

- NOTES:**
1. Any structural, services, fit out or external works are indicated for coordination purposes only, please refer to relevant Consultants / Clients information for full details where applicable.
 2. The areas indicated relate to the likely areas of the building at the current stage of design. Any decision to be made on the basis of these predictions, contractual agreements or the law, should include due allowance for design development and building insurance. Plans are subject to Building Control and other statutory approvals.
 3. Refer to relevant performance specifications and NBS for full application of Architectural elements.
 4. All primary Structure to Structural Engineers design, details and specification and with allowance also made for Secondary Structure and SFS accordingly to specialist subcontractor design as applicable.
 5. The content of this drawing is for design intent only and may require further design coordination with all relevant consultants, specialist designers, subcontractors, manufacturers and with statutory authorities where applicable.
 6. All Wall and Roof (Flat) penetrations to be confirmed and coordinated with by MEP Engineer design.
 7. All external envelope construction, insulation specifications, number and size of opening lights, and size of louvers are subject to verification by Thermal / SDEM model and detail coordination with the Structural and MEP Engineers.
 8. Maintenance strategy to be agreed. Current design indicated indicative only.
 9. Roof Drainage Strategy:
 - 9.1. Rain Water Pans / Traps (RWT): Indicative positions shown only. Number of required, locations and size all to be confirmed by specialist subcontractor who is required to carry out calculations accordingly. Include roof guards to all locations. Drainage to connect with by Engineers design, details and specification.
 - 9.2. Rain Curbs (RC): Indicative overflows/ weeping outlets. Number, positions and size to be confirmed by specialist.
 - 9.3. Roof Access Hatch: Signage at base of roof access ladder to read: "Roof access for authorised personnel only. Roof not to be accessed outside daylight hours"

PLEASE NOTE:

IT IS THE CONTRACTORS RESPONSIBILITY TO CARRY OUT A SITE MEASURE ENSURING ANY DIMENSIONAL CONSTRAINTS ARE MET BEFORE PROCEEDING TO ANY CRITICAL LOCATIONS PROVIDING ALIGNMENT OF ANY NEW BUILD ELEMENTS WITH EXISTING WALLS & STRUCTURES TO ENGINEERS ARCHITECTURALLY FINISHED FINISH. THE ARCHITECT IS TO BE ADVISED OF ANY SUCH DIMENSIONAL CONSTRAINTS AT COMMENCEMENT / INSTALLATION OF ASSOCIATED WORKS

- KEY:**
- Red Line Boundary
 - Phase 1 Boundary
 - Phase 2 Boundary
 - Phase 2 Scope (Refer to SDP / Pick Everard dwg's)

DEPARTMENT LEGEND:

- Circulation
- Concourse
- Kirklees Tenant
- Plant
- Retail
- Shared Access
- Staff
- Store
- Travel Centre
- WC's
- WYCA Tenant

Location & size of external plant compound is shown indicatively and is subject to site survey and investigation to assess suitability as it is located within the Network Rail easement zone.

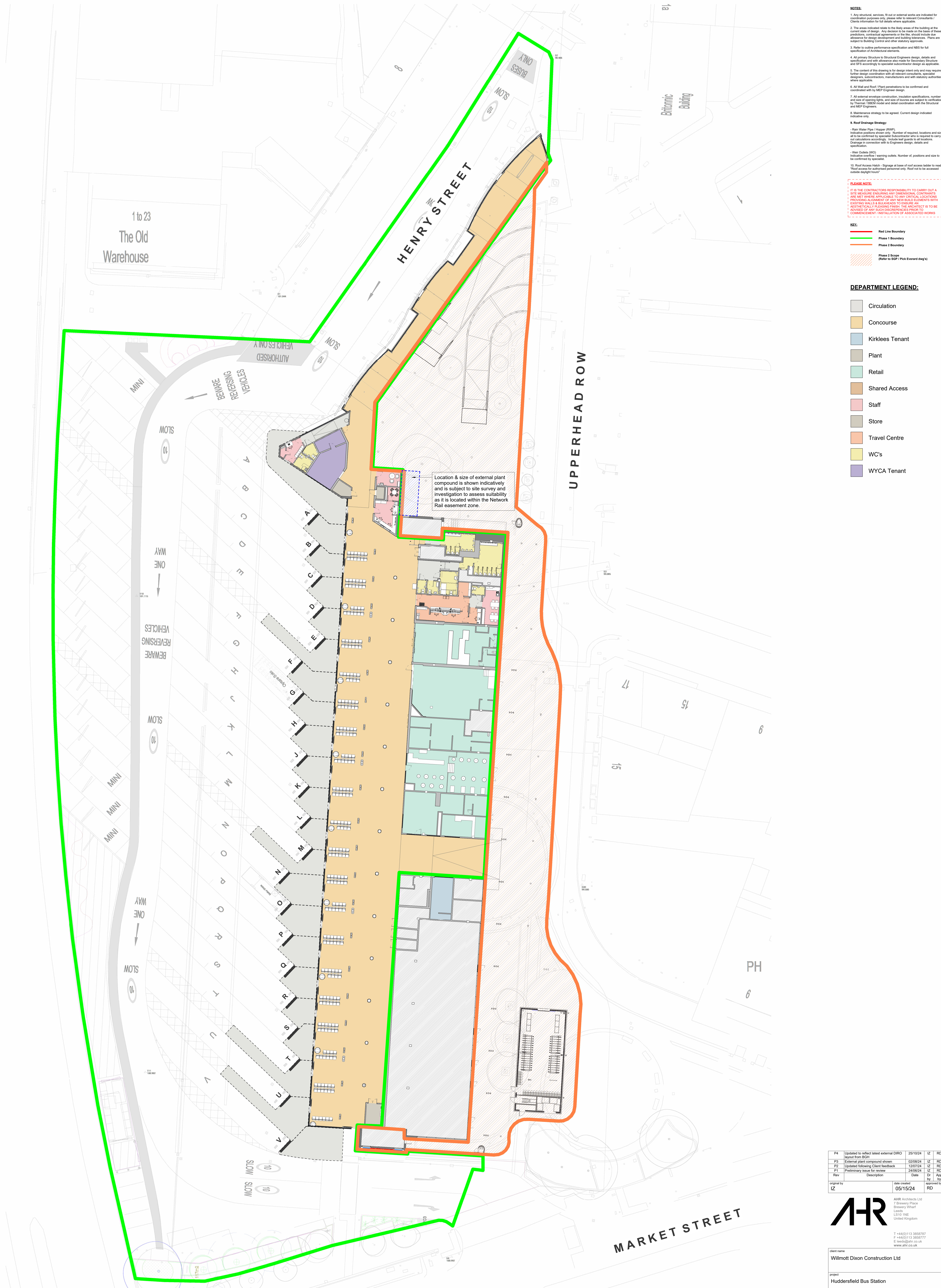

Rev	Description	Date	By	App
P4	Updated to reflect latest external DRO layout from BGM	25/10/24	IZ	RD
P3	External plant compound shown	02/09/24	IZ	RD
P2	Updated following Client feedback	12/07/24	IZ	RD
P1	Preliminary issue for review	24/06/24	IZ	RD

AHR Architects Ltd
 7 Brewery Place
 Brewery Wharf
 LS10 1NE
 Leeds
 United Kingdom
 T +44(0)113 3858787
 F +44(0)113 3858777
 E info@ahr.co.uk
 www.ahr.co.uk

client name	Willmott Dixon Construction Ltd		
project	Huddersfield Bus Station		
drawing	GA Floor Plan (Overall)		
computer file	Path: \\server\Public\Projects\Huddersfield\GA\GA-Floor-Plan-Overall.dwg	print date	
project number	2023.00190.000	scale	As Indicated@A0
drawing number	HBS-AHR-XX-00-D-A-20-001	rev	P4
		issue status	S2

00 GA Floor Plan (Overall) - Proposed
1:200

