

7.0 DESIGNING OUT CRIME

7.1 CONTEXT AND SECURITY ISSUES

West Yorkshire Police Designing Out Crime Officer (DOCO) has advised on a number of common criminal offences and anti-social behaviour issues to be aware of as relevant to the scheme. Proposed measures to mitigate this are illustrated in this section. The plans and photographs on this and the following page illustrate the various security risks that exist in and around the building.

The strategy that has been developed is designed to be proportionate to the threat level, and is to provide mitigation measures to protect the buildings and unauthorised access, burglary and potential attacks - and the associated damage this can cause both to the public and the fabric of the building.

As Dewsbury Market sits within the Publicly Accessible Location (PAL) definition, the Regional Counter Terrorism Security Advisor has also provided advice for the scheme as part of the planning process. A new Protect Duty, which is subject to an ongoing consultation process, will place a legal requirement for public places to ensure preparedness for and protection from terrorist attacks. Proposed measures to mitigate against potential attack include the treatment of glazing to prevent flying glass in the event of an explosion.

The inclusion of Hostile Vehicle Mitigation (HVM) measures to prevent unauthorised vehicular access is being developed for the proposals with the Council's appointed RSES Engineer Thornton Tomasetti.



Figure 7.1.1 Cars are able to access the site despite bollards and gates being in place to prevent entry.



Figure 7.1.2 Current street furniture and seating design encourages loitering and enables rough sleeping



Figure 7.1.3 Open stalls provide off ground shelter out of hours

Ad-hoc open shelters throughout the outdoor market facilitate loitering and anti-social behaviour



Figure 7.1.4 Narrow aisles and small alleys behind stalls create numerous hidden places without CCTV coverage



Figure 7.1.5 Vandalism and damage to glazing is common



Figure 7.1.6 Public toilets as stand-alone building are difficult to monitor and keep secure



7.2 DESIGNING OUT CRIME MEASURES: SITEWIDE

The plans and diagrams on the following pages illustrate the proposed security measures to be implemented as part of the scheme.



The building will be secured generally to prevent unauthorised access through the provision of new glazed & solid facades, access control, CCTV and new internal and external doorsets.

Vehicles are only permitted access on site during specified hours to allow traders to set up their stalls. This strategy will be managed and implemented by the Market management staff and removable bollards will be used to prevent unwanted vehicles accessing the site.

Other measures to mitigate against anti-social behaviour include;

-  Outdoor public toilet blocks demolished, new WC provision located inside the Semi-covered Market to increase opportunity for security and monitoring,
-  Glazed doors and stall hatches to be secured with external roller shutters

The following vehicle mitigation measures are proposed at the perimeter of the site, and subject to RSES engineer recommendation, could be specified as HVM measures;

-  Stone clad raised planters
-  Fence & gate
-  Bollards to the entry/ exit points of all vehicle routes will be adequately spaced and robust to prevent vehicle entry

Other vehicle mitigation measurers include;

-  Perimeter bollards to prevent vehicles parking on pavements and on top of the culvert





7.3 DESIGNING OUT CRIME MEASURES: GLAZING MITIGATION

As advised by the Counter Terrorism Security Officer, where there are vulnerabilities to the effects of explosive blast on external and internal glazing, measures should be taken to mitigate this.

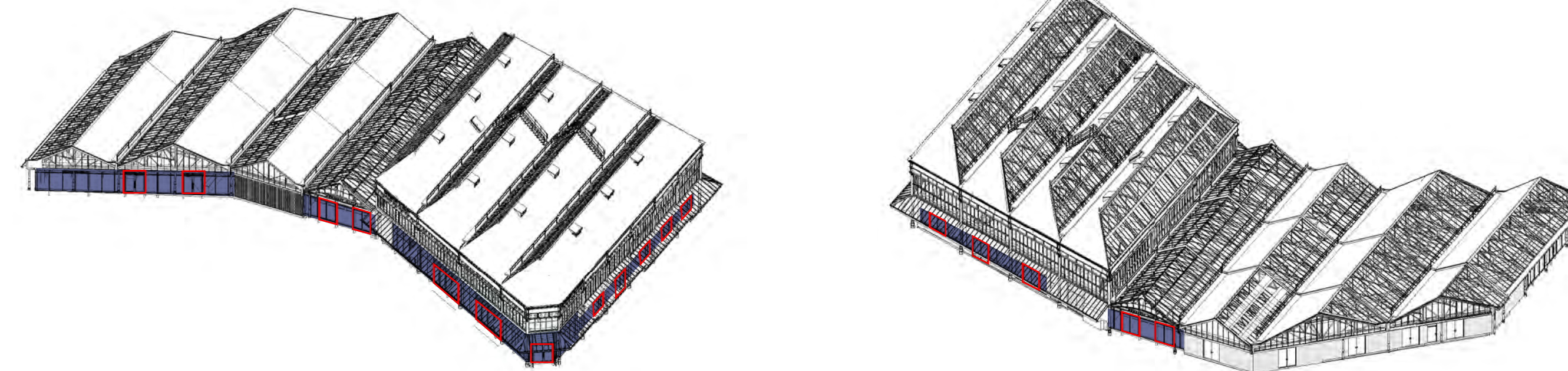
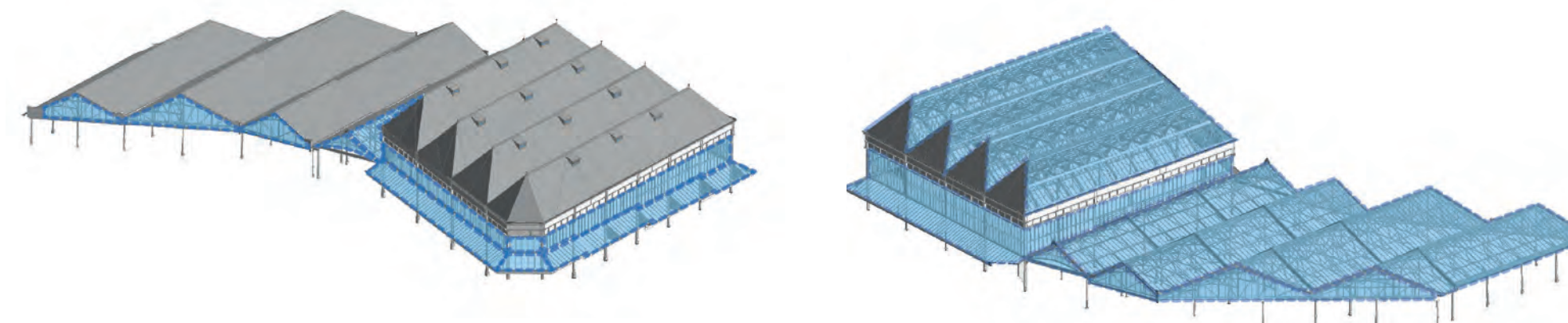
The diagrams adjacent illustrate the approach to new and existing glazing.



Key

-  New 7.5mm laminated glazing to EN ISO 12543 (or equivalent) standards
-  Glazing replacement - where feasible 7.5mm laminated glazing will be specified, where this is not possible or practical, anti-shatter film will be specified. *Note: Safety glass will be incorporated to external glazing where possible to meet necessary security requirements. Where this is not possible (e.g. without damaging the frames or increasing the load on the existing structure), anti-shatter film to be applied to existing glazing.*
-  Security shutters installed to glazed entrances & stall serving hatches