

Do Not Scale

Drawing Notes

Health, Safety & Environmental Notes

**Key**

Existing Ground level —

ADEPT Proposed Ground level —

ARP Proposed Ground level —

REFER TO LONGSECTION BELOW FOR CONTINUATION

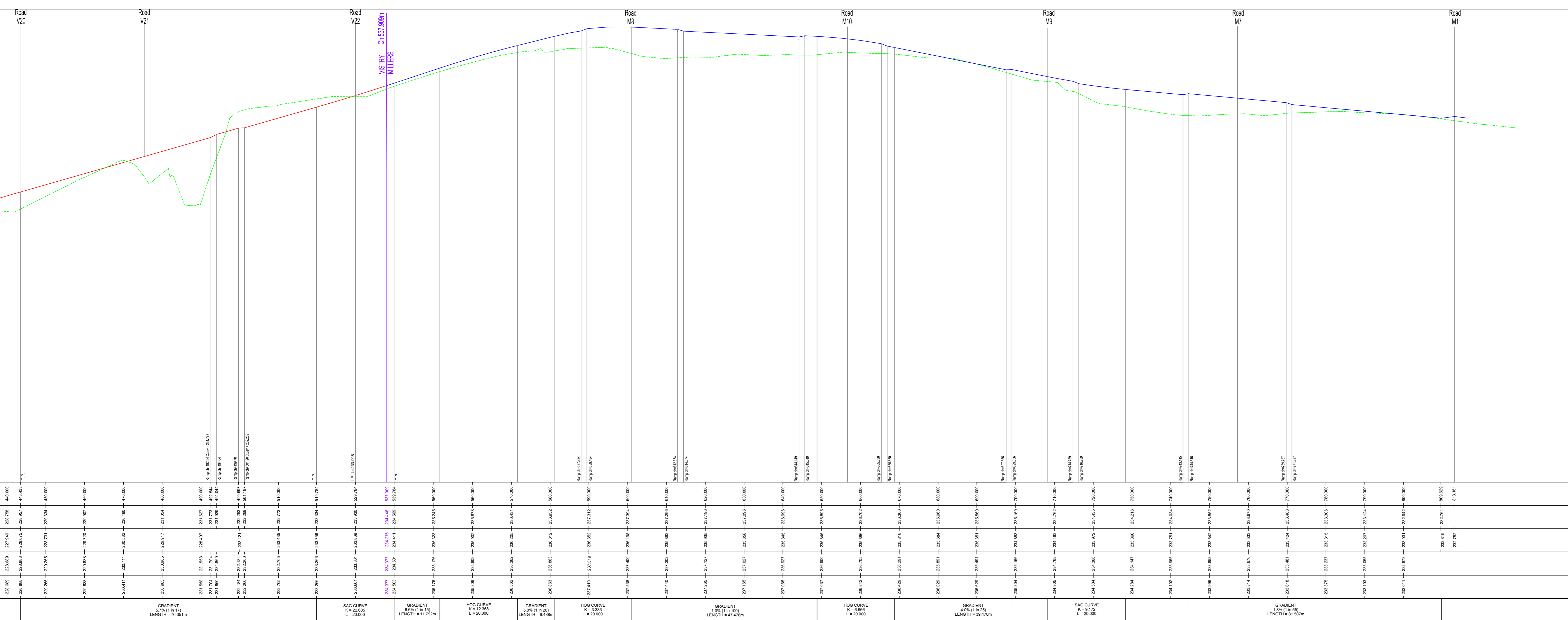
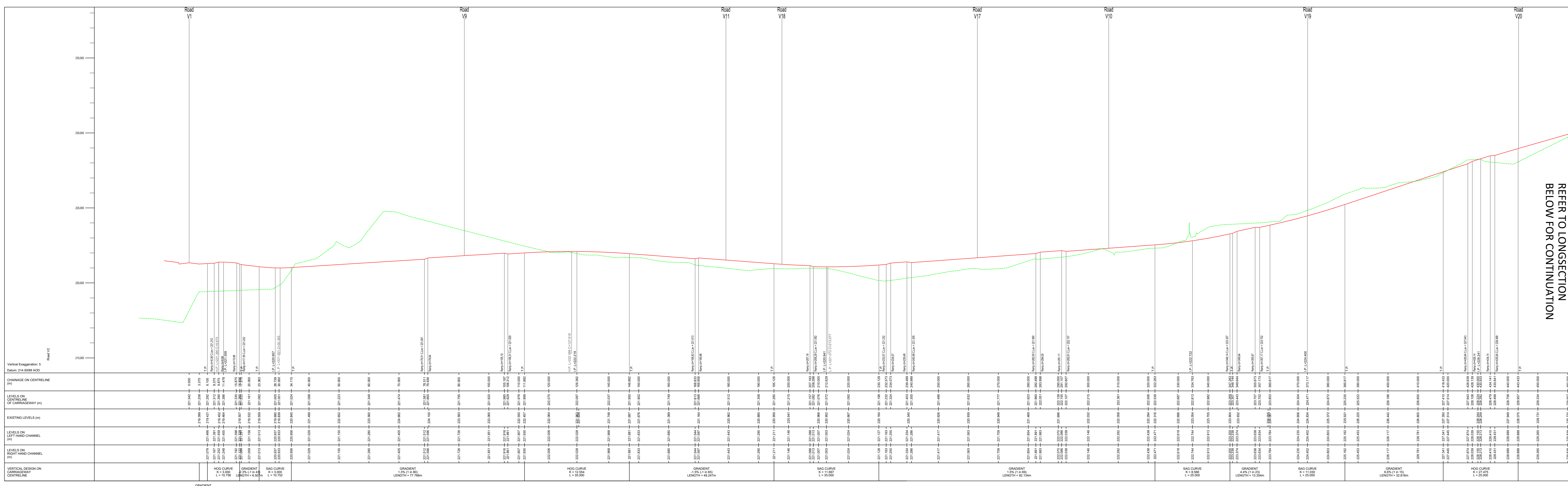

05.11.25	Road M2 amended to suit Millers / ARP updated road design	AT	RP	P2
03.11.25	Initial Issue	AT	RP	P1

Date	Description	By	Chk	Rev

**ADEPT**  
CIVIL AND STRUCTURAL CONSULTING ENGINEERS

Web: www.adepctce.com  
Email: info@adepctce.com  
Office Address: 292 Mill, Sunny Bank Mills, Farsley, Leeds LS28 5JJ

Project: **Blackmoorfoot, Huddersfield**

Title: **Planning Longsections Combined ARP-Adepts Sh.2**

Client: **Countryside Partnerships**

Scale: # A0	Initial author	Initial checker	Approver	Initial Date
1:500	AT	RP	RP	Nov 25
Status: S2	Purpose: Preliminary	Project Number: 08.24007	Rev:	
Project Originator/Functional Breakdown/Spatial Breakdown/Form Design/Number				
08.24007-ACE-00-ZZ-D-C-2038 P2				