

## **DESIGN & ACCESS STATEMENT**

### **AT 24 POLE GATE, SCAMMONDEN, HD3 3FW**

This report is to show how the external rear door at 24 Pole Gate, Scammonden, Huddersfield, HD3 3FW will be replaced.

The location of the proposed work is below:

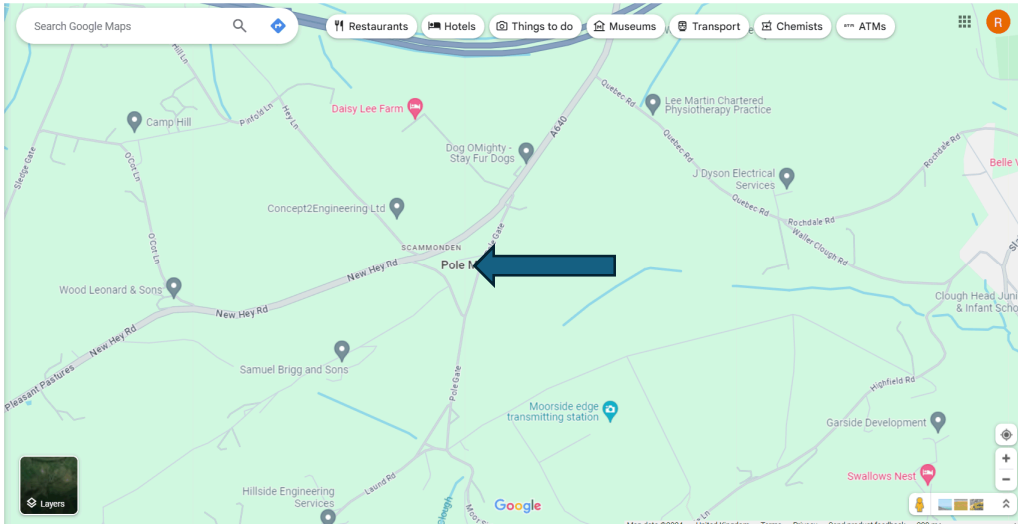

There is adequate parking for the joiner to enable the works to be completed in one single day. As the door & frame will be built offsite at their workshop.

There will be no disruption to the highway or excessive noise disruption for members of the public and neighbours. With access via the house and the garden.

The building was built in 1790 and is Grade II listed. It forms part of the Old School House which is adjoining The Chapel at Pole Moor.

The existing door and frame is made of Timber Hardwood and is rotten, photo on next page.

The existing light above the door is double glazing. The door is multi-point locking with two single pane glazing.

EXISTING



DETAIL  
S

Double  
Glazing  
to Light

Single  
glazing  
to door

PROPOSED DETAIL:

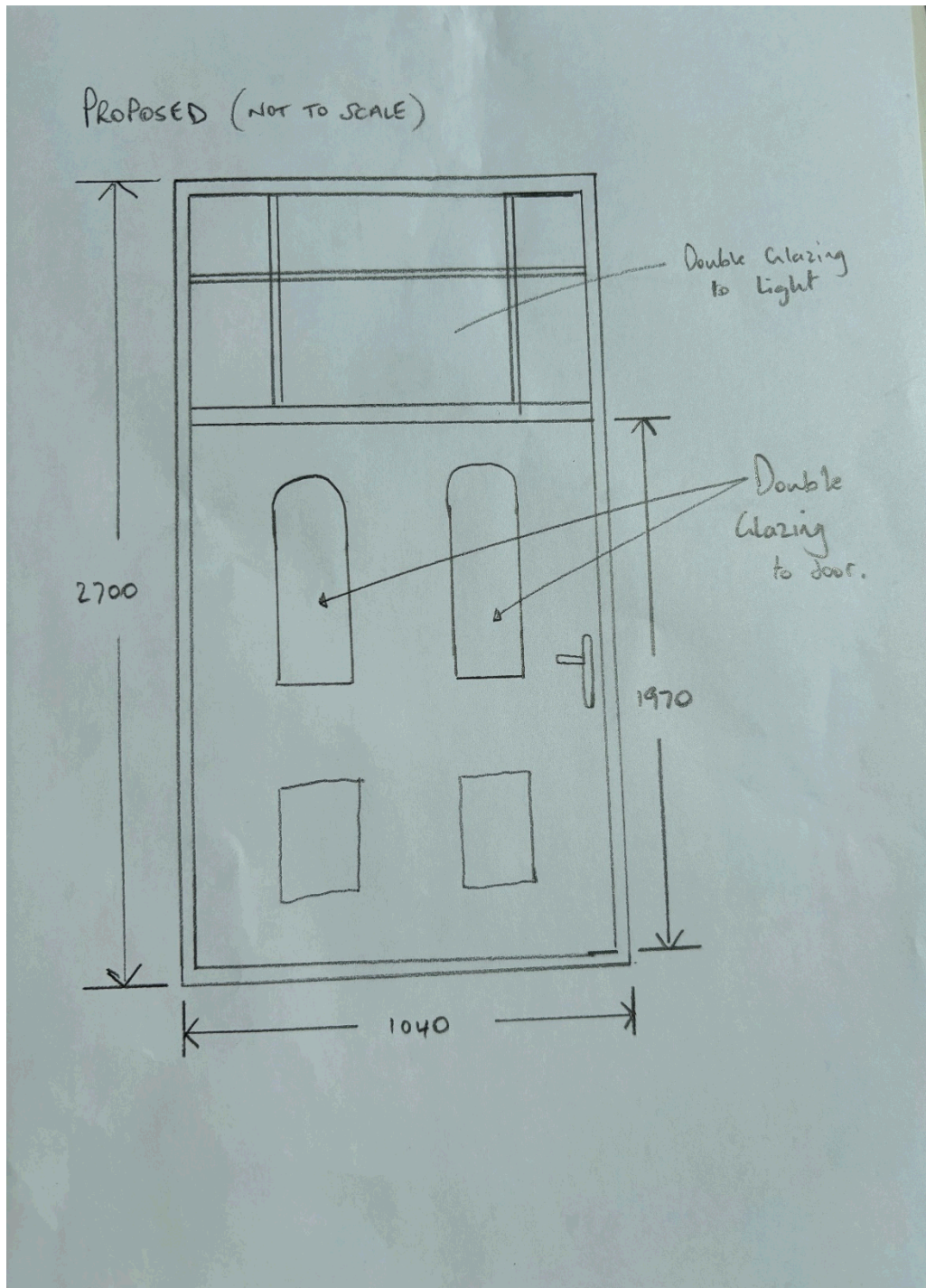

The proposed external door and frame will be visually the same as existing to preserve the appearance and heritage of the building.

The door can be seen from the Public Footpath to the rear of the property, as seen on the Location Report.

The joiner will be Roebuck & Holmes Ltd, of Farnley Tyas, Huddersfield. They have worked on many types of projects similar to this.