

DO NOT SCALE OR MEASURE FROM THIS DRAWING. ALL DIMENSIONS ARE TO BE CHECKED BY SITE MEASUREMENTS AND ANY DISCREPANCIES TO BE REPORTED IMMEDIATELY TO JW LEES LTD PROPERTY DEPARTMENT.

THIS DRAWING MUST BE READ IN CONJUNCTION WITH ALL OTHER JW LEES LTD DRAWINGS, SUBCONTRACTORS AND OTHER CONSULTANTS DRAWINGS AND TOGETHER WITH ANY SPECIFICATIONS AND OTHER CONTRACT DOCUMENTS.

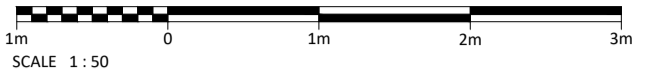

| INDICATIVE DRAINAGE KEY: | |
|--------------------------|---|
| | EXISTING BELOW GROUND FOUL DRAINAGE |
| | EXISTING BELOW GROUND SURFACE WATER DRAINAGE |
| | EXISTING REDUNDANT BELOW GROUND DRAINAGE TO BE REMOVED AND CAPPED |
| | PROPOSED BELOW GROUND FOUL DRAINAGE |
| | PROPOSED BELOW GROUND SURFACE WATER DRAINAGE |

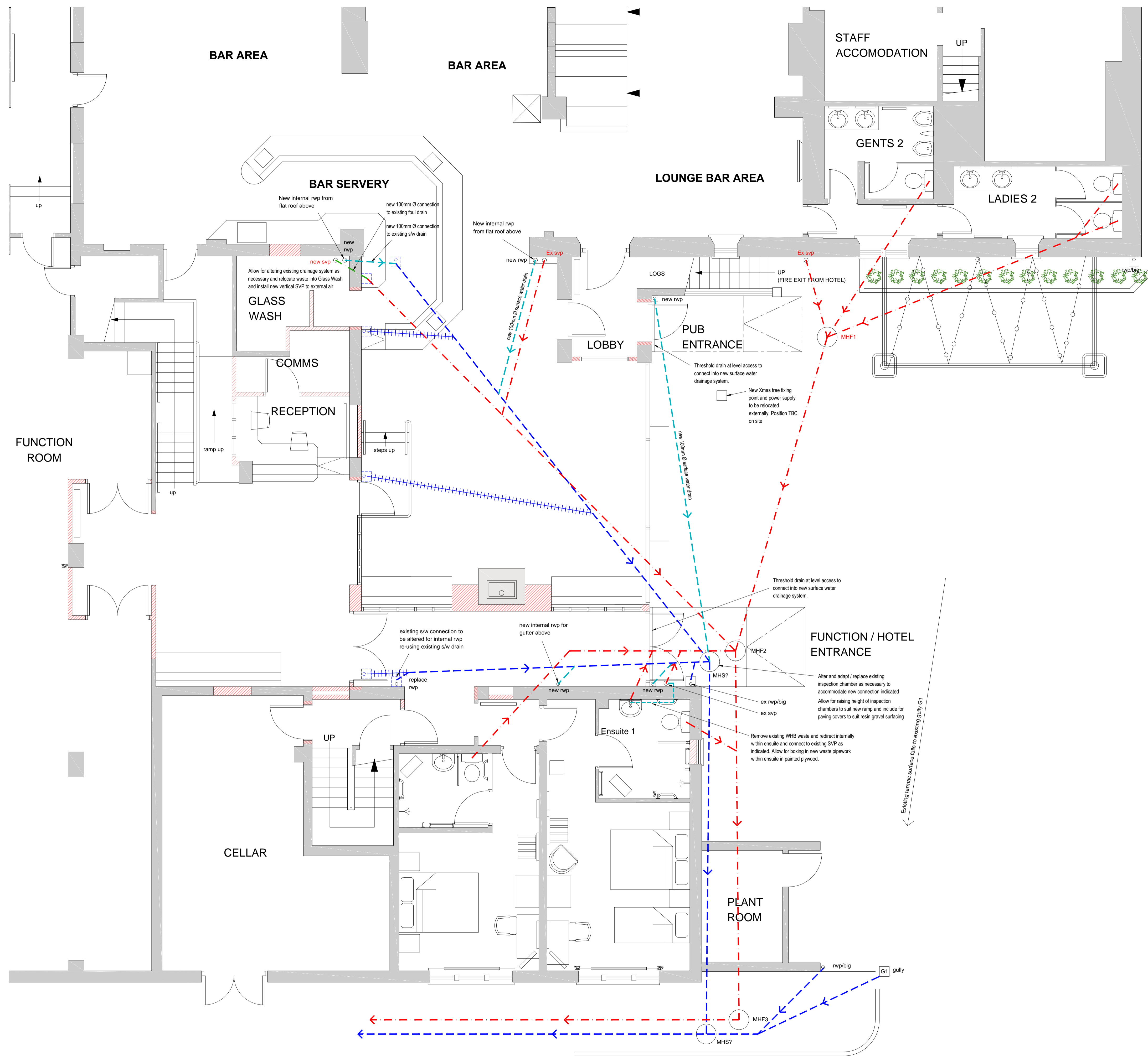

| Revisions | |
|--|-------------------------------------|
| PLANNING APPLICATION | |
| THE HUNTSMAN INN GREENFIELD ROAD, HOLMFIRTH, WEST YORKSHIRE, HD9 3XF | |
| GREENGATE BREWERY GRIMSHAW LANE, MIDDLETON, M24 2AX | |
| JWLEES | |
| Drawing | PROPOSED INDICATIVE DRAINAGE LAYOUT |
| Scale | 1:50 @ A1 |
| Date | July 2024 |
| Drawing Number | 1284_140 |