

Yorkshire

Published 1908

Source map scale - 1:10,560

The historical maps shown were reproduced from maps predominantly held at the scale adopted for England, Wales and Scotland in the 1840's. In 1854 the 1:2,500 scale was adopted for mapping urban areas; these maps were used to update the 1:10,560 maps. The published date given therefore is often some years later than the surveyed date. Before 1938, all OS maps were based on the Cassini Projection, with independent surveys of a single county or group of counties, giving rise to significant inaccuracies in outlying areas. In the late 1940's, a Provisional Edition was produced, which updated the 1:10,560 mapping from a number of sources. The maps appear unfinished - with all military camps and other strategic sites removed. These maps were initially overprinted with the National Grid. In 1970, the first 1:10,000 maps were produced using the Transverse Mercator Projection. The revision process continued until recently, with new editions appearing every 10 years or so for urban areas.

Map Name(s) and Date(s)

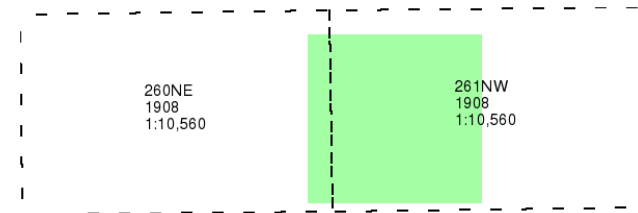

Historical Map - Slice A

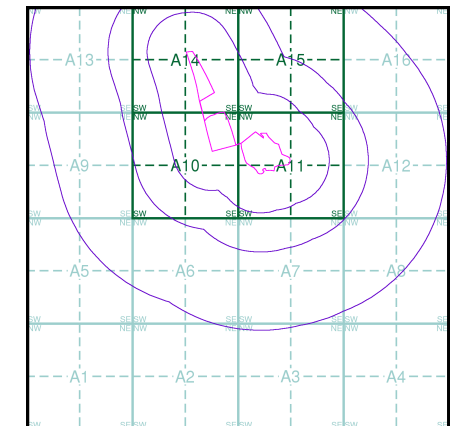

Order Details

Order Number: 132631275_1_1
 Customer Ref: 70035780
 National Grid Reference: 418870, 414330
 Slice: A
 Site Area (Ha): 10.7
 Search Buffer (m): 1000

Site Details

Land at Fenay Bridge, Fenay Bridge, HUDDERSFIELD, HD8 0JS

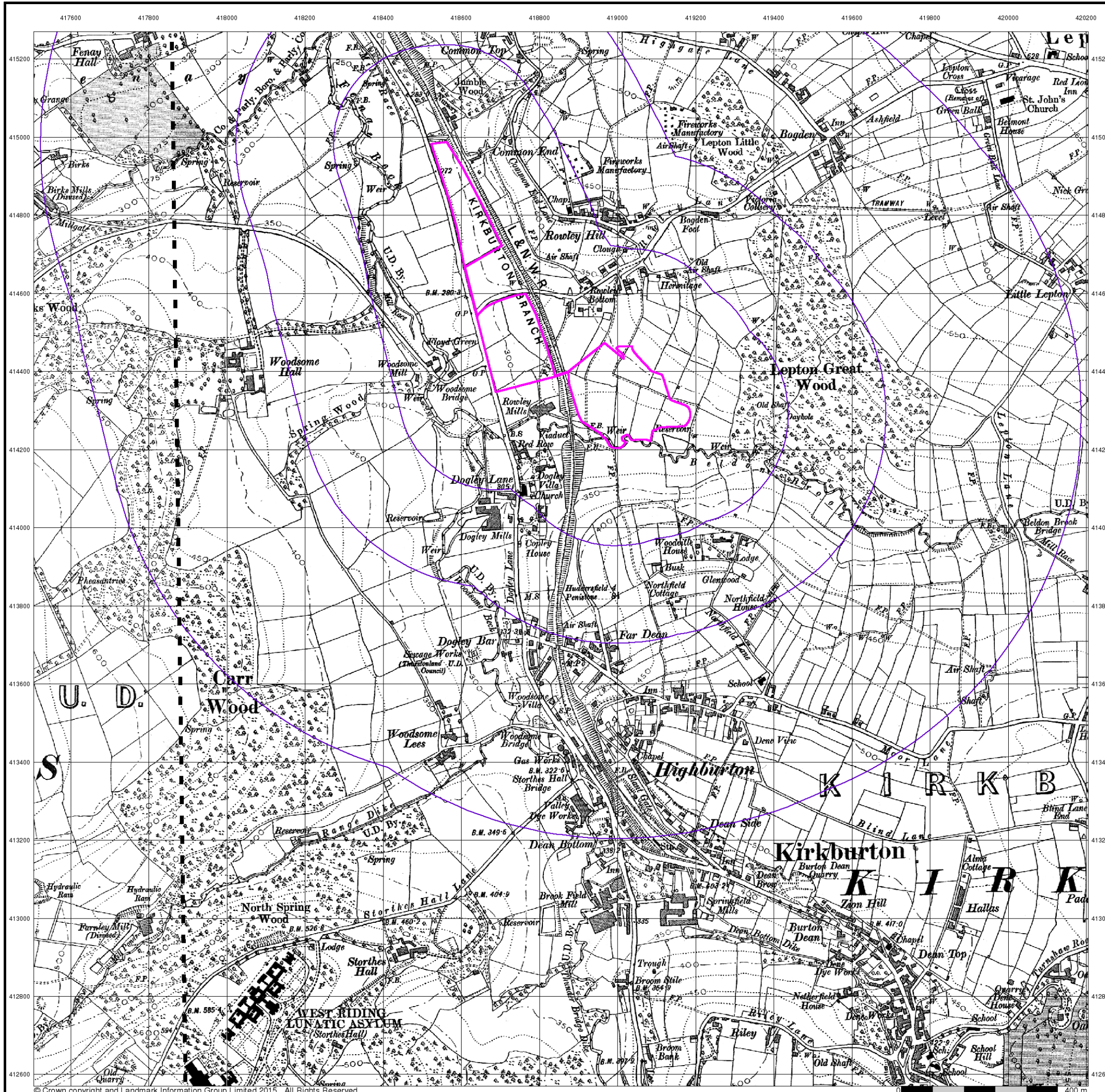

Yorkshire

Published 1930

Source map scale - 1:10,560

The historical maps shown were reproduced from maps predominantly held at the scale adopted for England, Wales and Scotland in the 1840's. In 1854 the 1:2,500 scale was adopted for mapping urban areas; these maps were used to update the 1:10,560 maps. The published date given therefore is often some years later than the surveyed date. Before 1938, all OS maps were based on the Cassini Projection, with independent surveys of a single county or group of counties, giving rise to significant inaccuracies in outlying areas. In the late 1940's, a Provisional Edition was produced, which updated the 1:10,560 mapping from a number of sources. The maps appear unfinished - with all military camps and other strategic sites removed. These maps were initially overprinted with the National Grid. In 1970, the first 1:10,000 maps were produced using the Transverse Mercator Projection. The revision process continued until recently, with new editions appearing every 10 years or so for urban areas.

Map Name(s) and Date(s)

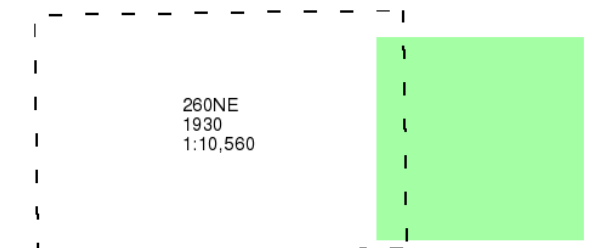

Historical Map - Slice A

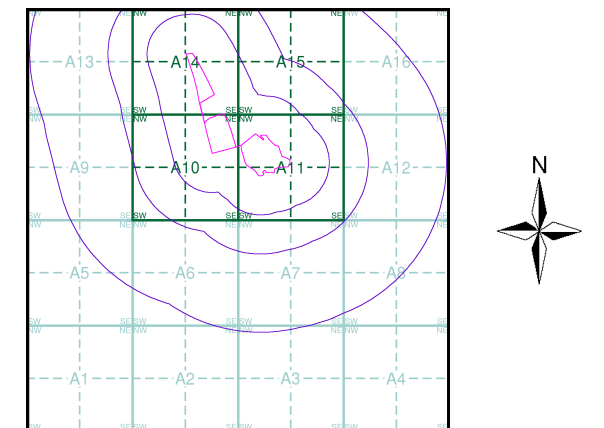

Order Details

Order Number: 132631275_1_1
 Customer Ref: 70035780
 National Grid Reference: 418870, 414330
 Slice: A
 Site Area (Ha): 10.7
 Search Buffer (m): 1000

Site Details

Land at Fenay Bridge, Fenay Bridge, HUDDERSFIELD, HD8 0JS

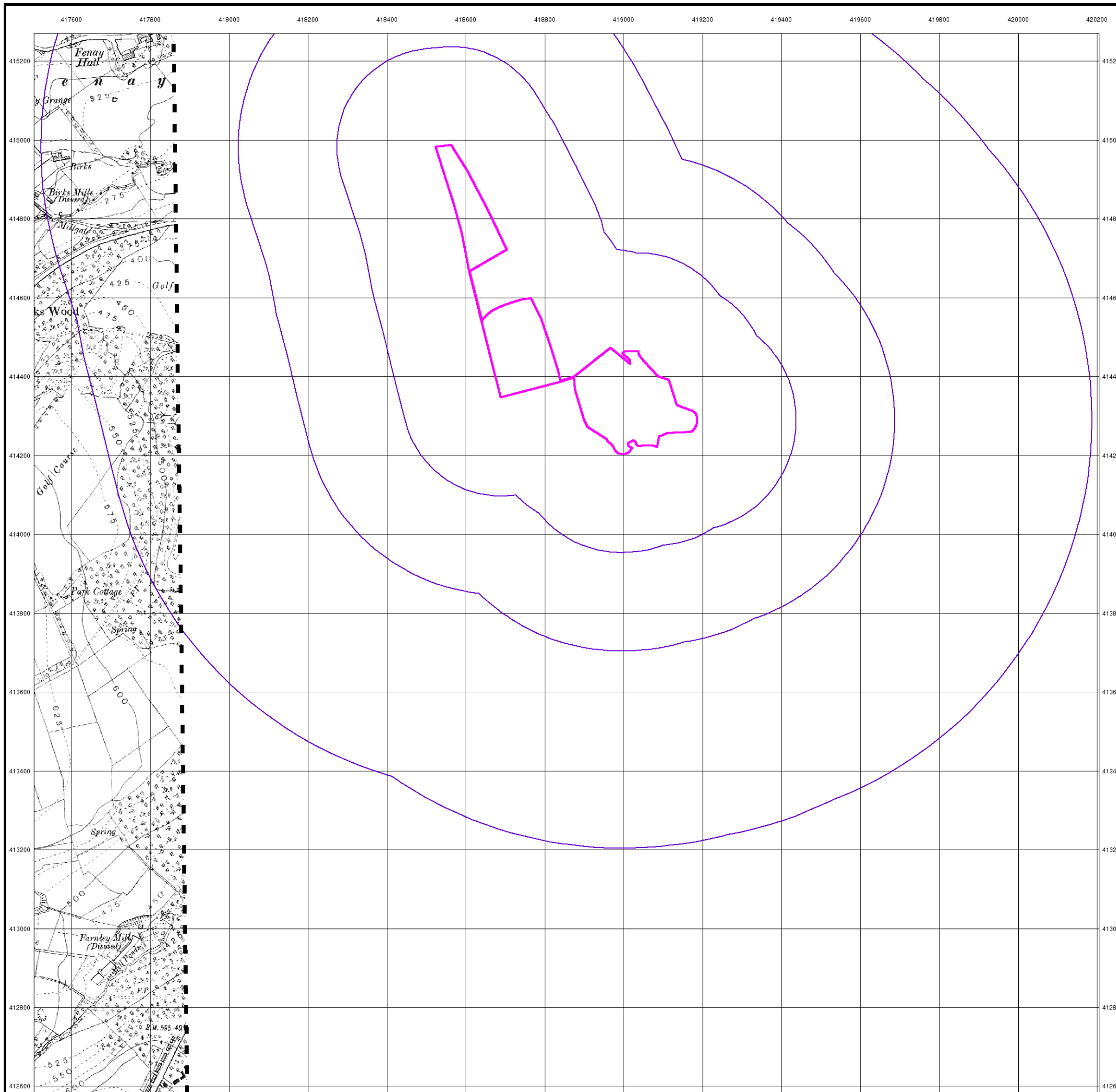

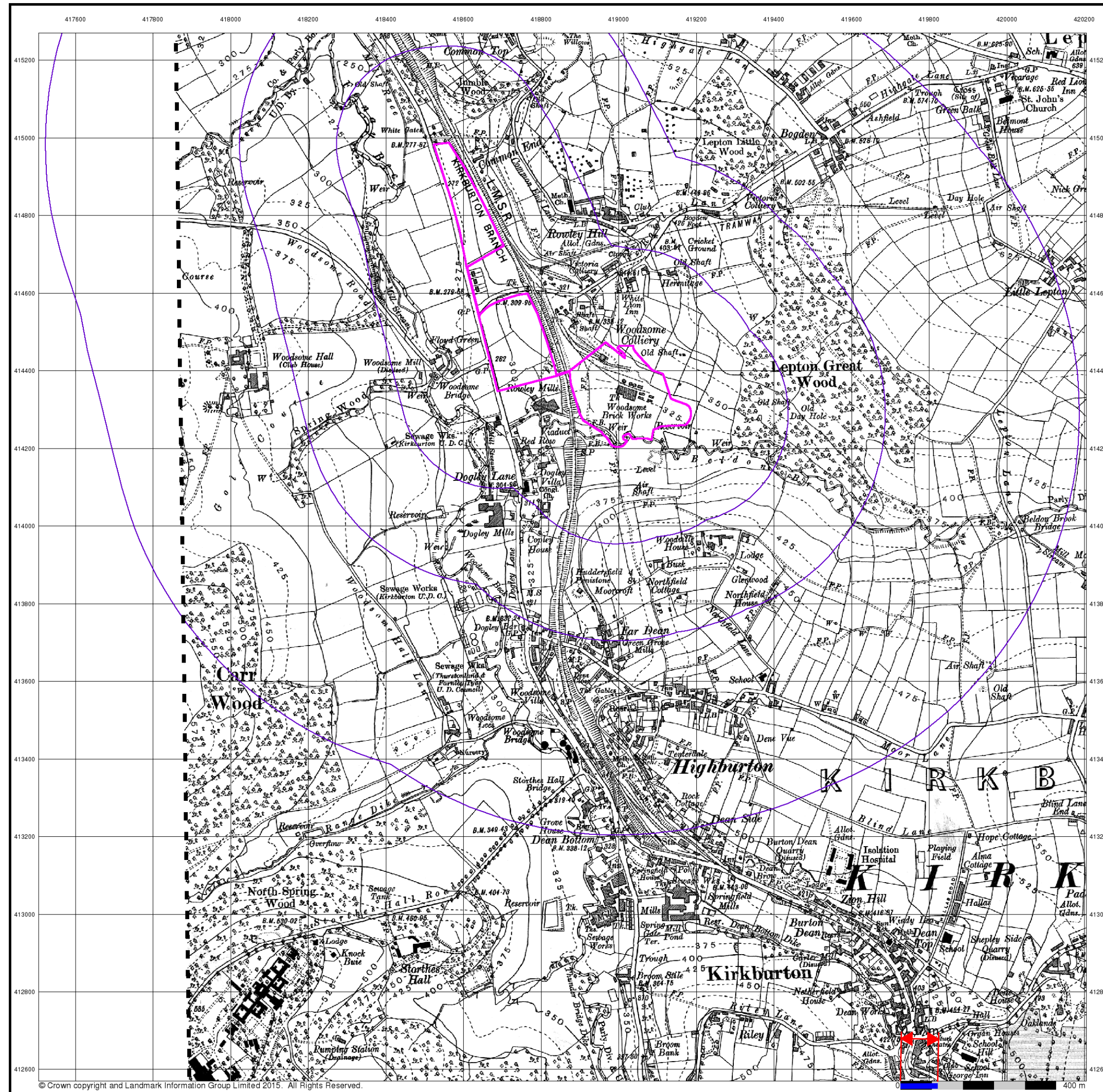

Yorkshire
Published 1933
Source map scale - 1:10,560

The historical maps shown were reproduced from maps predominantly held at the scale adopted for England, Wales and Scotland in the 1840's. In 1854 the 1:2,500 scale was adopted for mapping urban areas; these maps were used to update the 1:10,560 maps. The published date given therefore is often some years later than the surveyed date. Before 1938, all OS maps were based on the Cassini Projection, with independent surveys of a single county or group of counties, giving rise to significant inaccuracies in outlying areas. In the late 1940's, a Provisional Edition was produced, which updated the 1:10,560 mapping from a number of sources. The maps appear unfinished - with all military camps and other strategic sites removed. These maps were initially overprinted with the National Grid. In 1970, the first 1:10,000 maps were produced using the Transverse Mercator Projection. The revision process continued until recently, with new editions appearing every 10 years or so for urban areas.

Map Name(s) and Date(s)

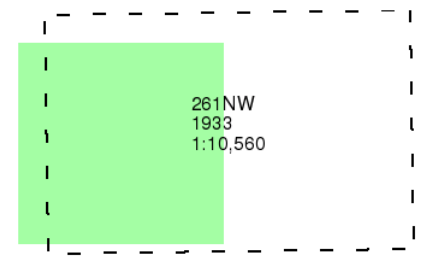

Historical Map - Slice A

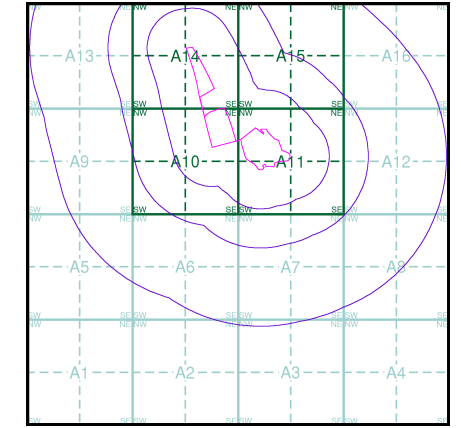

Order Details

Order Number: 132631275_1_1
 Customer Ref: 70035780
 National Grid Reference: 418870, 414330
 Slice: A
 Site Area (Ha): 10.7
 Search Buffer (m): 1000

Site Details

Land at Fenay Bridge, Fenay Bridge, HUDDERSFIELD, HD8 0JS

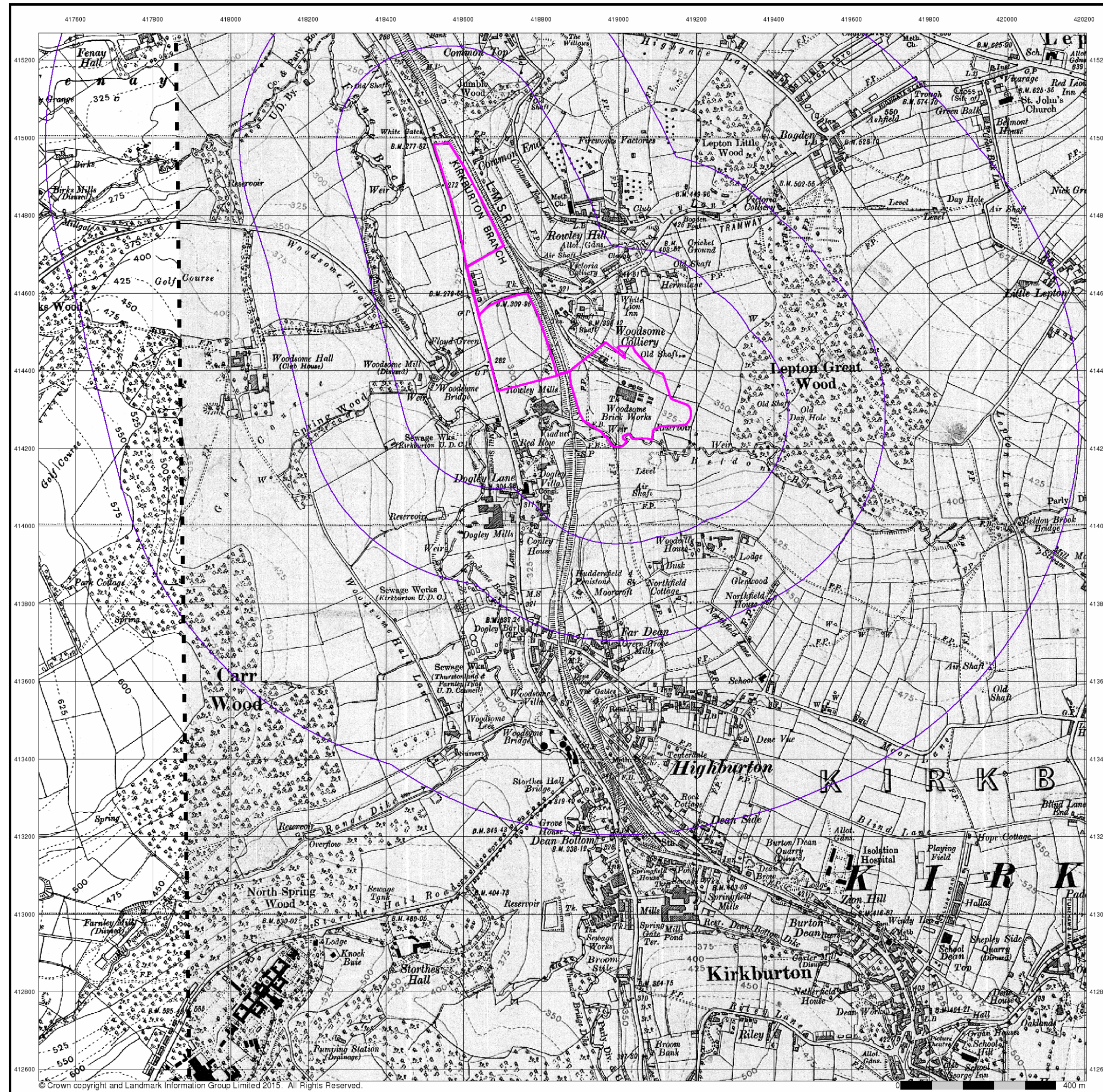

Yorkshire
Published 1938
Source map scale - 1:10,560

The historical maps shown were reproduced from maps predominantly held at the scale adopted for England, Wales and Scotland in the 1840's. In 1854 the 1:2,500 scale was adopted for mapping urban areas; these maps were used to update the 1:10,560 maps. The published date given therefore is often some years later than the surveyed date. Before 1938, all OS maps were based on the Cassini Projection, with independent surveys of a single county or group of counties, giving rise to significant inaccuracies in outlying areas. In the late 1940's, a Provisional Edition was produced, which updated the 1:10,560 mapping from a number of sources. The maps appear unfinished - with all military camps and other strategic sites removed. These maps were initially overprinted with the National Grid. In 1970, the first 1:10,000 maps were produced using the Transverse Mercator Projection. The revision process continued until recently, with new editions appearing every 10 years or so for urban areas.

Map Name(s) and Date(s)

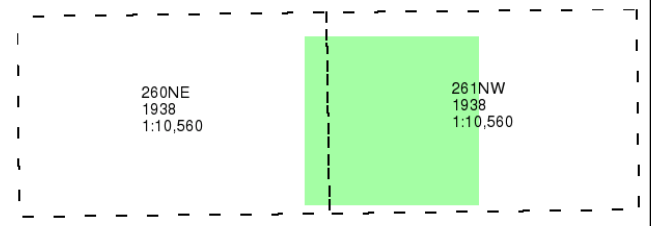

Historical Map - Slice A

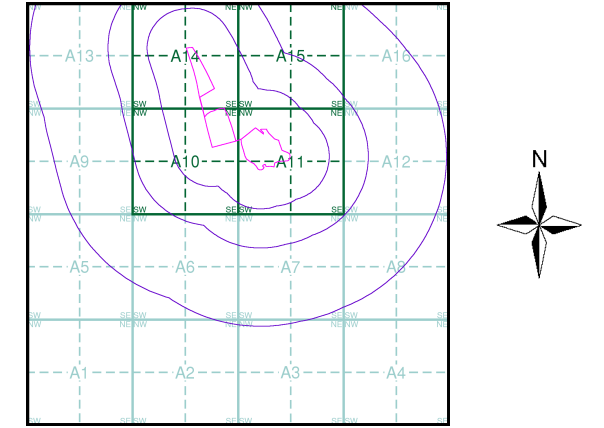

Order Details

Order Number: 132631275_1_1
 Customer Ref: 70035780
 National Grid Reference: 418870, 414330
 Slice: A
 Site Area (Ha): 10.7
 Search Buffer (m): 1000

Site Details

Land at Fenay Bridge, Fenay Bridge, HUDDERSFIELD, HD8 0JS

The historical maps shown were reproduced from maps predominantly held at the scale adopted for England, Wales and Scotland in the 1840's. In 1854 the 1:2,500 scale was adopted for mapping urban areas; these maps were used to update the 1:10,560 maps. The published date given therefore is often some years later than the surveyed date. Before 1938, all OS maps were based on the Cassini Projection, with independent surveys of a single county or group of counties, giving rise to significant inaccuracies in outlying areas. In the late 1940's, a Provisional Edition was produced, which updated the 1:10,560 mapping from a number of sources. The maps appear unfinished - with all military camps and other strategic sites removed. These maps were initially overprinted with the National Grid. In 1970, the first 1:10,000 maps were produced using the Transverse Mercator Projection. The revision process continued until recently, with new editions appearing every 10 years or so for urban areas.

Map Name(s) and Date(s)

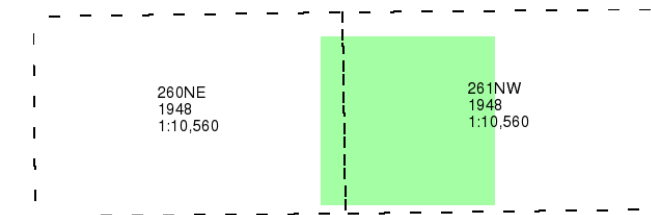

Historical Map - Slice A

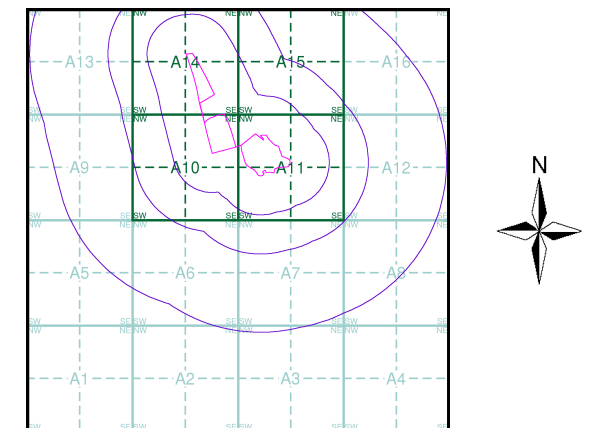

Order Details

Order Number: 132631275_1_1
 Customer Ref: 70035780
 National Grid Reference: 418870, 414330
 Slice: A
 Site Area (Ha): 10.7
 Search Buffer (m): 1000

Site Details

Land at Fenay Bridge, Fenay Bridge, HUDDERSFIELD, HD8 0JS

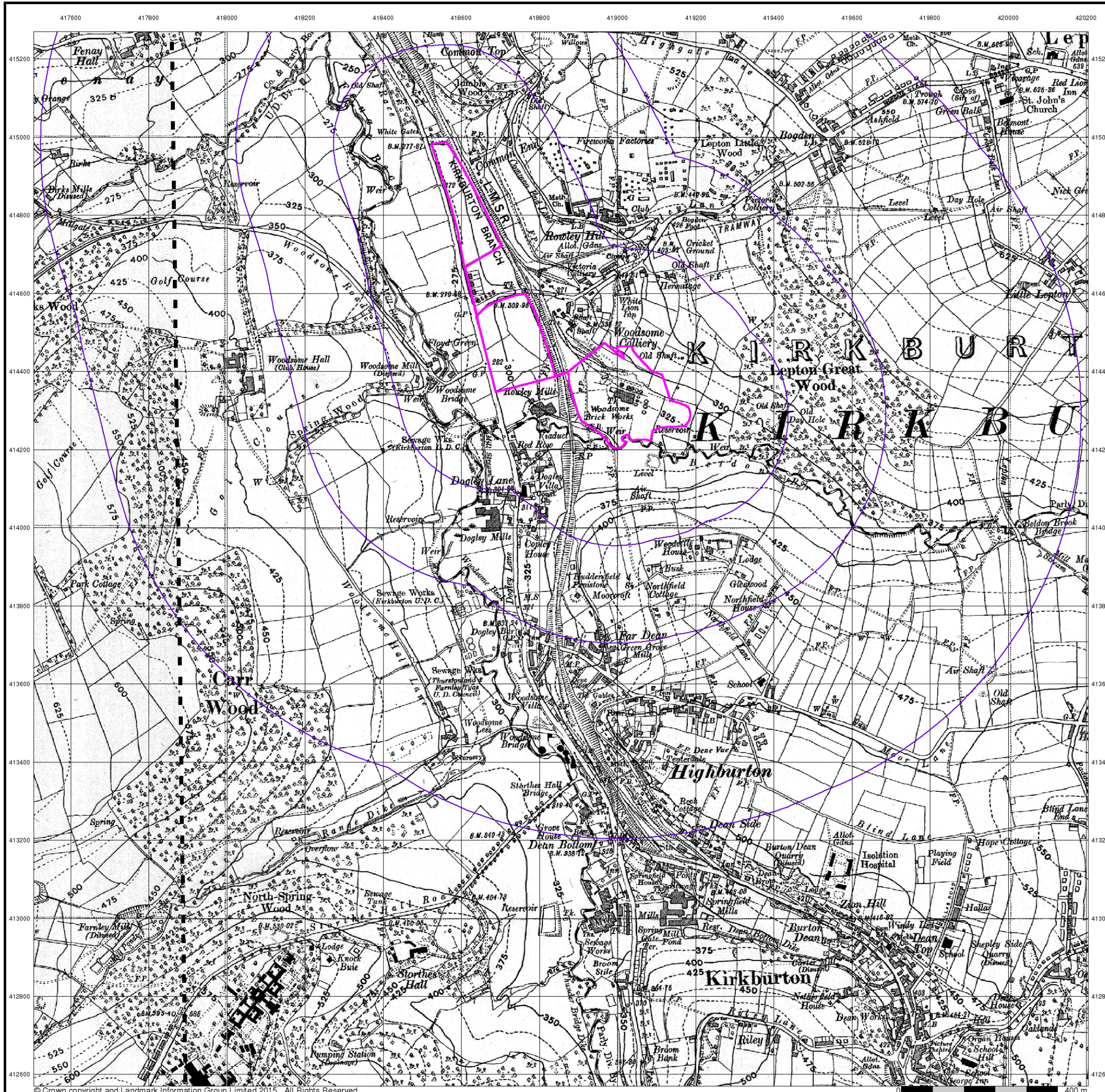

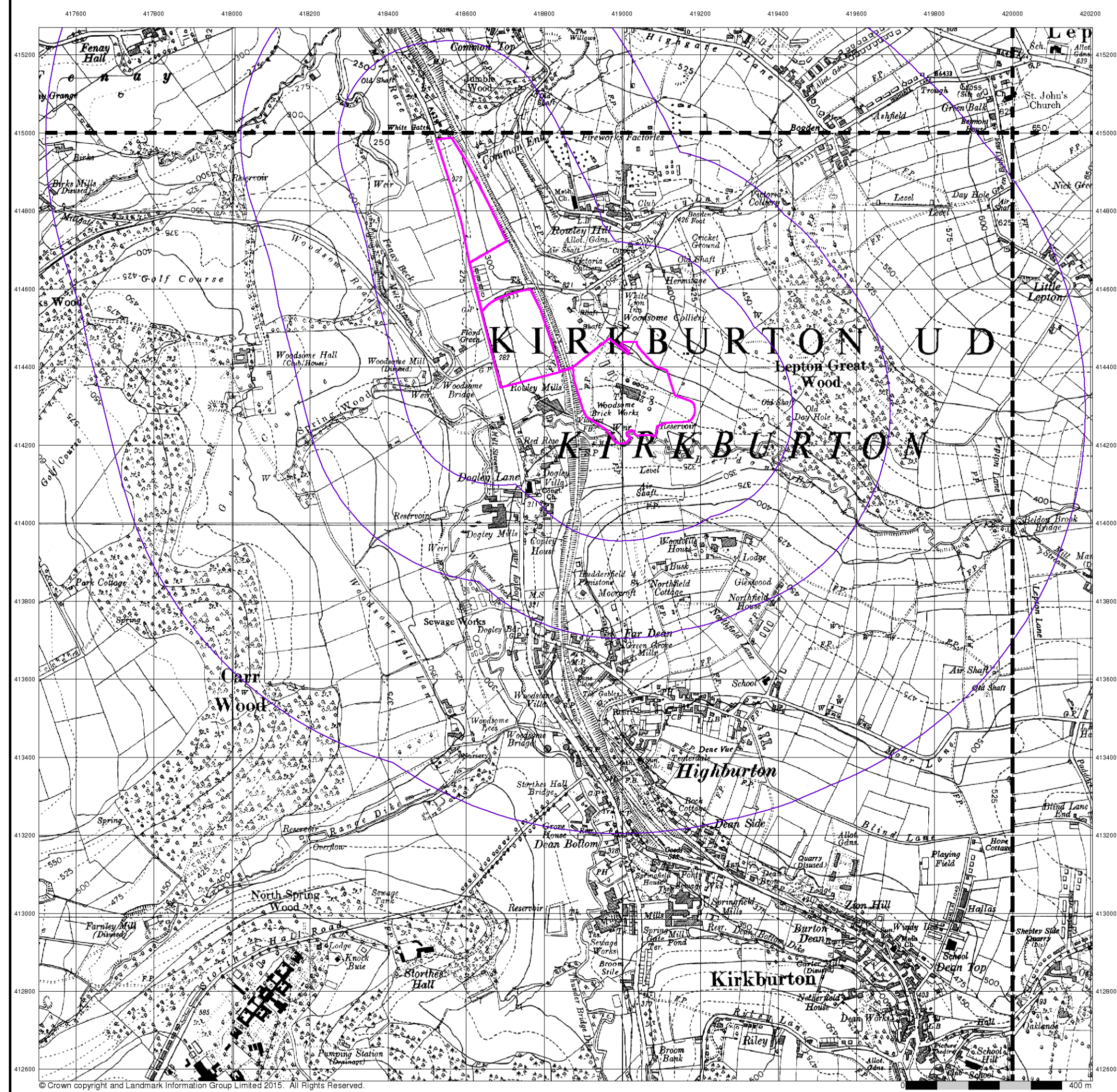

Ordnance Survey Plan

Published 1955 - 1956

Source map scale - 1:10,000

The historical maps shown were reproduced from maps predominantly held at the scale adopted for England, Wales and Scotland in the 1840's. In 1854 the 1:2,500 scale was adopted for mapping urban areas; these maps were used to update the 1:10,560 maps. The published date given therefore is often some years later than the surveyed date. Before 1938, all OS maps were based on the Cassini Projection, with independent surveys of a single county or group of counties, giving rise to significant inaccuracies in outlying areas. In the late 1940's, a Provisional Edition was produced, which updated the 1:10,560 mapping from a number of sources. The maps appear unfinished - with all military camps and other strategic sites removed. These maps were initially overprinted with the National Grid. In 1970, the first 1:10,000 maps were produced using the Transverse Mercator Projection. The revision process continued until recently, with new editions appearing every 10 years or so for urban areas.

Map Name(s) and Date(s)

SE11NE	SE21NW
1956	1955
1:10,560	1:10,560
SE11SE	SE21SW
1955	1955
1:10,560	1:10,560

Historical Map - Slice A

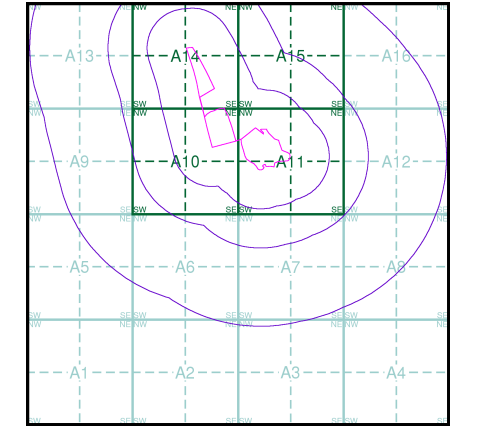

Order Details

Order Number: 132631275_1_1
 Customer Ref: 70035780
 National Grid Reference: 418870, 414330
 Slice: A
 Site Area (Ha): 10.7
 Search Buffer (m): 1000

Site Details

Land at Fenay Bridge, Fenay Bridge, HUDDERSFIELD, HD8 0JS

Ordnance Survey Plan

Published 1965 - 1968

Source map scale - 1:10,000

The historical maps shown were reproduced from maps predominantly held at the scale adopted for England, Wales and Scotland in the 1840's. In 1854 the 1:2,500 scale was adopted for mapping urban areas; these maps were used to update the 1:10,560 maps. The published date given therefore is often some years later than the surveyed date. Before 1938, all OS maps were based on the Cassini Projection, with independent surveys of a single county or group of counties, giving rise to significant inaccuracies in outlying areas. In the late 1940's, a Provisional Edition was produced, which updated the 1:10,560 mapping from a number of sources. The maps appear unfinished - with all military camps and other strategic sites removed. These maps were initially overprinted with the National Grid. In 1970, the first 1:10,000 maps were produced using the Transverse Mercator Projection. The revision process continued until recently, with new editions appearing every 10 years or so for urban areas.

Map Name(s) and Date(s)

SE11NE 1965 1:10,560	SE21NW 1966 1:10,560
SE11SE 1968 1:10,560	SE21SW 1967 1:10,560

Historical Map - Slice A

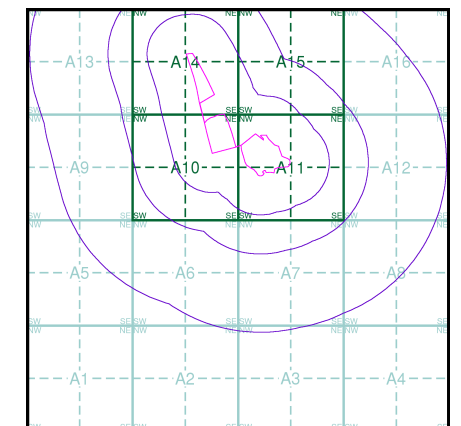

Order Details

Order Number: 132631275_1_1
 Customer Ref: 70035780
 National Grid Reference: 418870, 414330
 Slice: A
 Site Area (Ha): 10.7
 Search Buffer (m): 1000

Site Details

Land at Fenay Bridge, Fenay Bridge, HUDDERSFIELD, HD8 0JS

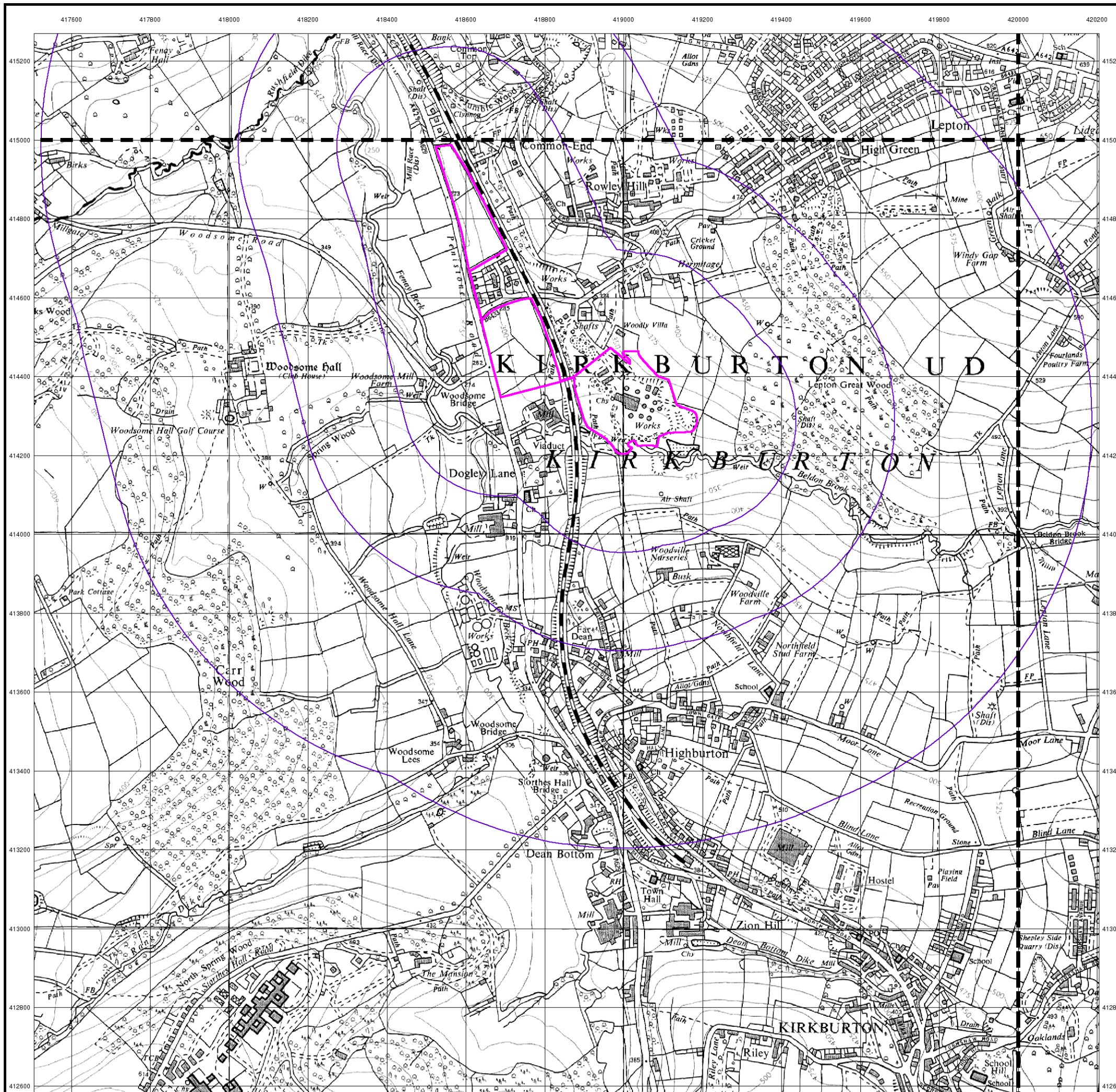

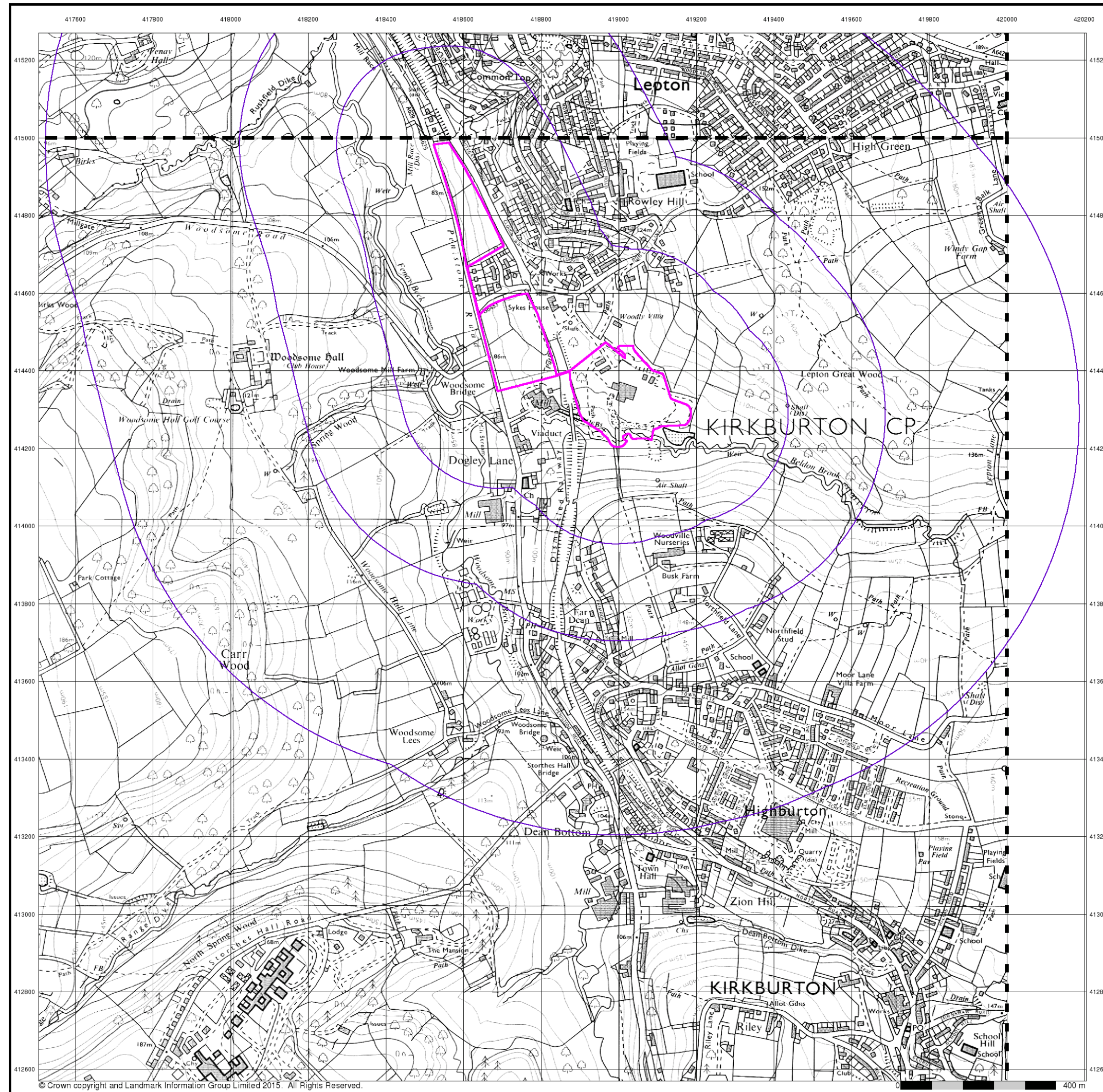

Envirocheck®

LANDMARK INFORMATION GROUP®

Ordnance Survey Plan

Published 1976 - 1979

Source map scale - 1:10,000

The historical maps shown were reproduced from maps predominantly held at the scale adopted for England, Wales and Scotland in the 1840's. In 1854 the 1:2,500 scale was adopted for mapping urban areas; these maps were used to update the 1:10,560 maps. The published date given therefore is often some years later than the surveyed date. Before 1938, all OS maps were based on the Cassini Projection, with independent surveys of a single county or group of counties, giving rise to significant inaccuracies in outlying areas. In the late 1940's, a Provisional Edition was produced, which updated the 1:10,560 mapping from a number of sources. The maps appear unfinished - with all military camps and other strategic sites removed. These maps were initially overprinted with the National Grid. In 1970, the first 1:10,000 maps were produced using the Transverse Mercator Projection. The revision process continued until recently, with new editions appearing every 10 years or so for urban areas.

Map Name(s) and Date(s)

SE11NE	1976	1:10,000
SE11SE	1979	1:10,000

Historical Map - Slice A

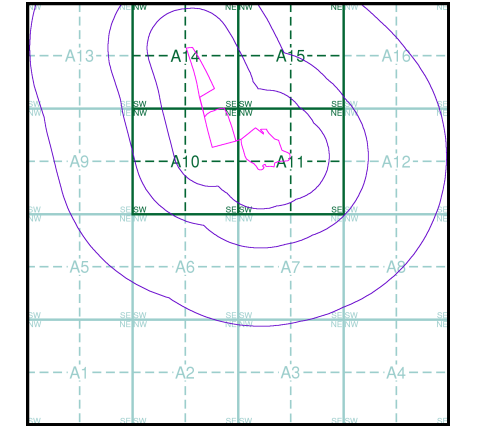

Order Details

Order Number: 132631275_1_1
 Customer Ref: 70035780
 National Grid Reference: 418870, 414330
 Slice: A
 Site Area (Ha): 10.7
 Search Buffer (m): 1000

Site Details

Land at Fenay Bridge, Fenay Bridge, HUDDERSFIELD, HD8 0JS

Landmark
 INFORMATION GROUP

Tel: 0844 844 9952
 Fax: 0844 844 9951
 Web: www.envirocheck.co.uk