

DO NOT SCALE

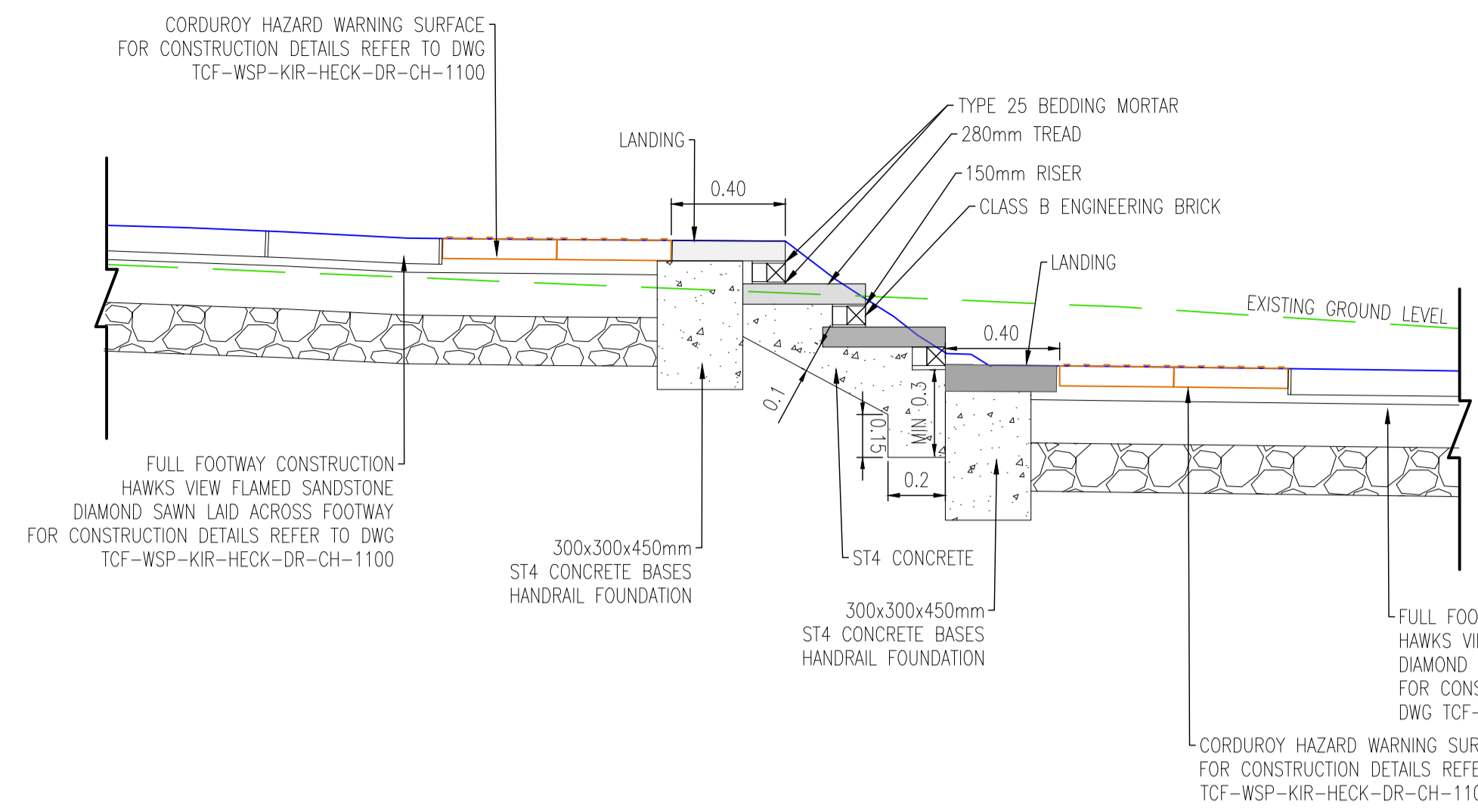

STEPS CROSS SECTION
(SCALE 1:20)

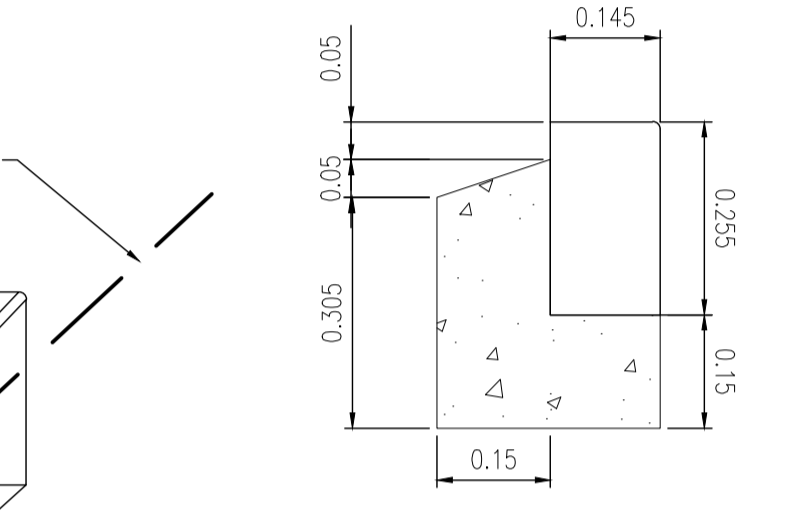

CONSERVATION KERBS (SK1)
(SCALE 1:10)

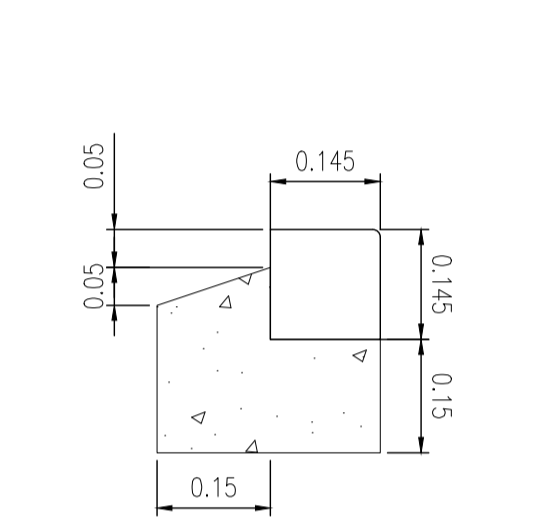

CONSERVATION KERBS (SK1C)
(SCALE 1:10)

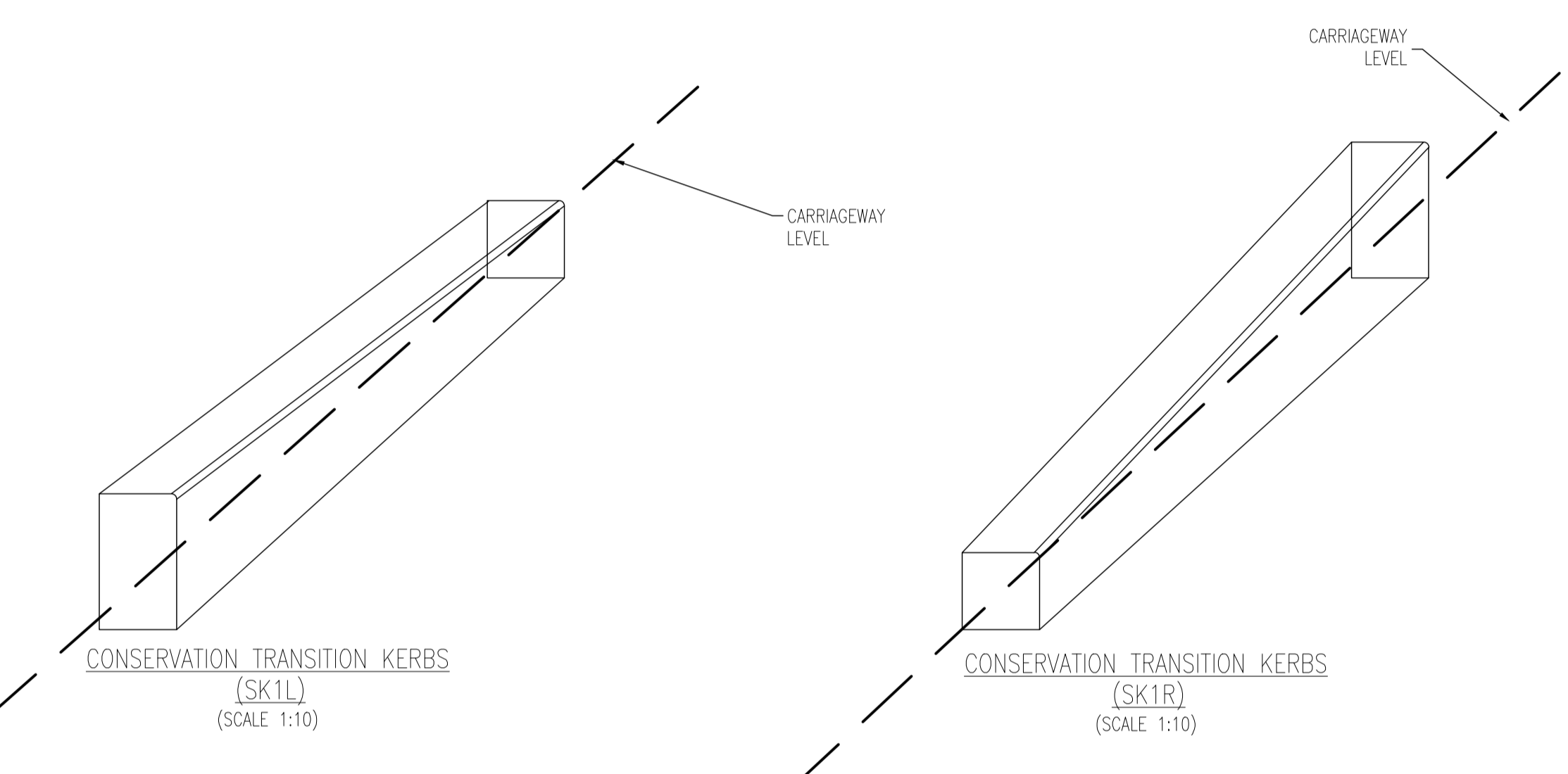

CONSERVATION TRANSITION KERBS (SK1L)
(SCALE 1:10)

CONSERVATION TRANSITION KERBS (SK1R)
(SCALE 1:10)

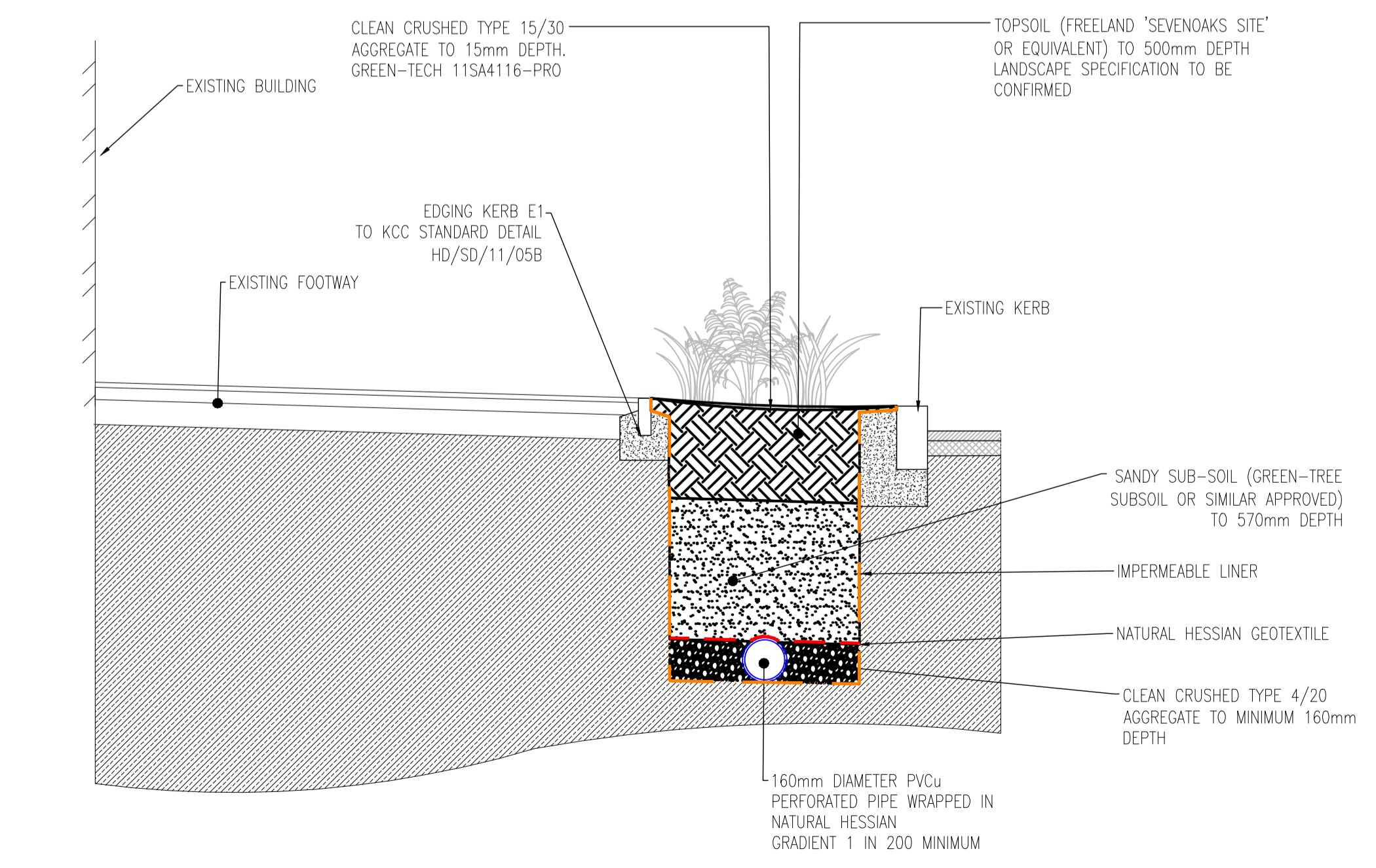

SUDs S GEORGE STREET
(SCALE 1:20)
REFER TO DWG
TCF-WSP-KIR-HECK-DR-CH-1100

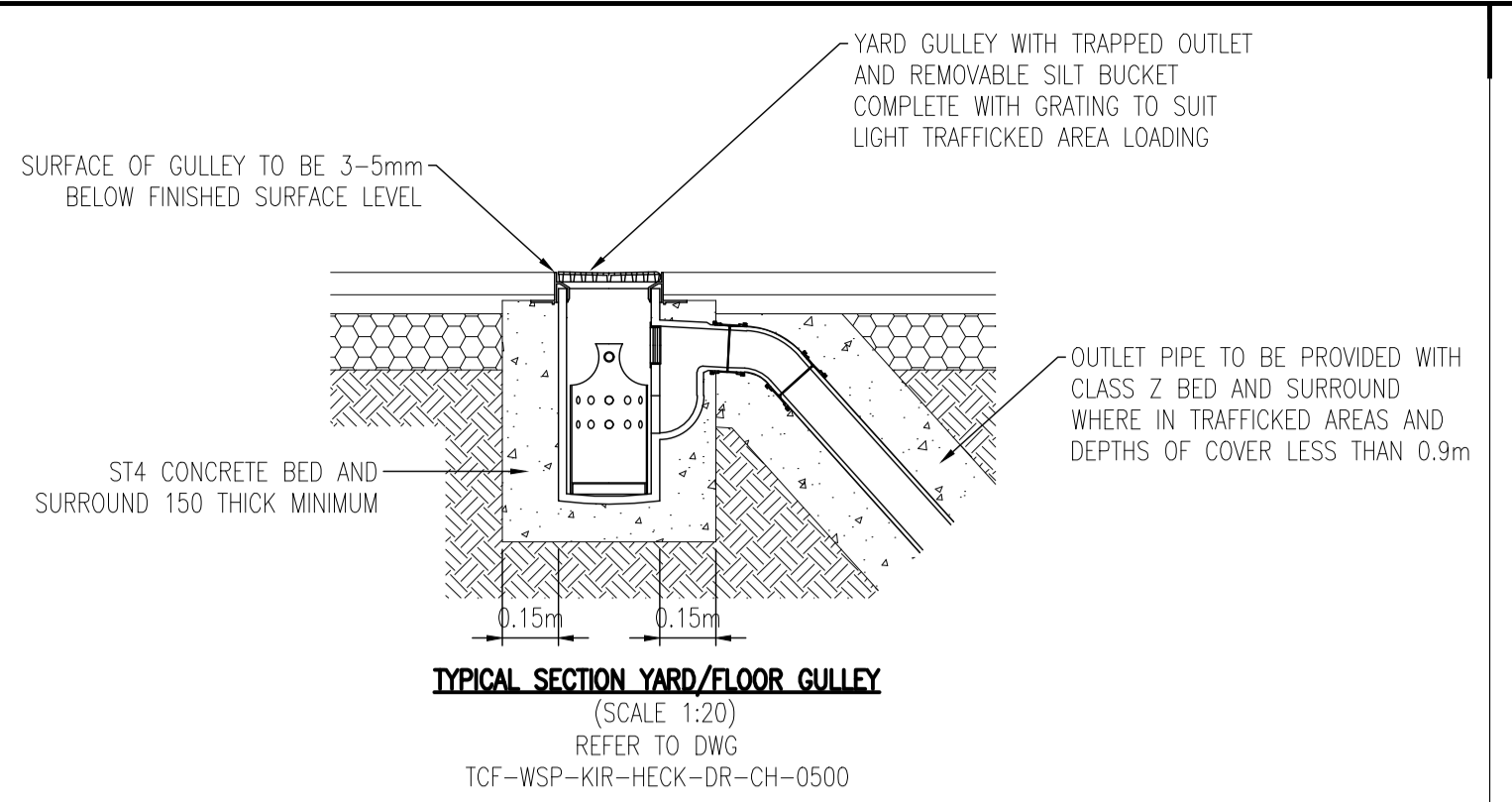
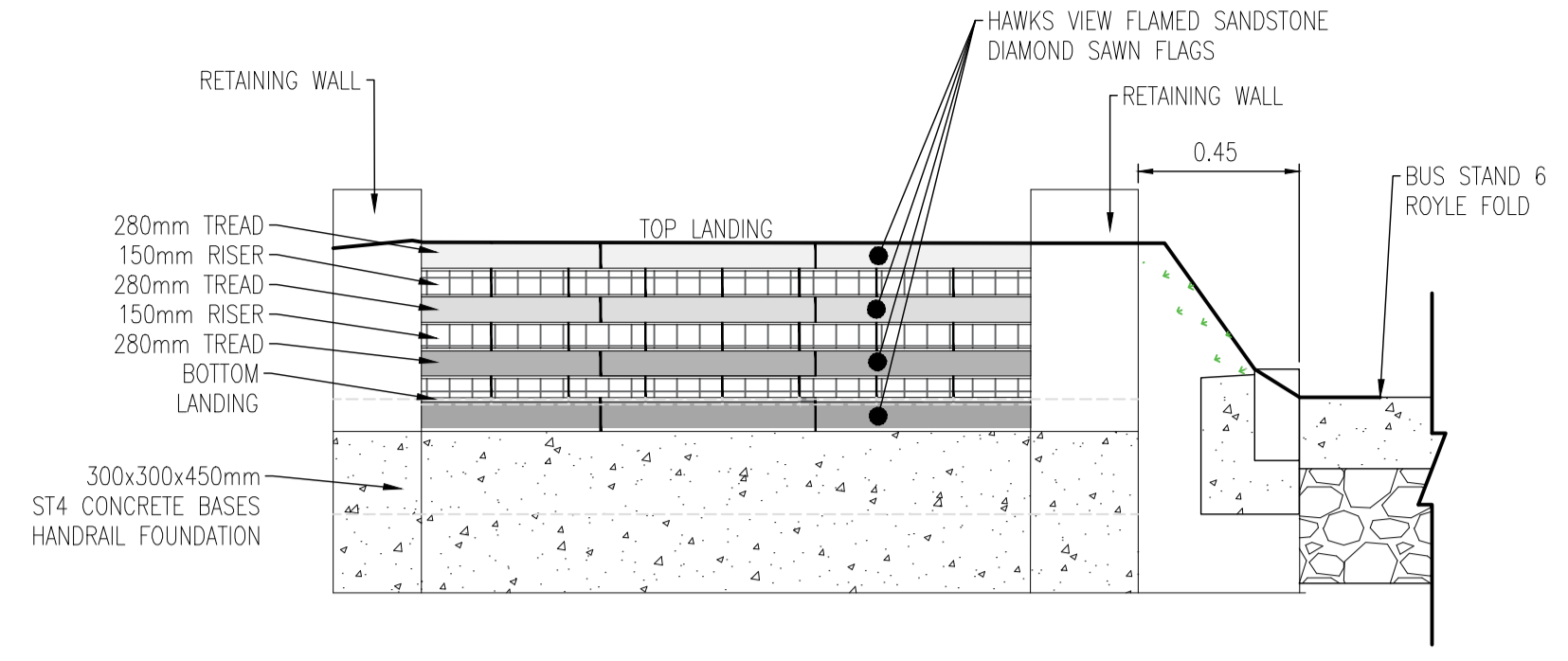

TYPICAL SECTION YARD/FLOOR GULLEY
(SCALE 1:20)
REFER TO DWG
TCF-WSP-KIR-HECK-DR-CH-0500

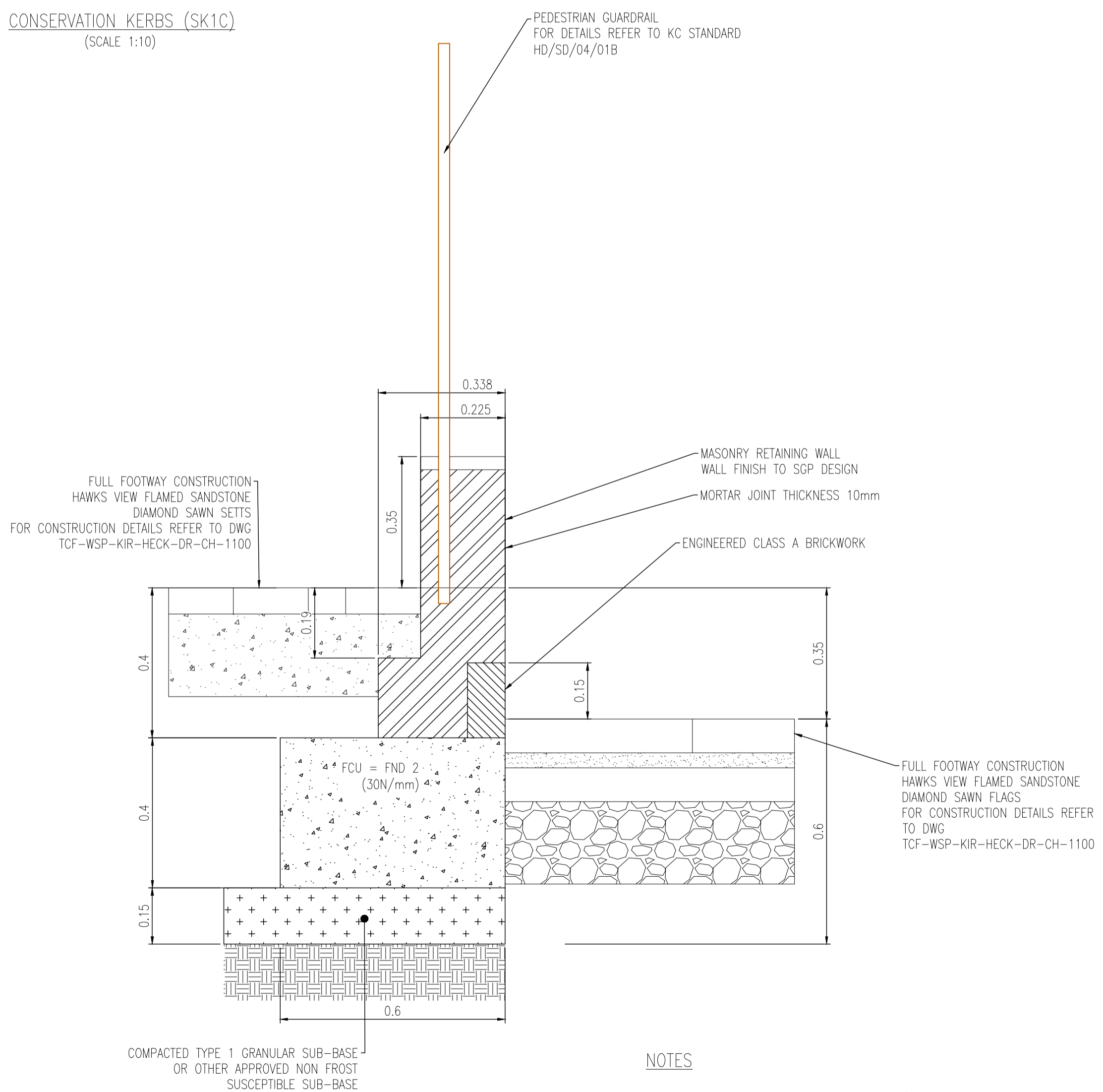

RETAINING WALL
(SCALE 1:10)
HEIGHT IS SUBJECT TO CHANGE
REFER TO DWG TCF-WSP-KIR-HECK-DR-CH-0400

NOTES

1. MINIMUM CRUSHING STRENGTH 20N/mm² FOR BRICKS
2. MORTAR MIX TO BE CLASS 1 EXPOSED FACES TO BE POINTED
3. BRICKWORK TO BE ENGLISH BOND
4. 50mm BLINDING OF ST2 CONCRETE IS REQUIRED TO SEAL GROUND UNDER FOUNDATIONS

UNTIL TECHNICAL APPROVAL HAS BEEN OBTAINED FROM THE RELEVANT LOCAL AUTHORITIES OR STATUTORY BODIES, IT SHOULD BE UNDERSTOOD THAT ALL DRAWINGS ARE ISSUED AS PRELIMINARY AND NOT FOR CONSTRUCTION. SHOULD THE CONTRACTOR AND / OR EMPLOYER COMMENCE WORK PRIOR TO APPROVAL BEING GIVEN, IT IS ENTIRELY AT THEIR OWN RISK

PO2	17/05/2024	CC	UPDATED IN LINE WITH KIRKLEES COUNCIL TECHNICAL REVIEW	SC	DB
P01	23/06/2023	CC	FIRST ISSUE	SC	DB
REV	DATE	BY	DESCRIPTION	CHK	APP

DRAWING STATUS: S2 - FOR INFORMATION

3 Wellington Place, Leeds, LS1 4AP, UK
T+ 44 (0) 113 395 6200, F+ 44 (0) 113 395 6201
wsp.com

CLIENT: KIRKLEES COUNCIL

ARCHITECT: SGP

SITE/PROJECT: HECKMONDWIKE BUS STATION RIBA 4

TITLE: TYPICAL SECTIONS

SCALE @ AT:	CHECKED:	APPROVED:
AS SHOWN	SG	DB

PROJECT NO:	DESIGNED:	DRAWN:	DATE:
70097732	CC	CC	May 24

DRAWING NO:	REV:
TCF-WSP-KIR-HECK-DR-CH-1101	P02

© WSP UK Ltd

File name: \\UK.WSPGROUP.COM\CENTRAL_DATA\PROJECTS\70097732-HECKMONDWIKE BS-RIBA4\03-IMPACT\CIVIL\ENGINEERING\03-DRAWINGS\TCF-WSP-KIR-HECK-DR-CH-1101.DWG, printed on 20 May 2024 14:53:30, by Cooper, Chris