

Do not scale from this drawing. Studio Gedye must be notified immediately should any discrepancies be found. The contractor must check all dimensions on site before construction or manufacture of materials. This drawing or any portion of it may not be reproduced without the consent of Studio Gedye.

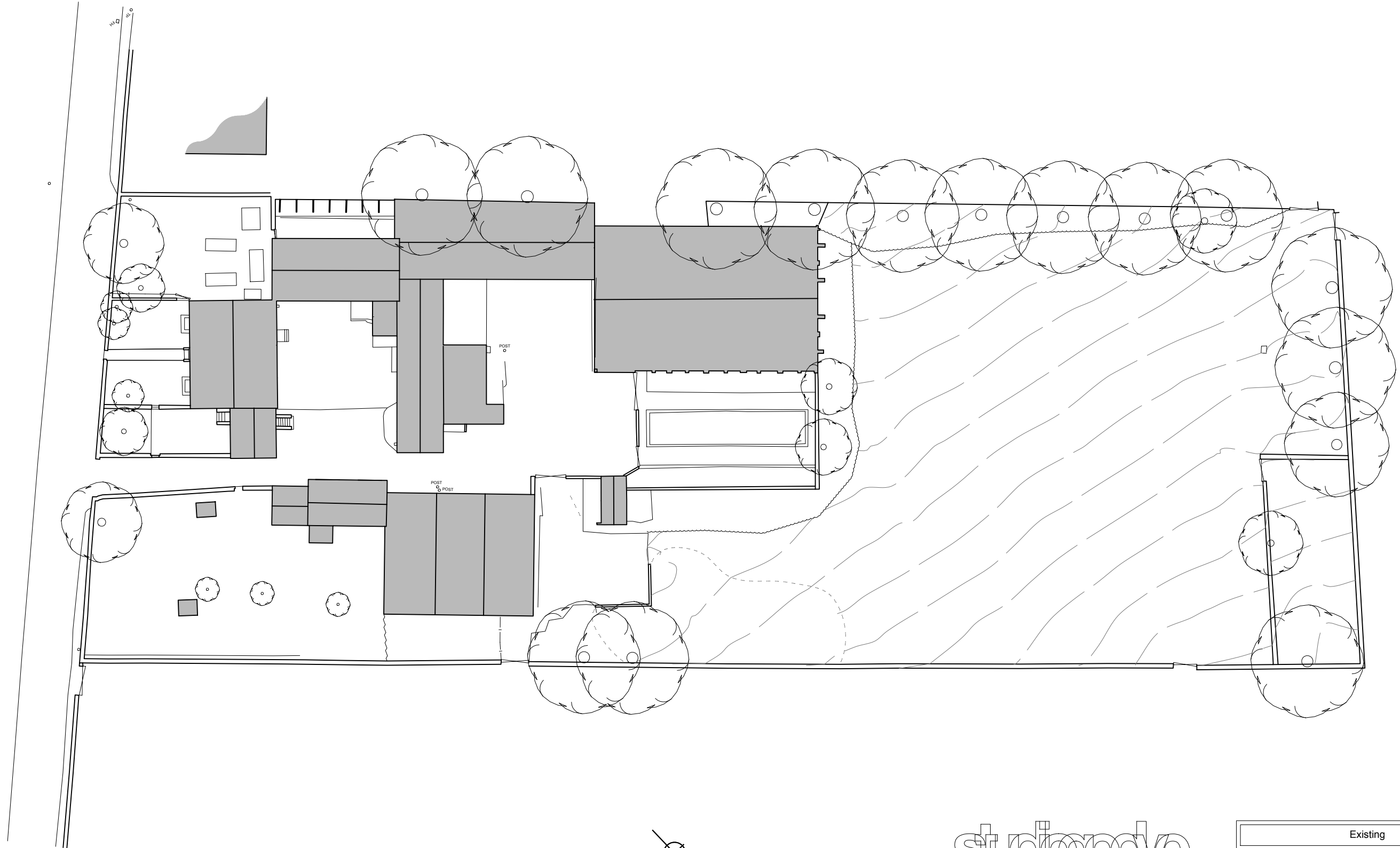

studiogedye  
architecture and design

The Studio  
2 Bank View  
Main Road  
Hathersage  
Derbyshire  
S22 1BB  
T : 01433 669461 / 0791 253 4372  
E : sgedye@mac.com

Project  
Oldfield Road, Honley  
Holmfirth, HD9 6RL

Existing

Drawing title  
Site Masterplan

Drawn by SM	Date 17/11/21	App'd -
Drawing no 001	Project no 21030	Scale @ A3 1:500
		Rev --