

"For the purposes of Planning Consent the following applies to any copy of this drawing made by the Local Authority:
 This copy has been made by and with the authority of the person required to make the plan and drawing open to public inspection pursuant to Section 47 of the Copyright, Designs and Patents Act 1988. Unless that Act provides a relevant exception to copyright, the copy must not be copied without the prior permission of the copyright owner. If any copy is made under the authority only the whole drawing including the copyright holder's name and this notice, is to be copied."

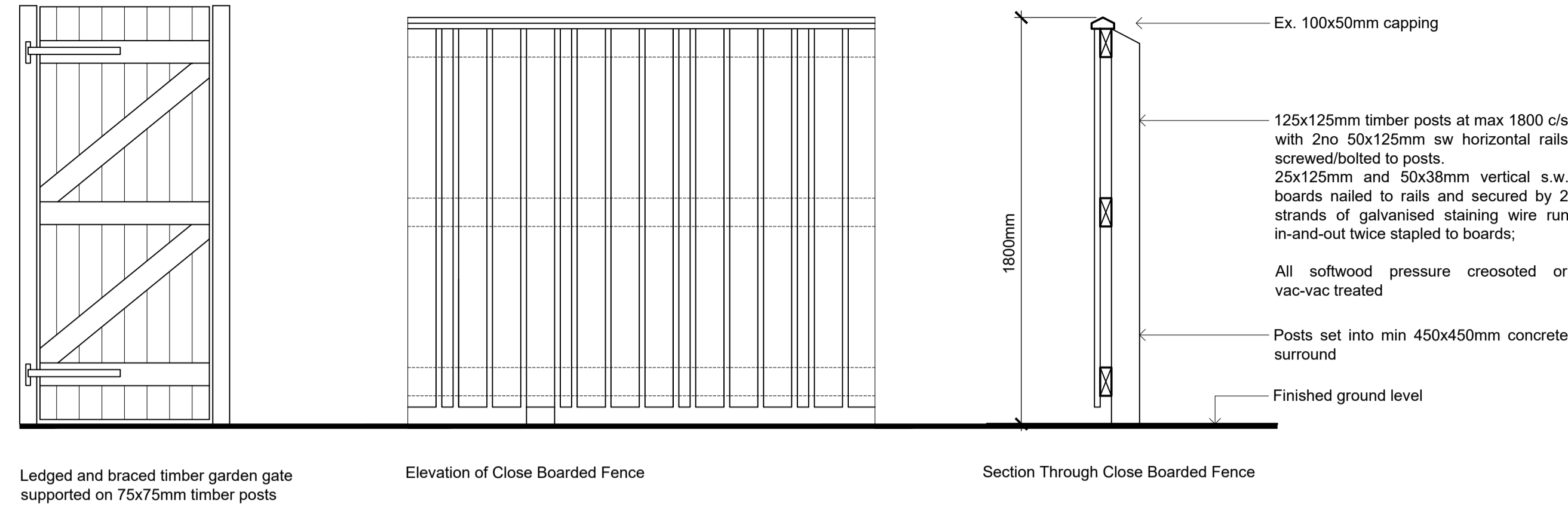

1800mm high timber hit and miss fence with gate access

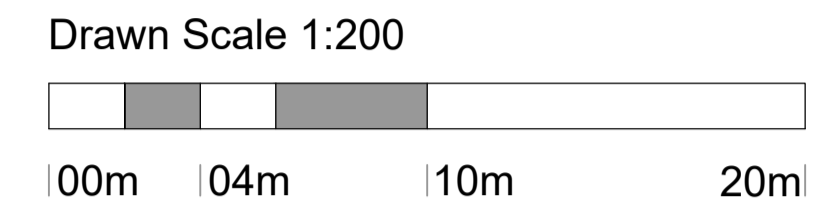
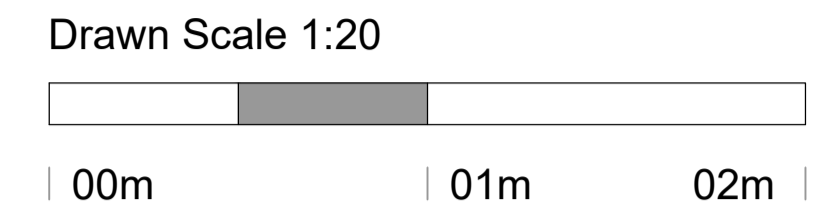

Key

PROPOSED

- █ 1800mm high timber hit and miss fence with gate access
- █ 1000mm high brick retaining wall, bricks to match with the house [Chatsworth Antique Brick]
- █ 1600mm high retaining wall with porcelaine tiled face

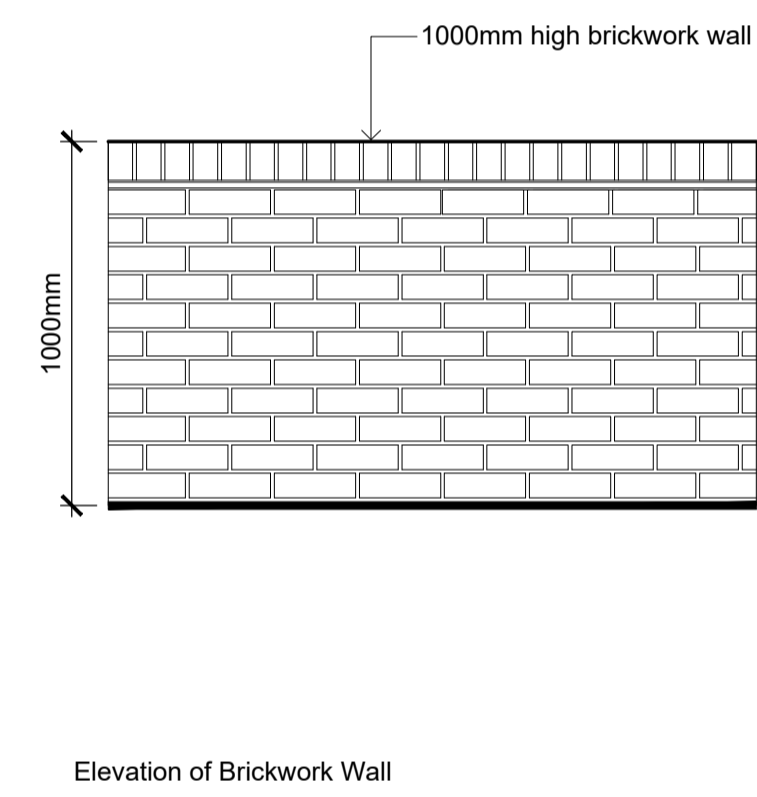
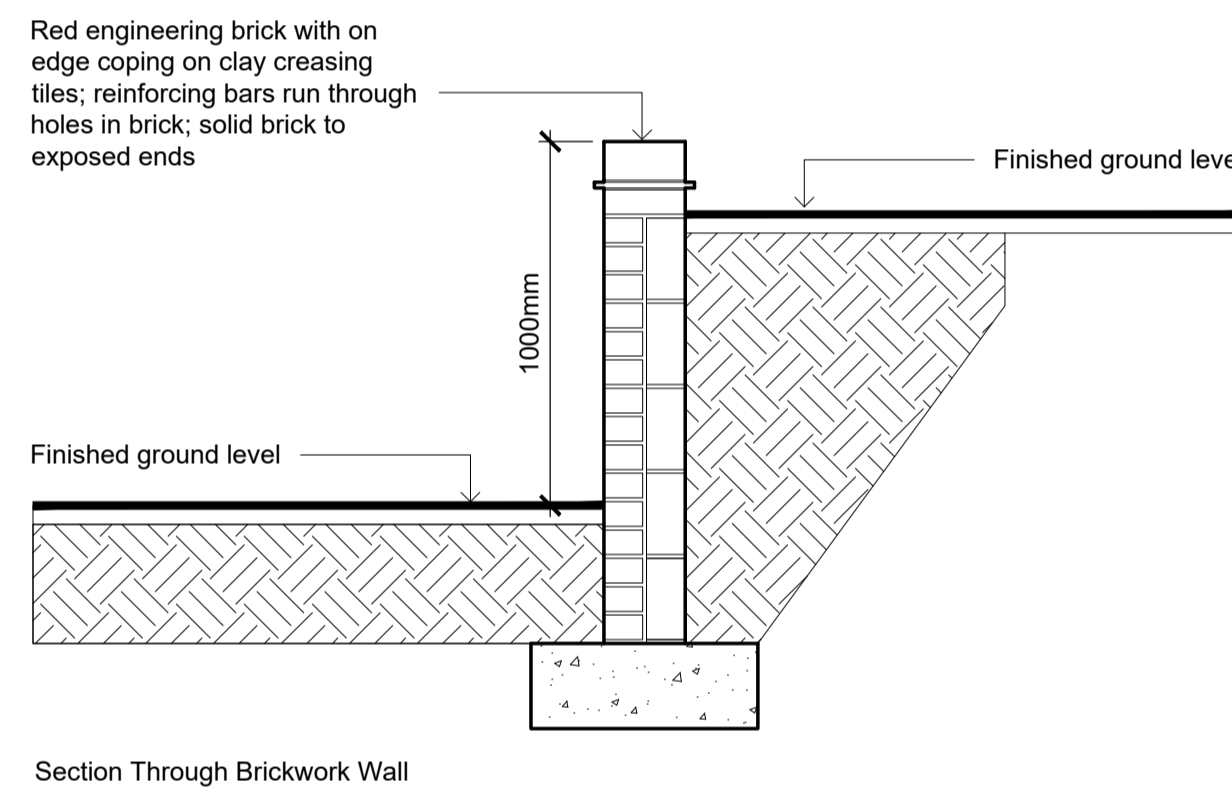

1000mm high brick wall, bricks to match with the house [Chatsworth Antique Brick]

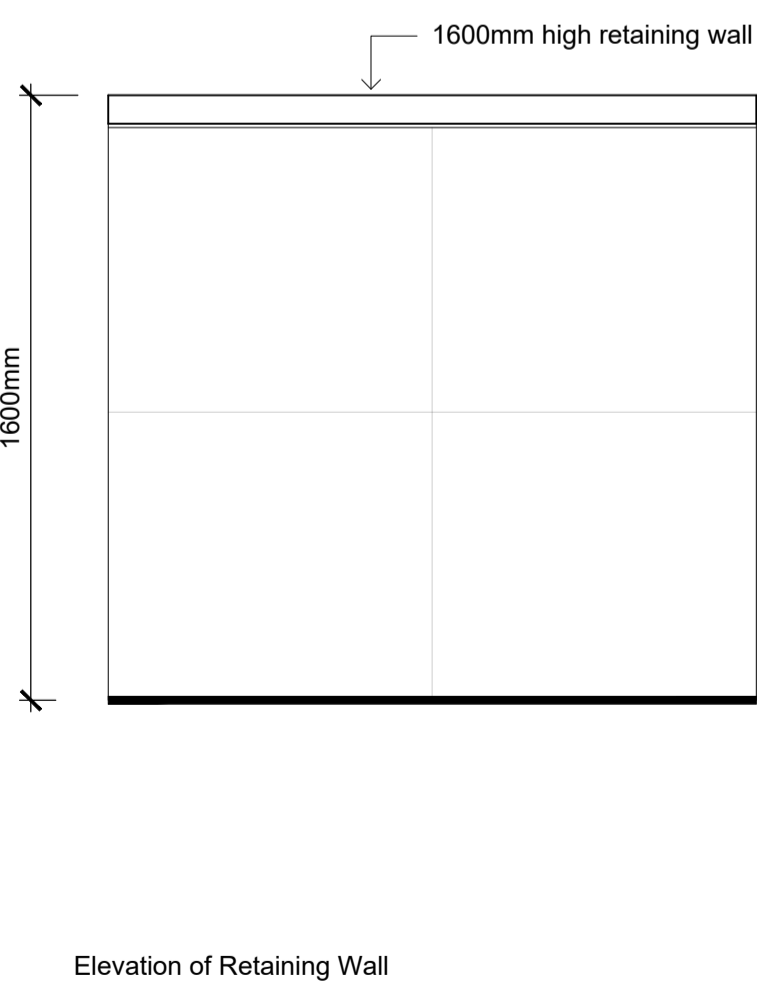
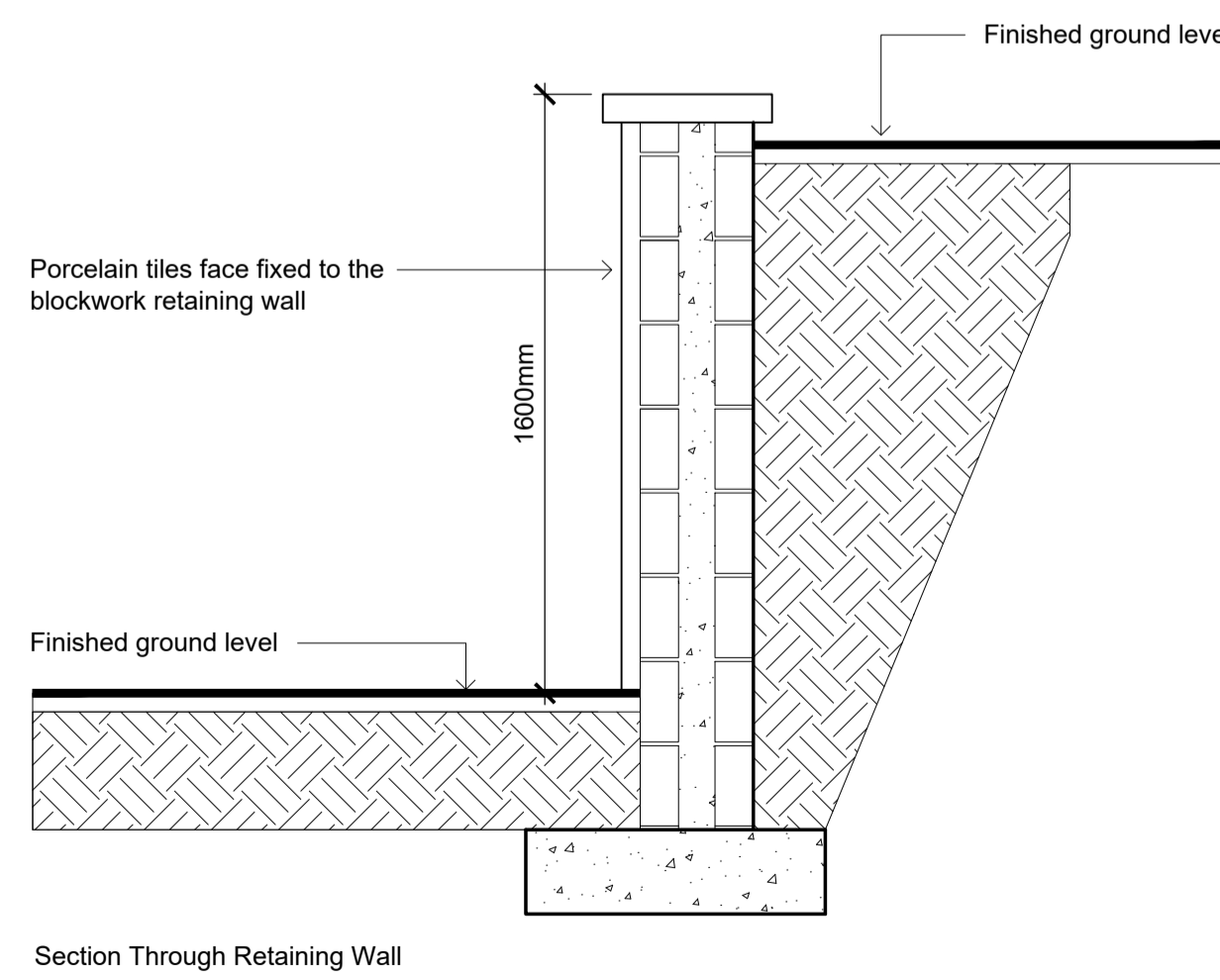

1600mm high retaining wall with porcelain tiled face

Issue Purpose: PLANNING APPLICATION

AHJ architects
 The Courtyard
 12a Commercial Road
 Skelmanthorpe
 Huddersfield
 HD8 9AA
 www.ahjarchitects.co.uk

AHJ
 architects

Client Mr Jav Mahood
 Project 2037 : 8 Heaton Road : Domestic Extension
 Title Boundary Treatment Details

Issued From
 Date May 2024
 Scale 1:20 @ A1

Drawing Number 2037 - D - 20 - 052

Revision

Do not scale from this drawing. Work to figure dimensions, and any discrepancy to be reported to the Architect.
 Refer to larger scale drawings where available.