

Site Access
Scale 1:500

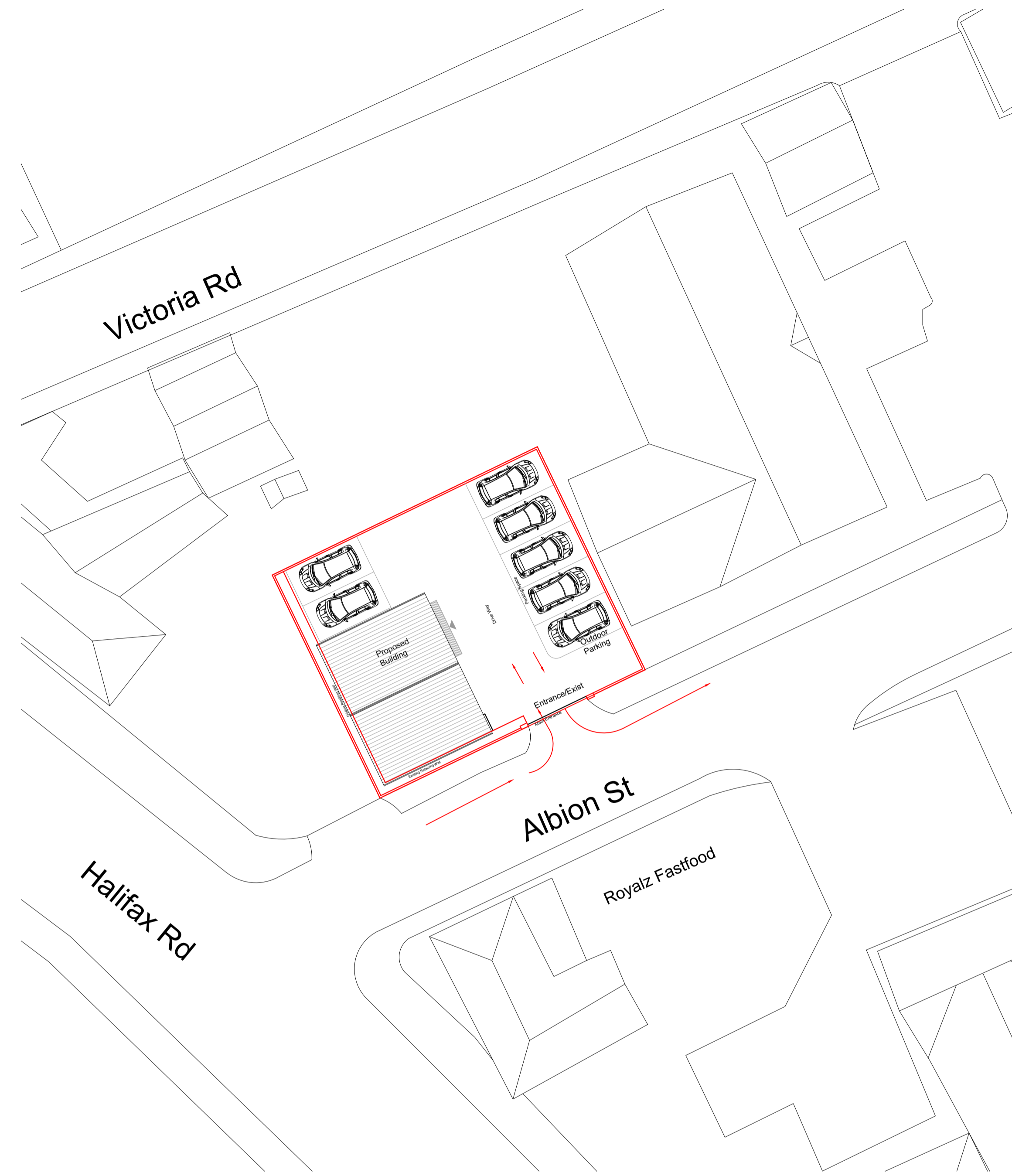

Proposed Site Plan
Scale 1:200

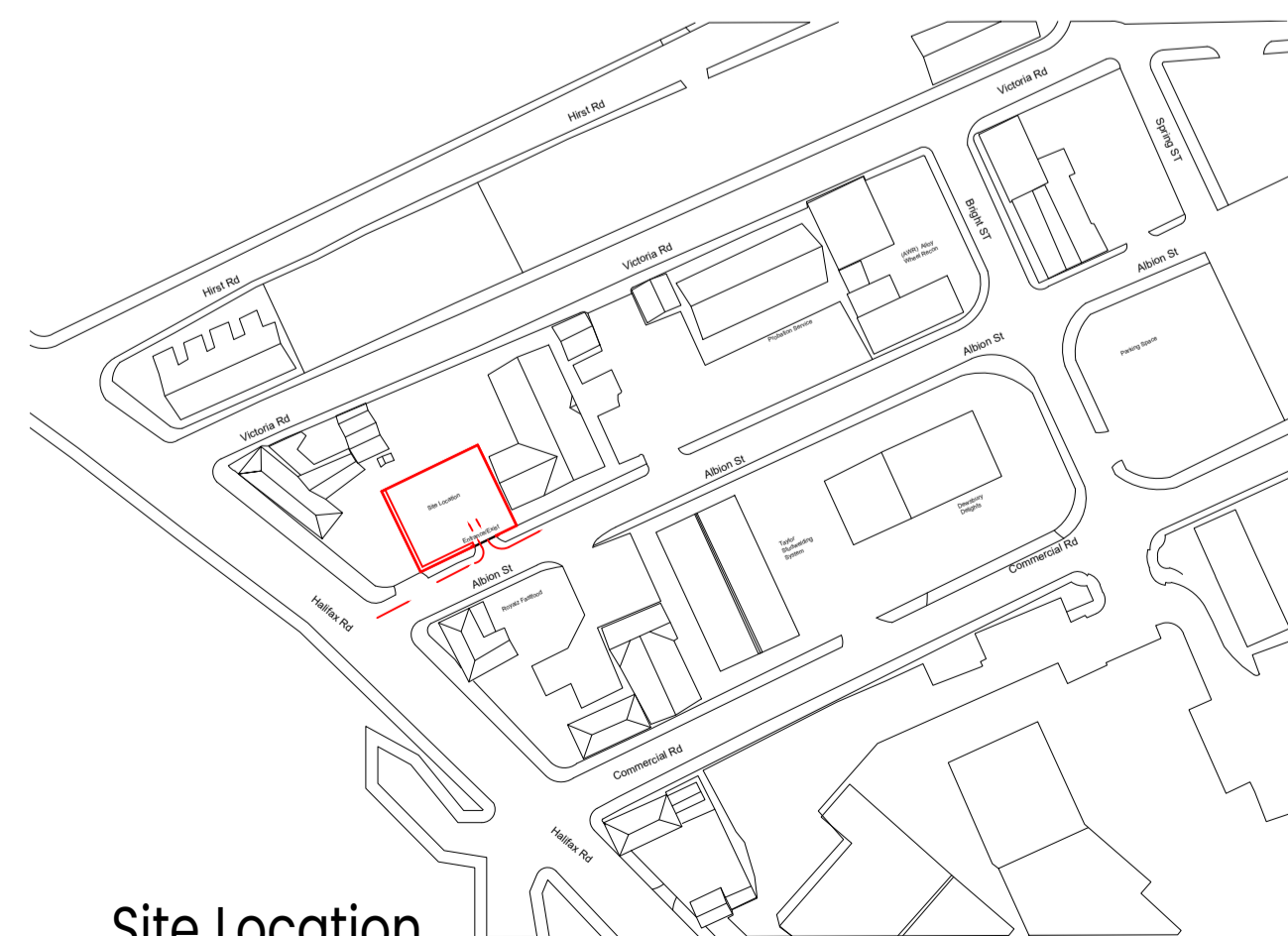

Site Location
Scale 1:1250



SITE LOCATION

NOTES :

1. All work to be carried out in accordance with current building regulations & codes of practice.
2. Do not scale the drawings.
3. All the dimensions should be verified on the site.
4. This drawing and the design is the copyright of FBS and is not to be used for any purpose without their consent.
5. The associated drawings may not be copied, lent, used by a third party or reproduced in whole or in part without express written permission of the drawing owner.

Boundary Wall

CDM Regulations - The client and the contractor must be abide by the construction design and management regulation 2015 which relate to any building works which: (a) Last longer than 30 working days and has more than 20 workers working simultaneously at any point in the project. or: (b) Exceeds 500 persons a day.

Please refer to <http://www.hse.gov.uk/pubns/indg411.htm> for guidance and compliance. for the cdm regulation the client will be employing one contractor and fbs responsibility for the project will be for the design only and does not include any project management.

REV.No.	Date	Description
01	29/08/2024	Building Material change to Brick work
02	01/10/2024	Drawings Revised
03	25/11/2024	Drawings Revised

CLIENT

Mr. Zubair Ramzan



PROJECT NAME

Albion Street WF13 2AJ

DRAWING TITLE

Location & Site Plan

DRAWN BY/ CHECKED BY

MR/FY

PHASE	SCALE	SHEET NO.	PROJ.NO.
Planning Application	Varies © A1	AR-03	C24019