



60%

- Adexa Commercial Chimney Extraction Canopy ref: SSCH1A

A stunning addition to any kitchen, this chimney extraction hood is constructed of stainless steel and ensures a contemporary commercial kitchen look.

Complete with 3 layer aluminium filters, a powerful extraction motor, lighting and control panel on the front.

- Chimney style
- Stainless steel extraction hood
- 3 speed
- Button control
- 165W
- 2 pcs 1.5w LED light
- 2pcs 3 layer aluminium filters
- Airflow: 600m3/h



Save 22%

C

- Polar G-Series Saladette Counter Fridge 240Ltr

Nisbets



Save 20%

D

- Polar G-Series Counter Freezer Single Door 88Ltr GN1/1



Save 20%

- Lincat Single Tank Single Basket Countertop Electric Fryer LSF



- Parry PEO1871 Electric Oven with Four Hob Fitted Top

**Description** Product Details About Parry Promotions & Discounts

**Parry PEO1871 Description**

- **PEO (Oven) Features include:**
  - Temperature control with a thermostat that regulates the maximum temperature of 250°C
  - Triple glass door consisting of 1 layer thermoplastic glass and 2 other layers of glass designed to reduce temperature on the outside face of the door
  - Internal glass door fitted with a silicone seal and forms a single unit with the inner door
  - Door fitted with new screw-less safety hinge
  - New safety hinge is also much easier to clean and keep clean
  - Door cooling fan provides a stream of cool air to flow across the door outside and door handle
  - Replaceable rubber door seal
  - Smooth internal cavity for easy cleaning
  - 2 wire shelves 459 x 360mm as standard
  - 3 rack positions
  - Green indicator light to show is on
- **1871 (Hob) Features include:**
  - Indented top to collect spillages
  - Fully sealed hot plates
  - Controlled by a 6 position heat control with 3 boiling and 3 simmering positions
  - Each hot plate is thermally protected and will automatically reduce their heat output when pans are removed improving efficiency and safety
  - Both units are manufactured from high quality stainless steel for extra strength
  - External Dimensions: 950(H) x 600(W) x 620(D)mm
  - Internal Dimensions: 330(H) x 460(W) x 400(D)mm
  - Capacity: 62 Litre / 2.3 Cu.Ft.
  - 2.9kW Plugged Electric Oven
  - 700W Hard Wired N1871 Hob
  - Weight: 57 KG
  - 3 year full warranty



- Example of extract grille.  
Approx size: 150x150mm

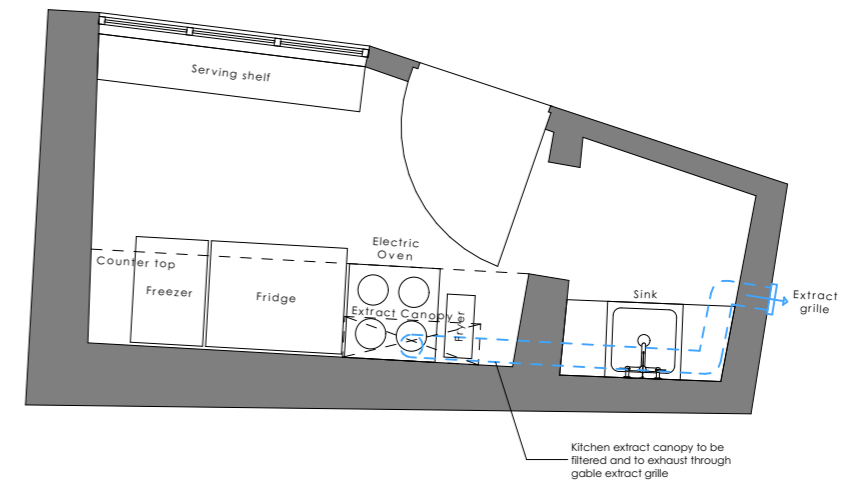

Client: **MR R. WRAY.**

Project: **CHANGE OF USE TO, REAR OF, 17 VICTORIA SQUARE, HOLMFIRTH**

Drawing: **KITCHEN LAYOUT & EQUIPMENT.**

Project No:	Drawing No:	Scale:	Date:	Drawn by:	Checked by:
1811	00_02_R01	1:50	MAY '24	AM	—

Address updated, Extract R01 grille shown	SH	14/05/2024
---	----	------------

Rev	Description	Drw	Chk	Date
-----	-------------	-----	-----	------



Wake Morley Architects

tel 01484 681755 e enquiry@wakemorleyarchitects.com  
1 Dunford Road, Holmfirth, West Yorkshire HD9 2DP