

The drawing is copyright © Eight One Two Architects Ltd. If in doubt... ASK.  
 Drawing measurements shall not be obtained from scaling from the drawing. All dimensions are to be site verified prior to construction. Any discrepancies are to be reported to Eight One Two Architects Ltd immediately. This drawing is to be read in conjunction with all associated drawings and specifications including all relevant sub-consultants information.

Notes

## PLANNING

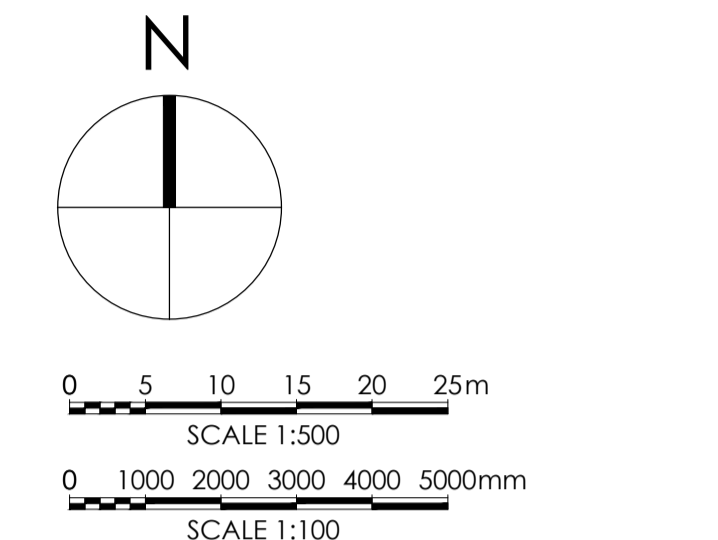

**Note:**  
 Surrounding contextual buildings and information are based on received ordinance survey drawings and are shown for illustrative purposes only. assumed site boundary is subject to confirmation legal confirmation

**Note:**  
 Information is based on OS map and received information and is subject to full topographical survey. Assumed site boundary and site constraints subject to legal confirmation. All Legal easements and extent of existing underground services locations are subject to confirmation.

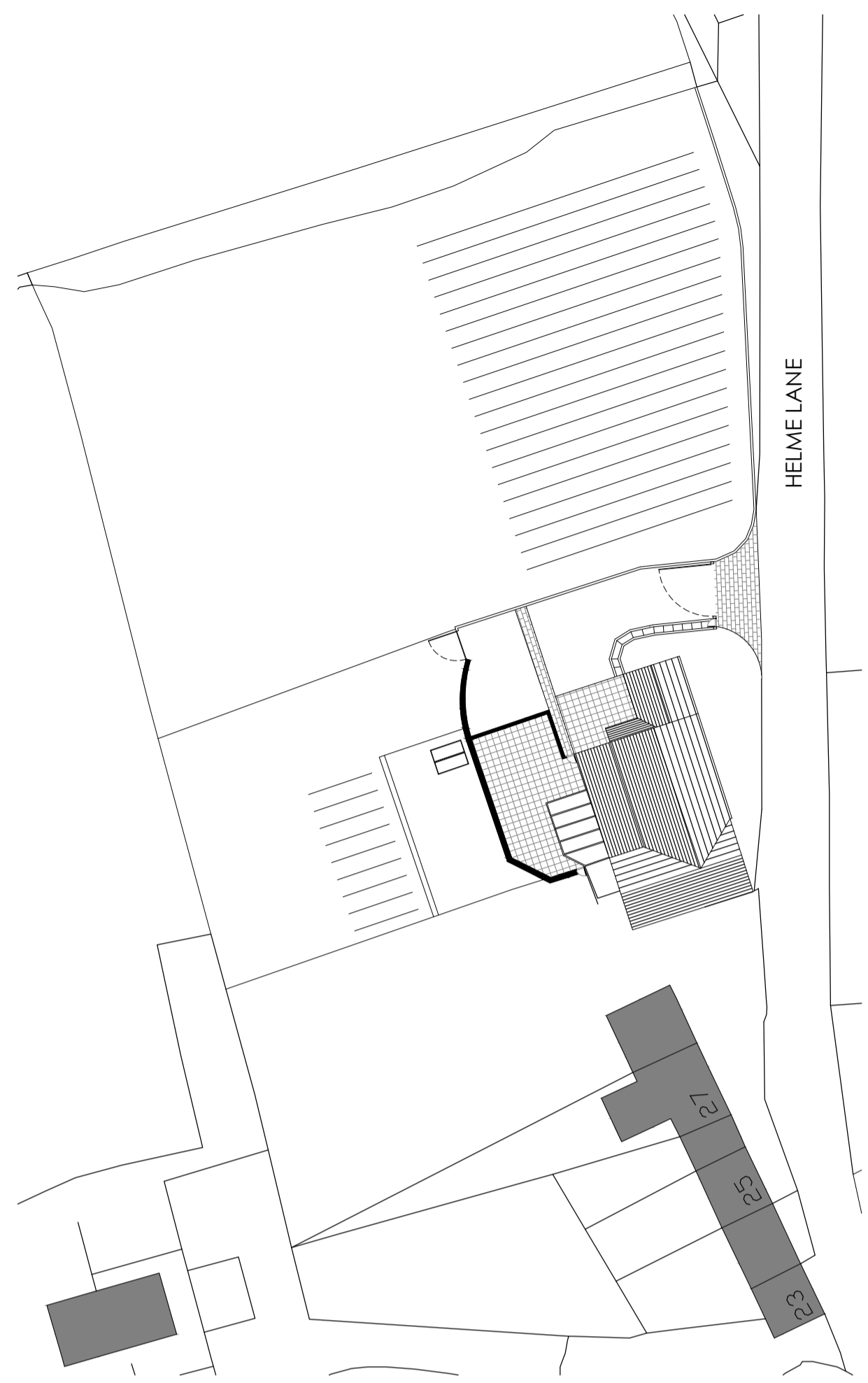

LOCATION PLAN  
 AS PROPOSED  
 0 5 10 15 20 25m  
 SCALE 1:500

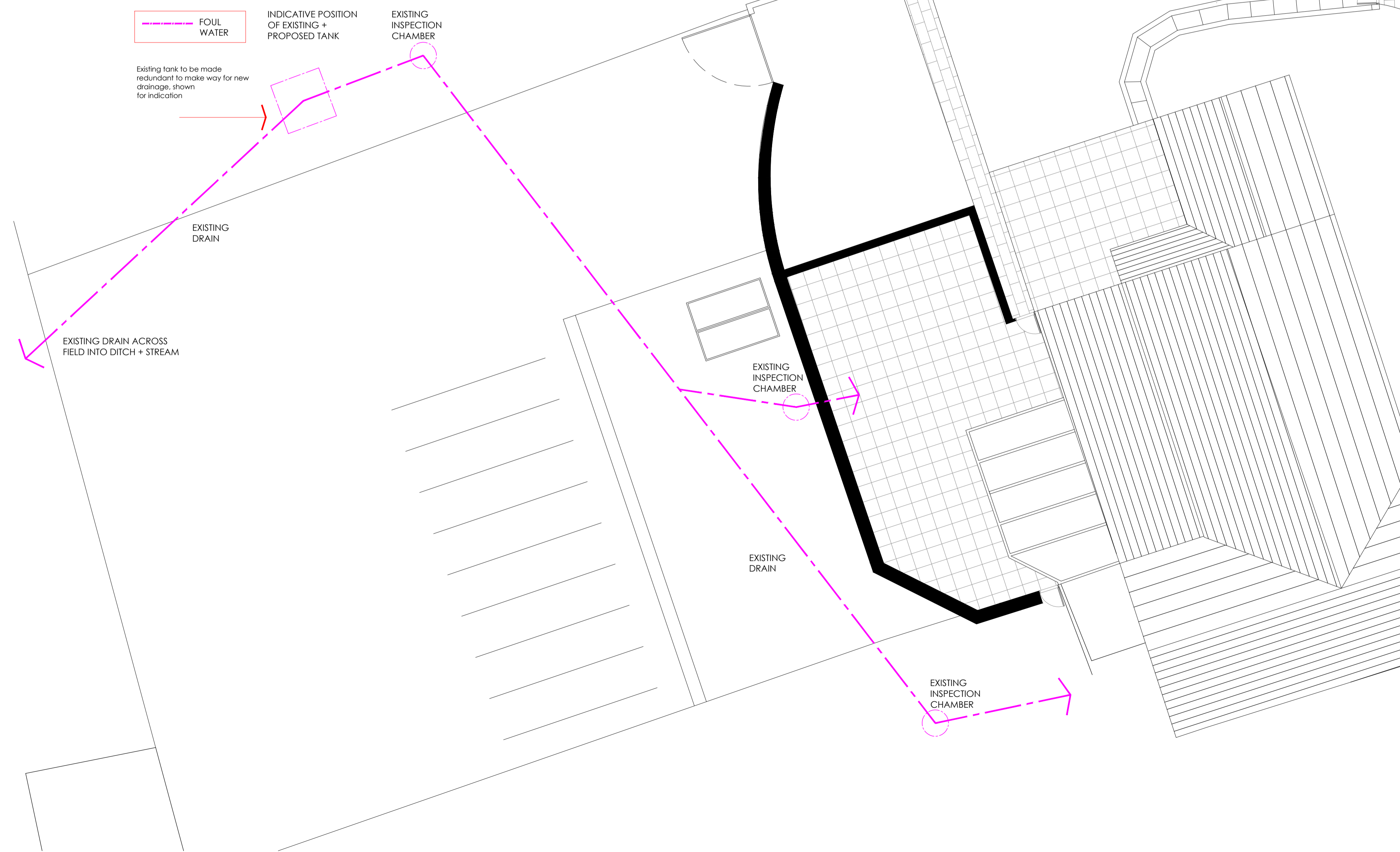

DRAINAGE SITE PLAN  
 AS PROPOSED  
 0 1000 2000 3000 4000 5000mm  
 SCALE 1:100

Rev. Date. Amendment. By. April

# Eight OneTwo Architects

Tel. +44 (0)7761 570735  
 Email. mail@eightonetwo.co.uk  
 www.eightonetwo.co.uk  
 Studio A5, Brooke's Mill, Armitage Bridge, Huddersfield, HD4 7NR

Drawing Status\_  
 PLANNING

Client\_  
 MR + MRS CALDER

Project\_  
 PROPOSED ANCILLARY BUILDING, HELME EDGE FARM, HELME LANE

Drawing Title\_  
 AS PROPOSED, DRAINAGE PLAN + LOCATION PLAN

Drawing Scale\_  
 1:500 1:100

Drawn By\_  
 Jcl

Checked By\_  
 Jcl

Paper Size\_  
 A1

Drawn Date\_  
 FEB 2024

Checked Date\_  
 APRIL 2024

Drawing Number\_  
 23\_811 105