

The drawing is copyright © Eight One Two Architects Ltd. If in doubt... ASK.
Drawing measurements shall not be obtained from scaling from the drawing. All dimensions are to be site verified prior to construction. Any discrepancies are to be reported to Eight One Two Architects Ltd immediately. This drawing is to be read in conjunction with all associated drawings and specifications including all relevant sub-consultants information.

Notes

PLANNING

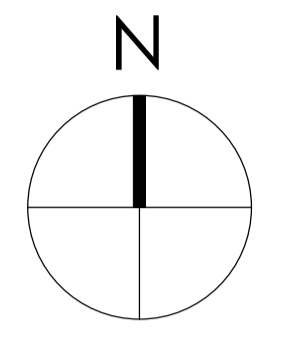

0 1000 2000 3000 4000 5000mm
SCALE 1:100

Note:
Surrounding contextual buildings and information are based on received ordinance survey drawings and are shown for illustrative purposes only. assumed site boundary is subject to confirmation to legal confirmation

Note:
Information is based on OS map and received information and is subject to full topographical survey. Assumed site boundary and site constraints subject to legal confirmation. All legal easements and extent of existing underground services locations are subject to confirmation.

Note:
Service vehicle access will occur during out of operation hours only.

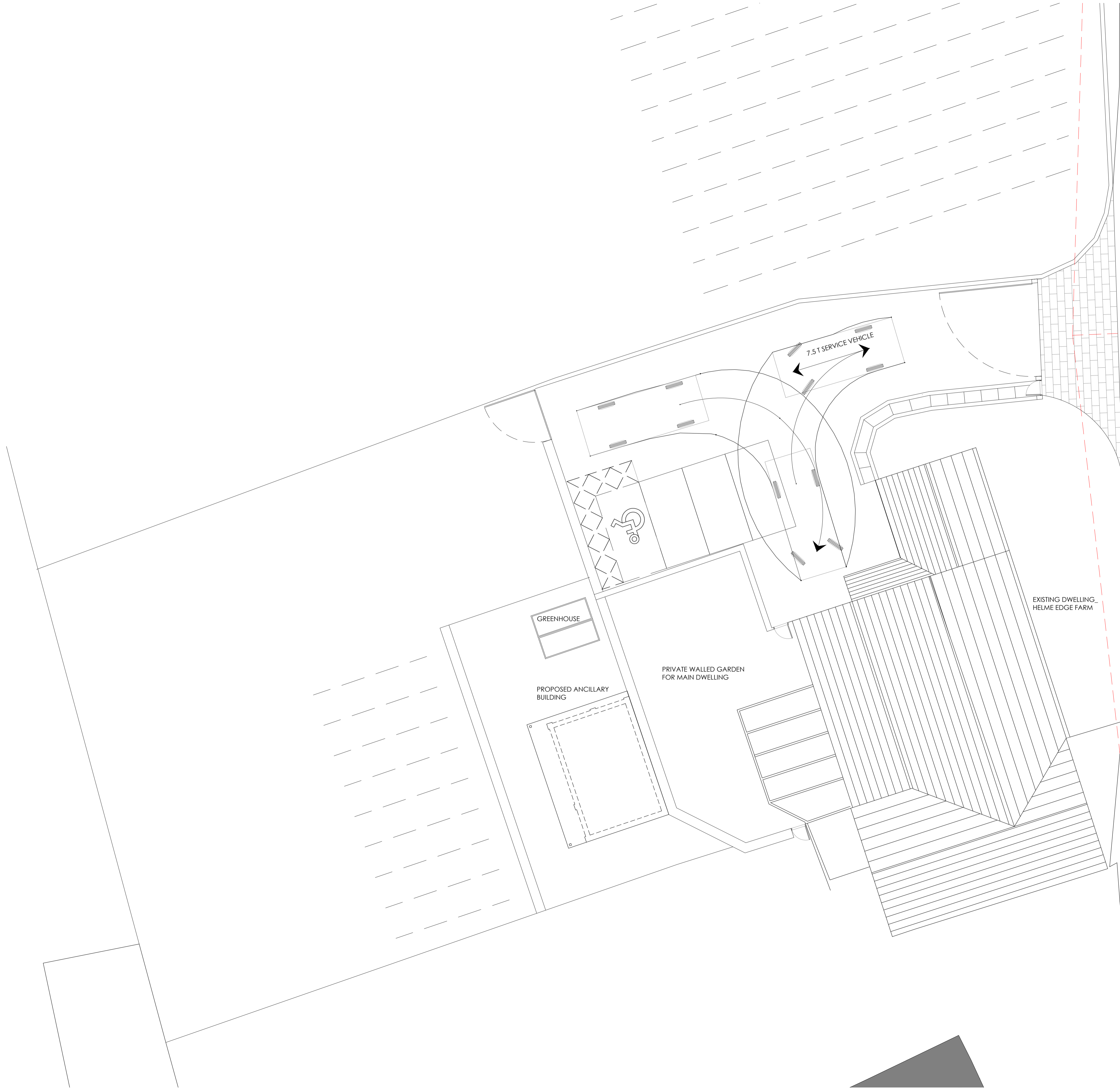

EXISTING BOUNDARY WALL LOWERED TO AROUND 600mm TO ALLOW FOR VISIBILITY SPLAYS. TBC BY HIGHWAYS [2.4m x 70m]

HARRISON LANE

Rev. Date. Amendment. By. Appd.

Eight OneTwo Architects

Tel. +44 [0]7761 570735
Email. mail@eightonetwo.co.uk
www.eightonetwo.co.uk
Studio A5, Brooke's Mill, Armitage Bridge, Huddersfield, HD4 7NR

Drawing Status
PLANNING

Client
MR + MRS CALDER

Project
PROPOSED ANCILLARY BUILDING, HELME EDGE FARM, HELME LANE

Drawing Title
A5 PROPOSED, SERVICE VEHICLE SWEEP PATH PLAN

Drawing Scale 1:100 Drawn By Jcl Checked By Jcl

Paper Size A1 Drawn Date FEB 2024 Checked Date FEB 2024

Drawing Number 23_811_104