



YW REF: H-3-264-956

DO NOT SCALE

DESIGNERS HAZARD IDENTIFICATION

IT IS ASSUMED THAT ALL WORKS WILL BE UNDERTAKEN BY A COMPETENT CONTRACTOR WORKING UNDER THE SUPERVISION OF AN APPROVED METHOD STATEMENT. IN ADDITION TO THE HAZARDS TYPICALLY ASSOCIATED WITH THE TYPES OF CONSTRUCTION SET OUT ON THIS DRAWING, ANY KNOWN ABNORMAL HAZARDS SPECIFIC TO THIS DRAWING HAVE BEEN IDENTIFIED.

ABNORMAL HAZARD REFERENCE

- THIS DRAWING IS BASED FROM:
 - 1.1. TOPO SURVEY - 2456001 (MAR 21)
 - 1.2. ARCHITECT LAYOUT - 2156.01 K (12/01/23)
- DO NOT SCALE FROM THIS DRAWING AS IT MAY NOT BE REPRODUCED TO SCALE.
- THIS DRAWING IS TO BE REPRODUCED IN COLOUR.
- PLEASE REPORT ANY DISCREPANCIES TO DUDLEYS CONSULTING ENGINEERS PRIOR TO CONSTRUCTION.

- KEY
- PROPOSED SW PRIVATE DRAIN
 - PROPOSED PW PRIVATE DRAIN
 - PROPOSED SW PRIVATE PIPIC
 - PROPOSED PW PRIVATE PIPIC
 - PROPOSED SW PRIVATE YARD GULLY
 - PROPOSED SW PRIVATE CHANNEL DRAIN
 - PROPOSED SW PRIVATE ROOFING EYE

YORKSHIRE WATER GENERAL NOTES

- ALL ADAPTABLE SEWER WORKS AND MATERIAL TO BE IN ACCORDANCE WITH SEWERAGE SECTOR GUIDANCE DESIGN AND CONSTRUCTION GUIDANCE (CODE FOR ADOPTION) THE RELEVANT BRITISH/EUROPEAN AND YORKSHIRE WATER'S STANDARDS/REQUIREMENTS/LOCAL PRACTICE FOR THE ADOPTION OF SMALL SUBURBIBLE TOWN AND SURFACE WATER PUMPING STATIONS AND KITEMARKED.
- MANHOLE COVERS SHALL HAVE A CLEAR OPENING OF 600MM AND SHALL BE CLASS D400 TO BS EN 124 WITH 150MM DEEP FRAMES IN HIGHWAYS.
- FILLED GROUND MUST BE FILLED AND CONSOLIDATED UNDER THE SUPERVISION AND TO THE SATISFACTION OF YORKSHIRE WATER BEFORE ANY SEWER WORKS ARE CARRIED OUT.
- YORKSHIRE WATER IS NOT OBLIGED TO ACCEPT FILTER DRAIN/LAND DRAINAGE RUN-OFF INTO THE PUBLIC SEWER NETWORK OR ACCEPTABLE DRAINAGE SYSTEM (DIRECTLY OR INDIRECTLY). AN ALTERNATIVE METHOD OF DISPOSAL OF THE LAND DRAINAGE RUN-OFF WILL THEREFORE BE REQUIRED AND YOU WILL HAVE TO LIAISE WITH THE LOCAL AUTHORITY. LAND DRAINAGE SECTION WITH REGARD TO THE DISPOSAL OF THE FILTER DRAIN/LAND DRAINAGE RUN-OFF.
- THE ADAPTABLE SEWERS SHOULD BE A MINIMUM OF 1M AND MANHOLES 0.5M FROM KERB FRAMES AND SERVICE MARGINS.
- SEWERS MUST HAVE 5 METRES CLEARANCE FROM TREES AND HEDGES OR THE WIDTH OF THE CANOPY AT MATURE HEIGHT.
- SEWERS TO BE LAID IN CLASS "S" BEDDING (150MM GRANULAR BED AND SURROUND) WHERE DEPTH OF COVER TO TOP OF THE SEWER IS LESS THAN 1.2M IN HIGHWAYS AND VERGES OR LESS THAN 900MM IN NONE VEHICULAR ACCESS AREAS THEN A CONCRETE SLAB SHOULD BE PROVIDED ABOVE GRANULAR BED AND SURROUND.
- BEDDING AND BACKFILL MATERIAL TO CONFORM TO THE REQUIREMENT OF WATER INDUSTRY SPECIFICATION 4-08-02 (TABLE A2).
- YORKSHIRE WATER POLICY IS THAT TYPE "C" BRICK MANHOLES AND 1000MM DIA. MANHOLE RINGS ARE NOT PREFERRED. INSTEAD IT IS PREFERRED THAT YOU USE A TYPE "B" MANHOLE WITH 1200MM DIA OR 1500MM DIA RINGS. WITH THE OPENING SIZED OVER THE CHANNEL WHERE DEPTH OF COVER TO PIPE SOFFIT IS 1 - 1.5M.
- ADAPTABLE PLASTIC SEWER PIPES TO BE BS1 KITEMARKED (CERTIFIED TO WS4-35-01 AND BS EN 13476). ADAPTABLE PLASTIC SEWER PIPES TO BE LAID IN MAXIMUM 3 METRE LENGTHS UNLESS THERE IS A SPECIFIC OPERATIONAL NEED TO LAY LONGER LENGTHS. PLASTIC CHANNEL SECTIONS IN MANHOLES ARE NOT ACCEPTABLE AND YORKSHIRE WATER WOULD PREFER CLAYWARE CHANNEL IN MANHOLES.
- THE MINIMUM CRUSHING STRENGTH FOR CLAY PIPES SHOULD BE AS FOLLOWS - 1000MM DIA. 40KNM, 1500MM DIA. 40KNM, 2250MM DIA. 45KNM AND 3000MM DIA. 72KNM. THE MINIMUM CRUSHING STRENGTH FOR CONCRETE PIPES SHOULD BE - (CLASS 120 TO EN 1916/BS5911-1:2002). PLASTIC PIPES SHOULD CONFORM TO WS4-35-01 AND BS EN13476.
- WHERE A B125 COVER AND FRAME HAS BEEN APPROVED, THIS MUST NOT BE COATED IN PLASTIC AND MUST HAVE LIFTING EYES SUITABLY SIZED TO ACCOMMODATE STANDARD LIFTING KEYS. SCREW DOWN COVERS ARE NOT ACCEPTABLE.
- THERE MUST BE ENOUGH CLEARANCE AT CROSSOVERS TO ACCOMMODATE BEDDING TO BOTH PIPES. APPROX. 50MM. IF CROSSOVER IS NEAR THE ROCKER THEN THE CLEARANCE NEEDED MAY NEED TO BE INCREASED.

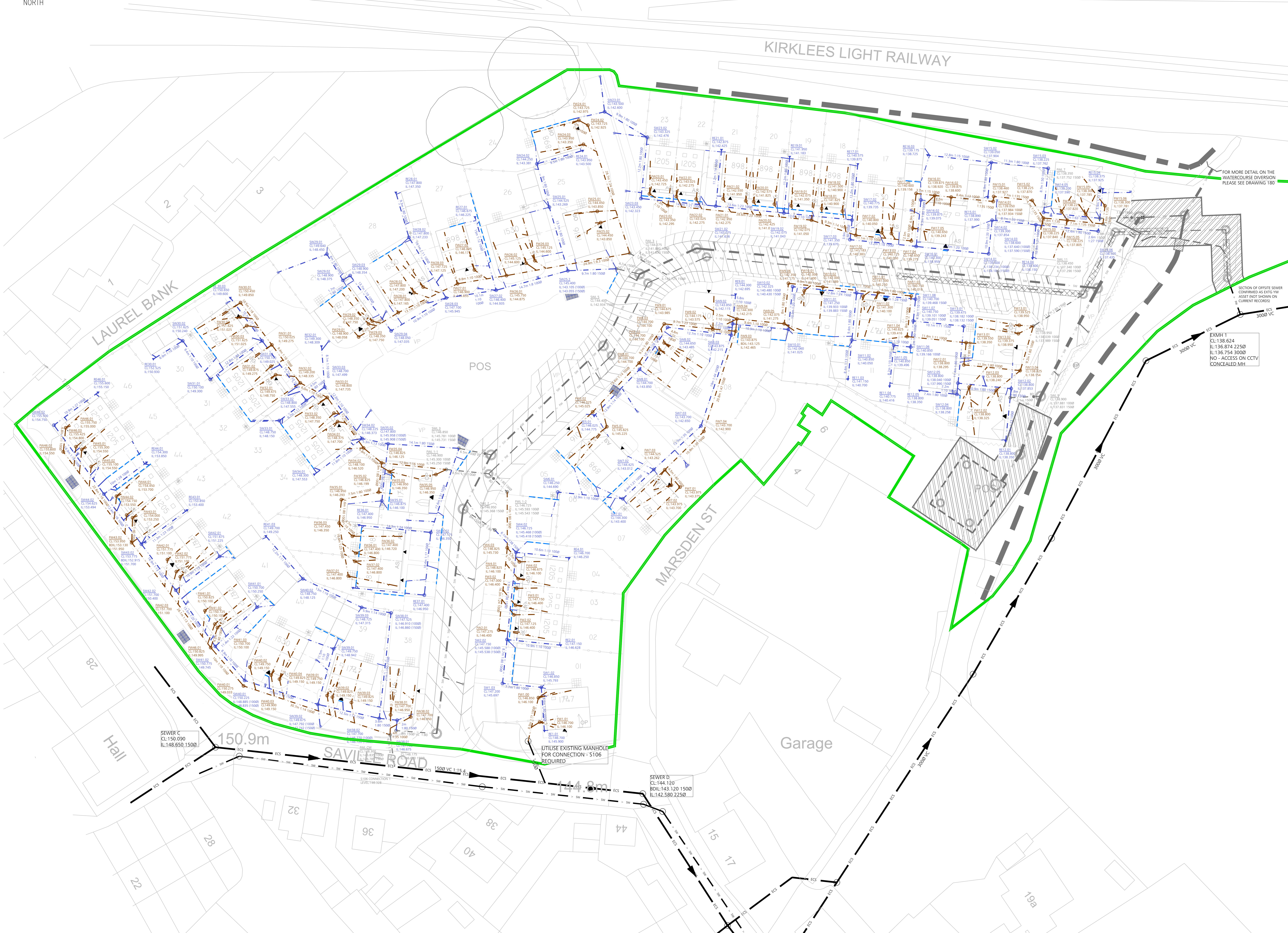

28.04.23	UPDATED TO SUIT S104 COMMENTS	MDJ	PD	P6
28.04.23	UPDATED TO SUIT S104 COMMENTS	MDJ	PD	P5
31.03.23	LINEAR DRAINS TO REAR GARDENS ADDED	MDJ	PD	P4
27.01.23	REVIEWED FOR TECH APPROVAL	MDJ	PD	P3
20.01.23	DRAINAGE LEVELLED	MDJ	PD	P2
13.01.23	PRELIMINARY ISSUE	MDJ	PD	P1
Date	Revision	By	Chkd	Ref

dudleys The House 35 Town Street Leeds LS16 8LJ T:0113 258 3611 E:info@dudleys.co.uk

Structural & Civil Consultants

Project
LOVELL HOMES
SAVILLE ROAD, SKELMANTHORPE
HD8 9EF

Title
PRIVATE DRAINAGE
LAYOUT

Scale	1:250	Page	A0	Drawn	MDJ	Check	PD
Date	JAN 23	Status	PRELIMINARY				
Job No	21374	Drp. No.	110	Rev.			P6