

rev	details	by	date
P01	STAGE 4 FIRST ISSUE	RK	21.09.2022
P02	VE UPDATES - METAL SCREEN REMOVED, HEDGING ADDED. STONE CLADDING TO RETAINING WALL REMOVED	RK	10.10.2023
P03	RETAINING WALL THICKNESS UPDATED	RK	30.04.2024
P04	COPING STONE WIDTH UPADTED TO BAM'S REQUEST	RK	02.05.2024
P05	COPING STONE WIDTH UPADTED TO BAM'S REQUEST	SVU	29.06.2024
C01	ISSUED FOR CONSTRUCTION	SVU	03.09.2024

Notes

1.0 Do not scale from drawing, use figured dimensions only
1.1 All dimensions to be checked onsite
1.2 This drawing to be read in conjunction with all other Gillespies drawings and specifications

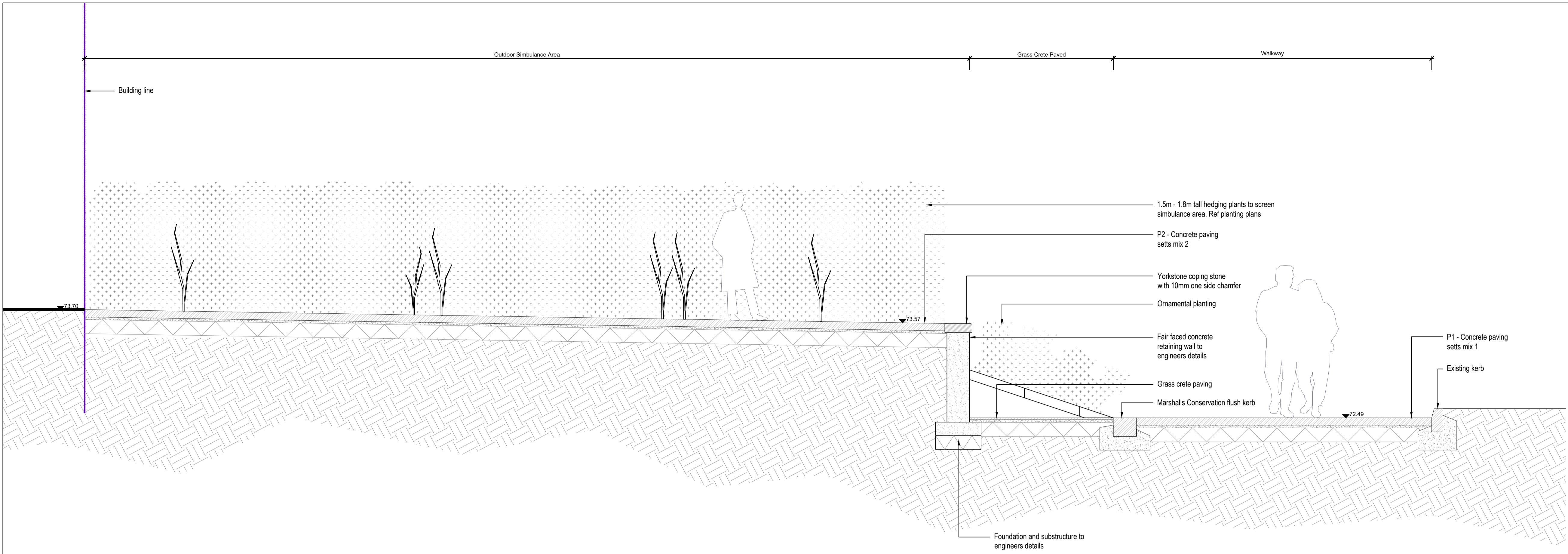
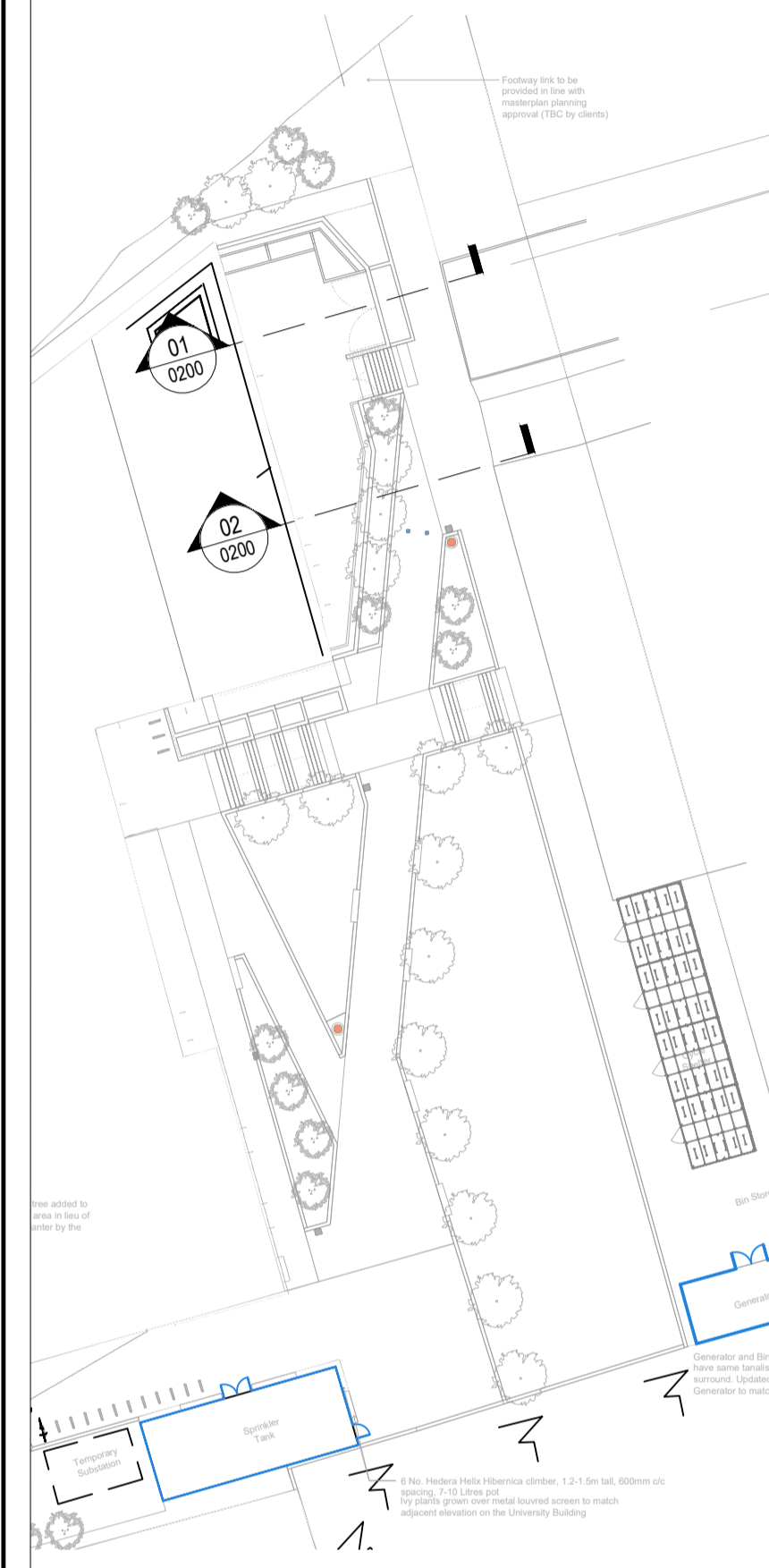

SECTION 01
Scale 1: 25 @A1

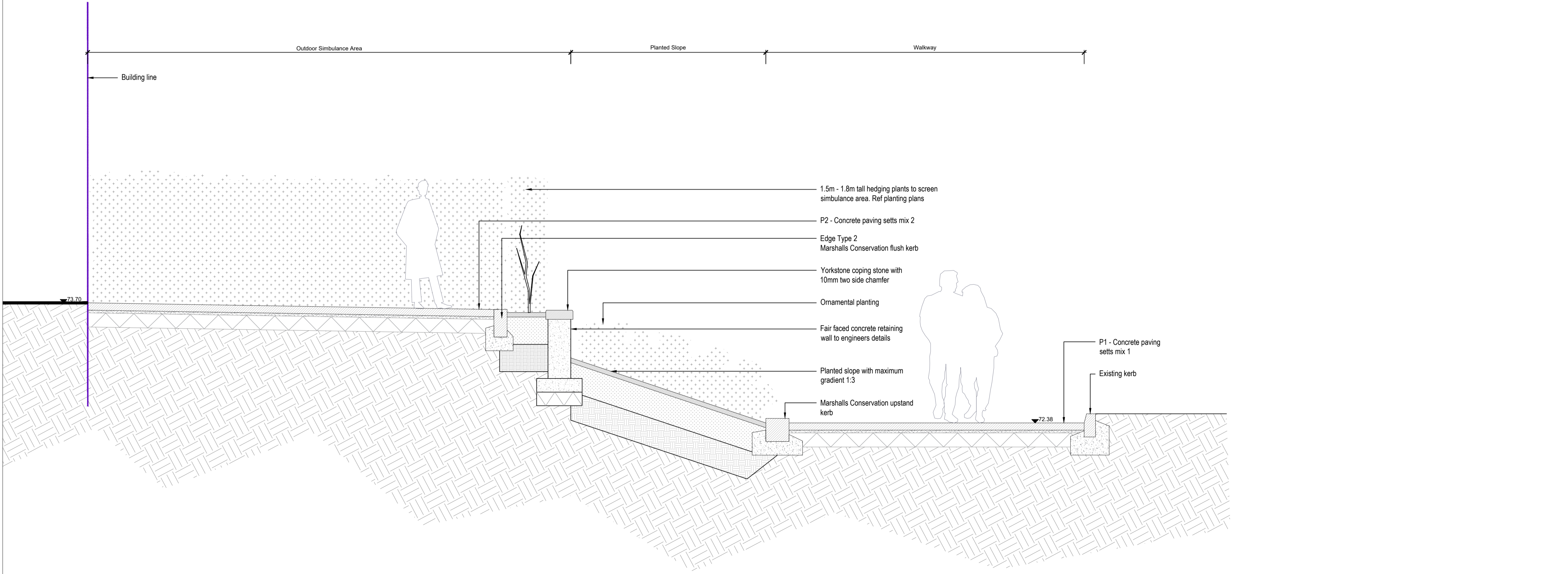

SECTION 02
Scale 1: 25 @A1

Project title
UoH
Health and Wellbeing Academy

Drawing title
SITE SECTIONS 01

Drawing status	Scale	Drawn
CONSTRUCTION	As shown @ A1	RK
	Date	Checked
	21.09.2022	WC
	Drawing number	Revision

HWA-GIL-P1-XX-DR-L-0200

Client
University of HUDDERSFIELD
Overington, Huddersfield West Yorkshire, HD13DH

GILLESPIES
5th Floor, Phoenix House, 3 South Parade, Leeds, LS1 5DQ
P: 0113 247 0550 F: 0113 247 0550 E: design.leeds@gillespies.co.uk