

Kingfisher KW100Z Louvre Blades  
 Supplier: Kingfisher Louvre or similar approved  
 Modular panels arranged as shown, allow flexible panel width  
 Gates: 2no. as shown on plan Double Leaf  
 Posts and Framework: Powder coated galv steel  
 Colour: Interpon D2525 - Steel Bronze 1 - Metallic Matt Y2206F  
 (To match the colour of building louvres)  
 Final shop drawing shall be supplied by  
 supplier for approval prior to manufacture

01  
0319 **SPRINKLER TANK ENCLOSURE PLAN**  
Scale 1: 50 @A1

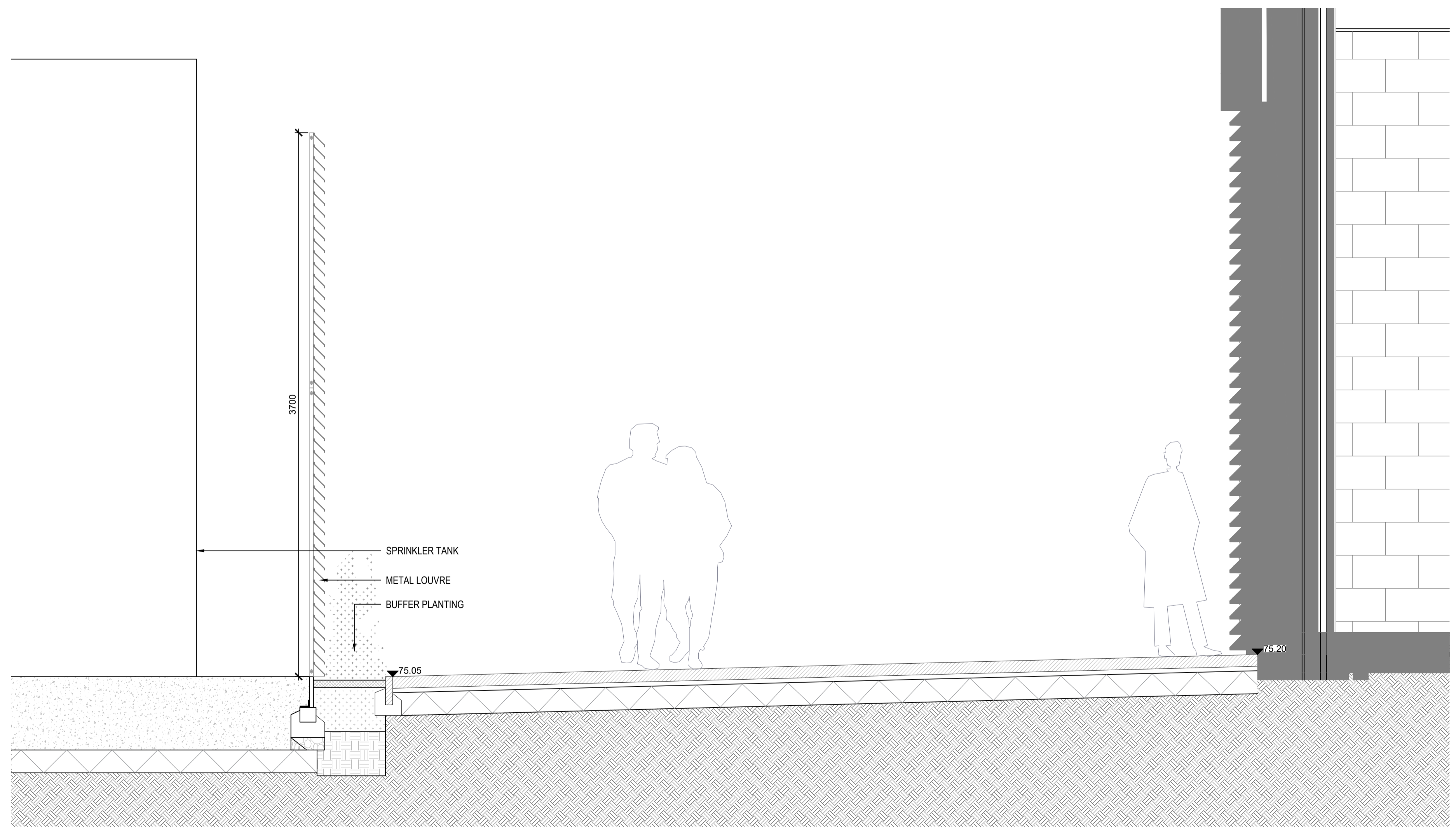

02  
0319 **FENCE SECTION**  
Scale 1: 20 @A1



03  
0319 **SPRINKLER TANK SCREEN - METAL LOUVRES**  
Scale 1: 50 @A1

rev	details	by	date
P00	ISSUED FOR PLANNING	SVU	15.08.2024

**Notes**  
 1.0 Do not scale from drawing, use figured dimensions only  
 1.1 All dimensions to be checked onsite  
 1.2 This drawing to be read in conjunction with all other Gillespies drawings and specifications

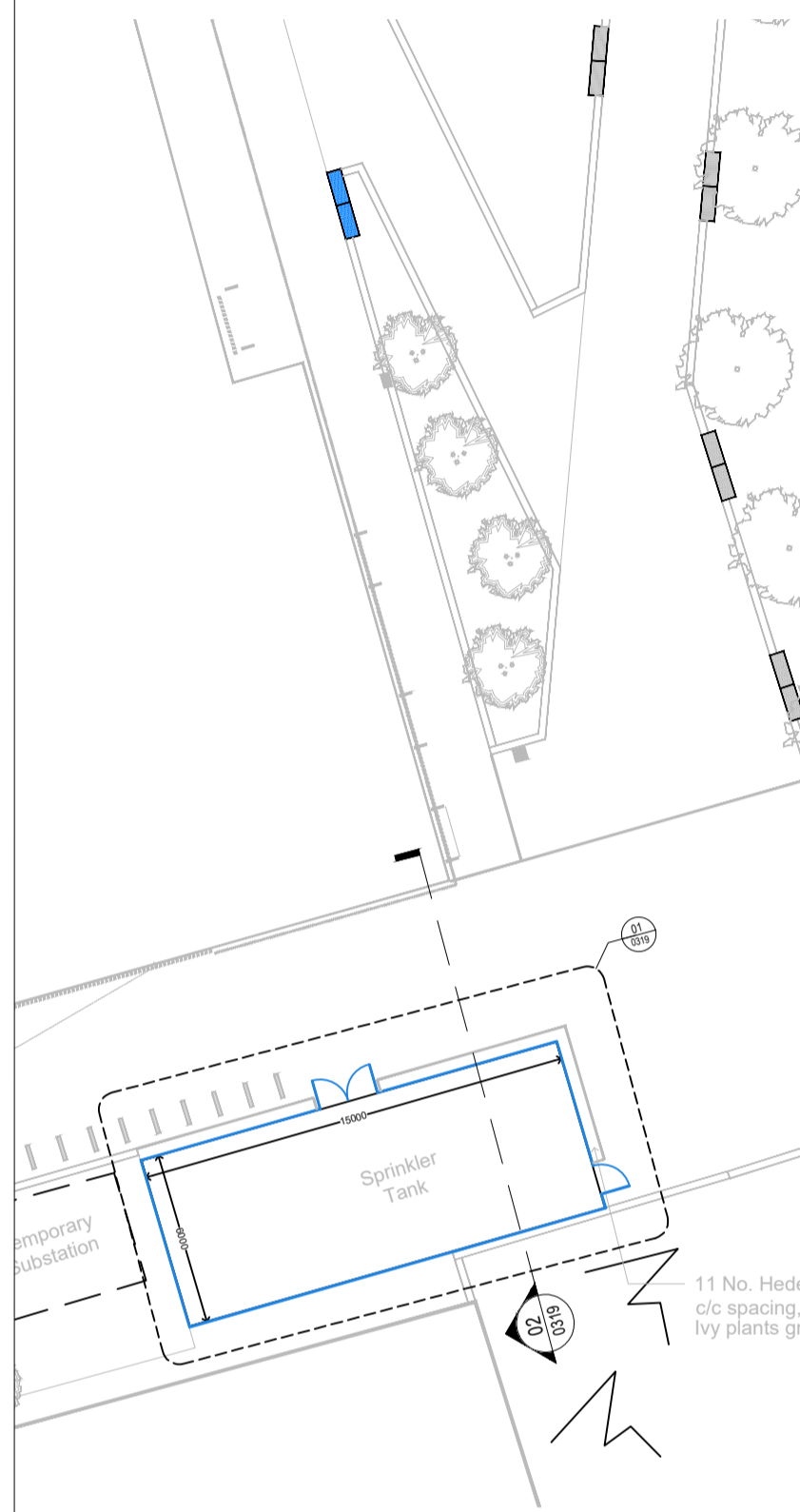

00  
0319 **KEY PLAN**  
Scale 1: 200 @A1

Project title  
**UoH  
 Health and Wellbeing Academy**

Drawing title  
**SPRINKLER TANK ENCLOSURE DETAILS -  
 METAL LOUVRE**

Drawing status	Scale	Drawn
STAGE 4	As shown @ A1	SVU
	Date	Checked
	30.07.2024	WC
	Drawing number	Revision

HWA-GIL-P1-XX-DR-L-0319 P00

Client  
**University of  
 HUDDERSFIELD**  
 Queensgate, Huddersfield  
 West Yorkshire, HD1 3DH

**GILLESPIES**