

1 SITE LOCATION PLAN
SCALE 1:1250

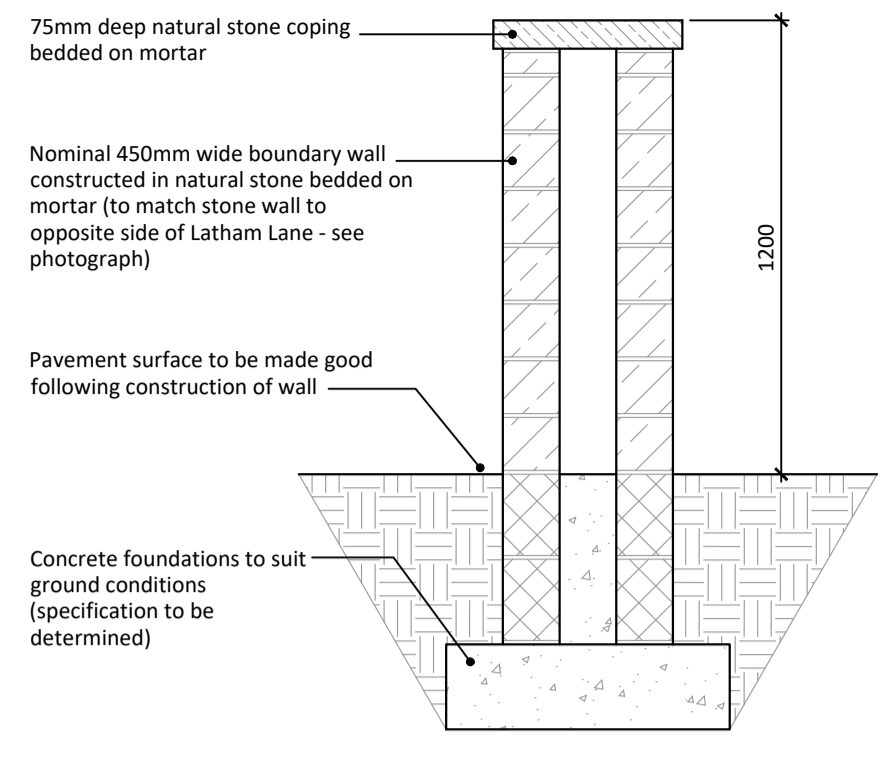

BOUNDARY WALL DETAIL
Boundary wall to Latham Lane to be 1.2m high constructed in natural stone with flat coping to match existing wall to opposite side of road (pictured above).
600x600mm square piers to be constructed in same materials to each side of gates (overall height as indicated on street scene elevation below)

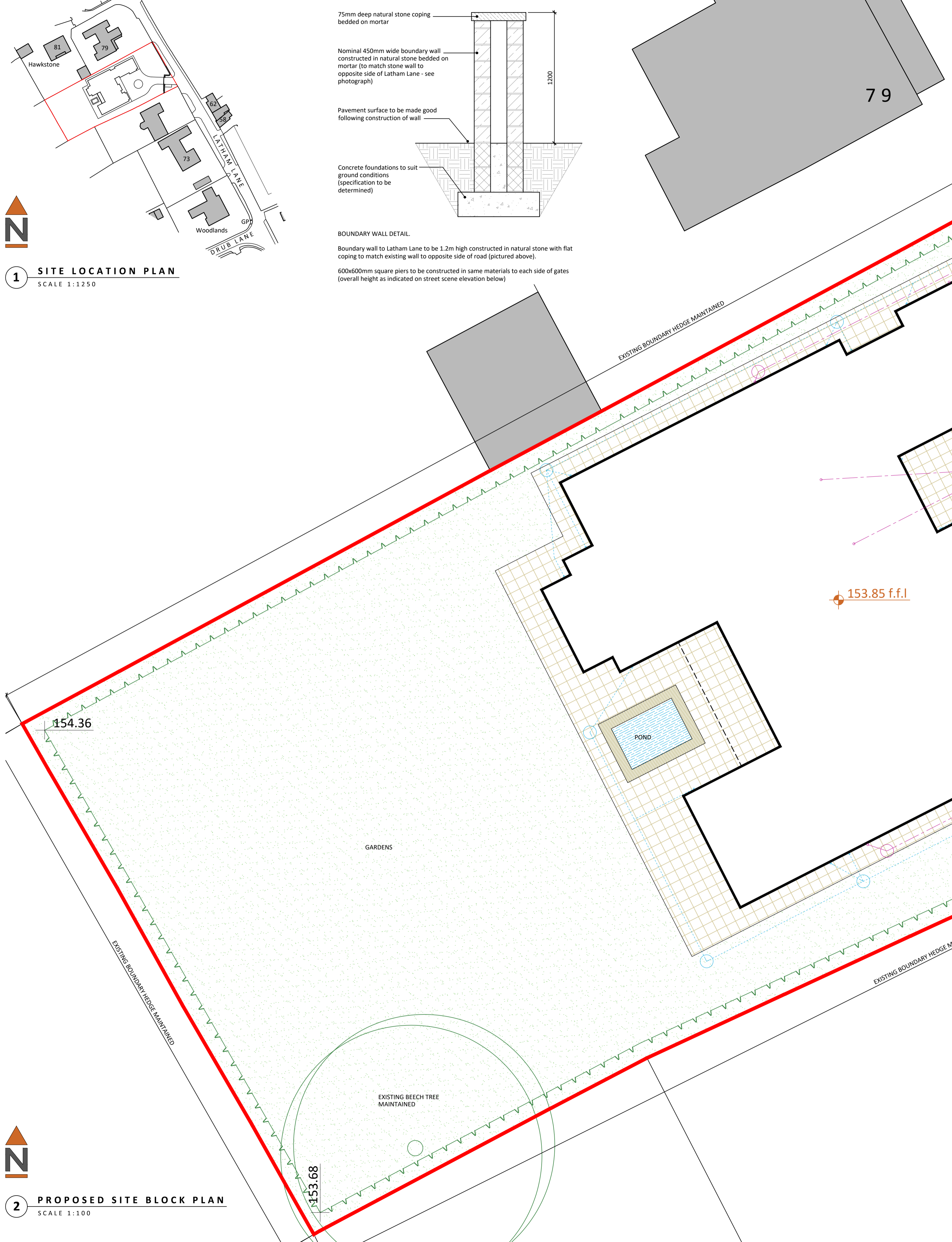

2 PROPOSED SITE BLOCK PLAN
SCALE 1:100

GENERAL SPECIFICATION FOR INITIAL ESTABLISHMENT AND MAINTENANCE OF PLANTED AREAS.

Preparation:
Prior to planting, shrub beds shall be forked, dug, hoed and stone picked to create a smooth, even surface free from weeds, stones greater than 50mm in any dimension or other deleterious material. Any perennial weed shall be removed including the roots. If necessary an approved herbicide shall be applied to manufacturer's instructions.

1st Season Maintenance:
Following planting all areas of new shrub planting shall be mulched with coarse grade bark to a minimum settled depth of 75mm during moist ground conditions. Shrub beds shall be kept clear of all weeds by either mechanical or chemical control during the first growing season after planting. Edges of shrub beds that abut grassed areas shall be kept tidy by regular edging at the time of grass cutting.

Long term Maintenance
Bark mulch shall be topped up as necessary at the start of each growing season to maintain a minimum settled depth of 75mm. Such mulching shall only be done once the beds are weed-free. Weeding shall be carried out as necessary during the growing season to keep beds in a tidy condition. Edges of shrub beds shall be kept clipped as above.
Pruning of shrubs shall be carried out as appropriate to maintain shape, flower and vigour.

Turfing
Soil to be prepared with all stones removed. Surface to be lightly scarified and graded to slope evenly where gradients necessary. Supply, lay and bed imported turf to be sourced from an Approved landscape turf supplier (Turf should be in accordance with the specifications given in BS 3969, and laid in accordance with BS 4428:1989, Section 6).

EXISTING BORDERS AND NEW PLANTING

Existing Borders:
To provide maturity to the garden where possible existing mature shrubs will be retained and any areas requiring infill will be supplemented with the addition of new planting species as below.

New Planting:
New planting to include a mix of native species: - Malus x domestica (Apple) Prunus avium (Wild Cherry) Pyrus communis (Pear) Corylus avellana (Hazel) Crataegus monogyna (Hawthorn) Ilex aquifolium (Holly) Prunus spinosa (Blackthorn) Sorbus aucuparia (Rowan/Mountain Ash).
To soften the base of the new house at the edge of the drive and pathway use Buxus microphylla 'Faulkner' (Small-Leaved Boxwood), Calluna vulgaris 'Spring Torch' (Heather), Cornus sanguinea 'Anny's Winter Orange' (Bloodtwig Dogwood), Carex pseudocyperus (Sedge Hop), Dryopteris affinis (Golden Male Fern) etc.
To be planted in spring following completion of development and to be maintained thereafter.

EXISTING HEDGES AND THEIR PROTECTION DURING THE CONSTRUCTION PHASE

Existing Hedging:
In the interests of providing effective screening and to attract wildlife the existing boundary hedges of beech, hawthorn, holly, privet and hazel will be retained. For new more formal hedging if required use Carpinus or Fagus species or a mixture of the two.

Construction Phase Protection
During the construction phase the existing hedges and existing trees are to be protected by means of barriers that offer full protection to the trees and hedges and their root systems (contractors responsibility)

Revisions

NORTHLIGHT ARCHITECTURE LTD
The Media Centre
7 Northumberland Avenue
Huddersfield
HD1 1AQ
T: 01484 204945
F: 01484 204946
E: info@northlightarchitecture.com
W: www.northlightarchitecture.com

Client
John & Sharon Valente

Project
**77 Latham Lane,
Gomersal
CLECKHEATON, BD19 4AP**

Drawing Title
**Site Block Plan
As Proposed**

PLANNING APPLICATION

Scale @ A1
1:100/ 1250

Date
Dec '23

Drawing no
22-1185/(AL)200

Drawn by
CG

App'd
-

Rev
-

© Northlight Architecture Ltd 2020