

The use of drawings by the Customer acts as an agreement to the following statements. The Customer must not use the drawings if it does not agree with any of the following statements:  
 All drawings are based upon site information supplied by third parties and as such their accuracy cannot be guaranteed. All features are approximate and subject to clarification by a detailed topographical survey, statutory service enquiries and confirmation of the legal boundaries. Do not scale the drawings. Figured dimensions must be used in all cases. All dimensions must be checked on site. Any discrepancies must be reported in writing to Colour+UDI, before proceeding. All drawings are copyright protected. Refer to full Terms & Conditions at [www.colour-udi.com](http://www.colour-udi.com)

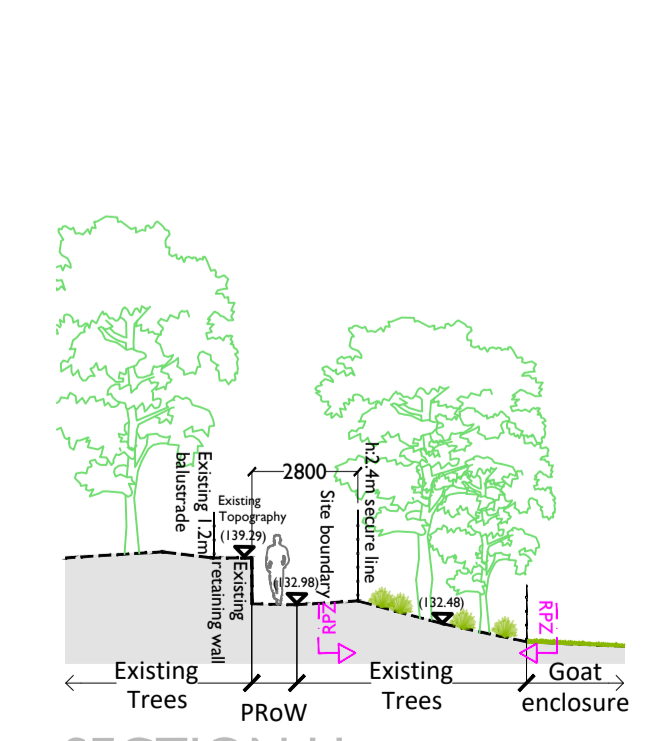
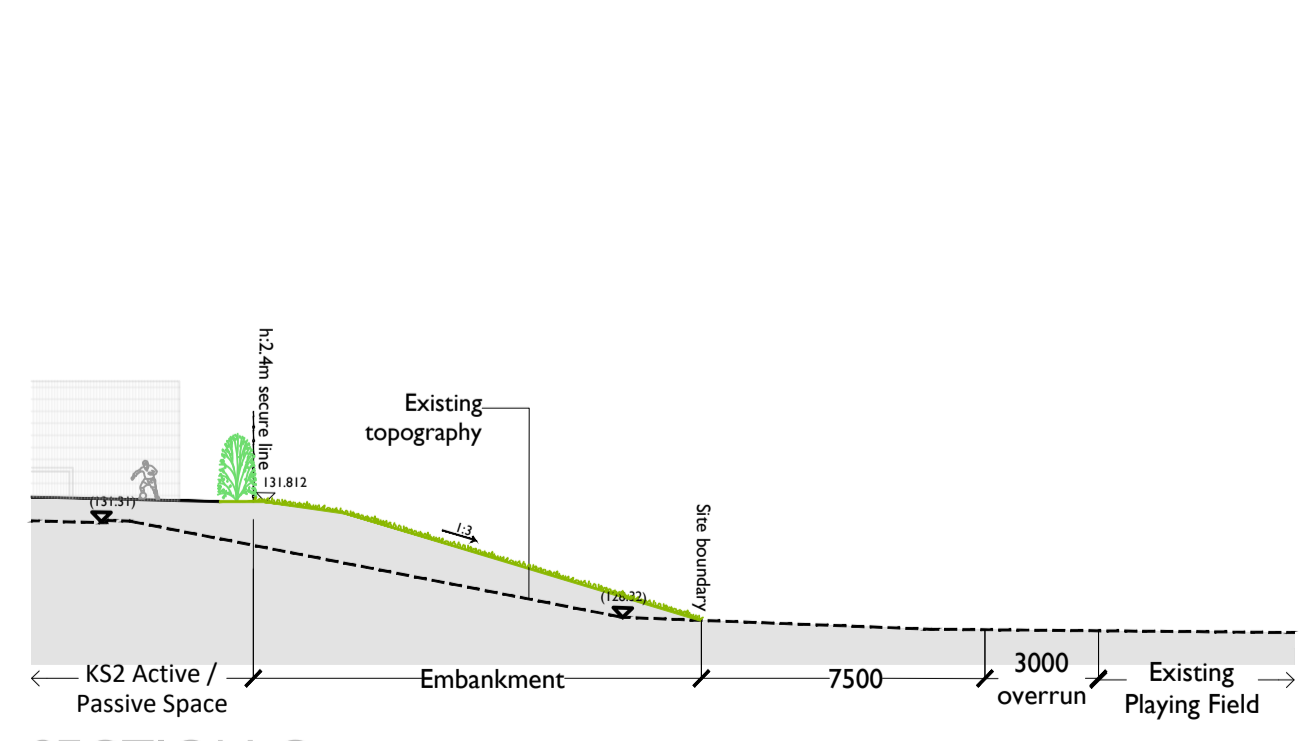
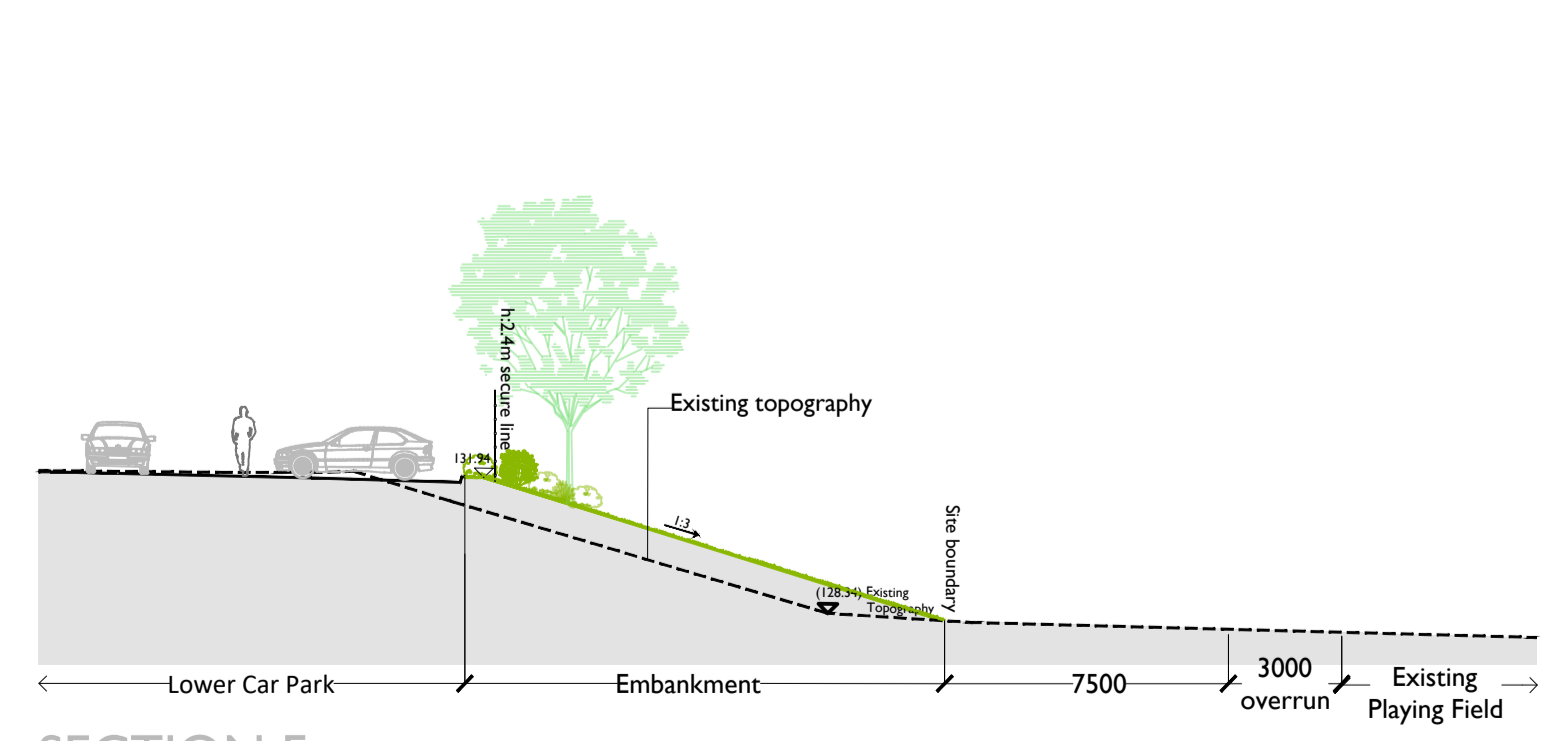
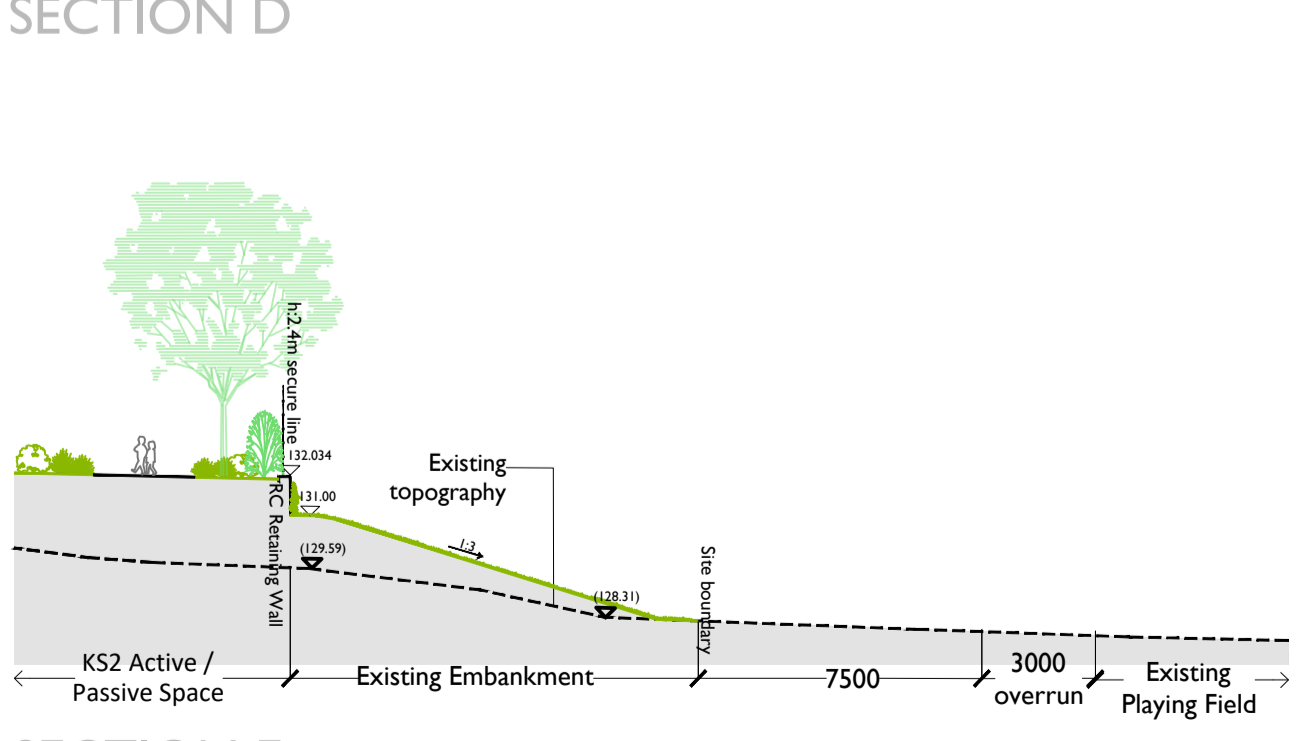
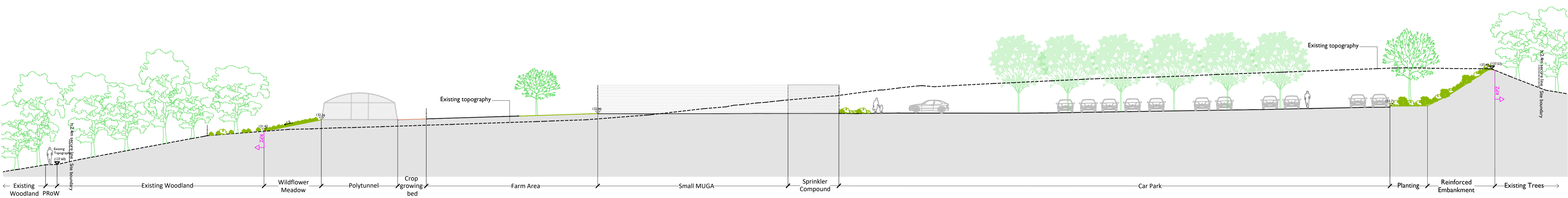
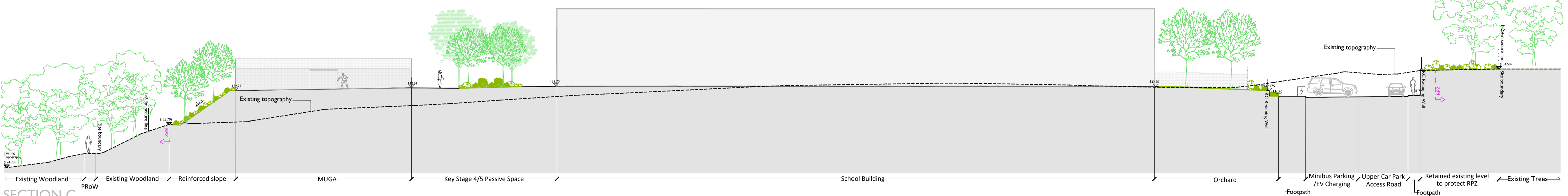
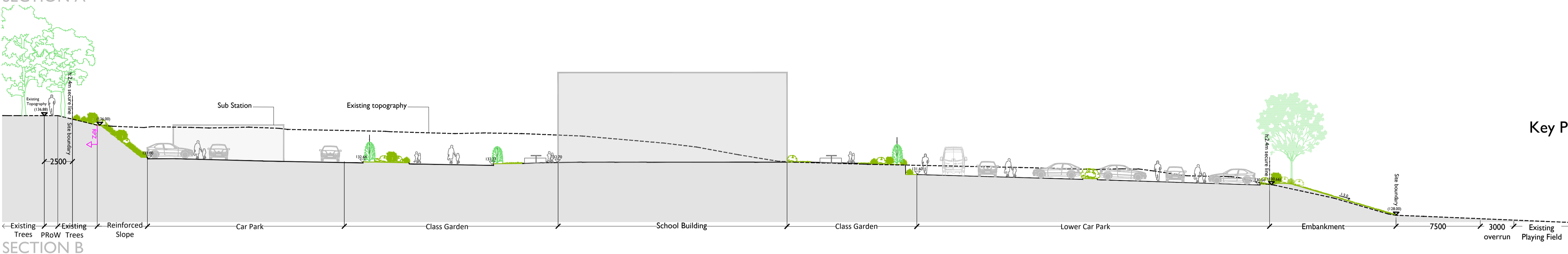
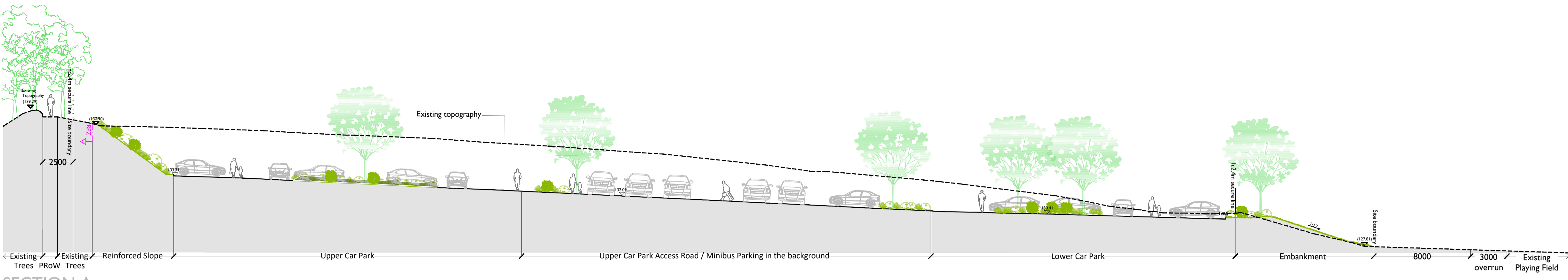
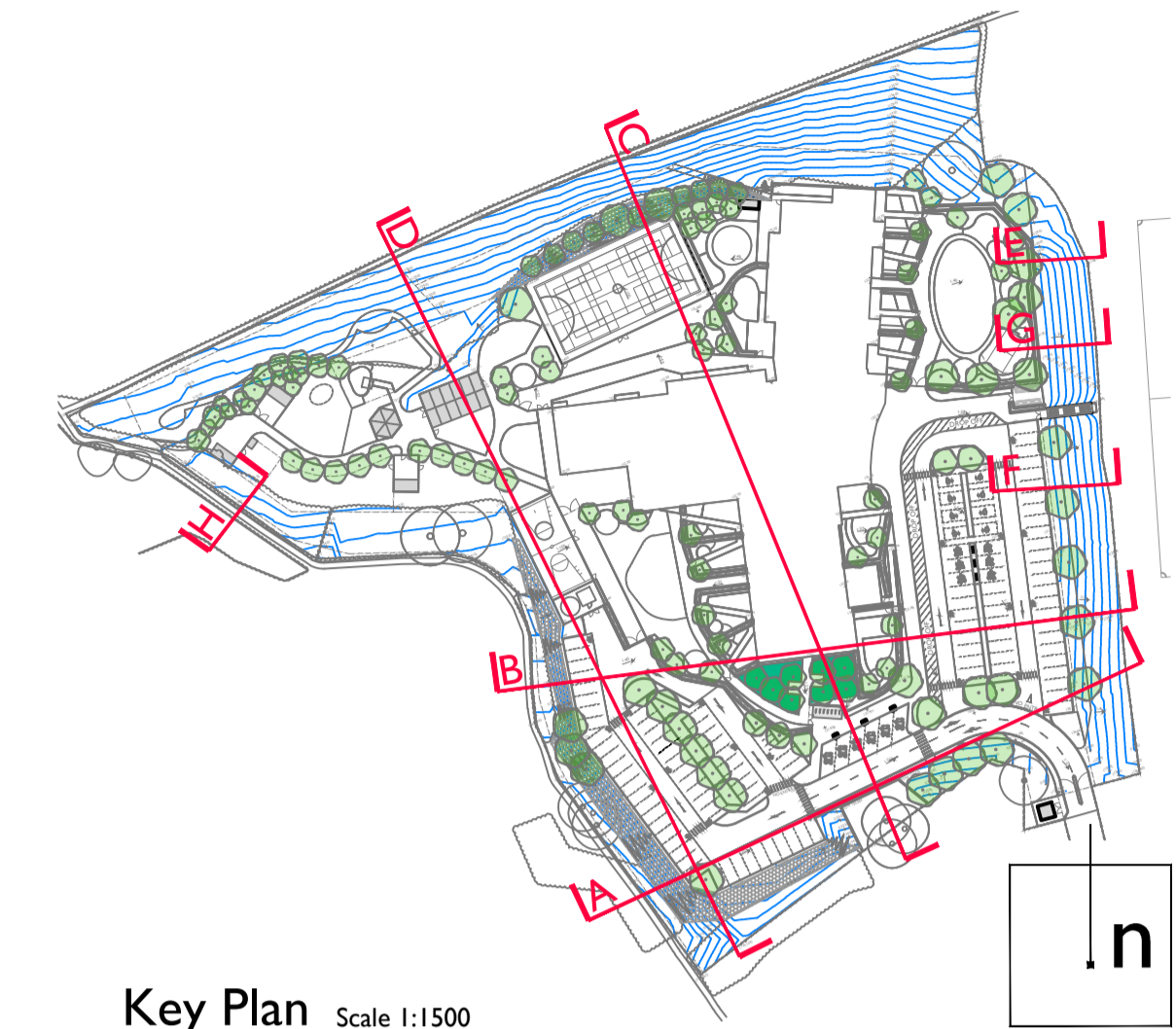

**INTERIM ISSUE**

All detailed levels and retaining structures to Engineer's specification

14	Amended sections A, B, C & G	13.02.24	TK	-
13	Revised eastern embankment	12.02.24	TK	-
12	Amended following revised layout	02.02.24	TK	-
11	Amended following revised layout	22.01.24	TK	-
10	Amended following revised layout	15.12.23	JR	PO
09	Revised gradients along eastern boundary	23.10.23	TK	-
08	Revised Section C to soil retaining wall	12.09.23	TK	-
07	Planning Issue	08.09.23	DC	TK
Rev	Amendments	Date	Drwn	Chkd

Project: Joseph Norton Academy, Deighton  
 Drawing Title: Proposed Landscape Sections  
 Long sections across site and sections through eastern embankment  
 Project No: 2352  
 Scale: @ A1 1:200  
 Project Status: For Approval  
 Drawing No: L-2352-SEC-3100  
 Revision: 14

London 0203 924 9888  
 Newcastle 0191 24 24 224  
 York 01904 925 888  
 colour-udi.com

