

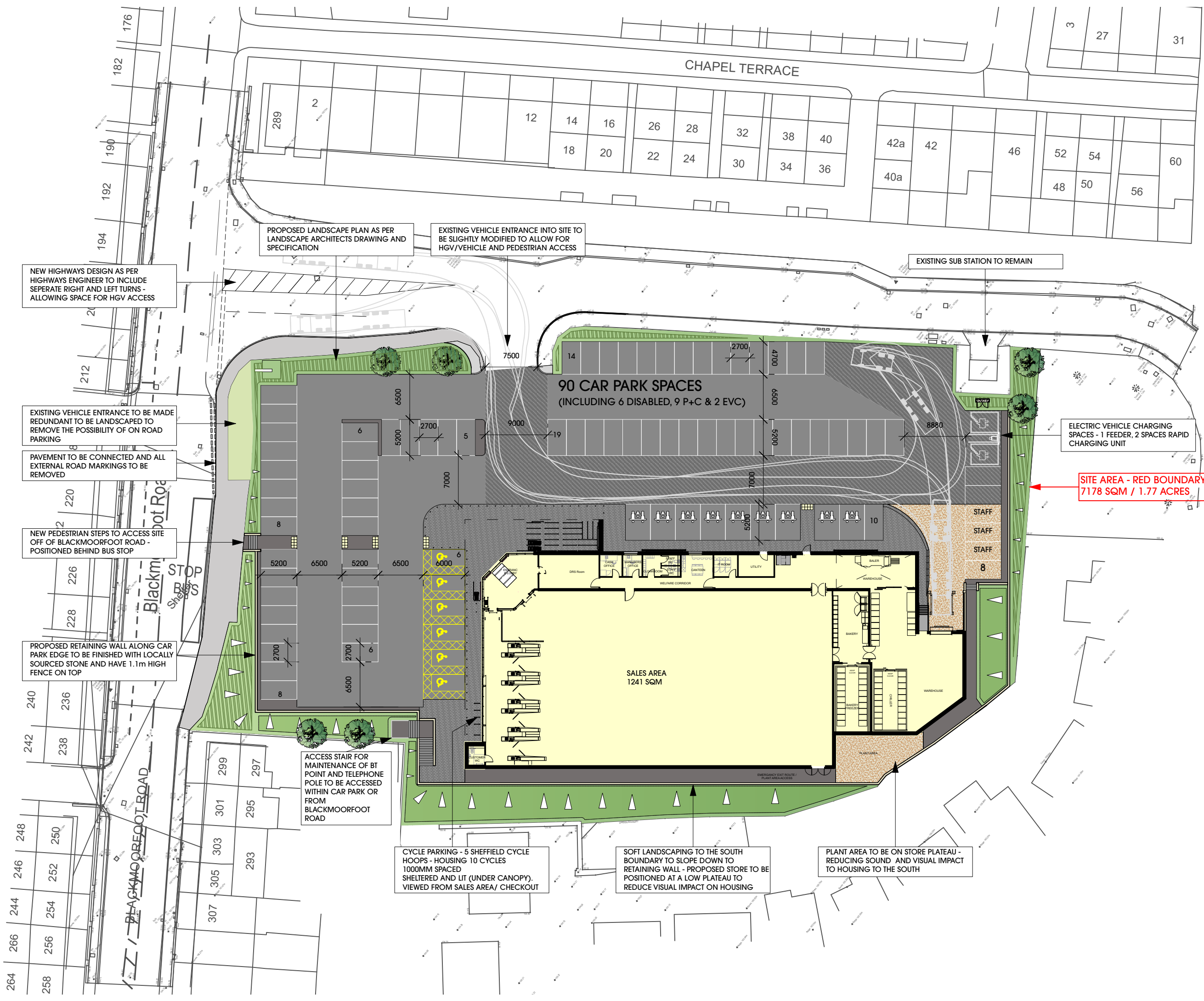

PROPOSED LIDL KEY

SALES AREA	= 1,241 sqm
WAREHOUSE	= 433 sqm
ANCILLARY	= 228 sqm
GIA	= 1,902 sqm
GEA (INC CANOPY)	= 2,160 sqm
90 CAR PARKING SPACES (6 DISABLED, 9 PARENT AND CHILD)	



SITE AREA - RED BOUNDARY
7178 SQM / 1.77 ACRES

B	14/03/2023	added	Updated Site Plan - Minor adjustments - Annotations	BM
A	29/11/2022	Engineers comments	Updated HGV turning Kerb as per Highways	BM
Rev	Date	Description		Drawn

htcarchitects
York Place Studio
8 Britannia Street
Leeds
LS1 2DZ
T: (0113) 244 3457
W: www.htcarchitects.co.uk
E: info@htcarchitects.co.uk

client
Lidl GB Ltd.

project
**Blackmoorfoot Road
Huddersfield**

drawing title
Proposed Site Plan

date **August 2022**
status **Planning**
scale **1:500 @ A3**
drawn **NG** checked **BM**
job no. **2783** dwg no. **P401** rev. **B**