

THIS DRAWING IS COPYRIGHT AND REMAINS THE PROPERTY OF HIC ARCHITECTS. IT MUST NOT BE REPRODUCED, USED, DISCLOSED OR TRANSMITTED TO THIRD PARTIES IN ANY FORM, IN WHOLE OR IN PART, WITHOUT PRIOR WRITTEN PERMISSION.

DO NOT SCALE!
ALL DIMENSIONS SHOULD BE CHECKED ON SITE BEFORE WORK COMMENCES

BOUNDARY BASED ON TITLE DEEDS: WYK696805

BOUNDARY BASED ON TOPOGRAPHICAL SURVEY: 5328-0721-01C

SUBJECT TO HIGHWAYS CONSULTATION

SUBJECT TO LEVELS STRATEGY REVIEW

LIDL INTERNALS ARE SUBJECT TO CONFIRMATION FROM LIDL FOLLOWING LATEST SPECIFICATION IMPLEMENTATION (AUG 2023)

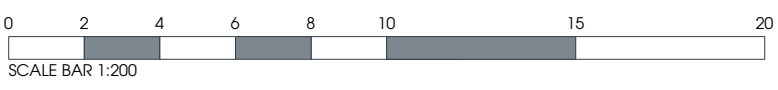
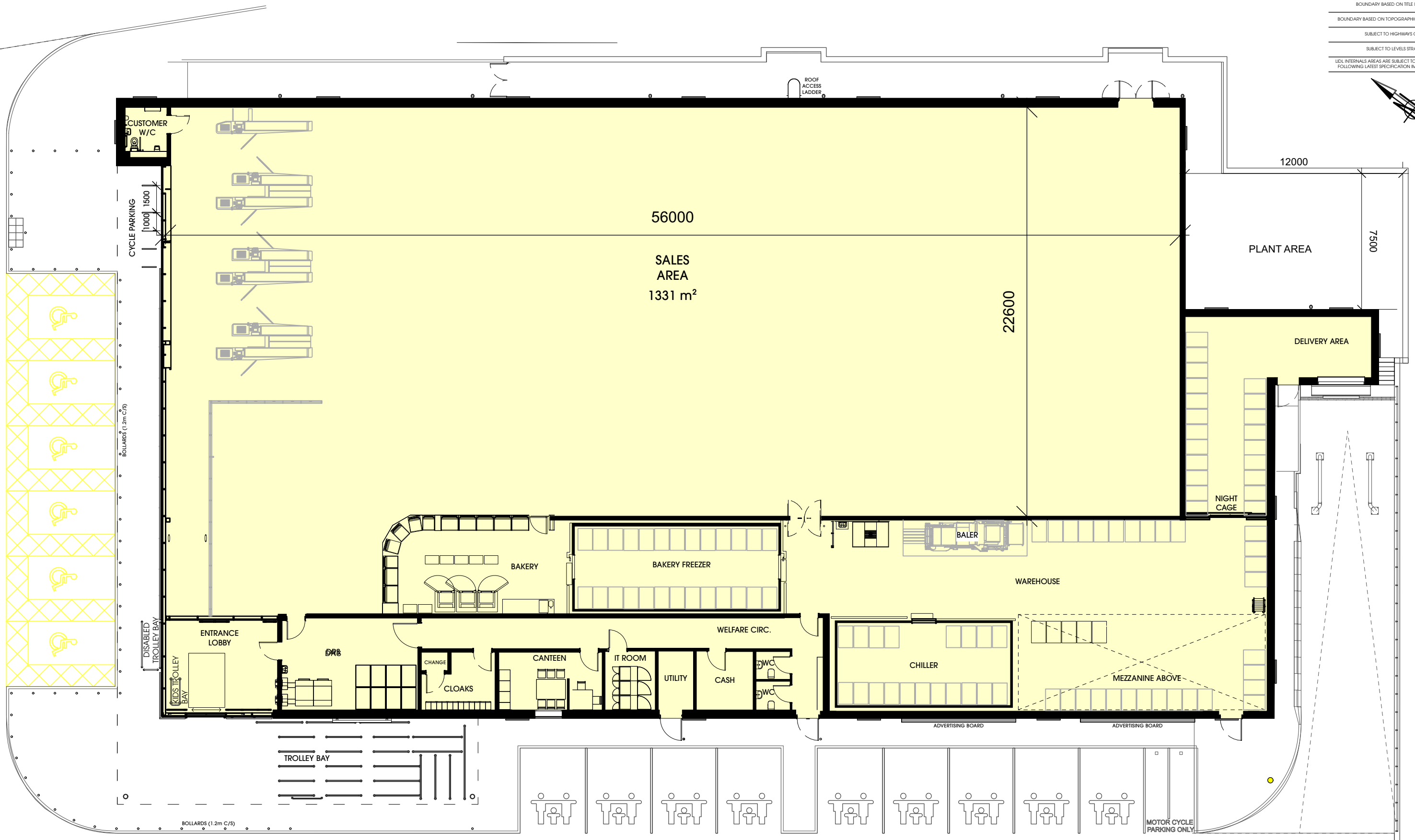
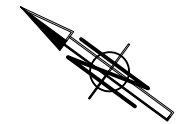

htcarchitects
 York Place Studio
 8 Britannia Street
 Leeds
 LS1 2JZ
 T: (0113) 244 3457
 W: www.htcarchitects.co.uk
 E: info@htcarchitects.co.uk

client
 Lidl GB Ltd.



project
 Blackmoorfoot Road
 Huddersfield
 drawing title
 Proposed Floor Plan

date August 2023
 status Planning
 scale 1:200 @ A3
 drawn KA checked BM
 job no. 2783 dwg no. P110 rev. A

Rev.	Date	Description	BM Drawn
A	27/10/2023	Bollards added, Disabled trolley bay and Childrens trolley bay added	