

Site Area -
2500m² (0.25 hectares)

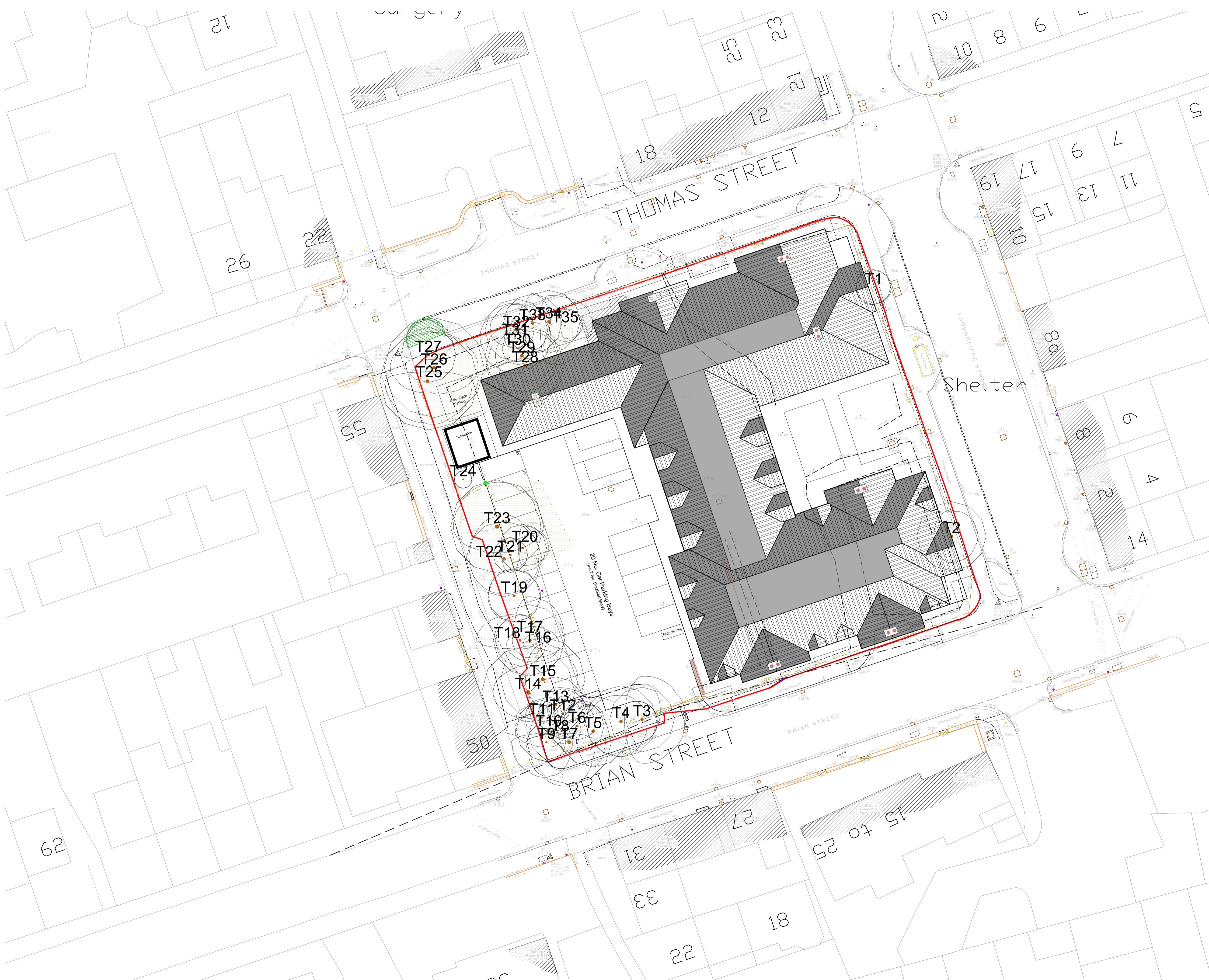

Rev	Date	Revision Description	Drawn By	Approved By
Q	05/05/23	Roof plan updated	CFF	JB
P	02/05/23	Substation added to site	CFF	JB
O	26/04/23	Bin store has been relocated and parking reduced	CM	JB
N	25/04/23	Note has been removed	CM	JB
M	25/04/23	Bin store has been relocated	CM	JB
L	25/04/23	Layout has been amended to suit the highways comments	CM	JB
K	24/04/23	Building footprint has been adjusted to accommodate the Highway comments	CM	JB
J	11/04/23	Footpath has been widened to 1200mm as required for access Consultant Road width has been increased as agreed with the Highways Consultant	CM	JB
I	03/04/23	Bin store and cycle store have been amended to suit the Landscape Officers comments	CM	JB
H	23/08/22	Bin store and cycle store have been amended to suit the Landscape Officers comments	CM	JB
G	21/06/22	Title block has been amended.	CM	JB
F	15/06/22	Roof Plan added to layout.	CM	JB
E	12/04/22	Layout has been revised to suit the Tree Consultants comments	CM	JB
D	30/03/22	Layout has been revised to suit the Transport Consultants comments	CM	JB
C	18/03/22	Detailed layout has been added	CM	JB
B	24/02/22	Title block has been updated.	CM	JB
A	13/01/22	Layout has been revised to accommodate the TPO	JB	JB
-	01/01/21	Original Drawing	JB	JB

ADG ARCHITECTS
 8 Pioneer Court, Darlington, DL1 4WD
 t: 01325 464 111
 e: studio@adgarchitects.co.uk
 w: www.adgarchitects.co.uk

Client
Muller Property Group

Project Information
Proposed Care Home Development
21 Thomas Street, Lindley, Huddersfield HD3 3JJ

Drawing Title
Proposed Site Plan

A1 Scale	1:200	A3 Scale	
Job Number	H.21.81	Drawing Number	(9-) 2
Revision			Q
Drawing Issue PLANNING			

FOR ILLUSTRATIVE PURPOSES ONLY

© Copyright 2018 ADG Architects Ltd