

## CCTV Survey



Customer	9 BIRKBY ROAD (CORBY)	Resource	Jamie Payne
Contact	David Irving		
Address	Birkby Road Huddersfield HD2 2DR	Job type	Commercial CCTV Survey
		Reference	COM-CCTV26037
		Order number	David Irving
		Date	28/06/2023 03:00 - 11:00
		Job duration	08:00:00
		Driving duration	00:00:02
		Distance travelled	0 mi

Notes CCTV survey of 100m long culvert (Site contact David Irving 07931774788)

### Resource notes

Attended site carried out survey of culvert pipework.

Unable to continue down pipework as is full with silt.

Tanker attended and could not clean through site manager said irving has advised to stop work and is going to dig trenches to expose pipework and potentially continue from there.

N/A

David Irving

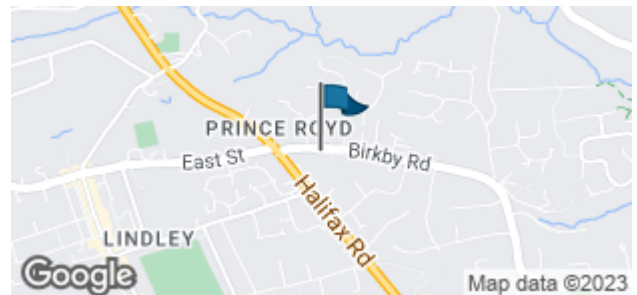

### 01 Site Access

	Answer	Notes
Can you access the site / property?	Yes	

### 02 Risk Assessment

	Answer	Notes
--	--------	-------



<b>Risk Assessment</b>	STATEMENT READ - This form must be completed and be signed prior to any works commencing. Under no circumstances must any work commence without the completion of this form.
<b>Please select any applicable environmental risks</b>	Slips/Trips
<b>Please select any applicable people risks</b>	Members of the Public, Other Contractors
<b>Please detail what actions have been taken to minimise the risks identified.</b>	Barriers to be used
<b>Have you got all necessary personal protective equipment (PPE) to proceed safely?</b>	Yes
<b>I declare I have identified the potential hazards associated with the work and put the relevant controls in place so that work can commence in a safe manner</b>	Jamie Payne

**03 Before Starting Work**

	Answer	Notes
<b>Provide a photo of the general area you will be working in before commencing work.</b>		

### 05 Commercial Drain Survey

	Answer	Notes
Has time been spent cleaning the drainage system prior to the CCTV survey being carried out?	Yes	
If the drainage system has been cleaned prior to the survey being carried out, please advise for how long and by what means.	Half shift	
Were there any manhole covers on site which could not be lifted?	No	
Has the survey of the drainage system been completed in the time allocated?	No	
If not, please confirm how much additional time is required to complete the survey.	When contractors want work another half shift potentially however they may just reroute system	

### 05 Manhole Photos 1

	Answer	Notes
1 Do you want to add photographs of manholes you have worked from?	Yes	
1. Manhole Cover		mh1 culvert



1. Manhole / Chamber



2 Do you want to add additional photographs of manholes you have worked from?

No

05 Manhole Photos 2

Answer

Notes

6 Do you want to add photographs of manholes you have worked from?

No

05 Manhole Photos 3

Answer

Notes

11 Do you want to add photographs of manholes you have worked from?

No

05 Manhole Photos 4

Answer

Notes

16 Do you want to add photographs of manholes you have worked from?

No

081 Plan of Site / Drainage System Worked On

Answer

Notes



Please provide a plan to show the area of the site and the drainage system which has been worked on

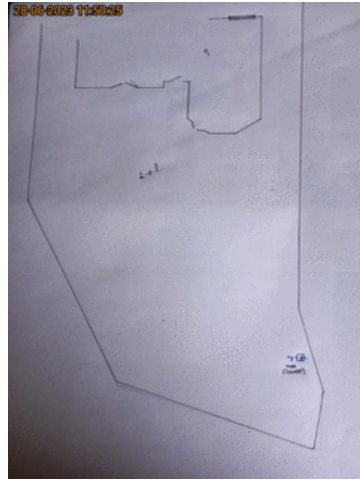

**09 Any Issues / Defects Identified Whilst on Site**

	Answer	Notes
Add Risk/Defect 1?	No	

**09 Before Departure from Site (Commercial CCTV)**

	Answer	Notes
--	--------	-------

Provide a photo of your general work area before leaving site.



Is an additional photo required?	No	
----------------------------------	----	--

INTERNAL - Are there any recommendations for additional work / improvements to current systems?	No	
---	----	--



**DRAINAGE  
CONSULTANTS LTD**  
Professional Drainage Contractors

**Drainage Consultants Ltd**

Clearwater House, Unit 20a Newby Road Industrial  
Estate  
Hazel Grove  
SK7 5DA

	<b>TOTAL</b>	<b>COST</b>
Job duration	08:00:00	£120
Driving duration	00:00:02	£0
Distance travelled	0 mi	£0
	<b>TOTAL</b>	<b>£120</b>