

**GA PLAN**  
1 : 100

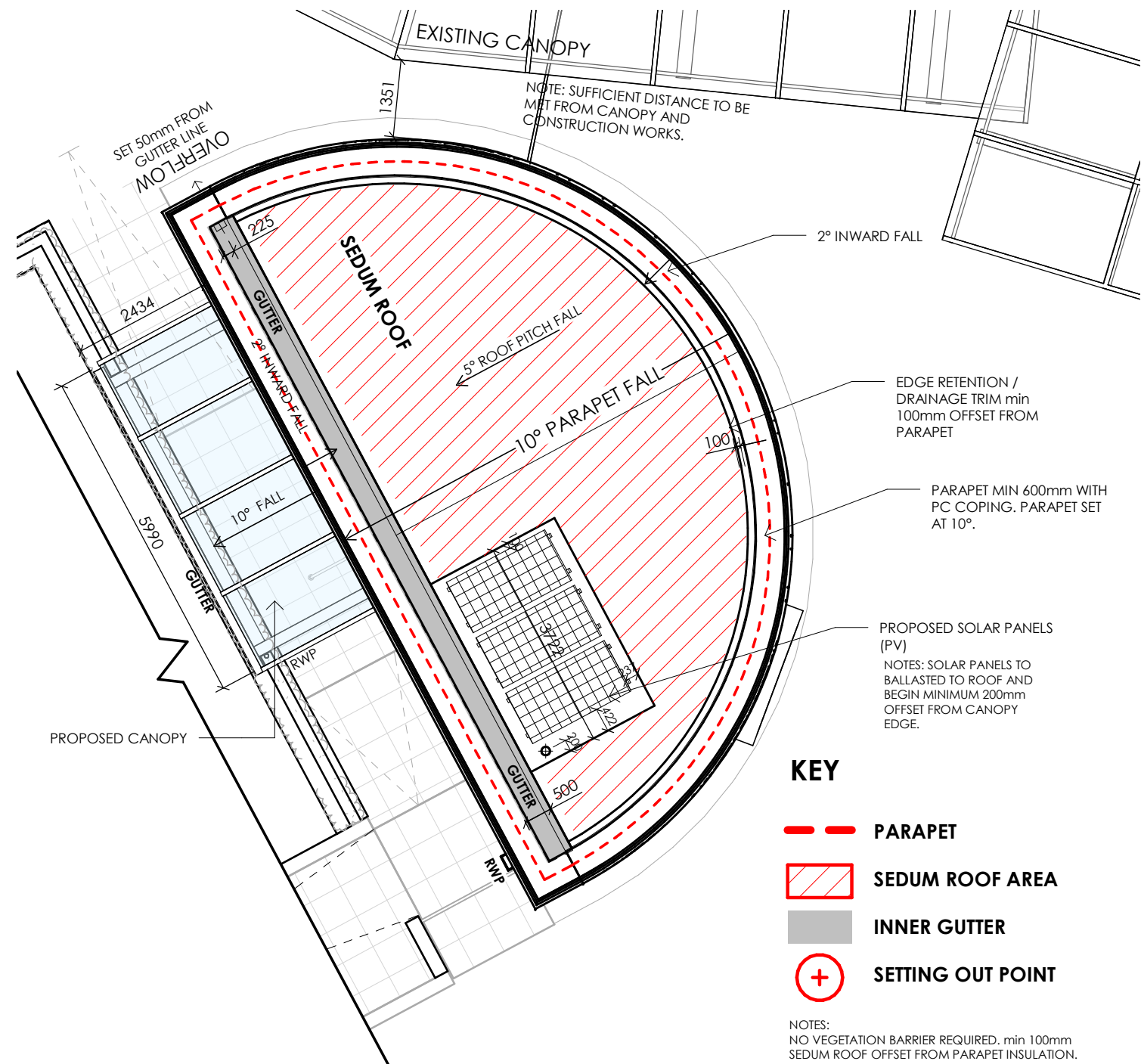

**GA ROOF PLAN**  
1 : 100

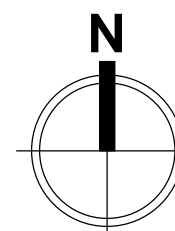

As outlined in section 2.3 of the CITB Industry Guidance to Designers, insignificant risks can usually be ignored, as can risks arising from routine construction activities, unless the design compounds or significantly alters these risks. In accordance with CDM Regulations 8, 9 and 11, any significant risks relating to the design features shown on this drawing have been identified and are annotated thus: **I**

No significant risks have been identified.     Significant risks have been identified - refer to notes on drawing for information on residual risks and any control measures to be employed.

Refer to the current Designer's Risk Assessment sheets for further details.

<b>Designer's Signature</b>	RB	<b>Date</b>	04.03.22
-----------------------------	----	-------------	----------

<b>Project</b> ReWork Eco Teaching				<b>Title</b> GA PLAN & ROOF PLAN			
<b>Client</b> Pinnacle Group _ Communication Academy Trust				<b>Drawing Status</b> LCI			
Rev.	Description	Vf'd	Date	WmS Project No.	Drawn by	Date	Scale
P3	Setting out points added for sedum roof cut out set out. Gutter area corrected. Notes added.	JCM	28.07.22	12335	KH	15.02.22	As indicated <sup>1</sup> A3
P4	Last Construction Issue	JCM	01.02.23	Drawing/Document Reference Project Originator Zone Level Type Role Number Status Rev. 12335 - WMS - XX - XX - DR - A - 10410 - D2 - P4			

**williamsaunders**  
architecture : engineering : building consultancy

Suite 14, Calls Wharf,  
2 The Calls,  
Leeds,  
LS2 7JU

Tel: 0113 246 8208  
W: wm-saunders.co.uk

Also at Newark, Lincoln & Wksworth