

WORK SEQUENCE TO BE FOLLOWED ALONG WEST AND EAST ELEVATIONS

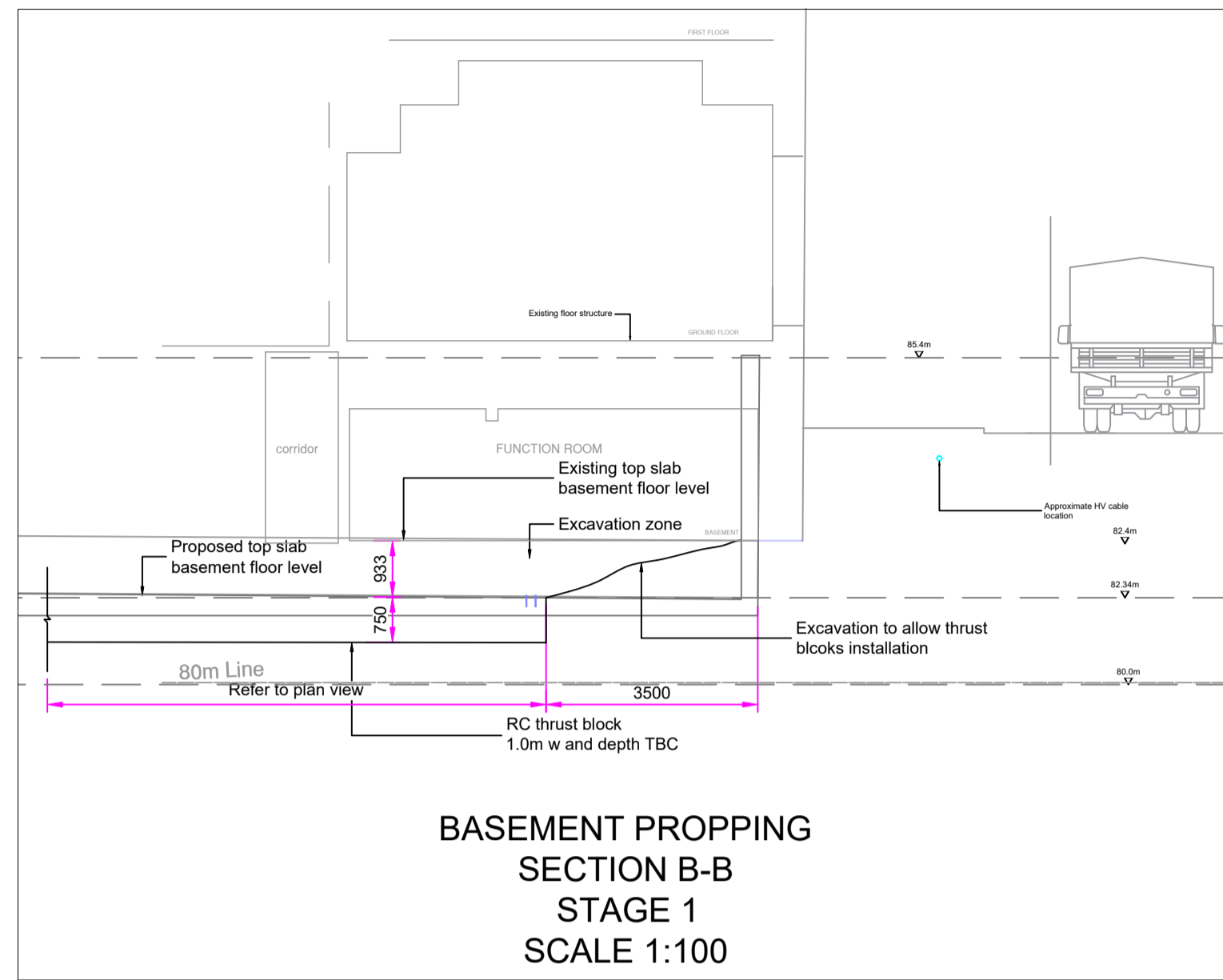

• LOCALLY EXCAVATE BELOW CURRENT BASEMENT LEVEL TO CAST THRUST BLOCKS.

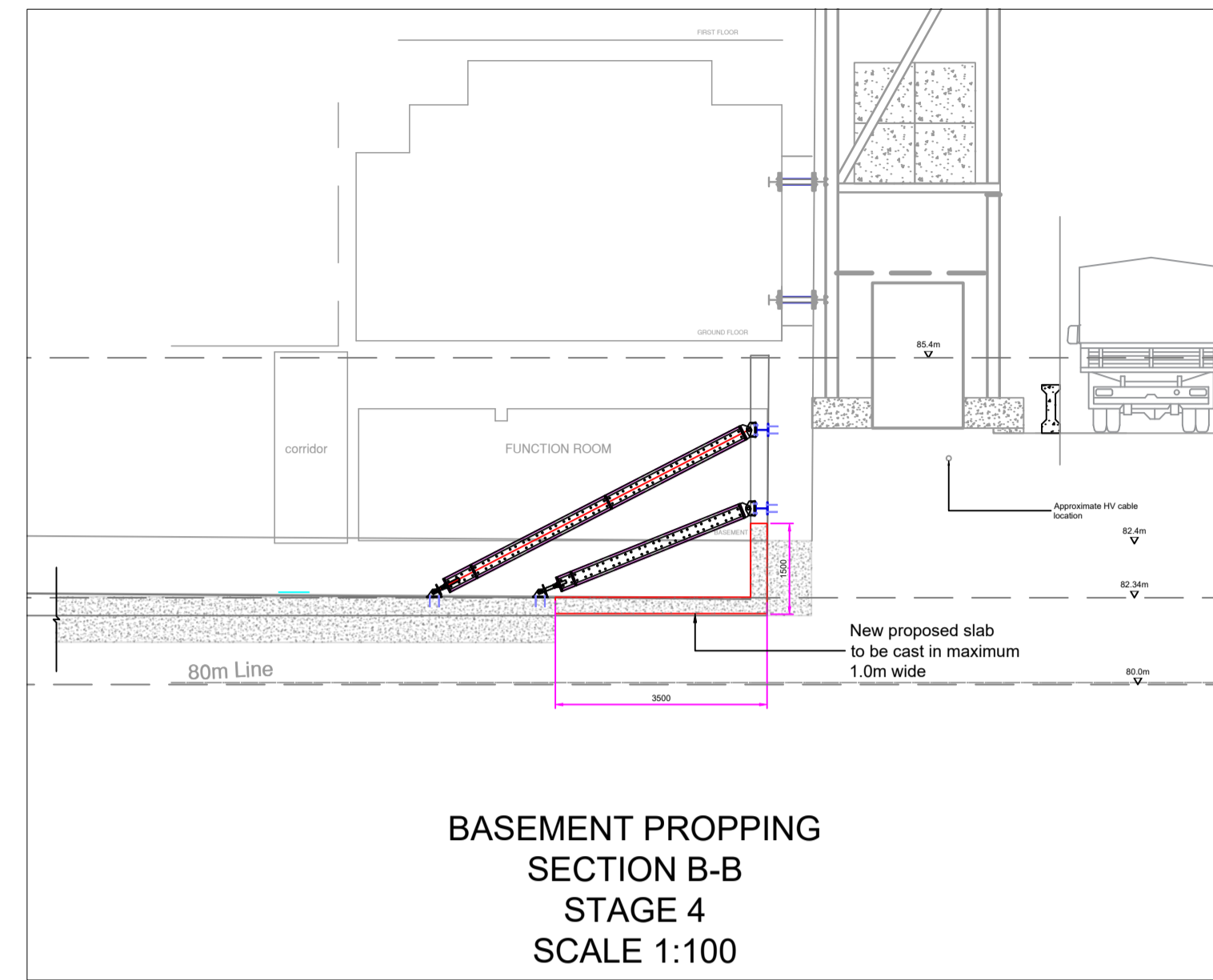

• CAST THE NEW BASEMENT SLAB AND CANTILEVER RC STUB IN FRONT OF THE THRUST BLOCKS

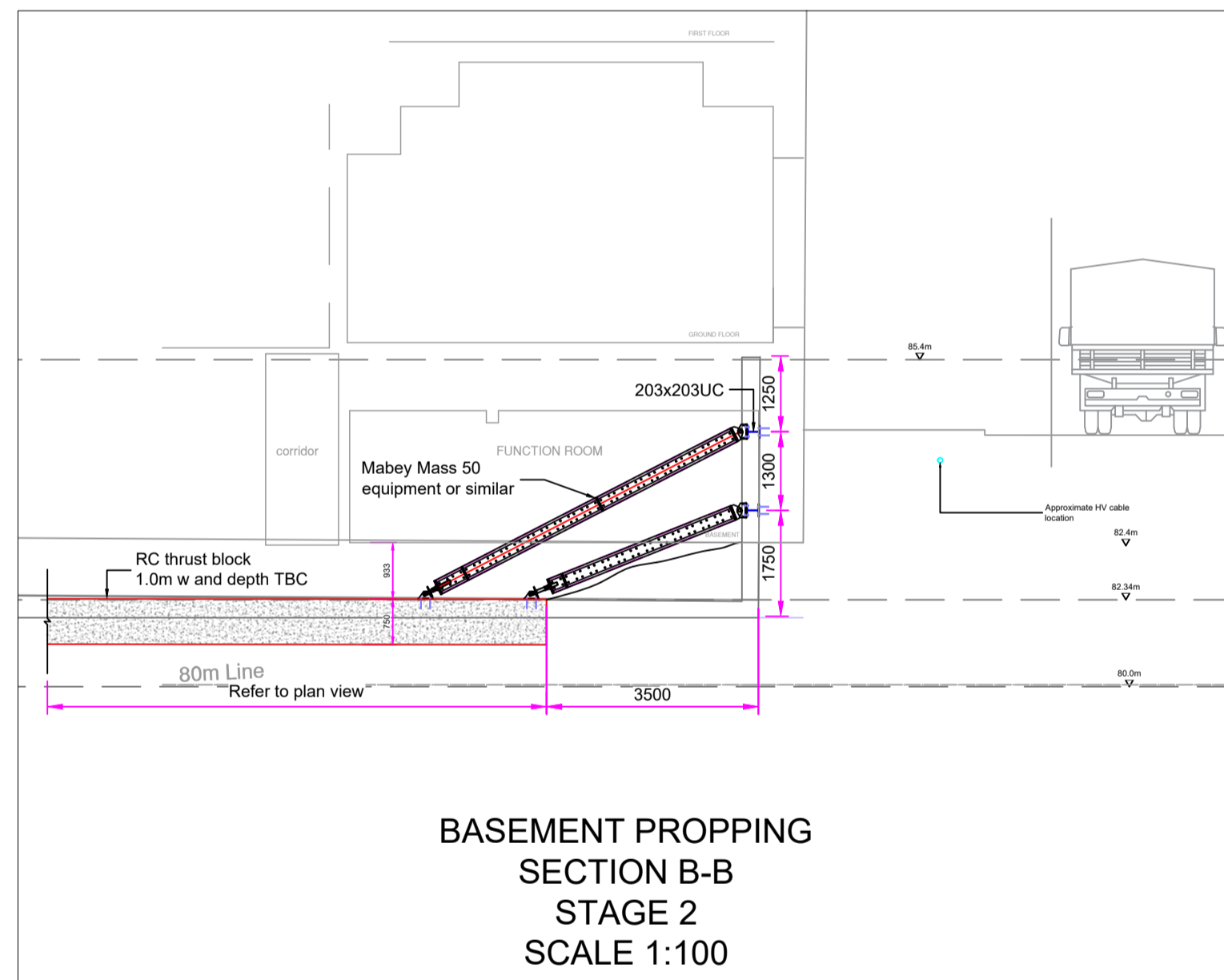

• INSTALL TOP AND BOTTOM WALERS ALONG WEST AND EAST ELEVATIONS
• INSTALL PROPPING TO WALER AND THRUST BLOCKS

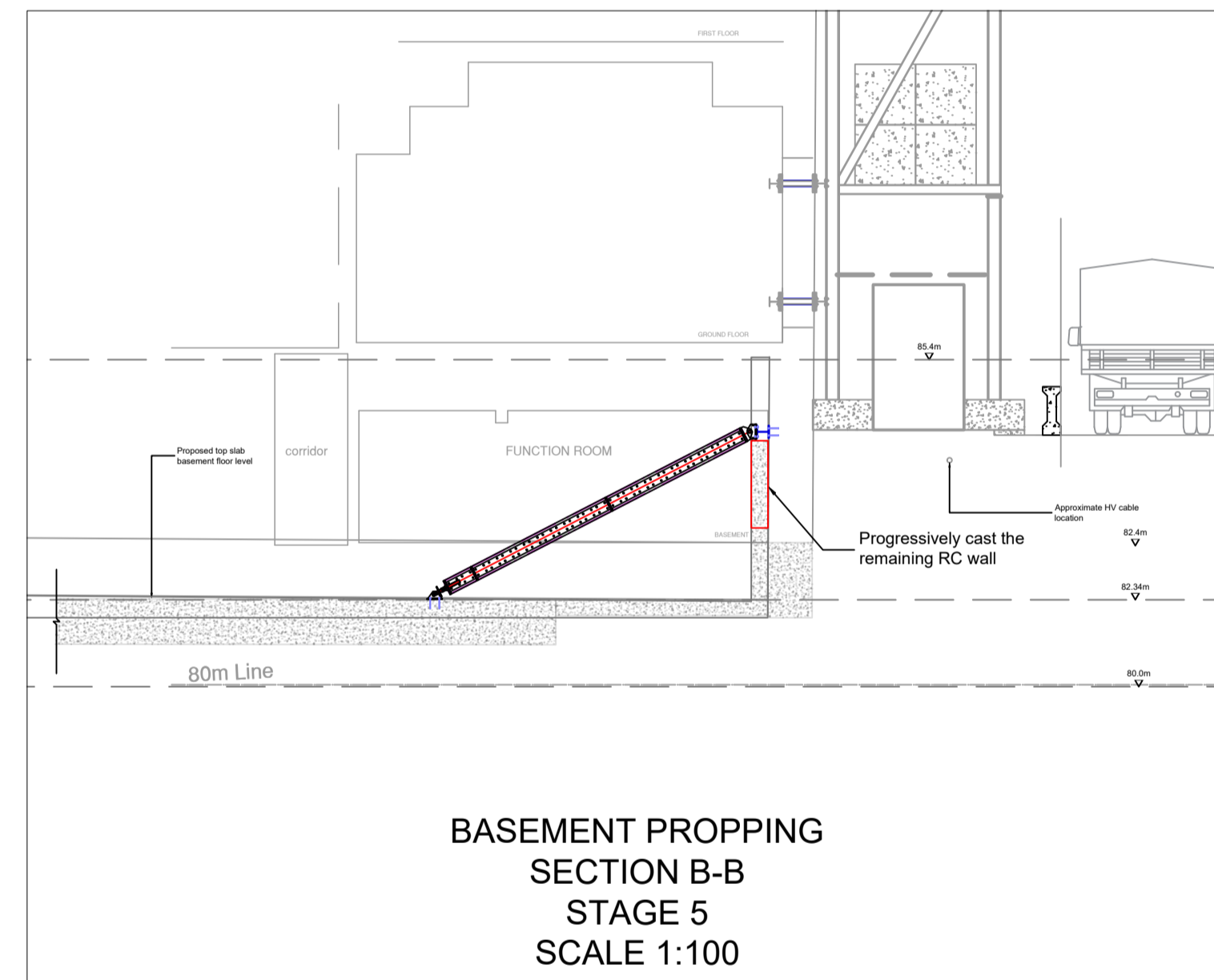

• Progressively cast the remaining RC wall

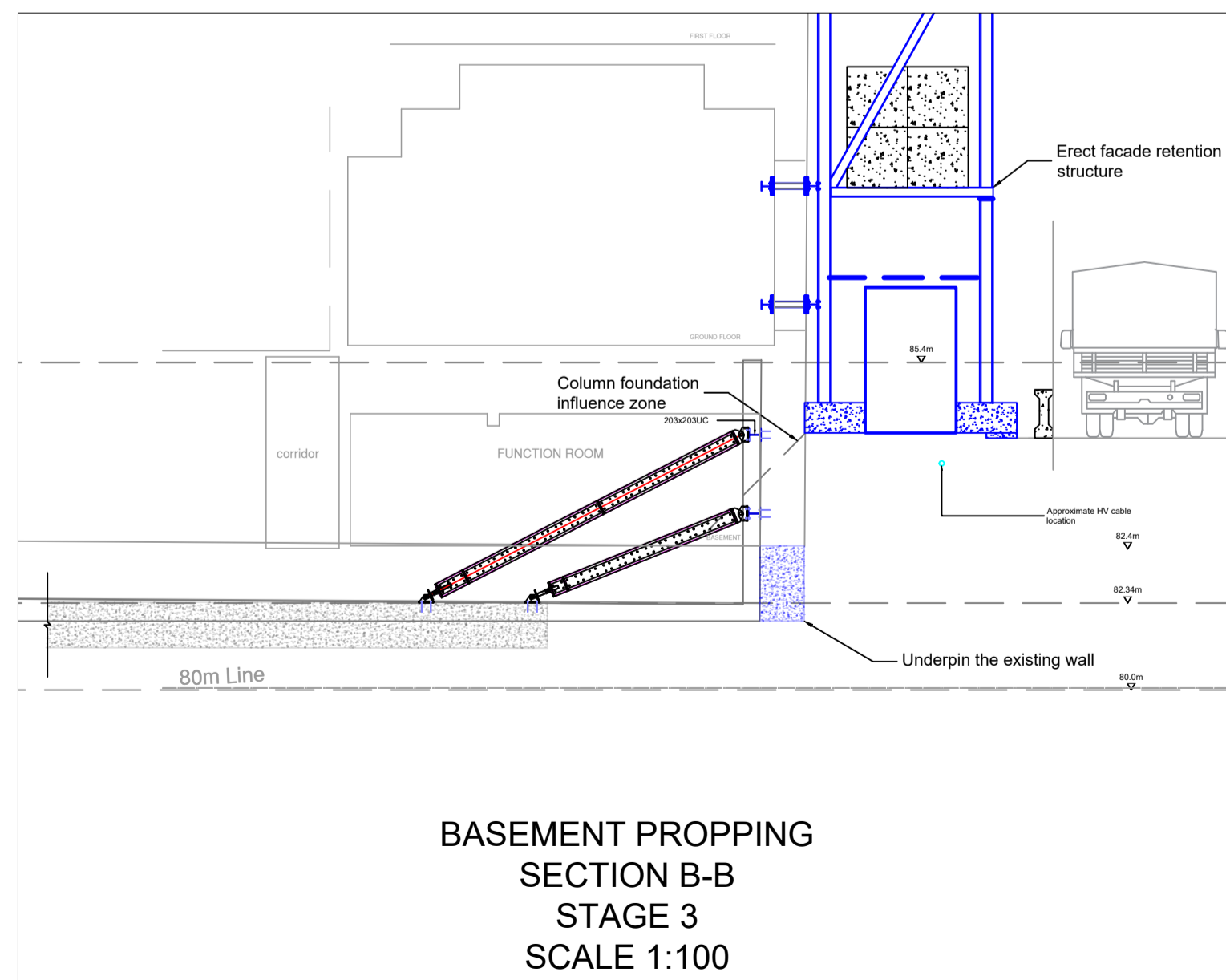

• ERECT THE FACADE RETENTION STRUCTURE AND UNDERPIN THE EXISTING BASEMENT WALLS

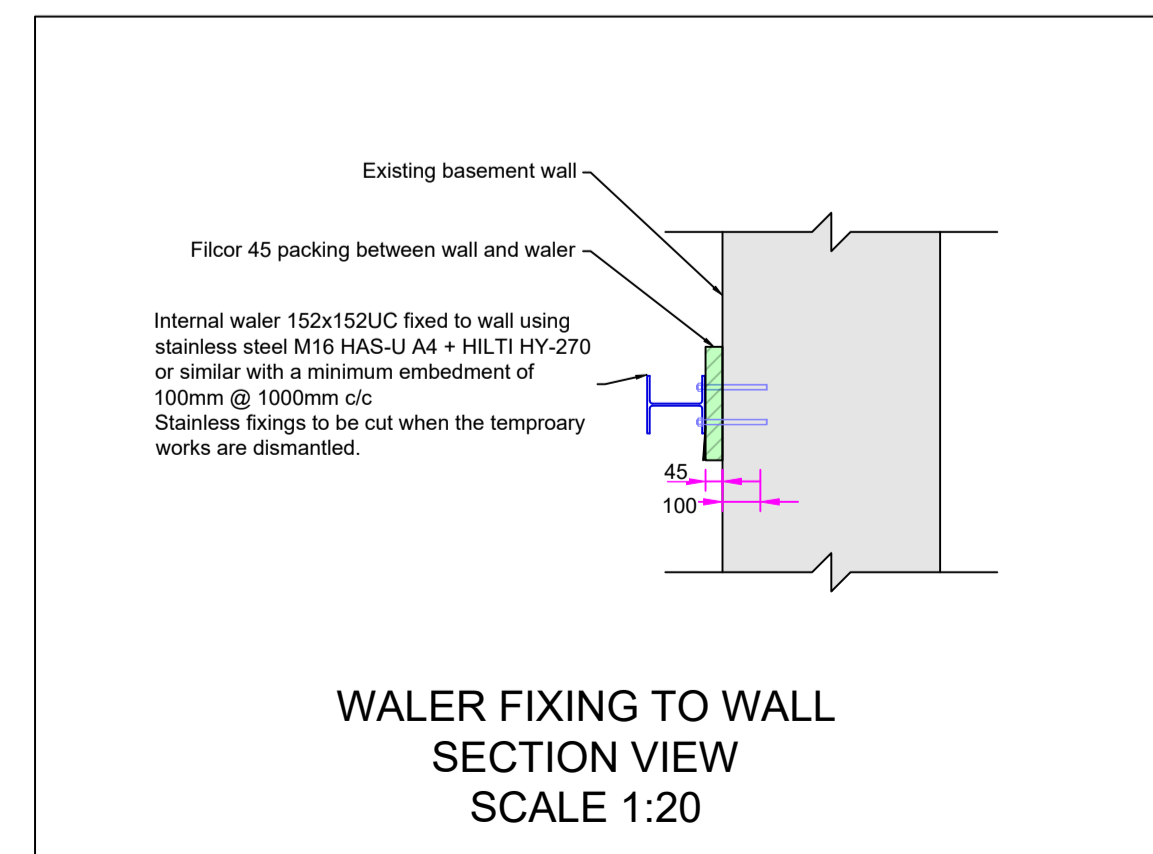

DEMOLITION WORKS

DEMOLITION WORKS TO BE COMPLETED USING THE APPROPRIATE EQUIPMENT.

NOTES

- NO FIXING TO FACADE FROM THE OUTSIDE.
- ALL ANCHORS MUST BE INSTALLED IN ACCORDANCE WITH THE MANUFACTURERS RECOMMENDATIONS.
- SIMILAR ANCHORS MAY BE APPLIED, PROVIDING THE INSTALLATION & ADEQUACY IS IN ACCORDANCE WITH THE MANUFACTURER SPECIFICATION.
- PROPS DESIGNED FOR 10 kN ACCIDENTAL LOAD
- STRUCTURE COULD BE OPTIMISED AT A LATTER STAGE

PROPPING SEQUENCE

1. LOCALLY EXCAVATE BELOW CURRENT BASEMENT LEVEL TO CAST THRUST BLOCKS.
2. INSTALL TOP AND BOTTOM WALERS ALONG WEST AND EAST ELEVATIONS
3. INSTALL PROPPING
4. ERECT FACADE RETENTION STRUCTURE AND UNDERPIN THE EXISTING BASEMENT WALLS
5. CAST THE NEW BASEMENT SLAB AND CANTILEVER RC STUB IN FRONT OF THE THRUST BLOCKS
6. UNDERPINNING AND CAST REMAINING BASEMENT WALLS BETWEEN THE THRUST BLOCKS
7. REMOVE BOTTOM PROPPING AND WALER
8. PROGRESS WITH BASEMENT WALL
9. RESTORE 1ST FLOOR STRUCTURE
10. REMOVE PROPPING AND FACADE RETENTION PROGRESSIVELY AS THE NEW FLOORS ARE INSTALLED AND ACHIEVE THE REQUIRED STRENGTH

NOTES:
This drawing is confidential and is the exclusive property of RDG Engineering Ltd. No unauthorized use, copy or disclosure is to be made and is to be returned upon request. Hire Only - All plant supplied on the basis is subject to our conditions of hire or sale as applicable.

Drawing Notes:
READ ALL NOTES ON DRAWING.

ALL bracing / restraints are to be installed as per drawing.

All design and erection of scaffolds are to conform with the following British Standards and Codes Of Practices where applicable:

TG 20:13	2013 Design Guide - Technical guidance on the use of BS EN 12811-1
TG 04:11	2011 Anchorage Systems
BS EN 12811-1	2003 Temporary works equipment - Part 1: Scaffolds - Performance requirements and general design
BS EN 12812	2008 Falsework - Performance requirements and general design
BS EN 13374	2013 Temporary edge protection systems - Product specification - Test methods
BS EN 39	2001 Loose steel tubes for tube and coupler scaffolds - Technical delivery conditions
BS EN 1991-1-1	2002 Eurocode 1: Actions on structure - Densities, self-weight and imposed loads
BS EN 1993-1-1	2005 Eurocode 3: Design of steel structures - Part 1-1: General rules and rules for Buildings
BS 5975:2019	Code of practice for temporary works procedures and the permissible stress design of falsework

No alteration in or which may effect the loading is to be made without reference to RDG Engineering Design Office.

Dimensions:
All dimensions are in mm and centre to centre unless otherwise stated. Written dimensions will take precedence over scaled dimensions.

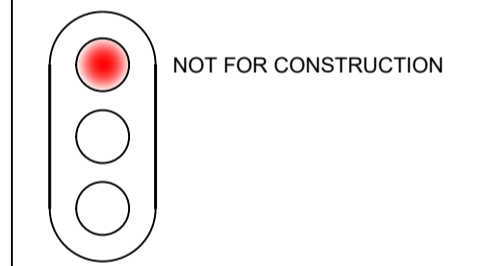

P1	06/12/22	Issued For Approval	NF	NF	PS	RDG
ISSUE	DATE	DESCRIPTION OF ISSUE	DRN	ENG	CHECKED	APPROVED

CLIENT
BOWMAN RILEY ARCHITECTS LTD

RDG
ENGINEERING (TW) LTD

Derbyshire House, St Chad's Street, London.
WC1H 8AG. tel: 020 7036 1650
e-mail: design@rdgengineering.co.uk

PROJECT
THE GEORGE HOTEL

DRAWING TITLE
BASEMENT PROPPING SEQUENCE OF WORKS SECTION

CLIENT'S DRAWING REFERENCE

SCALE @ A1	RDG ENGINEERING DRG No. 5797-01-01-02-005	ISSUE P1
----------------------	---	--------------------

THIS DRAWING AND THE INFORMATION CONTAINED IS CONFIDENTIAL AND IS THE PROPERTY OF RDG ENGINEERING (TW) LTD. IT IS ISSUED ON THE CONDITION THAT IT SHALL NOT BE REPRODUCED COPIED OR PASSED TO THIRD PARTIES WITHOUT THE WRITTEN APPROVAL OF RDG ENGINEERING (TW) LTD.