

**2 Huddersfield Masterplan - Proposed LG Mezzanine Level Demolition Plan**  
1:500

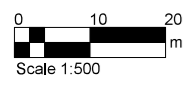
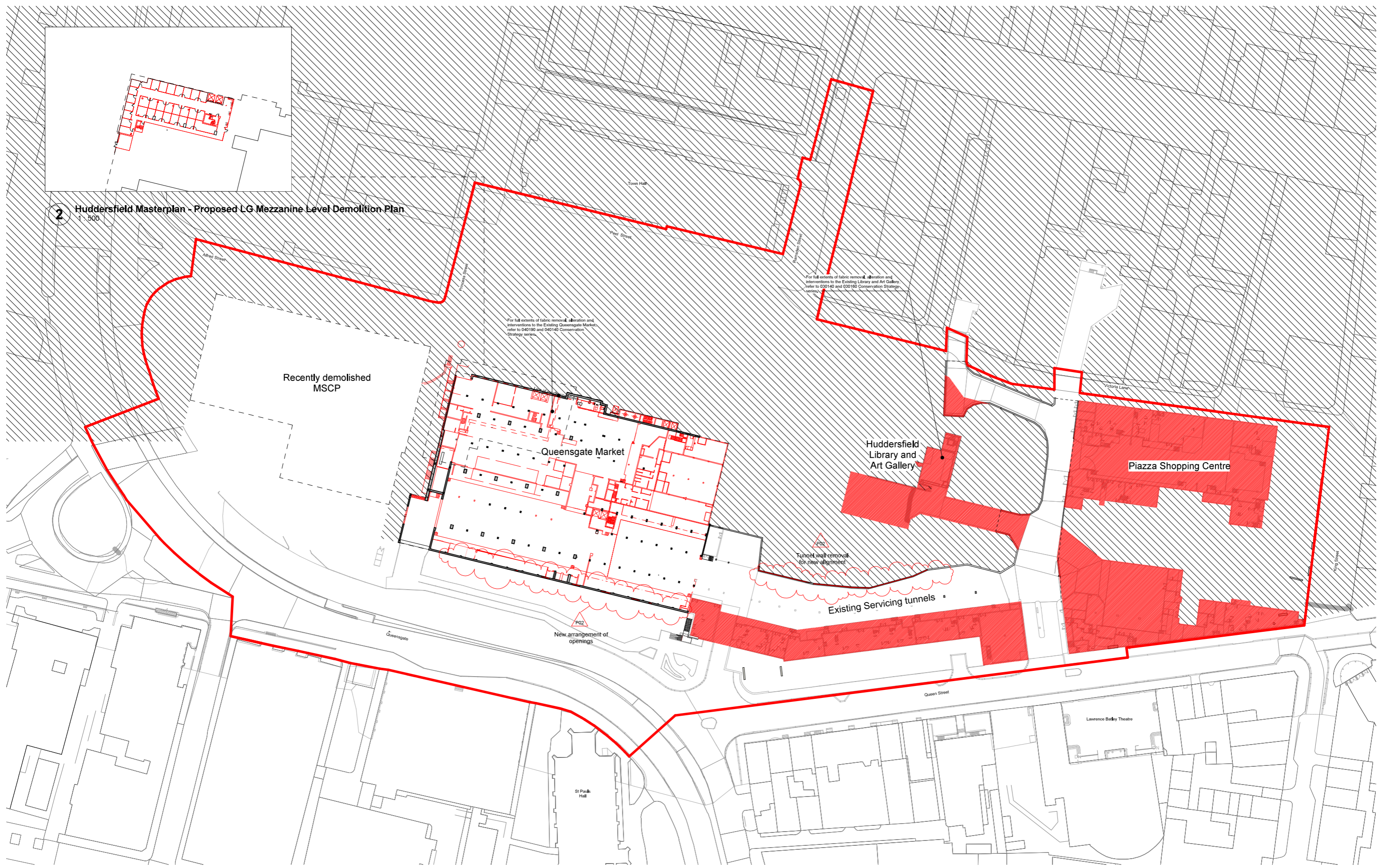

- Notes:**
- Dimensions are not to be scaled from this drawing.
  - Drawing only to be used for the purposes it was issued for.
  - Landscape, public realm and neighbouring buildings shown indicatively.
  - Existing locations and footprints of surrounding buildings are taken from: (OS Map - Promap-1634985-1735589-720-0.dwg) received 2021,10,27; (21359-100-Topo-Millimetres.dwg) received from Millby Surveys on 2022,02,23
  - Existing building plans and elevations are based on Millby Surveys drawings received on 2022,05,18 and 2022,05,19

**Legend**

- Planning Boundary
- Significant areas of removal
- Fabric removal

Planning Boundary Line and OS context taken from Kirklees Council Ordnance Survey © Crown copyright 2022. All rights reserved. Licence number 100007514.

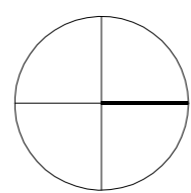

FeldenCleggBraceleyStudios  
LLP  
London Office  
Tottenham Street  
London  
W1T 4RG  
t +44 20 7323 5737  
e london@fcbstudios.com

| Rev | Status   | Date     |
|-----|--|----------|
| P01 | S2 Issued for Planning and Listed Building Consent | 30.09.22 |
| P02 | S2 Issued for Planning and Listed Building Consent | 01.12.22 |

Job/Drawing No  
**CDT430201-FCB-XX-LG-DR-A-020140**

Kirklees Cultural Heart  
Huddersfield Masterplan - Proposed Lower Ground Floor Demolition Plan

Scale As indicated@A1  
Date 15.07.22

Drawn London Studio  
Checked AW Group

Revision  
**P02**  
Status  
**S2**

FCBS project no  
CDT430201

Do not scale All dimensions to be checked on site