



Use Class
Entire Building to be Use Class "Sui-Generis"

KEY

-  Existing Fabric
-  Proposed / New Build Elements
-  Planning Boundary Line

Planning Boundary Line and OS context taken from Kirklees Council Ordnance Survey © Crown copyright 2022. All rights reserved. Licence number 100007514.

NOTES

- Dimensions are not to be scaled from this drawing.
- Drawing only to be used for the purposes it was issued for.
- Landscape, public realm and neighbouring buildings shown indicatively.
- Existing locations and footprints of surrounding buildings are taken from: (OS Map - Promap-1634985-1735589-720-0.dwg) received 2021.10.27; (21359-100-Topo-Millimetres.dwg) received from Maltby Surveys on 2022.02.23
- Existing building plans and elevations are based on Maltby Surveys drawings received on 2022.02.18 and 2022.03.15

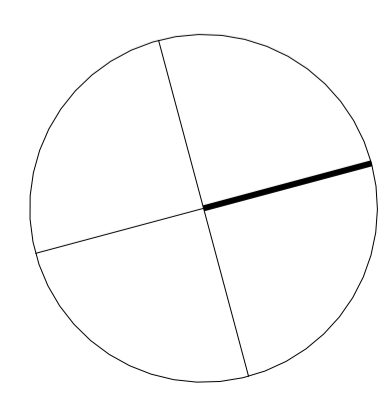
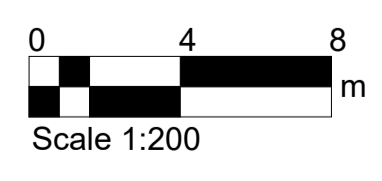
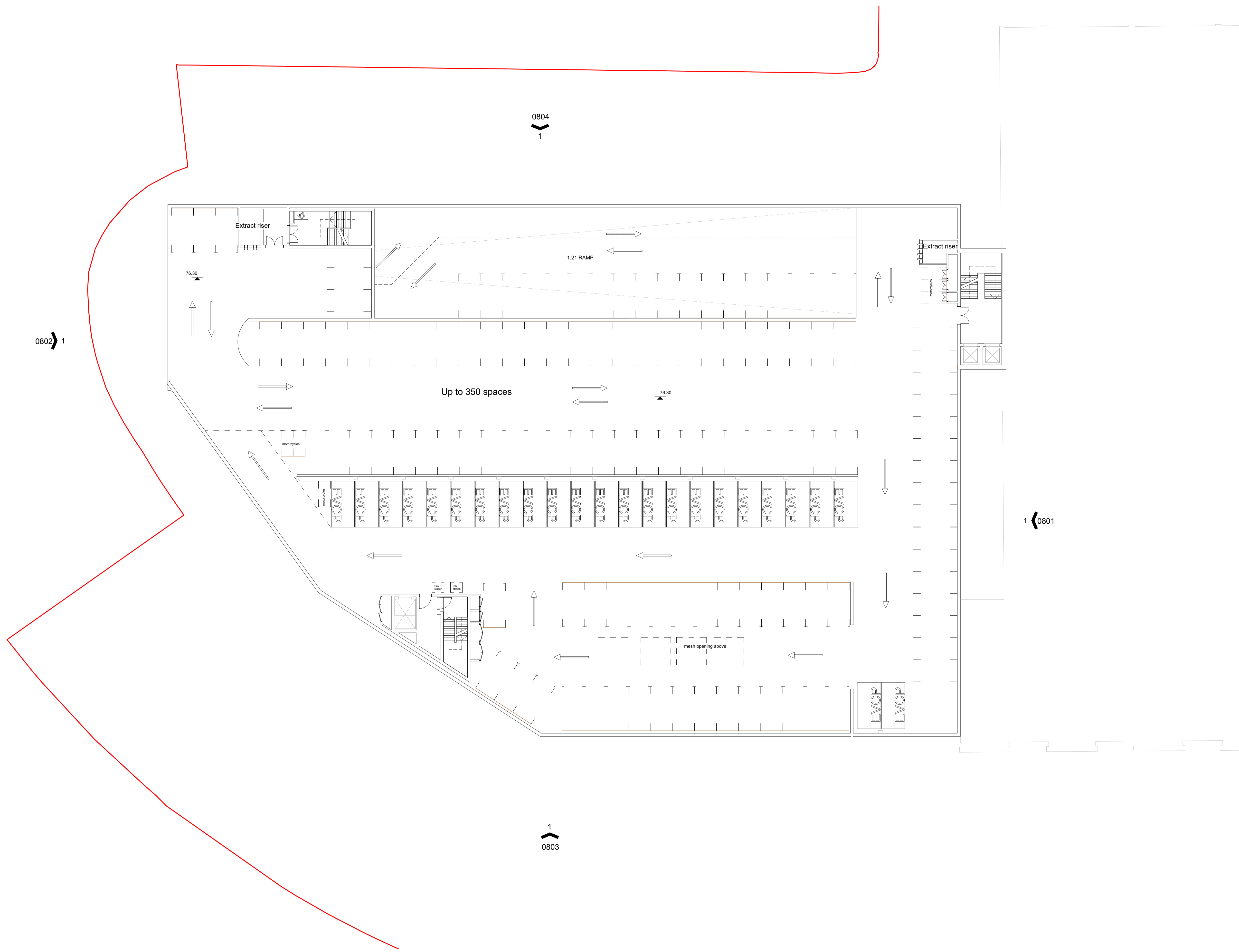

FeildenCleggBradleyStudios
LLP

London Office
Tottenham Street
London
W1T 4RG

t +44 20 7323 5737
e london@fcstudios.com

Rev	Status	Date
P01	S2 Issued for Planning and Listed Building Consent	30/09/22

Job/Drawing No	Revision
IR430303-FCB-XX-B1-DR-A-050212	P01

Kirklees Cultural Heart
Huddersfield Venue - Proposed Basement B1 Plan
Status
S2

Scale	Drawn	Checked	Date	FCBS project no
1 : 200@A1	London Studio	London Studio	30.09.22	IR430303

Do not scale All dimensions to be checked on site