

PROJECT: RELOCATION OF PREFAB DOUBLE GARAGE AT 36a NEW NORTH ROAD,
HECKMOND WIFE, WEST YORKSHIRE, WF16 9DH

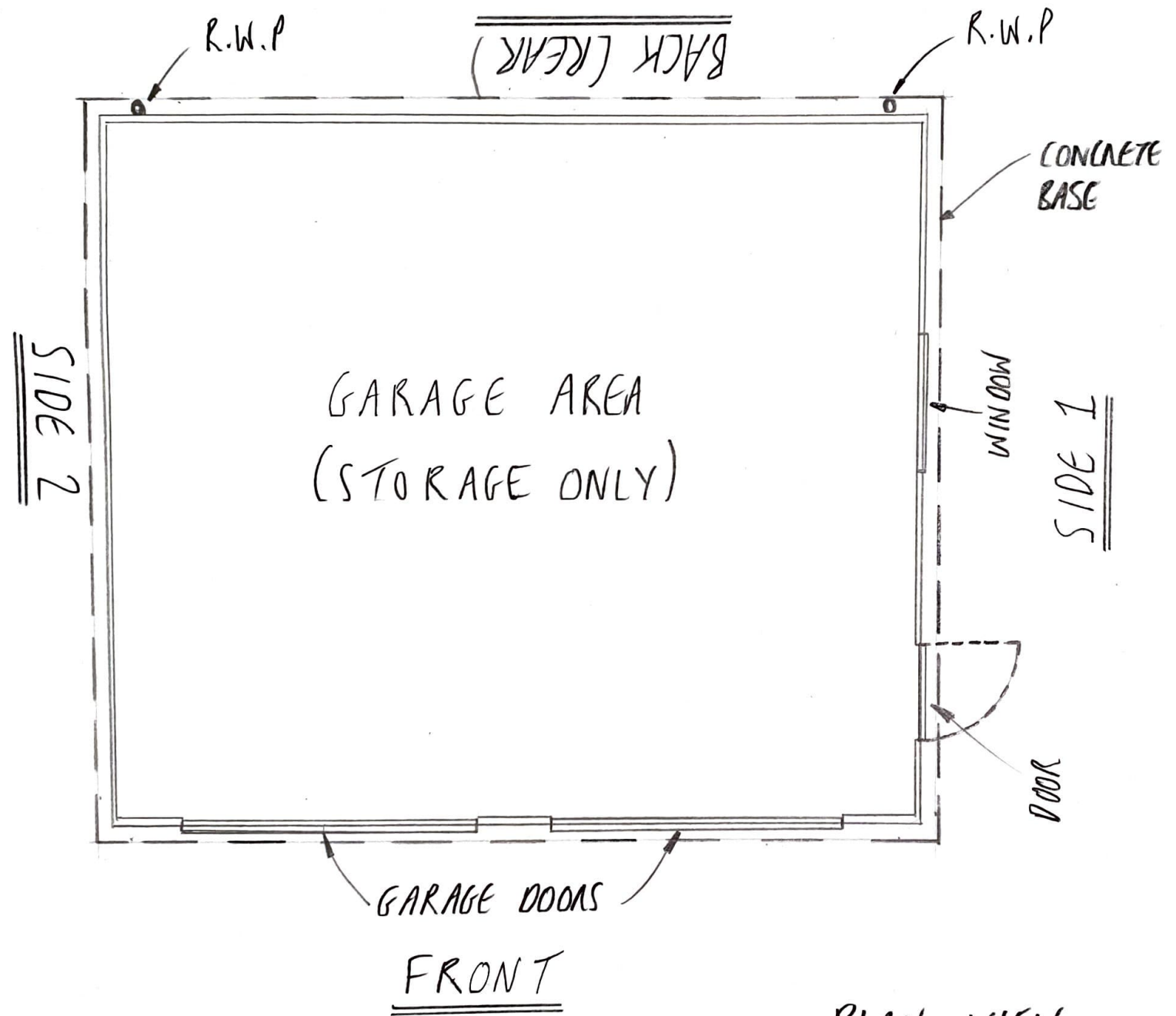

- NOTES:
1. GARAGE (MAIN) DOORS ARE OF PAINTED STEEL CONSTRUCTION
 2. GARAGE DOORS OPEN VERTICALLY
 3. SINGLE DOOR ON SIDE 1 IS OF PAINTED STEEL CONSTRUCTION
 4. GARAGE WILL SIT ON A SOLID CONCRETE BASE APPROX. 8" THK WITH A 4" OVERLAP ON ALL SIDES
 5. THE NEW BASE LOCATION WILL NOT IMPEDE ACCESS TO SERVICES.

SCALE: 1:50

CLIENT:
MR & MRS M QUAYLE

PLAN VIEW