

Existing Survey Levels Omitted for Clarity

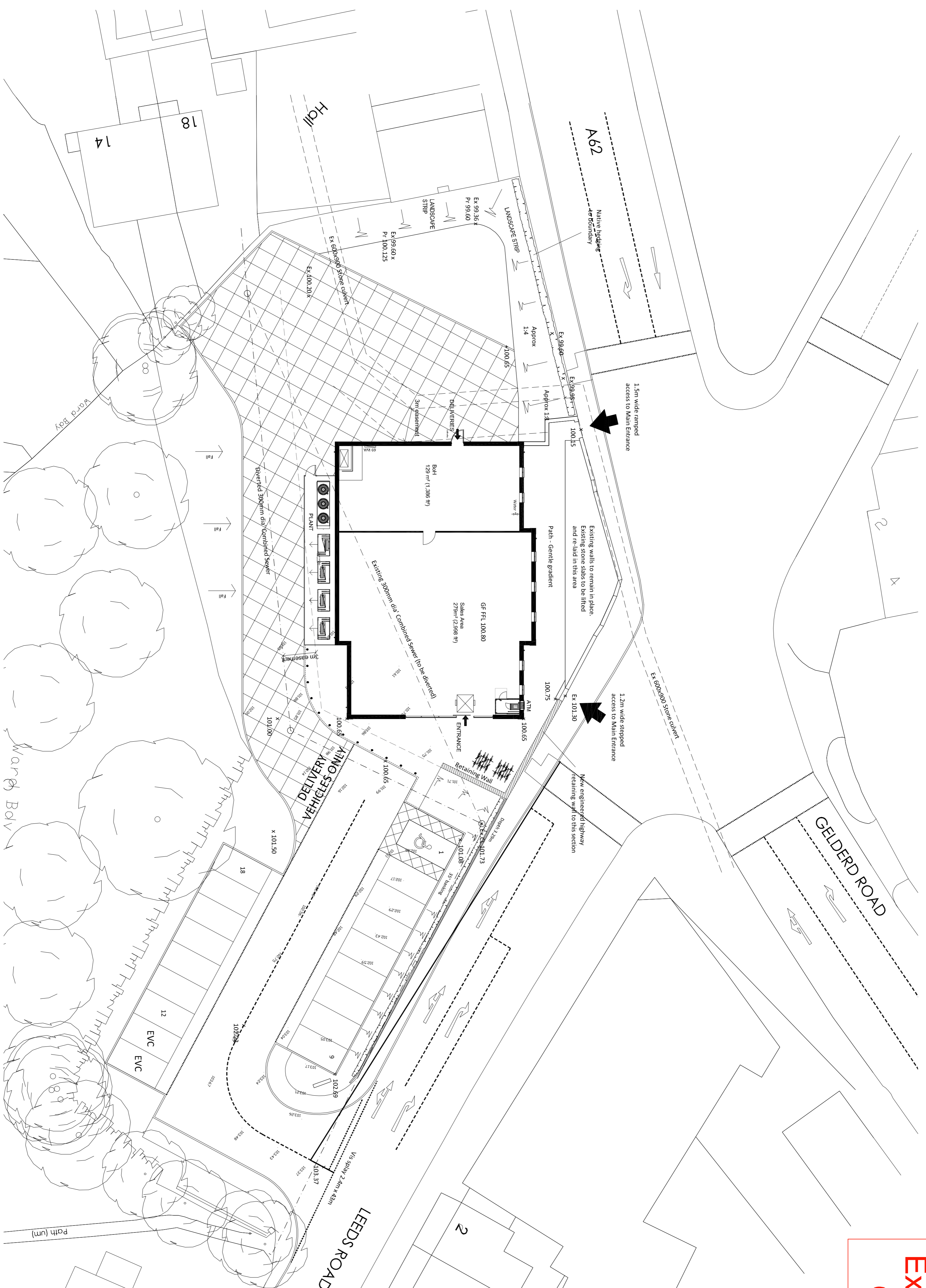

Rev	Description	By	Check	Date
P7	Amended to accommodate vehicle loading for new unbranded vehicle	RL	MM/J	06.03.22
P6	Amended to suit revised building services	RL	MM/J	06.03.22
P5	Amended to show 2nd EVC column	RL	MM/J	26.11.21
P4	Amended following consultation with client team	RL	MM/J	10.11.21
P3	For distribution, including meeting with external design team	RL	MM/J	16.02.21
P2	Issues to client and design team	RL	MM/J	16.02.21
P1	Issues to client and design team	RL	MM/J	17.02.21
Rev	Description	By	Checked	Date

Document Status: **S2**
Purpose of Issue: **For Information**

MARTIN WALSH ARCHITECTURAL
MWA

Firm Buildings: 99 - 103 Leeds Rd, Dewsbury, WF12 7BU
e: info@martinwalsh.co.uk w: www.martinwalsh.co.uk

Project: New Build Convenience Store at 1 Leeds Road, Birstall

Title: Proposed Site Plan
Client: Wharfedale Ltd.

MWA Project Ref: Scale: Original Paper Size: Paper Orientation: Drawn: 6228 @A1 Landscape RL

File Identifier: Originator: Volume: Level: Type: Role: Number: Revision: WLLR - MWA - XX - XX - DR - A - 1001 P7

Copyright © 2022 Martin Walsh Architectural. All Rights Reserved.
Martin Walsh Architectural is the trading name of Martin Walsh Architectural Limited. Registered in England Number: 0660933