

2m 4 6 8 10 12 14 16 18 20

ARCHITECTURE | PLANNING | DESIGN

Main Form
 Brow Lane
 Holmfirth
 HD9 2RJ
 07946872499
 paul@paulmatthewsarchitectural.co.uk
 www.paulmatthewsarchitectural.co.uk

Project
 Erection of Two Dwellings on Land adj 34 Cliff
 Road, Holmfirth, HD9 1UV.
 Client

Company Registration Number: 09898149 – Company
 Registered in England and Wales

Green End Construction
 Drawing Title/Issue

Proposed Site Layout
 scale 1:200 date 10/19 sheet size A2 dwg. no. 19/559/03f

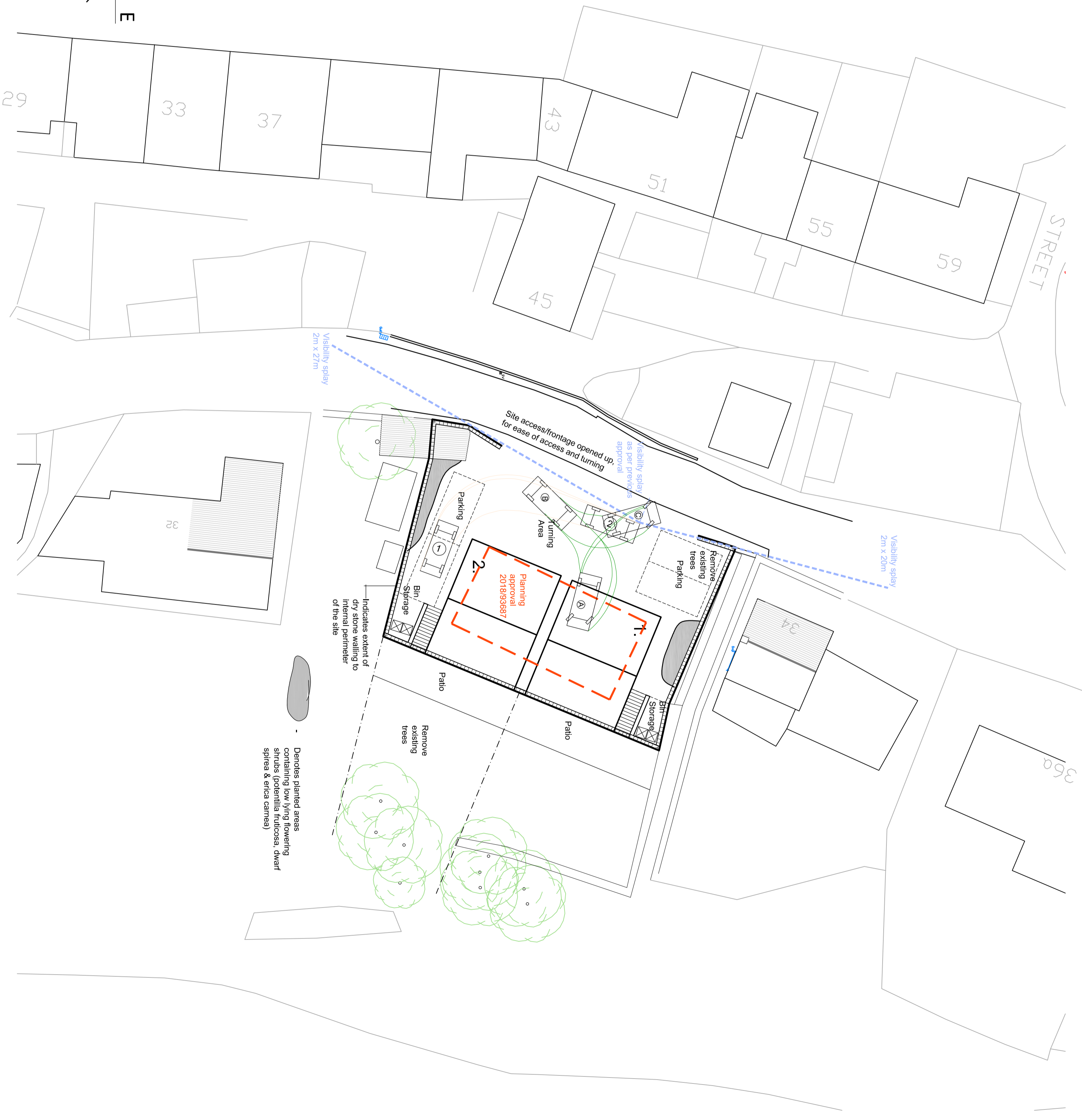
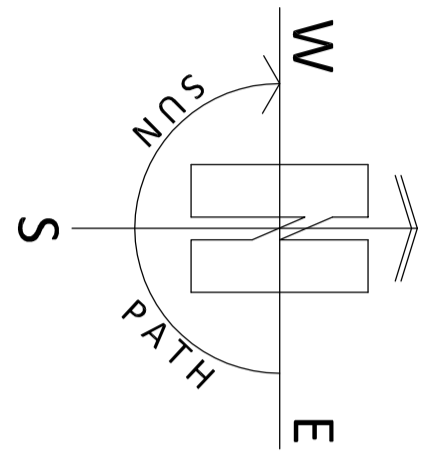

- Denotes planted areas
 containing low lying flowering
 shrubs (potentilla fruticosa, dwarf
 spiraea & erica carnea)

- Indicates extent of
 dry stone walling to
 internal perimeter
 of the site

Planning
 approval
 2018/93687

Site access/frontage opened up,
 for ease of access and turning

Visibility splay
 as per previous
 approval

Visibility splay
 2m x 27m

Visibility splay
 2m x 20m

STREET

36a

29

33

37

43

45

51

55

59

32

34