

DO NOT SCALE

NOTES:
 1. ALL DIMENSION IN MILLIMETERS (mm) AND ALL LEVELS IN m AOD UNLESS SPECIFIED OTHERWISE.

LEGEND:
 - ADAPTABLE KNDC RETAINING WALL
 - PROPOSED PROW LEVEL
 - PROPOSED PROW GRADIENT (ARROW INDICATES DIRECTION OF FALL)
 - EXISTING LEVEL
 - VISIBILITY SPLAY
 - MULTI MODAL LINK

REFERENCE:
 HB040-0736_DETAILS - ENGINEERING_AFU_-_S38 PH2 GUARD RAIL DETAILS

PLAN
SCALE 1:200

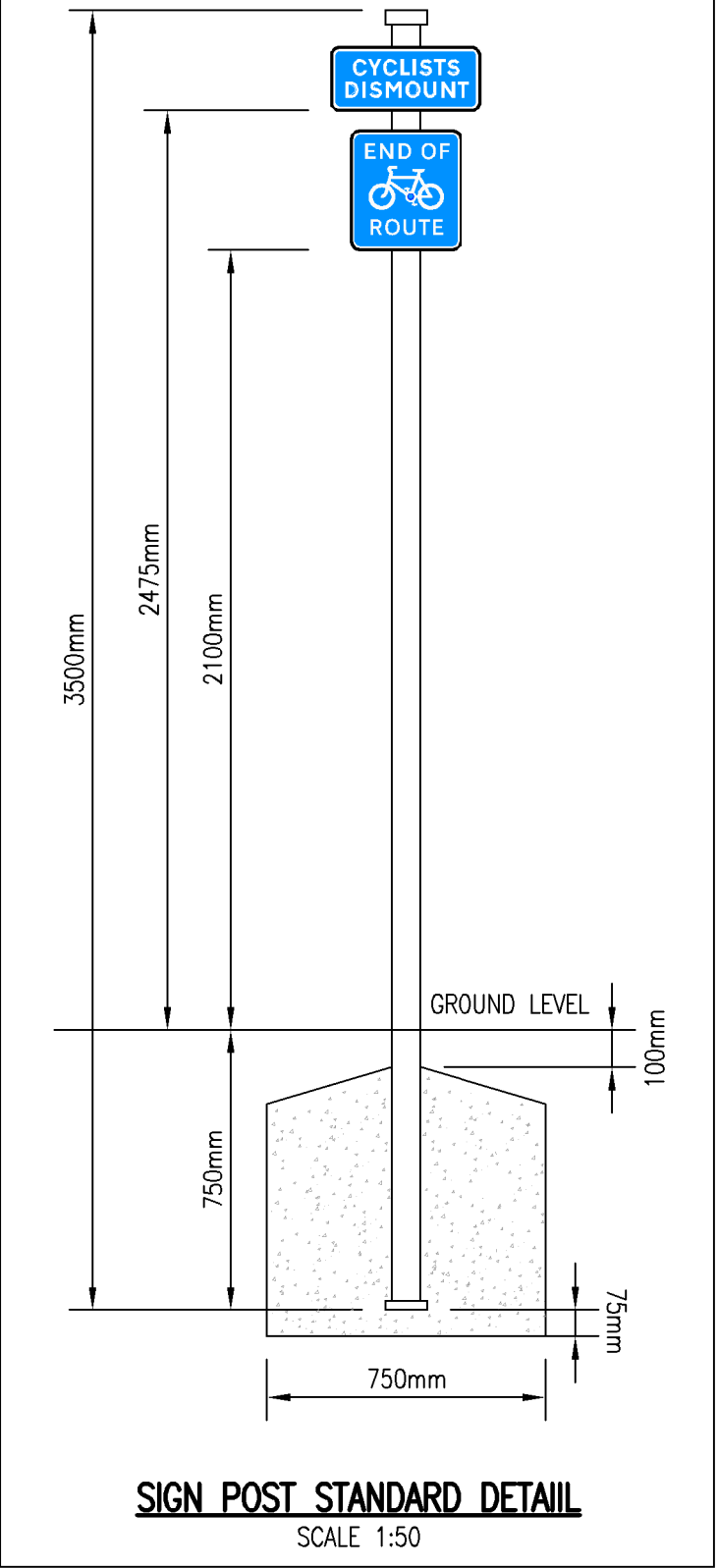
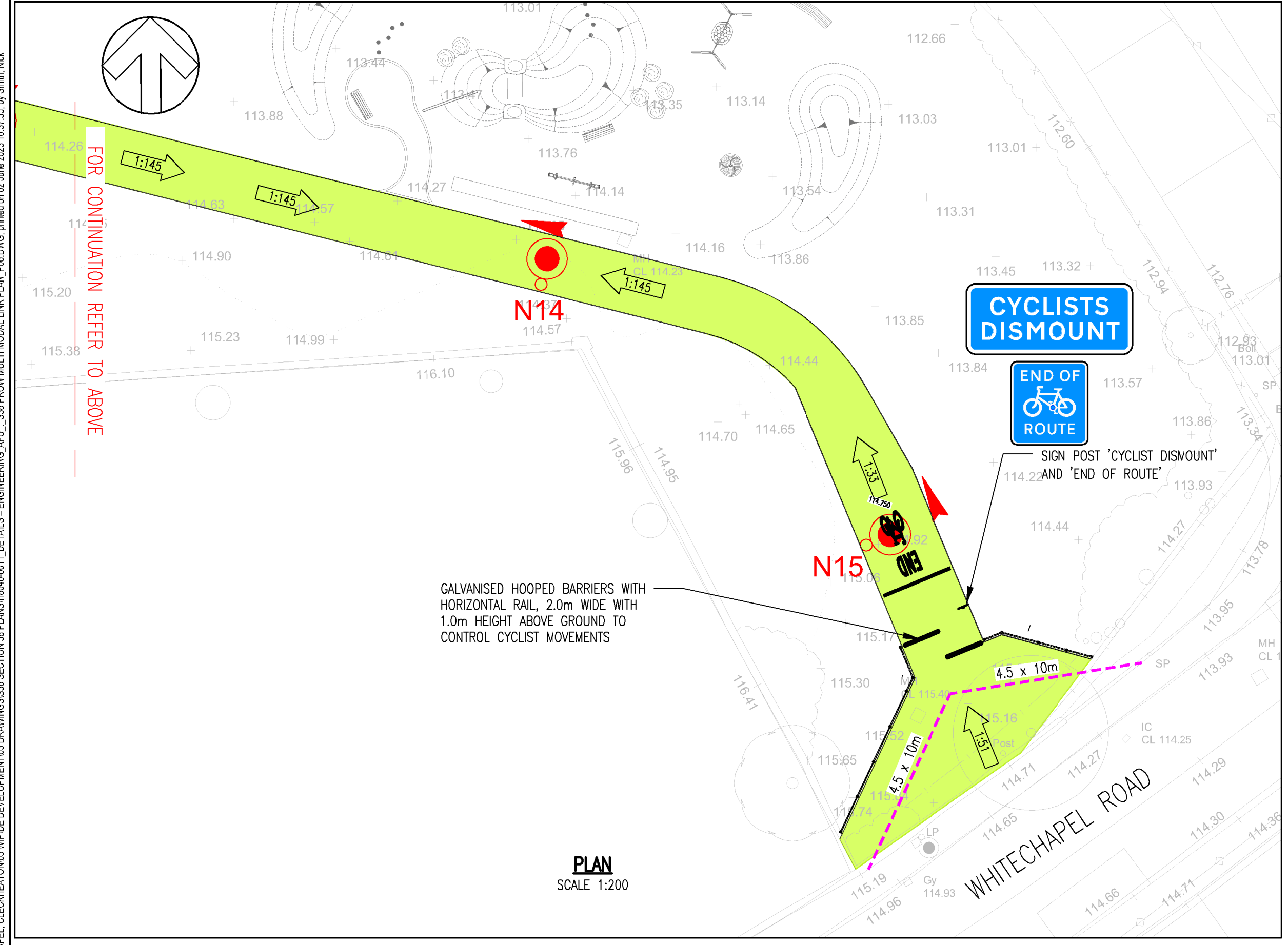

STRUCTURAL CALCULATION DETAILS

SIGNS:
 REFERENCE: SIGN 1
 WIDTH: 400mm, HEIGHT: 175mm
 SHAPE: RECTANGLE
 ORIENTATION: FACING FRONT
 MOUNTED ON POSTS: 1
 MOUNTING HEIGHT: 2475mm, AT POST

REFERENCE: SIGN 2
 WIDTH: 295mm, HEIGHT: 325mm
 SHAPE: RECTANGLE
 ORIENTATION: FACING FRONT
 MOUNTED ON POSTS: 1
 MOUNTING HEIGHT: 2100mm, AT POST

POSTS:
 QUANTITY: 1
 TYPE: 76.1 X 3.2 CHS
 SPACING: N/A
 POST 1 LENGTH: 3600mm

BASE:
 TYPE: PLANTED
 DIAMETER: 750mm
 EARTH COVER: 100mm

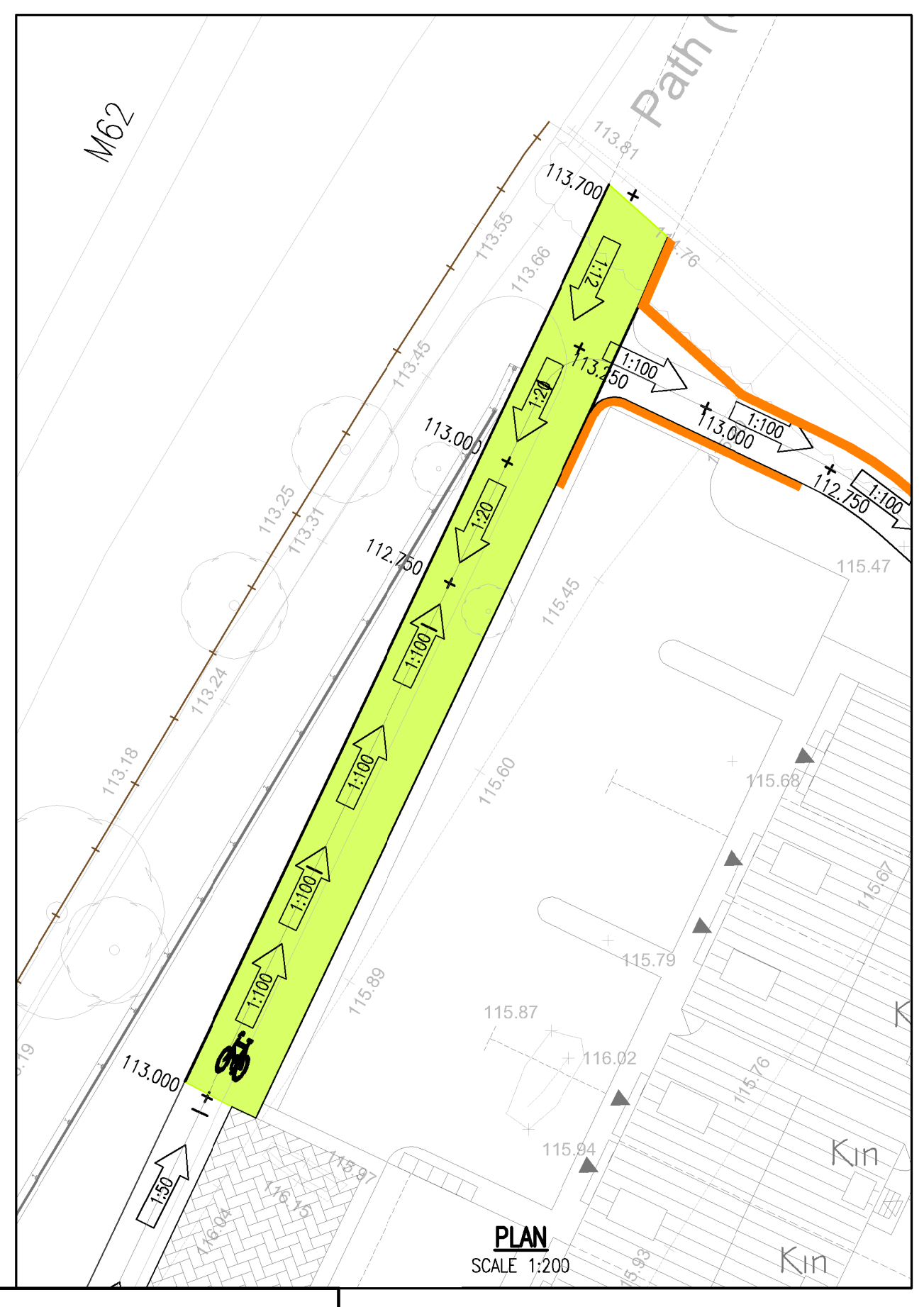

PLAN
SCALE 1:200

UNTIL TECHNICAL APPROVAL HAS BEEN OBTAINED FROM THE RELEVANT LOCAL AUTHORITIES OR STATUTORY BODIES, IT SHOULD BE UNDERSTOOD THAT ALL DRAWINGS ARE ISSUED AS PRELIMINARY AND NOT FOR CONSTRUCTION. SHOULD THE CONTRACTOR AND / OR EMPLOYER COMMENCE WORK PRIOR TO APPROVAL BEING GIVEN, IT IS ENTIRELY AT THEIR OWN RISK

POB	DATE	BY	DESCRIPTION	CHK	APP
P06	01/06/2023	MW	PROW RAMP UPDATED	N5	2P
P05	05/01/2023	MW	PROW RAMP UPDATED	N5	2P
P04	05/12/2022	MW	MULTI-MODAL LINK IN NW CORNER OF SITE ADDED	N5	2P
P03	02/12/2022	MW	PROW STEPS REPLACED WITH RAMP OPTION	N5	2P
P02	29/11/2022	MW	SIGNAGE DETAILS UPDATED	N5	2P
P01	28/11/2022	MW	FIRST ISSUE	N5	2P
REV	DATE	BY	DESCRIPTION	CHK	APP

DRAWING STATUS: **S2 - FOR INFORMATION**



CLIENT: **BDW HOMES WEST YORKSHIRE**

ARCHITECT: **JRP ARCHITECTURE**

SITE PROJECT: **WHITECHAPEL ROAD, CLECKHEATON**

TITLE: **S38 PROW MULTI MODAL LINK PLAN**

SCALE @ A1:	CHECKED:	APPROVED:
AS SHOWN	NS	DB
PROJECT NO:	DESIGNED:	DRAWN:
70055404	MW	MW
DATE:	DATE:	DATE:
June 23	June 23	June 23
DRAWING NO:	REV:	
H8040-0011 DETAILS - ENGINEERING_AFU_-_S38 PROW MULTI MODAL LINK PLAN	P06	

© WSP UK Ltd

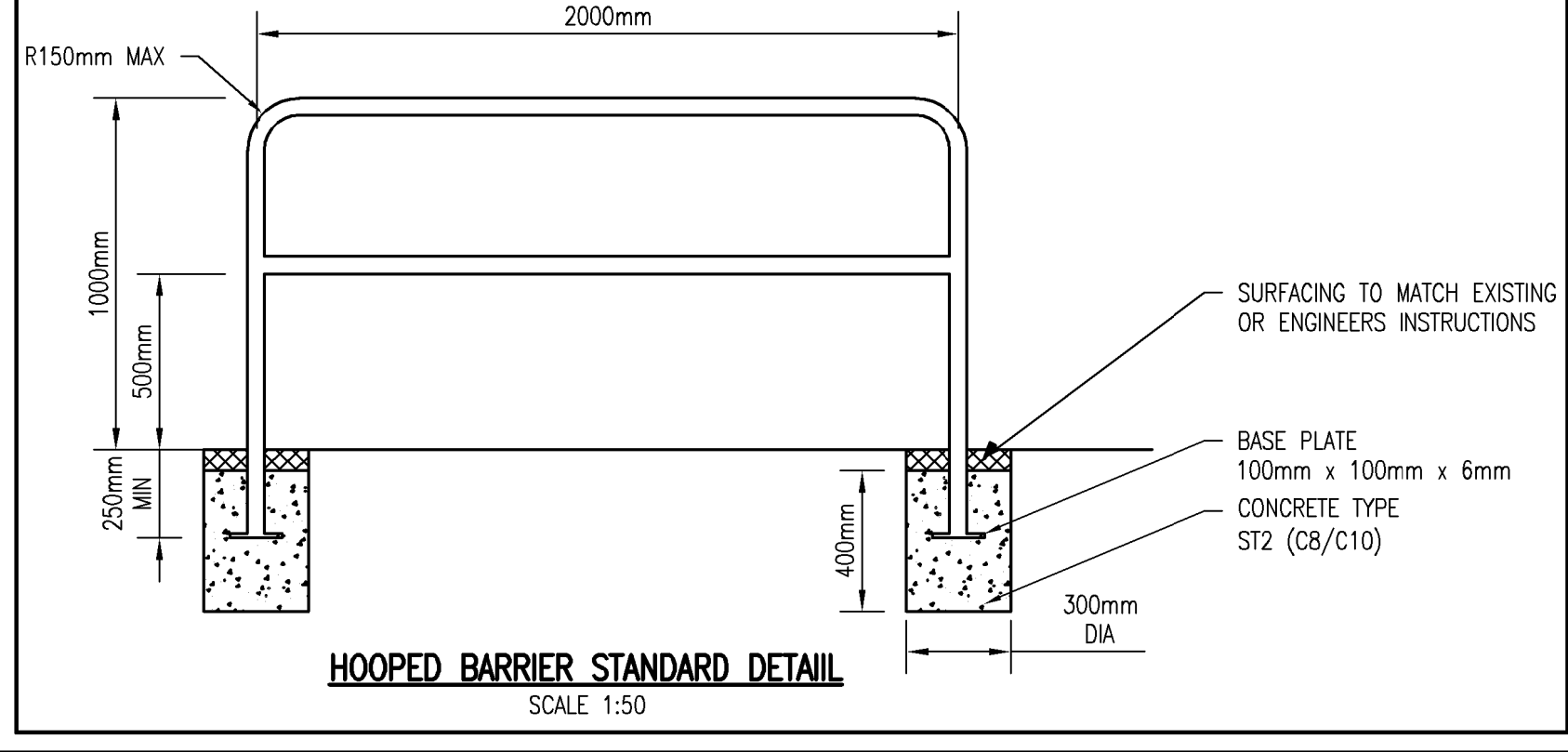
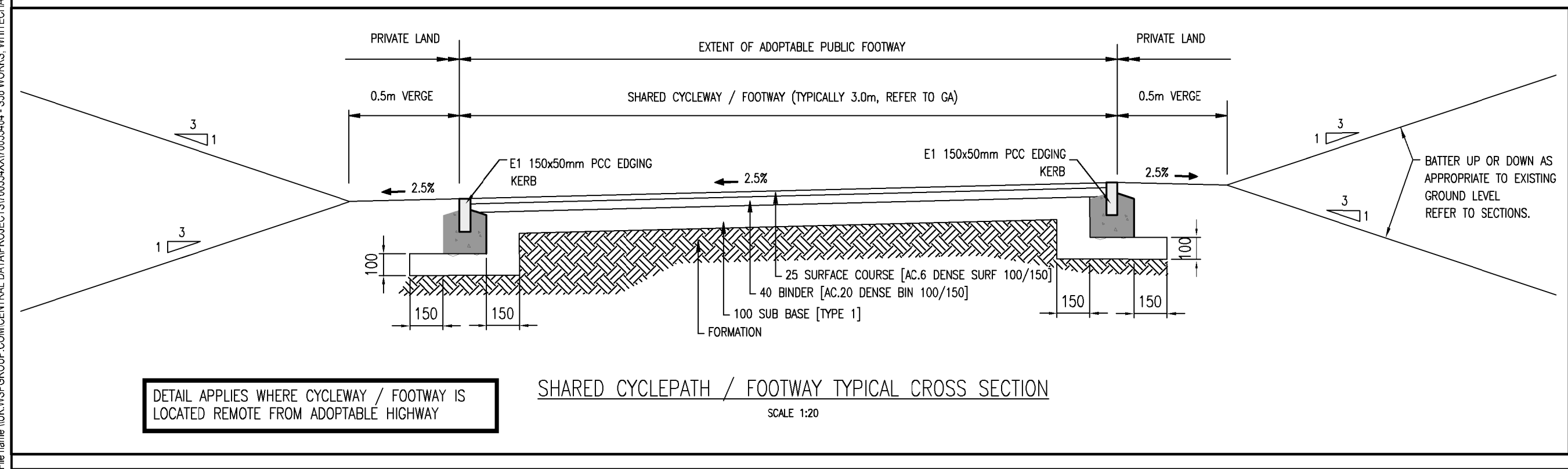

File name: I:\UK\WSPGROUP\COMCENTRAL\DATA\PROJECTS\70055404\0011\DETAILS - ENGINEERING_AFU_-_S38 PROW MULTI MODAL LINK PLAN_P06.DWG, printed on 02 June 2023 10:37:56 by Smith, Nick