

EXISTING SITE PLAN 1:500

101 Existing Property Boundary = 700.5m² (7540.1 ft²)

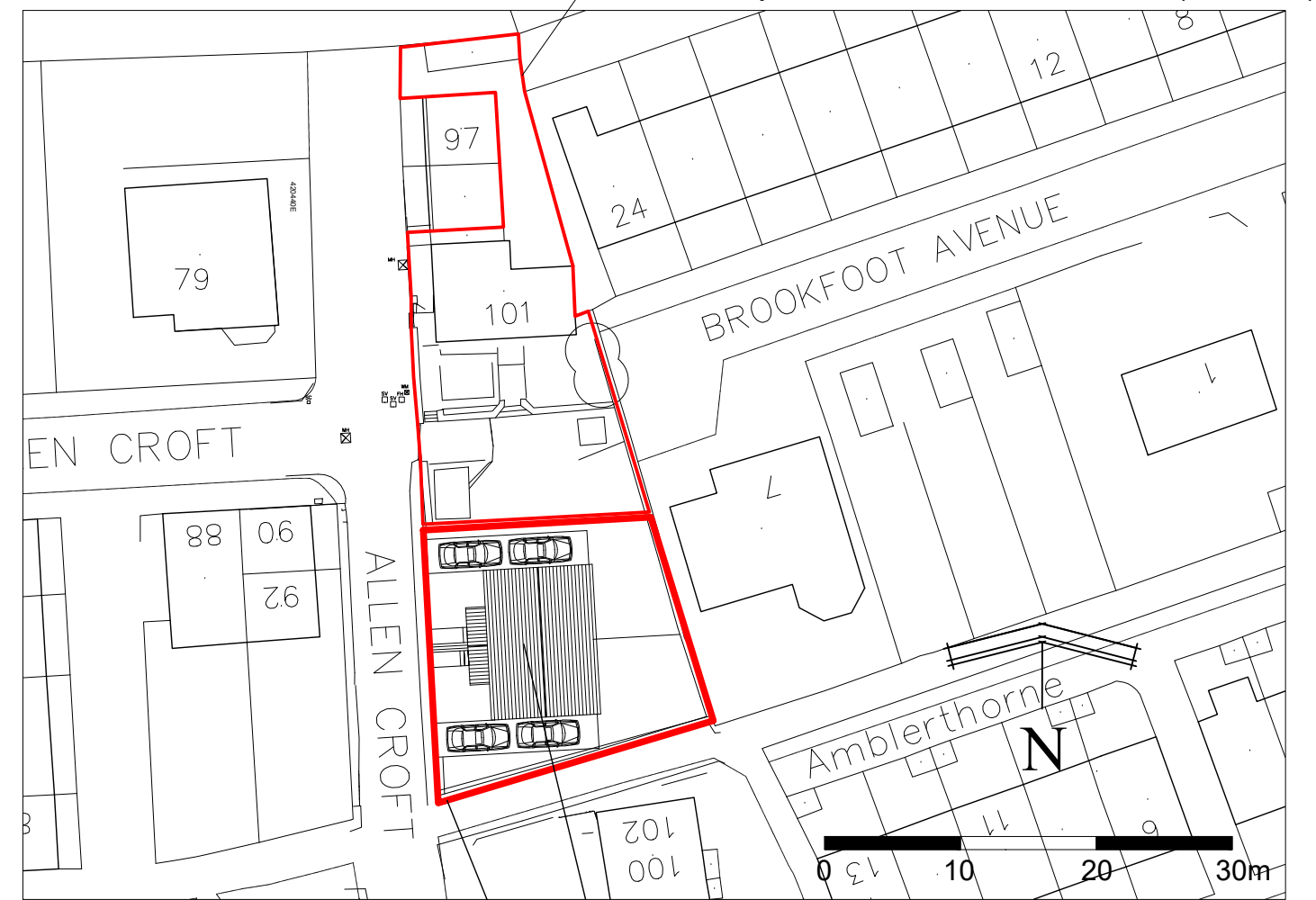

PROPOSED SITE PLAN 1:500

New boundary for No 101 Allen Croft 363.5m² (3912.7 ft²)
Two new semi detached two storey houses
New site boundary for 2 No new dwellings 337m² (3627.4 ft²)

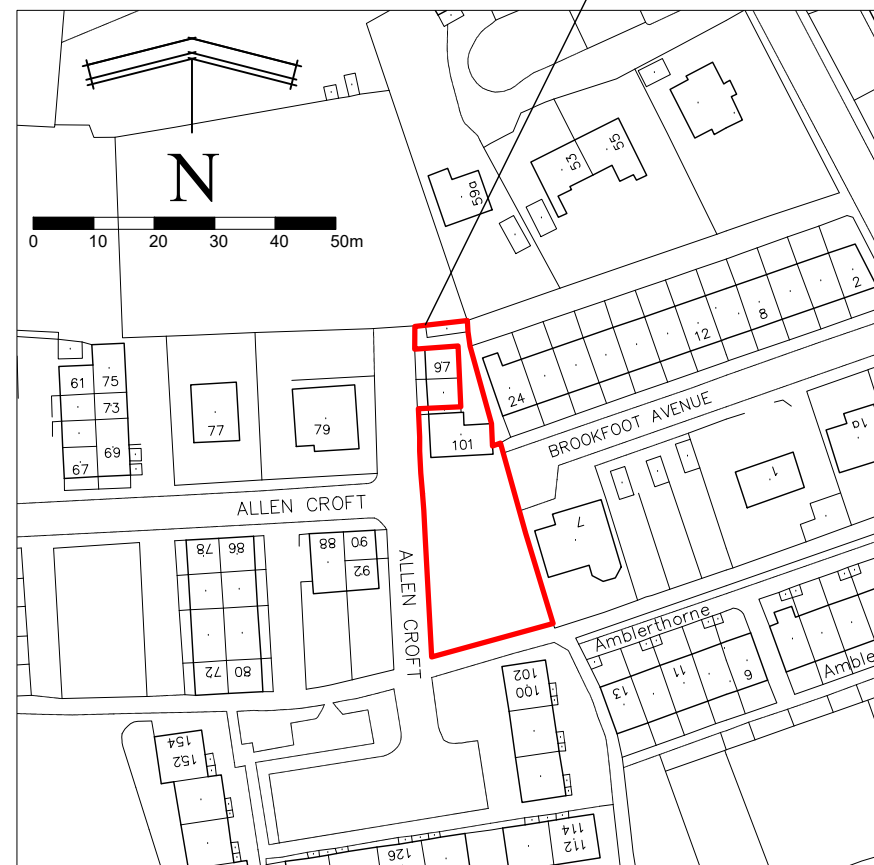

LOCATION PLAN & EXISTING BOUNDARY 1:1250

Map area bounded by: 420383,428333 420525,428475. Produced on 10 September 2021 from the OS National Geographic Database. Reproduction in whole or part is prohibited without the prior permission of Ordnance Survey. © Crown copyright 2021. Supplied by UKPlanningMaps.com a licensed OS partner (100054135). Unique plan reference: p2c/uk/687549/931098

New boundary for No 101 Allen Croft 363.5m² (3912.7 ft²)

Two new semi detached two storey houses

New site boundary for 2 No new dwellings 337m² (3627.4 ft²)

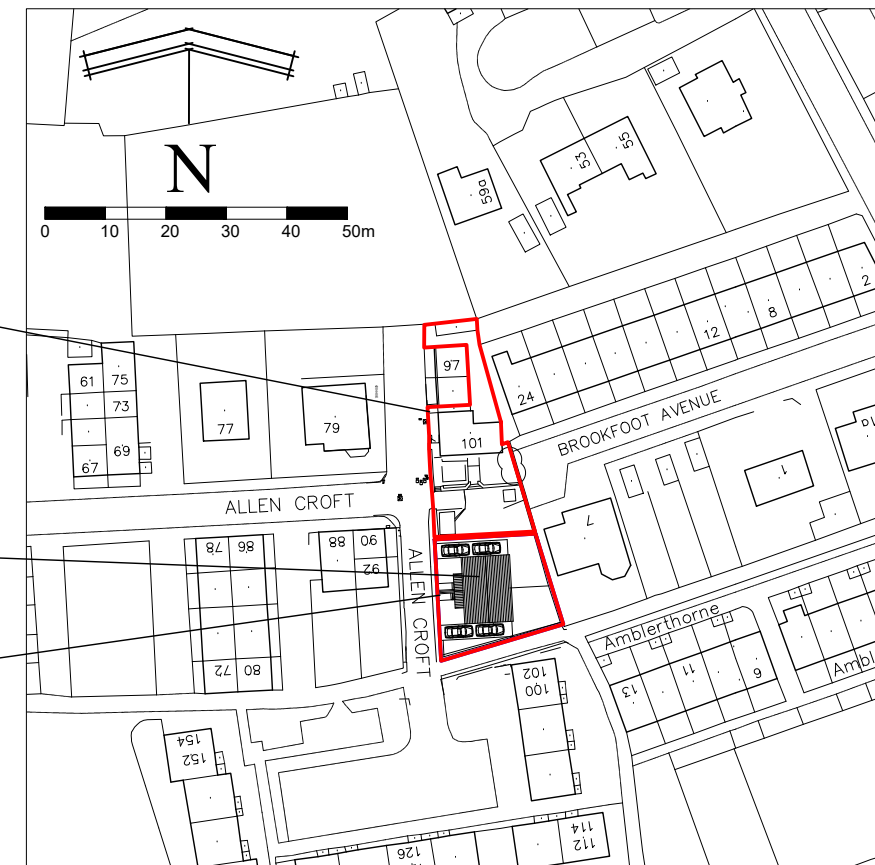

LOCATION PLAN & PROPOSED BOUNDARIES 1:1250

THIS DRAWING TO BE READ IN CONJUNCTION WITH DRAWING HAS/20/205/200,300,301,302 &600

Rev A New site boundary colour changed from blue to red 29/09/21

HAS
HARDY ARCHITECTURAL SERVICES

4 Swift Way
Sandral
Wakefield
West Yorkshire
WF2 6SQ
Tel: 01924 242116
Mob: 07443227172
Facebook: hardyarchltd
Email: hardyclive39@yahoo.com

CLIENT:	MR R TILBROOK
PROJECT:	PROPOSED TWO NUMBER TWO STOREY 3 BEDROOM SEMI DETACHED HOUSES 101 ALLEN CROFT BIRKENSRAW BD11 2AB
DRAWING TITLE:	EXISTING & PROPOSED SITE AND LOCATION PLANS WITH PROPERTY BOUNDARIES
PROJECT REF:	2020 - 205
DRAWING NO:	HAS/20/205/600
SCALE:	1:50 @A3
DATE/REV:	Aug 21 /A
DRAWN BY:	R HARDY