

Site Access Schedule

January 2021

Land at Greenhill Bank Road, New Mill, Holmfirth, HD9 1ER

Planning Reference 2016/62/92761/W

Schedule of site access arrangements

Site description

The site consists of an area of sloping land off Greenhill Bank Road, New Mill, outlined in red on the attached Ordnance Survey plan, see appendix 1.

Site access location points

Construction traffic will access the site directly from Greenhill Bank Road via newly formed dropped kerb access over the current narrow footpath adjacent. All temporary footpath alteration and reinstatement works will be carried out under the relevant permit system from Kirklees Council Highways Department and all works will be carried out by Streetworks accredited operatives.

During the course of the works it will be necessary to alter the actual point of entry to the site, due in part to the requirement to construct a new highway retaining wall along the full length of the boundary with Greenhill Bank Road. All temporary access points will be sited to ensure a minimum 45m sight line for traffic exiting the site onto Greenhill Bank Road, meeting or exceeding the long-term sight line requirements for the access onto Greenhill Bank Road from the 2 detached dwellings being constructed, as confirmed in condition 6 of the planning permission.

The site plans in Appendix 2 indicate the likely location of the access points, subject to the relevant permit from Kirklees Council Highways Department.

Site access hours

The normal site working hours will be Mondays to Fridays 07.30 to 17.30, Saturdays 08.00 to 13.00. During these hours there will be access required to site for vehicles carrying site operatives.

All larger deliveries of materials to site will be controlled and arranged in advance by the Site Manager to ensure that the deliveries are expected on site and that there is adequate access and storage available. Wherever possible deliveries to site will be arranged to avoid the anticipated busy traffic periods of 08.30 to 09.30 and 15.00 onwards.

Routing of construction traffic

Access for site cars and vans will be directly from Greenhill Bank Road travelling in either direction. Larger delivery vehicles will be instructed to access site in a downhill direction, to afford the necessary space to turn into site. This information will be provided to all suppliers and subcontractors prior to any orders being placed.

Please see attached plan in appendix 3.

Construction workers parking facilities

At the initial site set-up stage an area of the site will be cleared of vegetation and topsoil and will have a geotextile membrane and imported hardcore laid to form a clean stone surface to the site access, an area for the site welfare set-up to be located, an area for material deliveries to be unloaded and an area for on site parking of construction operative vehicles.

The location of these areas may be altered during the construction period to suit the programme and sequence of construction of the 2 detached dwellings but the principle will remain throughout the construction period.

Please see attached plan in appendix 4 for the likely location of the site welfare, storage and parking facilities

Incident / action procedures

Throughout the construction phase the works will be controlled on site at all times by either a Site Manager with the necessary experience and SMSTS accreditation or equivalent or a Site Supervisor with the necessary experience and SSSTS accreditation or equivalent. The works will be carried out under the Construction Design and Management Regulations and as part of that there will be a Construction Phase Health and Safety Plan in place for the duration of the works. The Construction Phase Health and Safety Plan is a live document that will be continually assessed and updated and will set out all the relevant health and safety and incident procedures at each stage of the works, taking into consideration the size, nature and scope of the works as they progress. It will include specific procedures for dealing with any site accidents or emergencies, details of on-site first aid provision, details of the nearest accident and emergency department, fire warning and evacuation procedures and all relevant reporting and notification procedures.

The Main Contractor will have CHAS accreditation and will be required to have an independent Health and Safety Advisor, NEBOSH trained and on the Health and Safety Executives Occupational Safety & Health Consultants Register, advising and carrying out site inspections at regular intervals throughout the works to ensure that the Construction Phase Health and Safety Plan is relevant and applicable at each stage of the works, to check and verify the adequacy of the incident and emergency procedures and to ensure that the Plan is being complied with on site.

Appendix 1

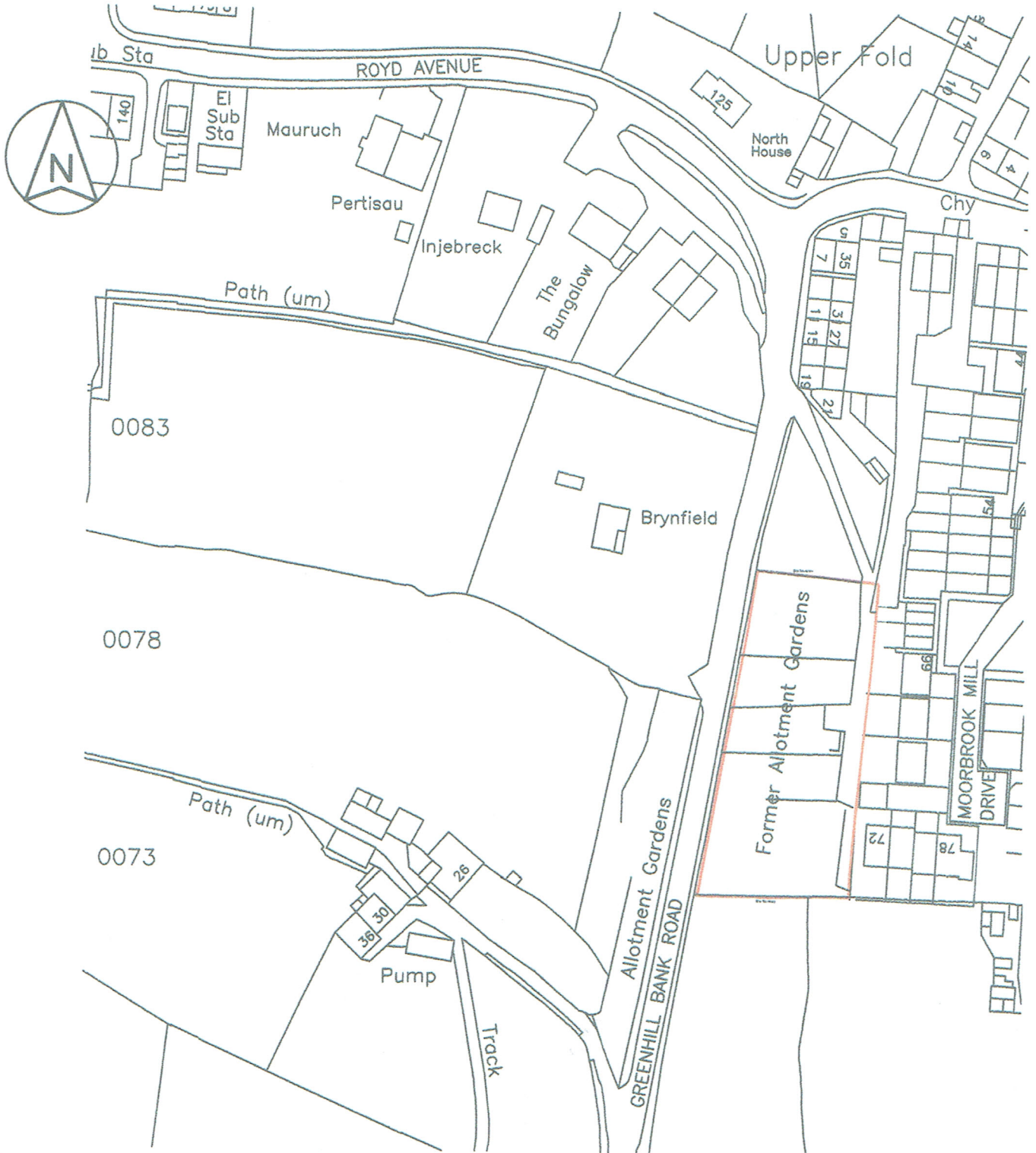

Crown Copyright. All rights reserved. Licence Number 100020449

Note to contractor
Check all dimensions prior to commencing works or ordering any materials

Rev A 18/8/2016 Ordnance survey extended at Planners request
Rev B 05/12/2017 Red Line amended

Note to Client : These works will be subject to CDM Legislation



Unit 2, The Office Campus, Paragon Business Park, Red Hall Court, Wakefield, WF1 2UY

Project Proposed 5 houses at Greenhill Bank Lane for Mr Midgley

Drawing Ordnance Survey Plan

01924 380873

Date 03/08/2016

Drg No

A4	
F	1929 Scale
R	B 1:1250
	OS

Appendix 2

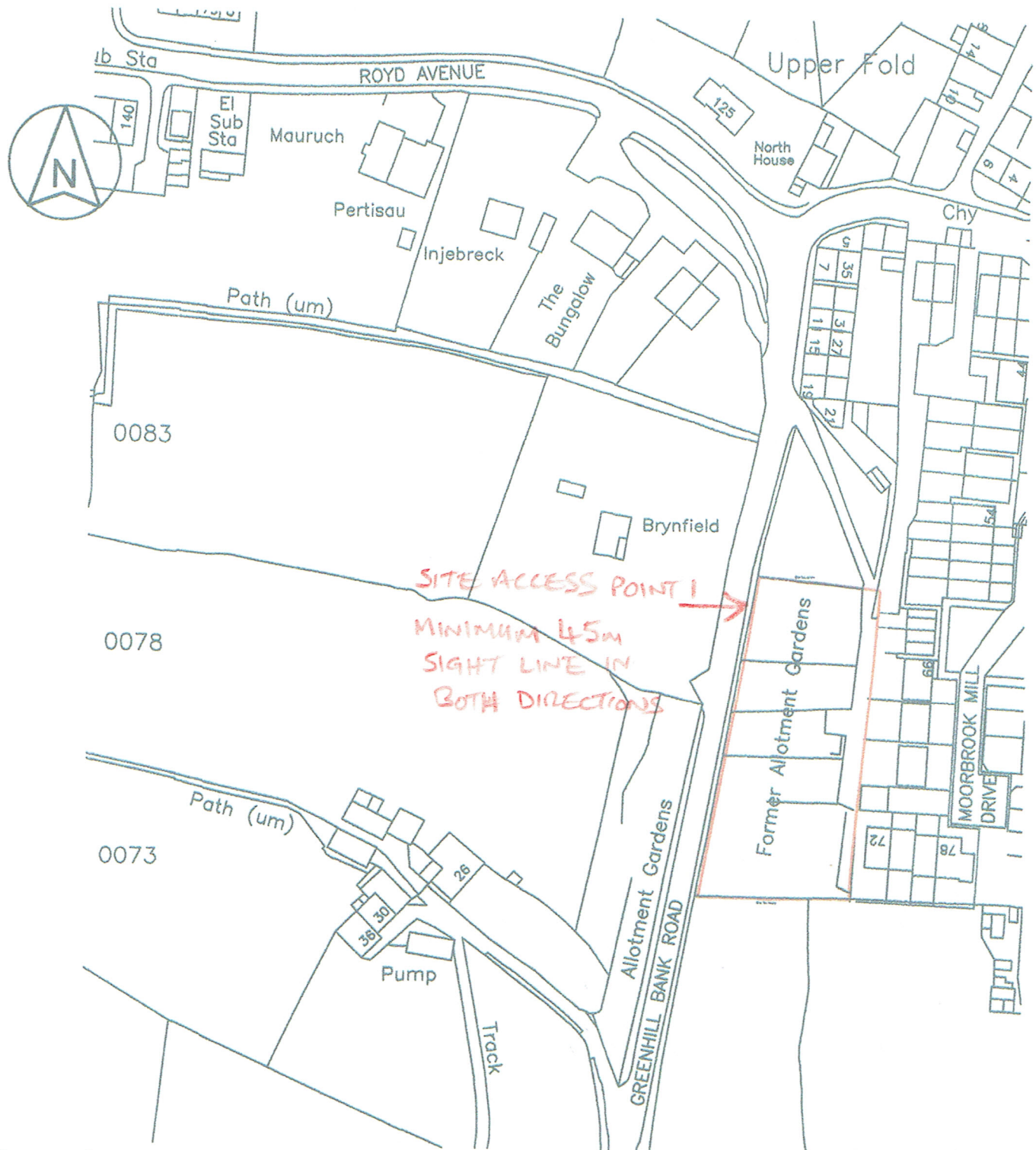

Crown Copyright. All rights reserved. Licence Number 100020449

Note to contractor
Check all dimensions prior to
commencing works or ordering
any materials

Rev A 18/8/2016 Ordnance survey extended at Planners request
Rev B 05/12/2017 Red Line amended

Note to Client : These works will be subject to CDM Legislation



Unit 2, The Office Campus, Paragon
Business Park, Red Hall Court,
Wakefield, WF1 2UY

Project Proposed 5 houses
at Greenhill Bank Lane
for Mr Midgley

Drawing Ordnance Survey Plan

01924 380873

Date 03/08/2016

Drg No

A4	
F 1929	Scale
R B	1:1250
OS	

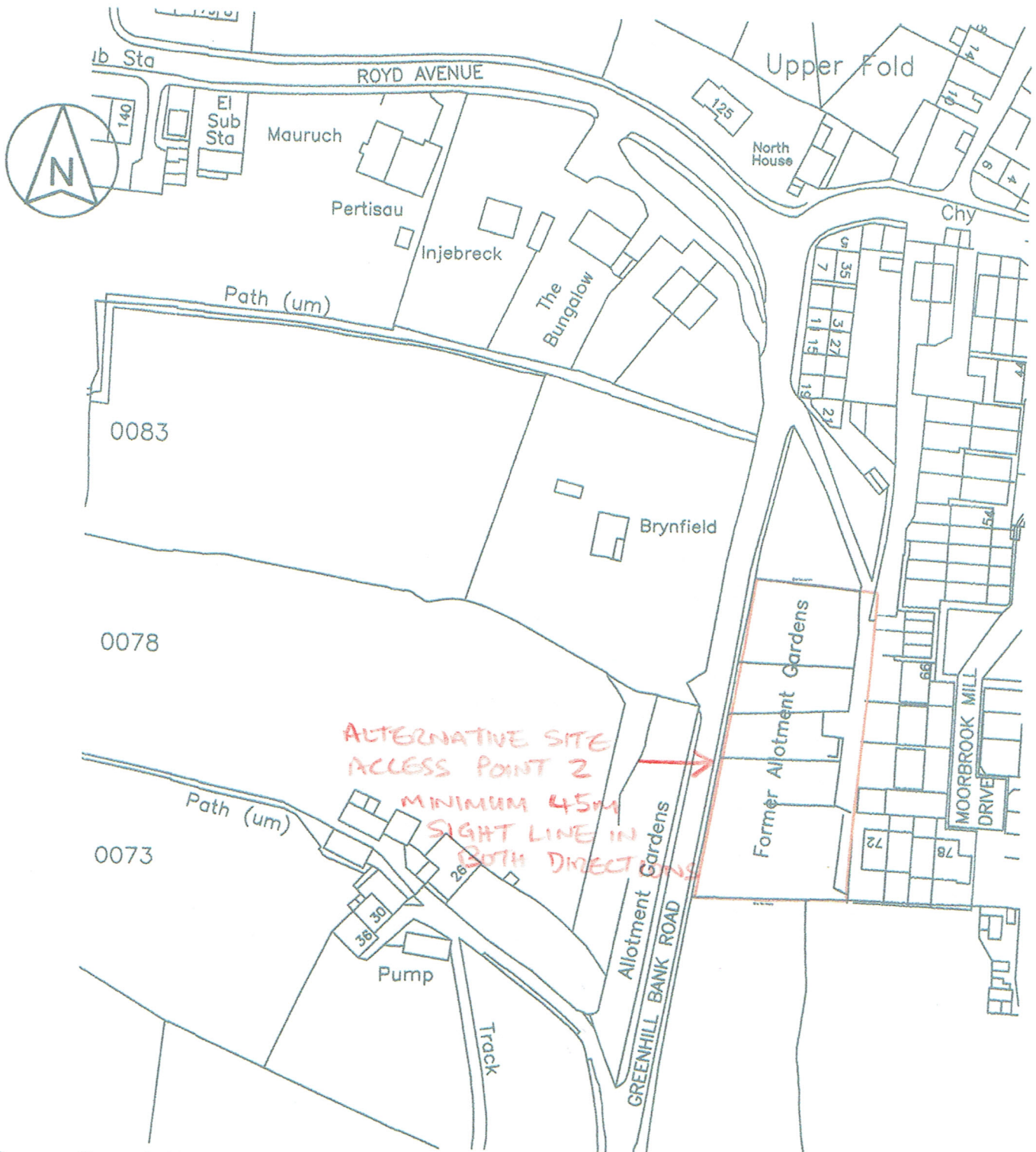

Crown Copyright. All rights reserved. Licence Number 100020449

Note to contractor
Check all dimensions prior to commencing works or ordering any materials

Rev A 18/8/2016 Ordnance survey extended at Planners request
Rev B 05/12/2017 Red Line amended

Note to Client : These works will be subject to CDM Legislation

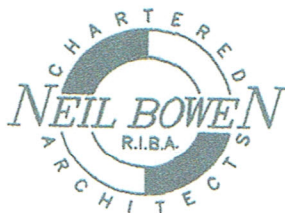

Unit 2, The Office Campus, Paragon
Business Park, Red Hall Court,
Wakefield, WF1 2UY

Project Proposed 5 houses
at Greenhill Bank Lane
for Mr Midgley

Drawing Ordnance Survey Plan

01924 380873

Date 03/08/2016

Drg No

A4	
F	1929 Scale
R	B 1:1250
	OS

Appendix 3

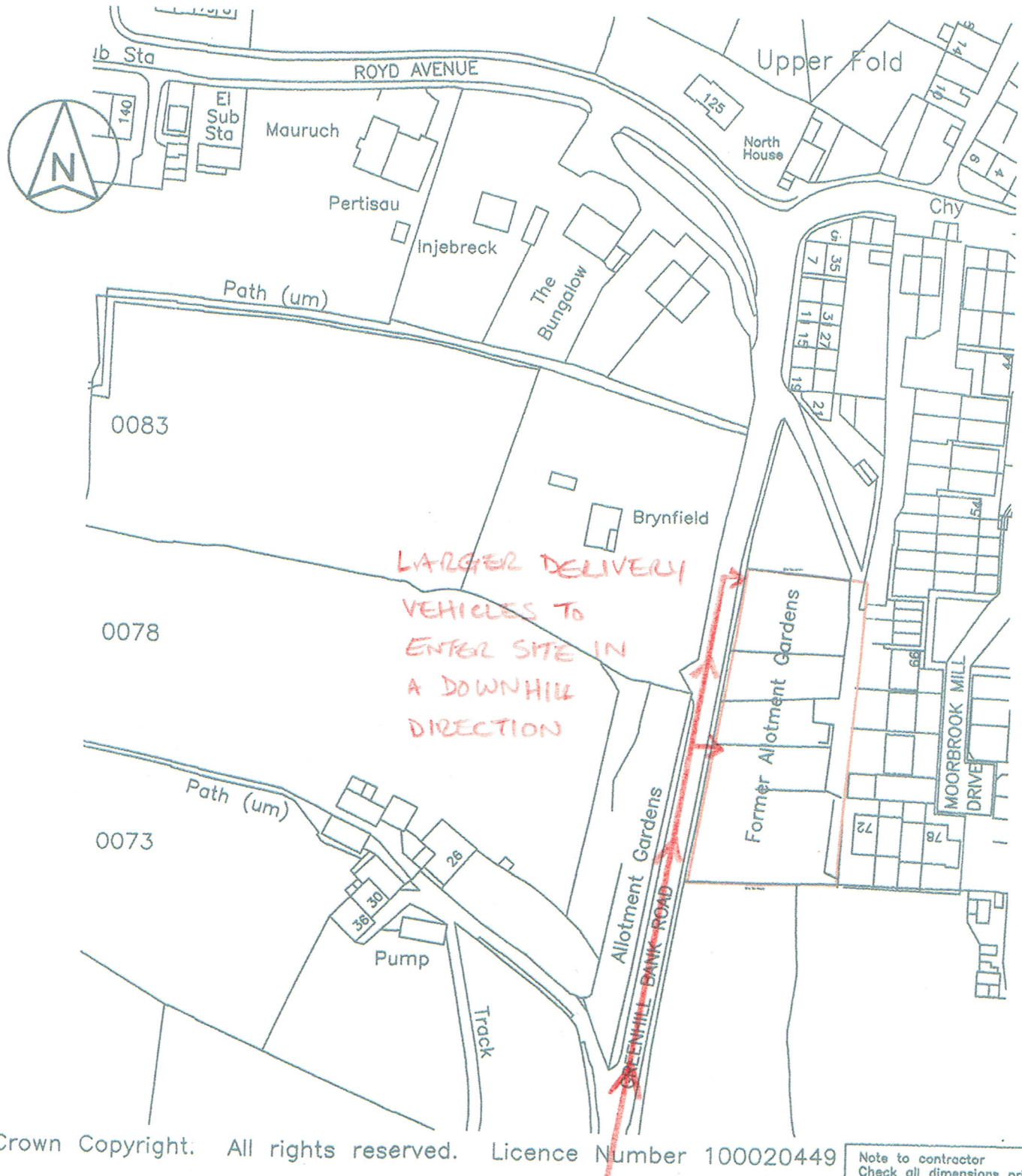

Crown Copyright. All rights reserved. Licence Number 100020449

Note to contractor
Check all dimensions prior to commencing works or ordering any materials

Rev A 18/8/2016 Ordnance survey extended at Planners request
Rev B 05/12/2017 Red Line amended

Note to Client : These works will be subject to CDM Legislation

Unit 2, The Office Campus, Paragon
Business Park, Red Hall Court,
Wakefield, WF1 2UY

Project Proposed 5 houses
at Greenhill Bank Lane
for Mr Midgley

Drawing Ordnance Survey Plan

01924 380873

Date 03/08/2016

Drg No

A4	
F 1929	Scale
R B	1:1250
OS	

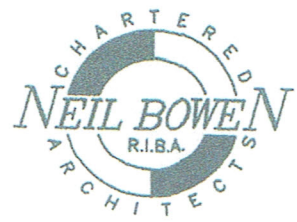

Appendix 4

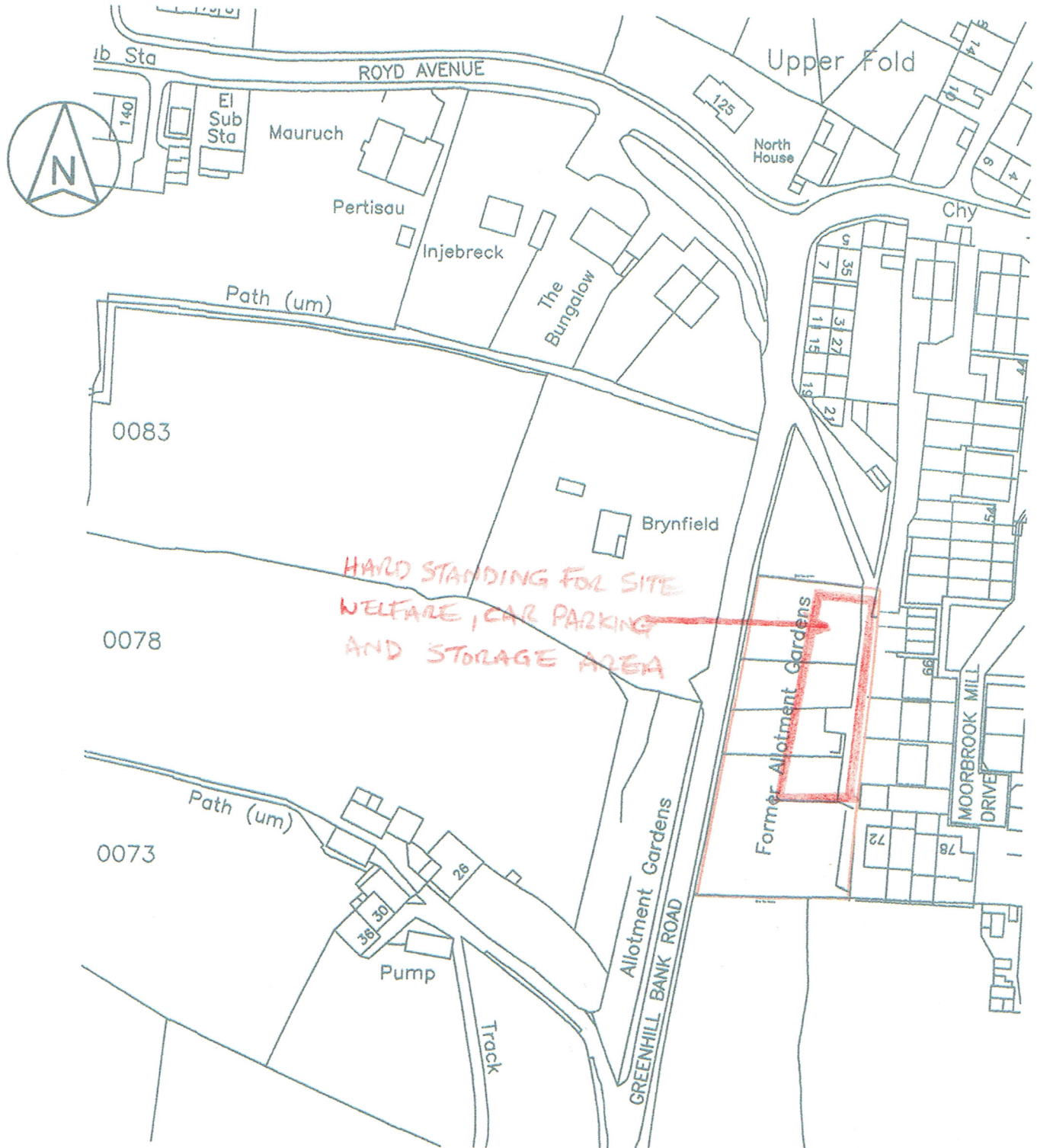

Crown Copyright. All rights reserved. Licence Number 100020449

Note to contractor
Check all dimensions prior to commencing works or ordering any materials

Rev A 18/8/2016 Ordnance survey extended at Planners request
Rev B 05/12/2017 Red Line amended

Note to Client : These works will be subject to CDM Legislation



Unit 2, The Office Campus, Paragon
Business Park, Red Hall Court,
Wakefield, WF1 2UY

Project Proposed 5 houses
at Greenhill Bank Lane
for Mr Midgley

Drawing Ordnance Survey Plan

01924 380873

Date 03/08/2016

Drg No

A4	
F	1929 Scale
R	B 1:1250
OS	