

Proposed First Floor Plan

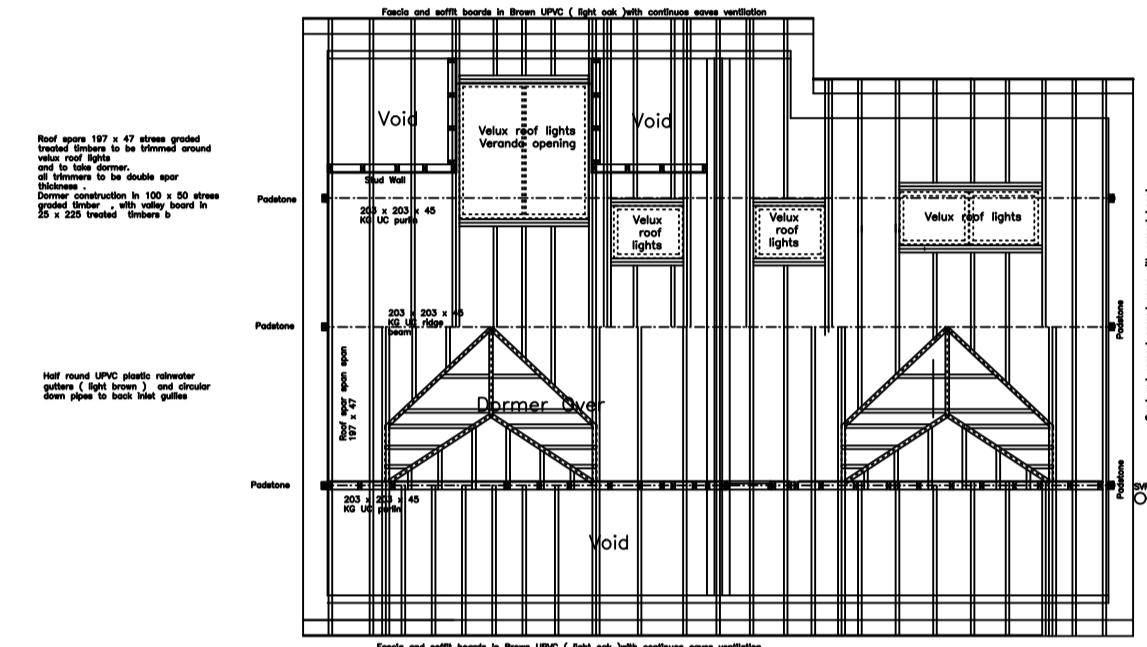

Roof Services

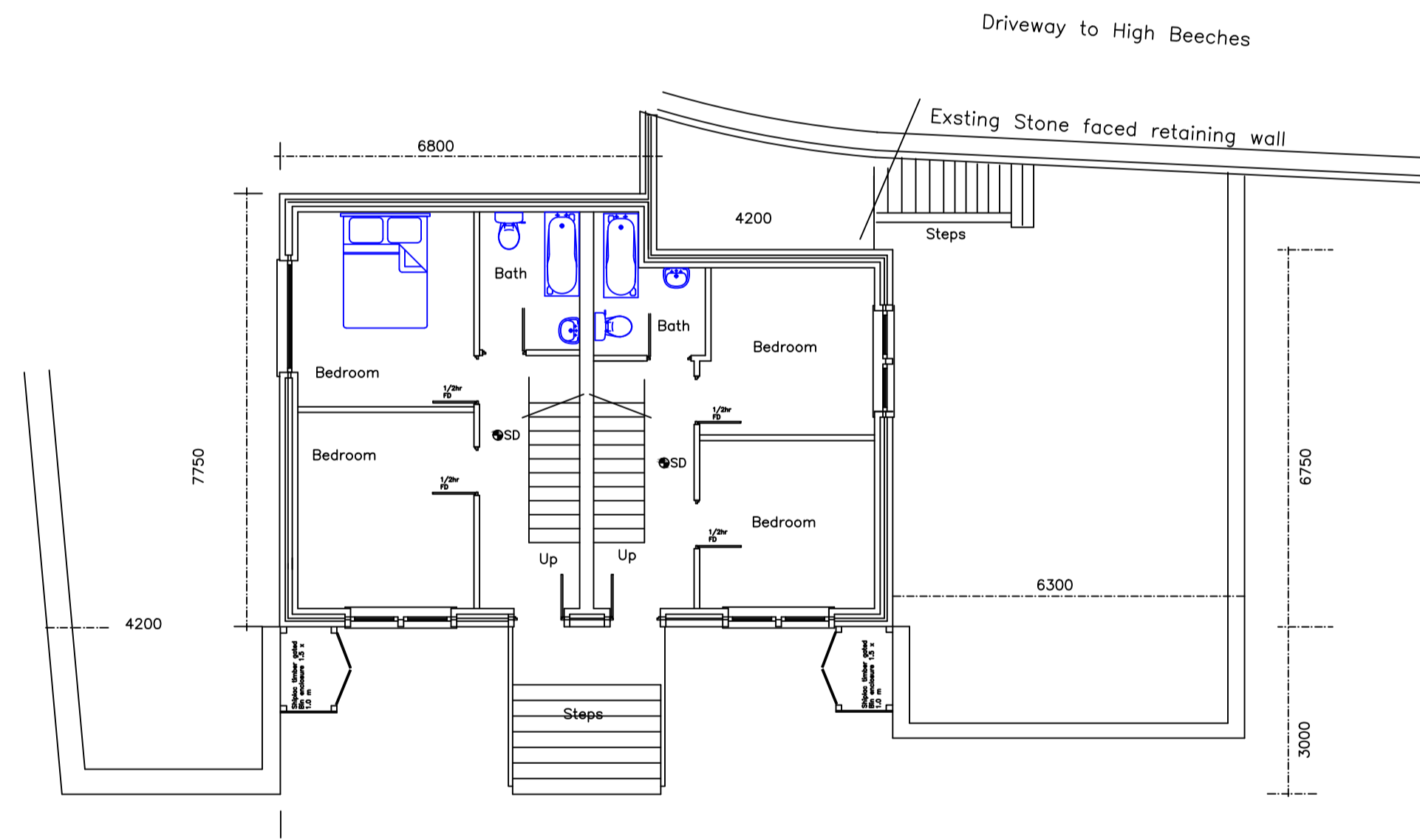

Proposed Ground Floor Plan

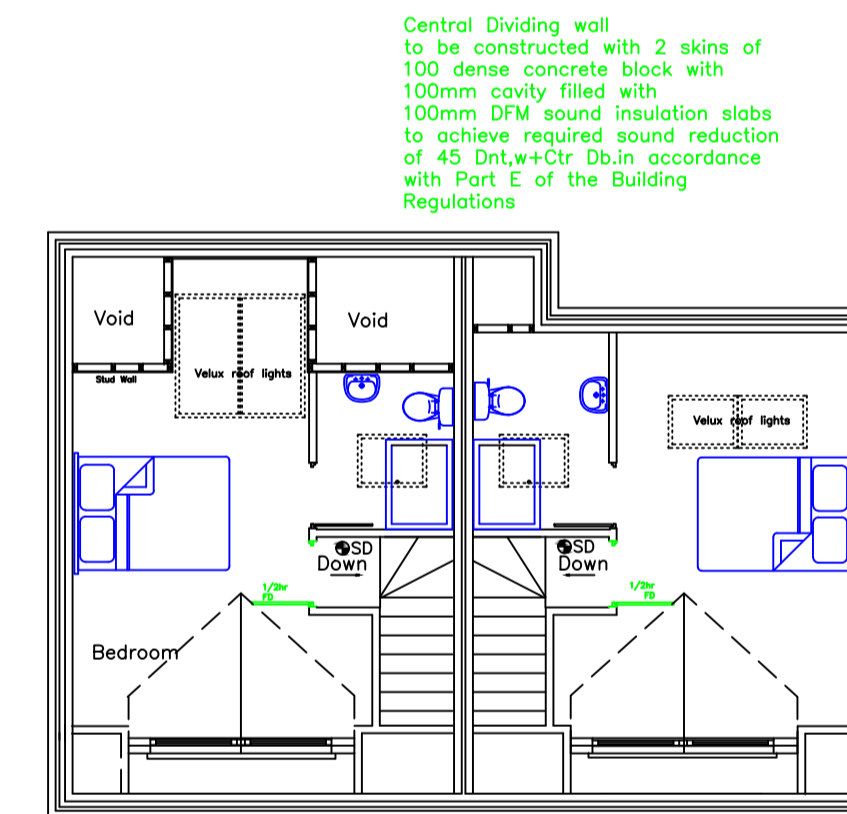

Proposed Attic Level Plan

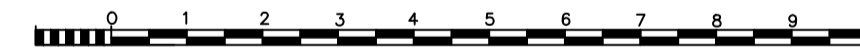

Scale 1:500 on A1

Rev	Description	Rev. by	Date
1	Client/Architect		
2	Mr Nick Charlton		
3	Mr Andrew Armitage		
4	Project		
5	585 Manchester Road		
6	Linthwaite Bottom Plot		
7	Title		
8	Proposed Floor Plans for		
9	2 Semi detached dwellings		
10	Date 17th January 2020	Drawn By	
11	Size A1	Checked	
12	Scale 1:100 on A1	Approved	
13	FCS Consultants 31 Summerville, Bridge Lane Holmfirth, HD7 1AG Tel. 01484 687 722		
14	Issue	Planning	
15	Drawing Number	HBBP/2019/18	Revision
16			F