

General Notes

THIS DRAWING HAS BEEN PREPARED FROM ORDINANCE SURVEY INFORMATION AND FROM SURVEY INFORMATION PROVIDED BY OTHERS AND IS FOR INFORMATION PURPOSES ONLY. DO NOT SCALE FROM DRAWING. USE FIGURED DIMENSIONS ONLY. ALL DIMENSIONS MUST BE CHECKED AND VERIFIED ON SITE PRIOR TO COMMENCEMENT OF WORK AND DESIGNER TO BE NOTIFIED OF ANY DISCREPANCIES. ENGINEERING DETAILS (E. RETAINING WALL AND BATTERED SLOPES) TO DESIGN BY OTHERS AND THE INFORMATION SHOWN RELATES TO DETAILS PROVIDED BY OTHERS.

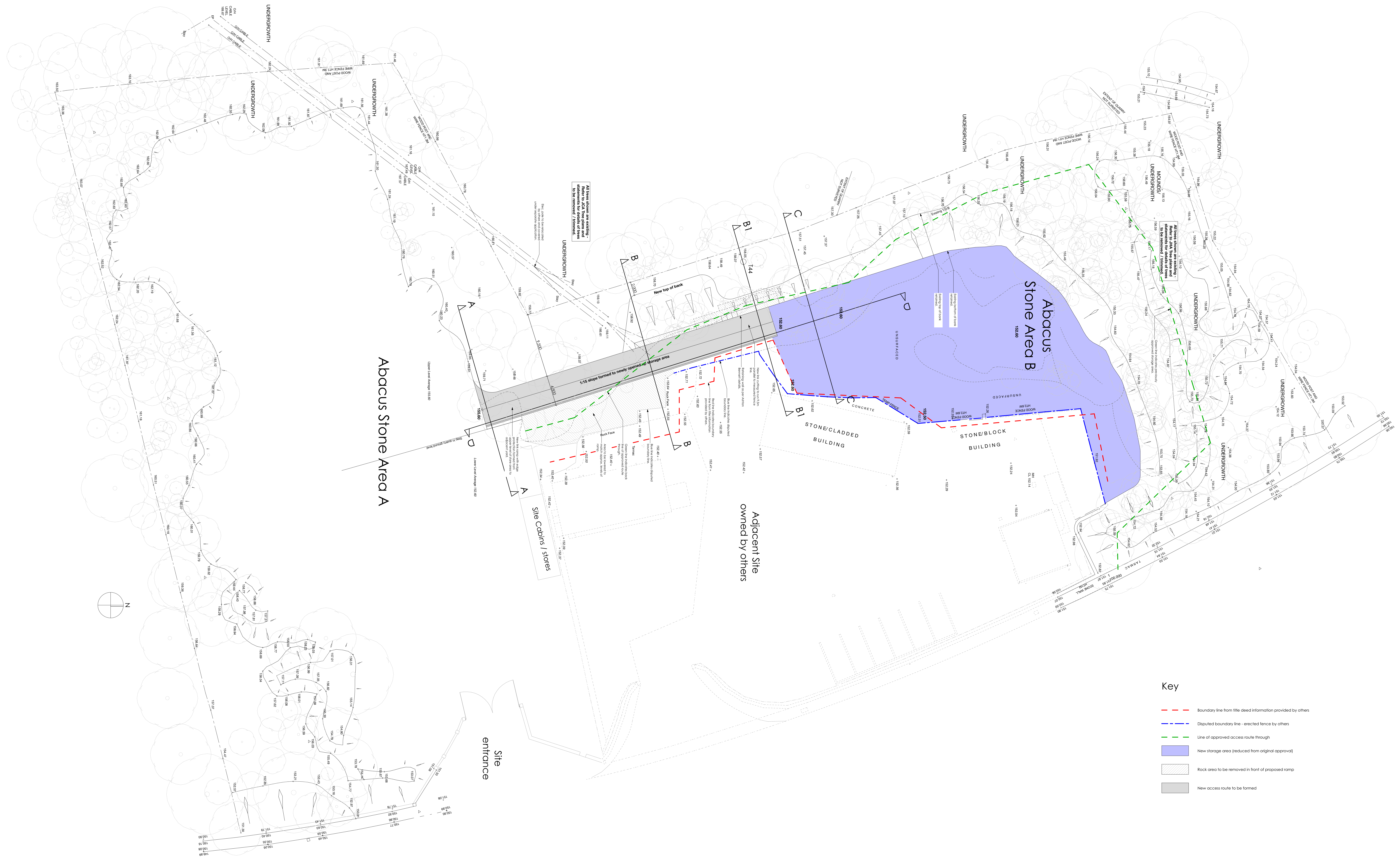

Plan 1:200

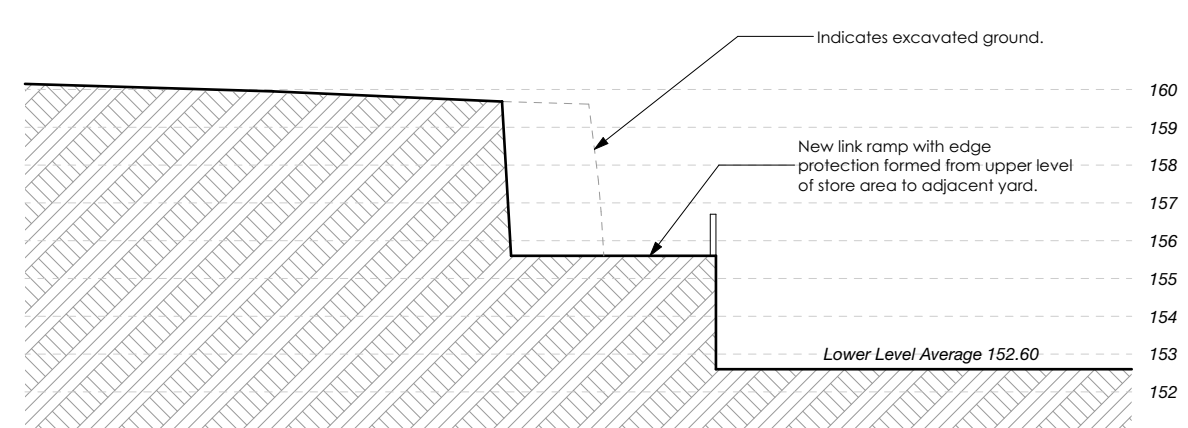

Site Section A 1:200

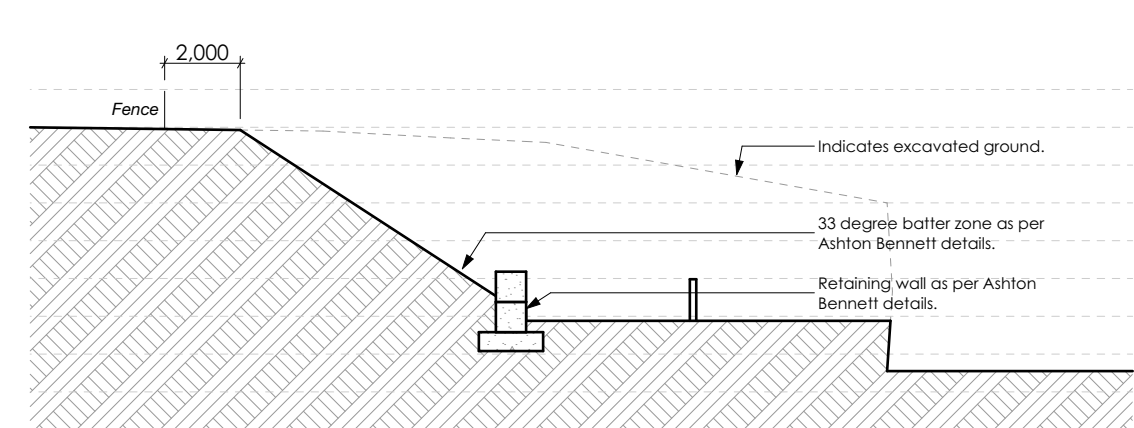

Site Section B 1:200

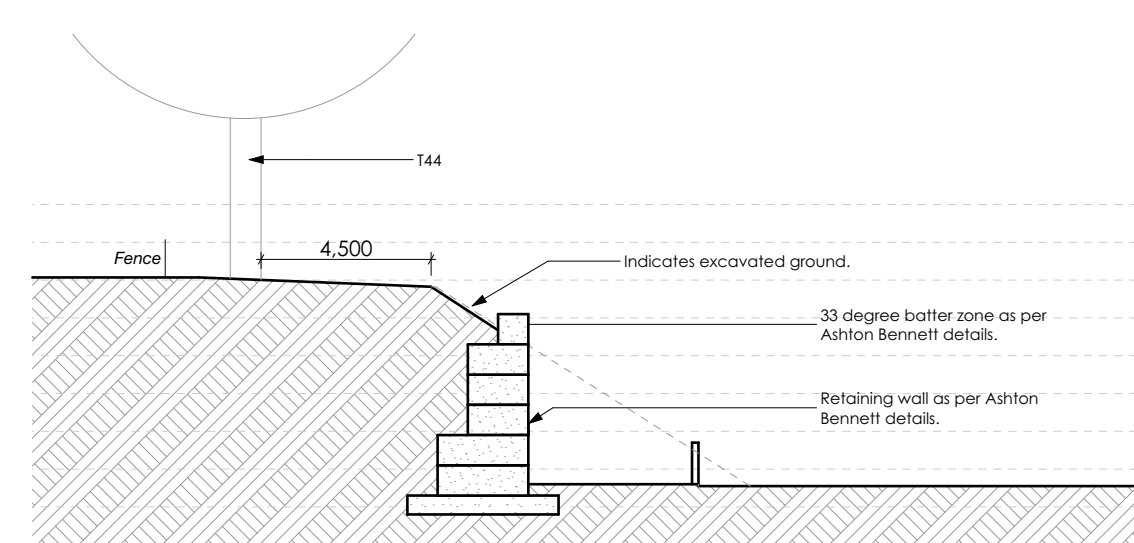

Site Section B1 1:200

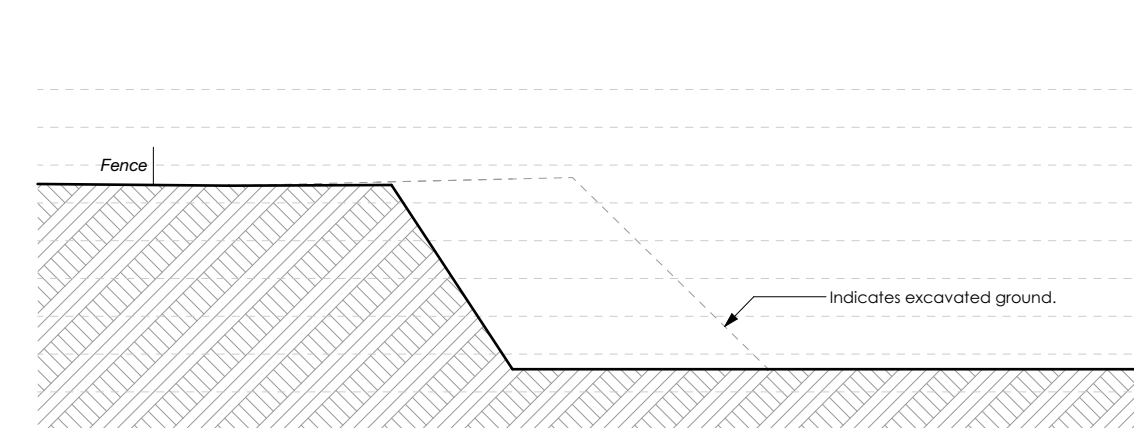

Site Section C 1:200

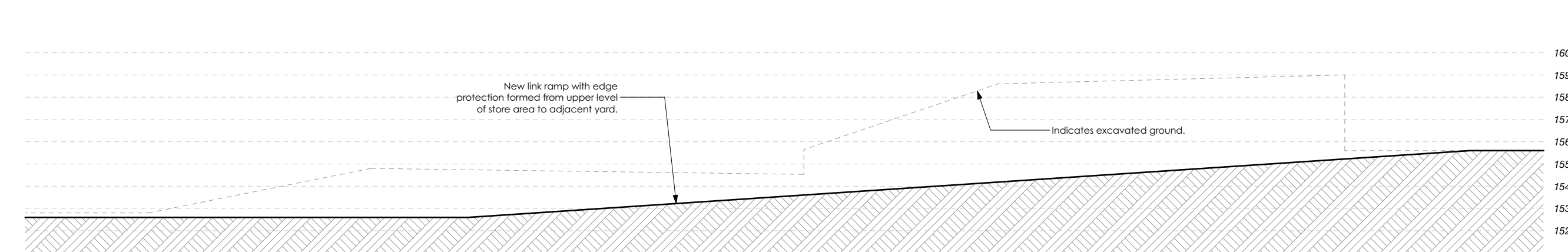

Site Section D 1:200

Key

- Boundary line from title deed information provided by others
- Disputed boundary line - erected fence by others
- Line of approved access route through
- New storage area (reduced from original approval)
- Rock area to be removed in front of proposed ramp
- New access route to be formed

B	Revising and updated	AB	13/06/2020
A	Revised and added Section	AB	12/06/2020
Revision	Description	Revised	Checked

Client:
Abacus Stone Sales Ltd.

Project:
Abacus Stone Sales Ltd.
Hoggy Wood Quarry, Woodhead Road, Huddersfield.

Drawing:
Proposed Site Plan & Sections - S73

Drawing Status:

Date:	Scale @ A0:	Drawn by:
MAY 20	1:200	AB
Project No.:	Drawing No.:	Revision:
028	(0-) 10	B