

Notes

Do not scale from drawing, use figured dimensions only.
 All dimensions must be checked and verified on site prior to commencement of work and architect to be notified of any discrepancies.
 This drawing is intended to permit overall scheme proposals only and cannot be used for construction purposes without further information.

Rev	Drawn	Checked	Date

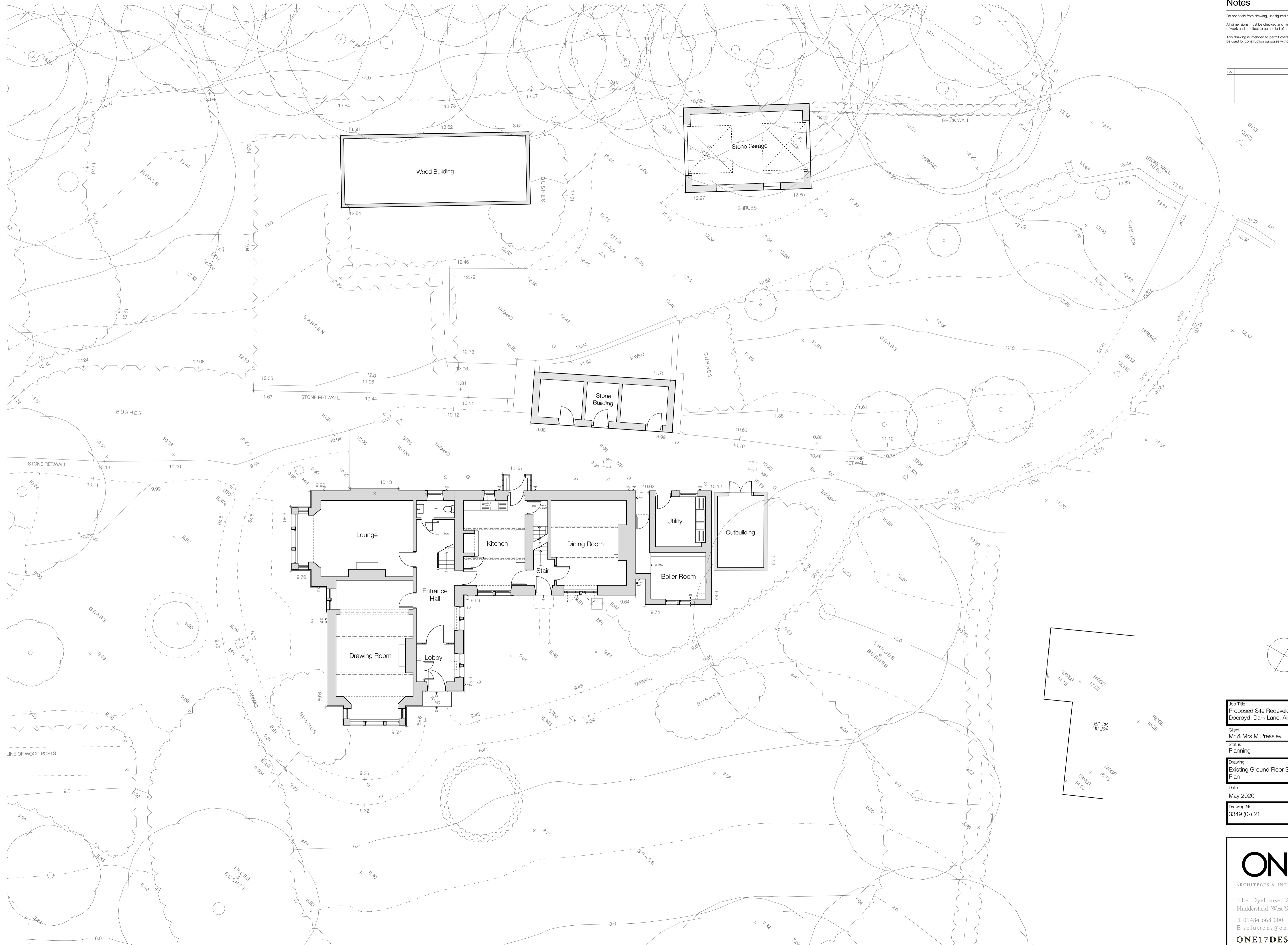

Existing Ground Floor Plan 1:100

Job Title Proposed Site Redevelopment, Doeroyd, Dark Lane, Almondbury.	
Client Mr & Mrs M Pressley	Company AD
Status Planning	Scale @ A1 1:100
Drawing Existing Ground Floor Site Plan	
Date May 2020	Drawn / Checked FWG
Drawing No. 3349 (0-) 21	Revision

ONE17
 ARCHITECTS & INTERIOR DESIGNERS

The Dyehouse, Armitage Bridge
 Huddersfield, West Yorkshire HD4 7PD
 T 01484 668 000 F 01484 668 001
 E solutions@one17design.com

ONE17DESIGN.COM