

1. ALL WORK TO BE CARRIED OUT IN ACCORDANCE WITH THE BUILDING REGULATIONS AND THE REQUIREMENTS OF THE LOCAL AUTHORITY.
2. NO DIMENSIONS TO BE CALLED FROM THIS DRAWING.
3. THE CONTRACTOR SHALL VERIFY ALL LEVELS AND DIMENSIONS ON THE BEFORE COMMENCEMENT OF WORK.
4. ON THE ATTENTION TO THE CONSTRUCTION OR FINISHES SHOWN OR WRITTEN ON THIS DRAWING MUST BE DRAWN TO THE INTENTION OF THE ARCHITECT BEFORE SUCH WORK IS UNDERTAKEN.
5. ALL TIMBERS REQUIRE PRESERVATIVE TREATMENT

© COPYRIGHT RESERVED

- KEY
- Marshall's Brindle block paving
 - Aggregate indicates 450x450 buff paving
 - Existing natural roofing slates to be re-used where possible
 - Existing natural stone walling to be re-used where possible
 - Existing double glazed timber windows to be re-used where possible and painted Antique White.
 - Existing timber doors to be re-used where possible and painted black.

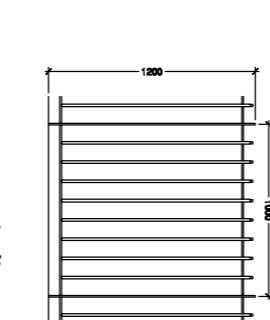

Indicates 200mm high metal fencing

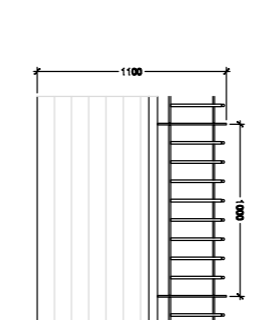

Indicates 1200mm high metal railing

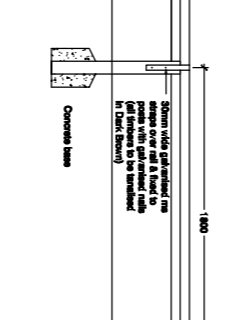

Indicates 450mm high knee rail

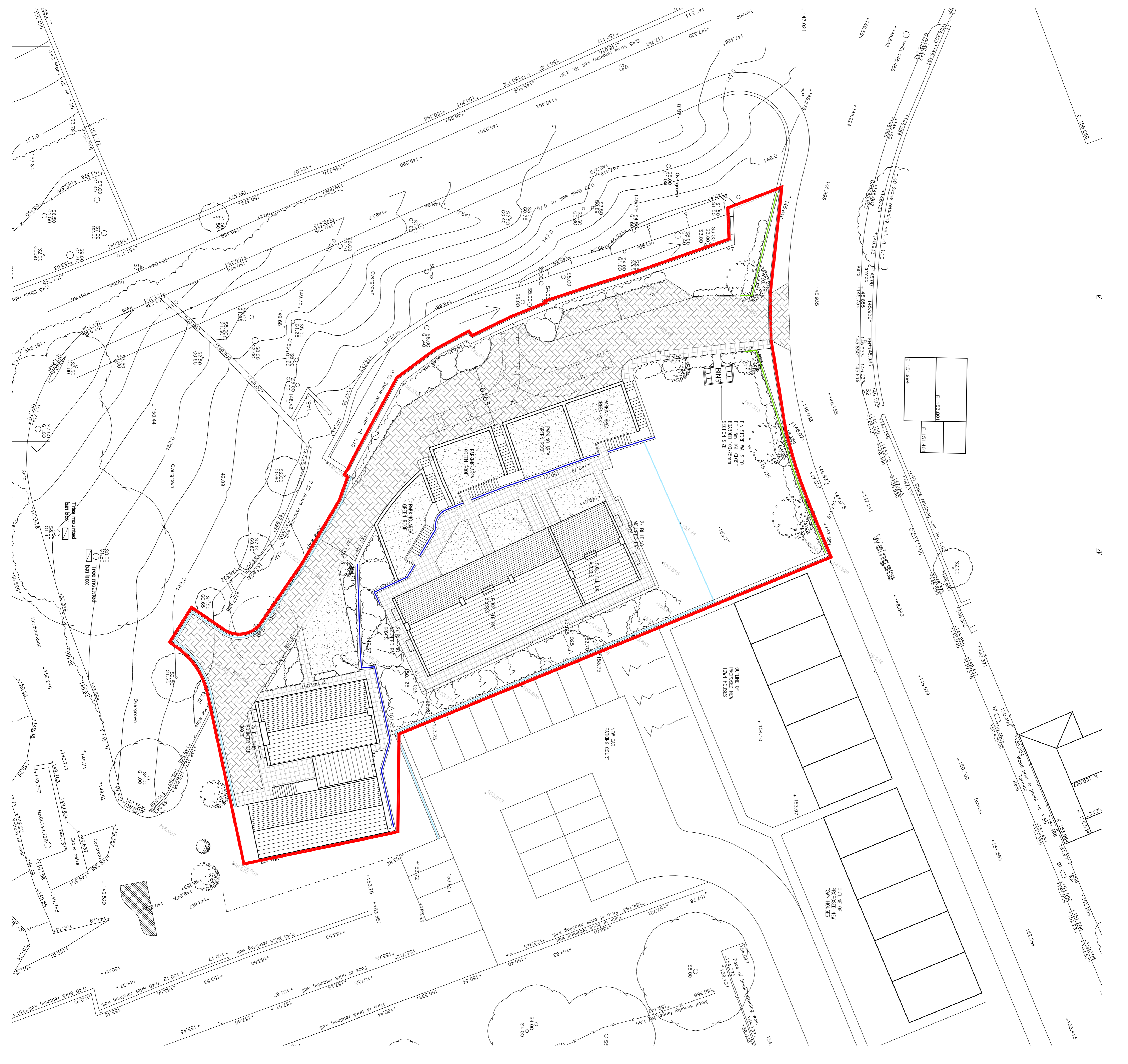

PROGRESSIVE
 ARCHITECTURE
 LTD.
 11, LINDSAY STREET
 DUNDEE DD1 1JG
 TEL: 01382 464000
 WWW.PROGRESSIVEARCHITECTURE.CO.UK

Client: **M. R. WILLIAMS**
 Site: **Beck Rock Mill, Linnvale, Huddersfield**
 Drawing Title: **Proposed Site Plan**
 Project Number: **PI024**
 Drawing Number: **05**
 Date: **22.09.19**
 Scale: **1:200 @ A1**
 Drawn: **IWW**