

NOTES:

Key:

- Extent of greenbelt
- Extent of previously developed land within greenbelt
- Demolition

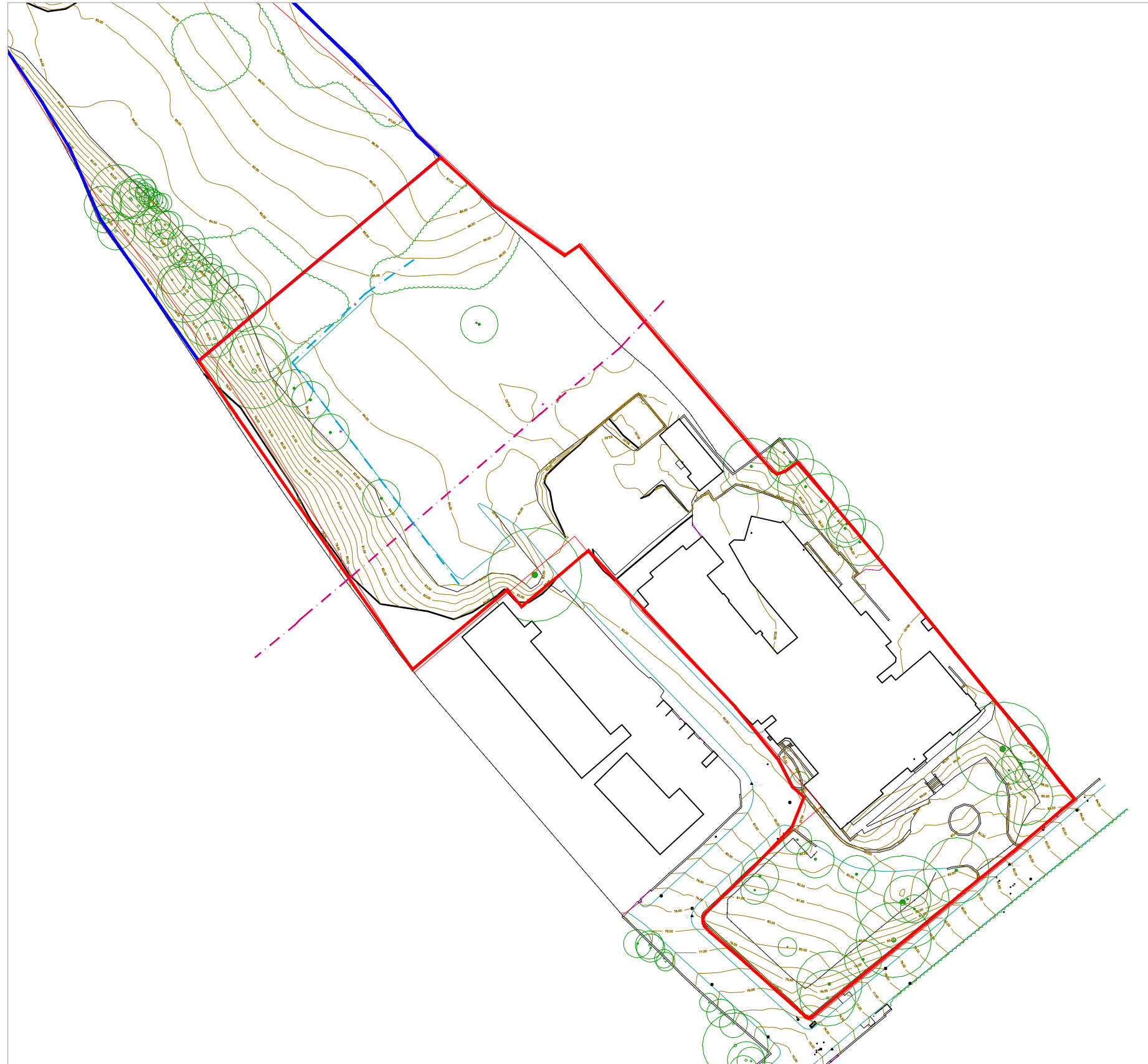

THIS DRAWING HAS BEEN PREPARED FOR **PLANNING** ONLY AND IS TO BE READ IN CONJUNCTION WITH ALL OTHER RELEVANT OTHER SPECIALISTS DRAWINGS, DETAILS AND SPECIFICATIONS. ALL WORKS ARE TO BE CARRIED OUT IN ACCORDANCE WITH THE LATEST EDITION OF THE BUILDING REGULATIONS AND ANY AMENDMENTS, TOGETHER WITH ALL RELEVANT BRITISH STANDARDS AND CODES OF PRACTICE. ALL DIMENSIONS UNLESS NOTED OTHERWISE ARE IN MILLIMETRES. ALL DIMENSIONS AND LEVELS ARE TO BE CHECKED BY THE CONTRACTOR ON SITE PRIOR TO ORDER, FABRICATION OR COMMENCEMENT OF WORK ON SITE. CONTRACTOR TO CHECK AND SATISFY HIMSELF OF THE POSITIONS OF ALL EXISTING STATUTORY AUTHORITIES MAINS SERVICES ON AND AROUND SITE. ALL MATERIALS AND PROPRIETARY ITEMS ARE TO BE FIXED / INSTALLED / APPLIED IN STRICT ACCORDANCE WITH THE RESPECTIVE MANUFACTURERS RECOMMENDATIONS. AT ALL STAGES OF WORK, THE CONTRACTOR WILL BE RESPONSIBLE FOR AND MUST ENSURE THE OVERALL STABILITY OF ALL BUILDINGS, STRUCTURES AND EXCAVATIONS ETC. IS MAINTAINED. DURING THE CONSTRUCTION WORKS ALL EXISTING LIVE DRAINAGE IS TO BE ADEQUATELY PROTECTED AND NORMAL FLOWS MAINTAINED. © COPYRIGHT KUFIC 2019

KUFIC Suite 24 Batley Business Park t: 01924 694 404
Technology Drive e: info@kufic.co.uk
Batley WF17 6ER . UK w: www.kufic.co.uk

DRAWN BY:	STAGE: DESIGN	DATE: 30/09/19
LOCATION:	CARLINGHOW HILL, BATLEY	
TITLE:	RESIDENTIAL DEVELOPMENT	
DESCRIPTION:	EXISTING SITE PLAN	
REF:	18001-D02-A	

EXISTING SITE PLAN
SCALE 1:1000 @ A3