

2. Environmental Permits, Incidents and Registers

2.1 Industrial Sites Holding Licences and/or Authorisations

Searches of information provided by the Environment Agency/Natural Resources Wales and Local Authorities reveal the following information:

2.1.1 Records of historic IPC Authorisations within 500m of the study site:

1

The following IPC Authorisations are represented as points on the Environmental Permits, Incidents and Registers Map:

ID	Distance (m)	Direction	NGR	Details
13C	243	SE	423900 424800	Operator: Asprey Chemicals Ltd (dissolved) Address: 507 Bradford Road, Batley, West Yorkshire, WF17 8LL Process: Processes Involving Halogens Permit Number: AI4026 Original Permit Number: IPCAIRAPP Date Approved: 20-8-1993 Effective Date: 20-8-1993 Status: Revoked

2.1.2 Records of Part A(1) and IPPC Authorised Activities within 500m of the study site:

0

Database searched and no data found.

2.1.3 Records of Red List Discharge Consents (potentially harmful discharges to controlled waters) within 500m of the study site:

0

Database searched and no data found.

2.1.4 Records of List 1 Dangerous Substances Inventory Sites within 500m of the study site:

0

Database searched and no data found.

2.1.5 Records of List 2 Dangerous Substance Inventory Sites within 500m of the study site:

0

Database searched and no data found.

2.1.6 Records of Part A(2) and Part B Activities and Enforcements within 500m of the study site:

3

The following Part A(2) and Part B Activities are represented as points on the Environmental Permits, Incidents and Registers Map:

ID	Distance (m)	Direction	NGR	Details
10	137	SW	423561 425004	Address: Dyson Engineering, Unit 5, Cheapside Mills, Bradford Rd, Batley, West Yorkshire, WF17 8HB Process: Coating Processes Status: Historical Permit Permit Type: Part B Enforcement: No Enforcements Notified Date of Enforcement: No Enforcements Notified Comment: No Enforcements Notified
11	162	SW	423587 424943	Address: Whitehall Veneered Panels, 581 Bradford Rd, Batley, WF17 8HB Process: Timber Manufacture Status: Historical Permit Permit Type: Part B Enforcement: No Enforcements Notified Date of Enforcement: No Enforcements Notified Comment: No Enforcements Notified
12	344	S	423761 424659	Address: Brookroyd Auto Repairs, Unit 47 Carlinghow Mills, 501 Bradford Road, Batley, WF17 8LL Process: Respraying of Road Vehicles Status: Historical Permit Permit Type: Part B Enforcement: No Enforcements Notified Date of Enforcement: No Enforcements Notified Comment: No Enforcements Notified

2.1.7 Records of Category 3 or 4 Radioactive Substances Authorisations:

0

Database searched and no data found.

2.1.8 Records of Licensed Discharge Consents within 500m of the study site:

4

The following Licensed Discharge Consents records are represented as points on the Environmental Permits, Incidents and Registers Map:

ID	Distance (m)	Direction	NGR	Details
SA	331	SE	423900 424700	Address: ASHWOOD CHEMICALS LTD, 507 BRADFORD, ROAD, BATLEY, W YORKS Effluent Type: TRADE DISCHARGES - UNSPECIFIED Permit Number: C5251 Permit Version: 2 Receiving Water: BATLEY BECK Status: REVOKED - UNSPECIFIED Issue date: 13/12/1991 Effective Date: 13-Dec-1991 Revocation Date: 28/07/1994

ID	Distance (m)	Direction	NGR	Details	
6A	331	SE	423900 424700	Address: ASHWOOD CHEMICALS LTD, 507 BRADFORD, ROAD, BATLEY, W YORKS Effluent Type: TRADE DISCHARGES - UNSPECIFIED Permit Number: C5251 Permit Version: 1	Receiving Water: BATLEY BECK Status: TRANSFERRED FROM COPA 1974 Issue date: 28/09/1988 Effective Date: 28-Sep-1988 Revocation Date: 12/12/1991
7B	411	SE	423960 424640	Address: MELTON STREET CSO, THOMAS STREET, BATLEY, WEST YORKSHIRE Effluent Type: SEWAGE DISCHARGES - SEWER STORM OVERFLOW - WATER COMPANY Permit Number: WRA8671 Permit Version: 1	Receiving Water: CARLINGHOW BECK Status: NEW CONSENT (WRA 91, S88 & SCHED 10 AS AMENDED BY ENV ACT 1995) Issue date: 11/03/2005 Effective Date: 01-Apr-2005 Revocation Date: 02/03/2010
8B	411	SE	423960 424640	Address: MELTON STREET CSO, THOMAS STREET, BATLEY, WEST YORKSHIRE Effluent Type: SEWAGE DISCHARGES - SEWER STORM OVERFLOW - WATER COMPANY Permit Number: WRA8671 Permit Version: 2	Receiving Water: CARLINGHOW BECK Status: MODIFIED - (WRA 91 SCHED 10 - AS AMENDED BY ENV ACT 1995) Issue date: 03/03/2010 Effective Date: 03-Mar-2010 Revocation Date: -

2.1.9 Records of Water Industry Referrals (potentially harmful discharges to the public sewer) within 500m of the study site:

0

Database searched and no data found.

2.1.10 Records of Planning Hazardous Substance Consents and Enforcements within 500m of the study site:

0

Database searched and no data found.

2.2 Dangerous or Hazardous Sites

Records of COMAH & NIHHS sites within 500m of the study site:

0

Database searched and no data found.

2.3 Environment Agency/Natural Resources Wales Recorded Pollution Incidents

2.3.1 Records of National Incidents Recording System, List 2 within 500m of the study site:

4

The following NIRS List 2 records are represented as points on the Environmental Permits, Incidents and Registers Map:

ID	Distance (m)	Direction	NGR	Details	
1	113	SW	423667.0 424941.0	Incident Date: 14-Mar-2002 Incident Identification: 64046.0 Pollutant: Sewage Materials Pollutant Description: Grey Water	Water Impact: Category 3 (Minor) Land Impact: Category 3 (Minor) Air Impact: Category 4 (No Impact)
2	128	SW	423488.0 425111.0	Incident Date: 08-May-2003 Incident Identification: 156888.0 Pollutant: Organic Chemicals/Products Pollutant Description: Other Organic Chemical or Product	Water Impact: Category 4 (No Impact) Land Impact: Category 4 (No Impact) Air Impact: Category 4 (No Impact)
3	255	NW	423321.0 425375.0	Incident Date: 28-Sep-2007 Incident Identification: 534710.0 Pollutant: Pollutant Not Identified Pollutant Description: Not Identified	Water Impact: Category 1 (Major) Land Impact: Category 4 (No Impact) Air Impact: Category 4 (No Impact)
4	301	NW	423285.0 425405.0	Incident Date: 02-Jul-2010 Incident Identification: 797205.0 Pollutant: Other Pollutant Pollutant Description: Other	Water Impact: Category 2 (Significant) Land Impact: Category 4 (No impact) Air Impact: Category 4 (No Impact)

2.3.2 Records of National Incidents Recording System, List 1 within 500m of the study site:

0

Database searched and no data found.

2.4 Sites Determined as Contaminated Land under Part 2A EPA 1990

Records of sites determined as contaminated land under Section 78R of the Environmental Protection Act 1990 are there within 500m of the study site

0

Database searched and no data found.

3. Landfill and Other Waste Sites Map

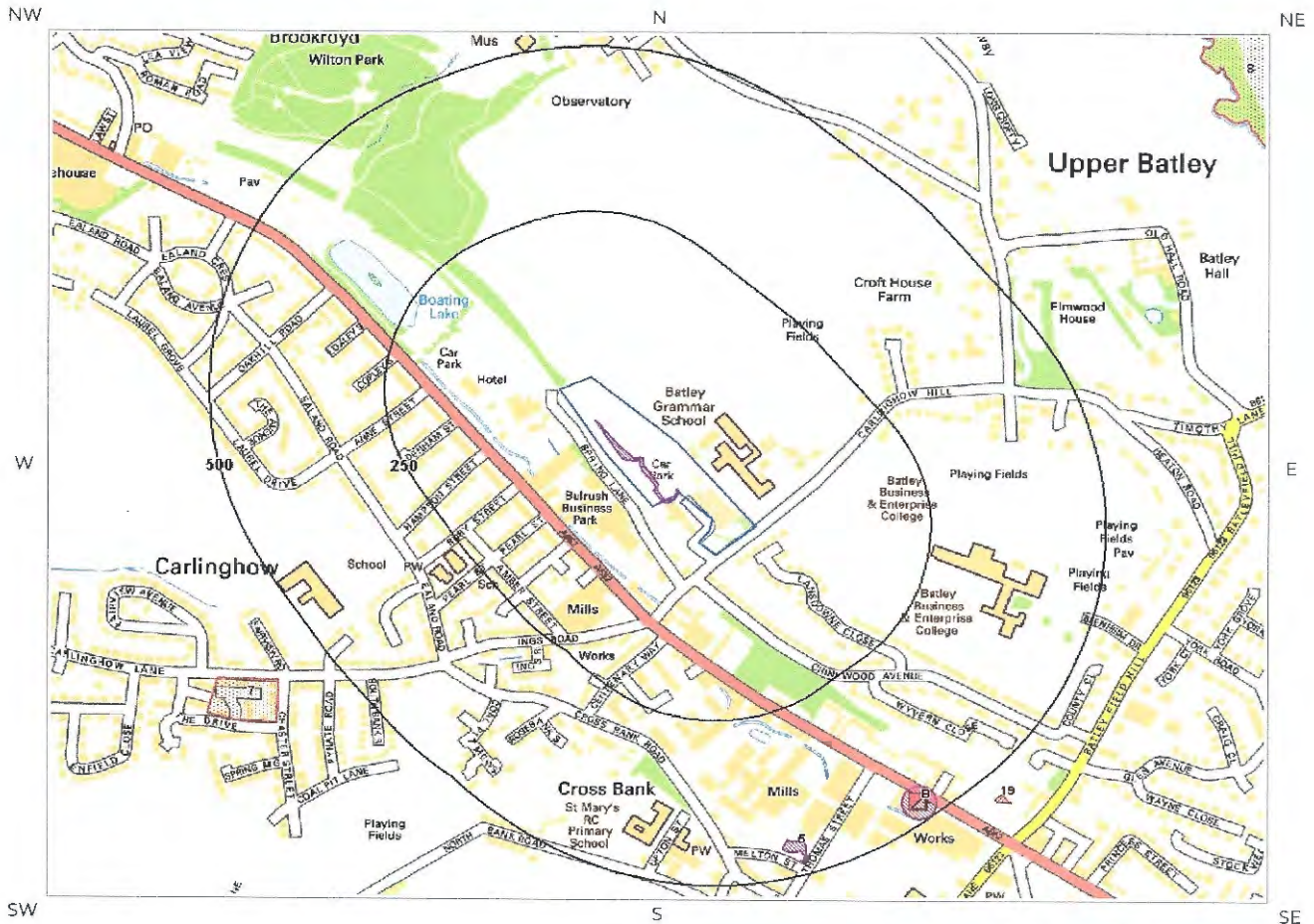

© Crown copyright and database rights 2019.
Ordnance Survey licence 100035207.

-  Site Outline
-  EA/NRW Active Landfill
-  Historic and Planned Waste Sites
-  EA/NRW Historic Landfill
-  EA/NRW Licensed Waste Site
-  BGS / DoE Survey Landfill
-  Local Authority/Historical Mapping Landfill Records
-  250 Search Buffers (m)
-  500 Search Buffers (m)

3. Landfill and Other Waste Sites

3.1 Landfill Sites

3.1.1 Records from Environment Agency/Natural Resources Wales landfill data within 1000m of the study site:

1

The following Environment Agency/Natural Resources Wales landfill records are represented as polygons on the Landfill and Other Waste Sites map:

ID	Distance (m)	Direction	NGR	Details
Not shown	978	NE	424843 425618	<p>Address: Land To Rear Of West View, Scotchman Road, Morley, Leeds, West Yorkshire, LS27 0NZ</p> <p>Landfill Reference: 61200.0</p> <p>Environmental Permitting Regulations (Waste) Reference: CAL001</p> <p>Landfill Type: A05: Landfill taking Non-Biodegradeable Wastes</p> <p>Operator: Calder J F Mr Status: Issued IPPC Reference: EPR Reference:</p>

3.1.2 Records of Environment Agency/Natural Resources Wales historic landfill sites within 1500m of the study site:

6

The following landfill records are represented as either points or polygons on the Landfill and Other Waste Sites map:

ID	Distance (m)	Direction	NGR	Details
7	580	SW		<p>Site Address: Chaster Street, Carlinghow, Batley</p> <p>Waste Licence: - Site Reference: - Waste Type: Inert, Commercial</p> <p>Environmental Permitting Regulations (Waste) Reference: -</p> <p>Licence Issue: Licence Surrendered: Licence Holder Address: - Operator: - Licence Holder: - First Recorded: - Last Recorded: -</p>
8	908	NE		<p>Site Address: West End Colliery, Scotchman Lane, Morley</p> <p>Waste Licence: - Site Reference: - Waste Type: Industrial</p> <p>Environmental Permitting Regulations (Waste) Reference: -</p> <p>Licence Issue: Licence Surrendered: Licence Holder Address: - Operator: Clugston Reclamation Licence Holder: - First Recorded: 01-Jun-1969 Last Recorded: 30-Jun-1977</p>
Not shown	1021	SE		<p>Site Address: Bridge Street, Batley, Yorkshire</p> <p>Waste Licence: - Site Reference: -</p> <p>Licence Issue: Licence Surrendered: Licence Holder Address: - Operator: James Duncan Limited</p>

ID	Distance (m)	Direction	NGR	Details	
				Waste Type: Liquid sludge Environmental Permitting Regulations (Waste) Reference: -	Licence Holder: - First Recorded: 30-Jun-1968 Last Recorded: -
Not shown	1119	NW		Site Address: Birstall Holder Station, Bradford Road, Birstall Waste Licence: Yes Site Reference: 4700/0080 Waste Type: Inert, Commercial Environmental Permitting Regulations (Waste) Reference: -	Licence Issue: 24-Aug-1977 Licence Surrendered: 30-Apr-1994 Licence Holder Address: New York Road, Leeds Operator: - Licence Holder: North East Gas First Recorded: 01-Jan-1974 Last Recorded: 05-Apr-1979
Not shown	1292	SW		Site Address: Jail Road, Off White Lee Road, Batley Waste Licence: Yes Site Reference: 4700/0244 Waste Type: Inert, Industrial, Commercial Environmental Permitting Regulations (Waste) Reference: -	Licence Issue: 08-Aug-1980 Licence Surrendered: 31-Jan-1984 Licence Holder Address: Progress Works, Hall Lane, Bradford Operator: - Licence Holder: Brian Gill (Excavations) Limited First Recorded: 31-Dec-1980 Last Recorded: 31-Dec-1984
Not shown	1472	N		Site Address: Railway Cutting, Moat Hill Farm, Howden Clough, Birstall, Batley Waste Licence: Yes Site Reference: 4700/0159 Waste Type: Inert, Industrial, Commercial Environmental Permitting Regulations (Waste) Reference: -	Licence Issue: 20-Nov-1978 Licence Surrendered: 21-Nov-1988 Licence Holder Address: Moat Hill Farm, Howden Clough, Birstall, Batley Operator: - Licence Holder: Mr Stanley Briggs First Recorded: 31-Dec-1978 Last Recorded: 31-Dec-1988

3.1.3 Records of BGS/DoE non-operational landfill sites within 1500m of the study site:

1

The following landfill records are represented as points on the Landfill and Other Waste Sites map:

ID	Distance (m)	Direction	NGR	Details	
Not shown	1117	SE	424800.0 424500.0	Address: Bridge Street, Batley, Yorks BGS Number: 1457.0	Risk: No risk to aquifer Waste Type: N/A

3.1.4 Records of Landfills from Local Authority and Historical Mapping Records within 1500m of the study site:

4

The following landfill records are represented as points or polygons on the Landfill and Other Waste Sites map:

ID	Distance (m)	Direction	NGR	Site Address	Source	Data Type
19	535	SE	424181 424638	Refuse Tip	1969 mapping	Polygon
Not shown	1052	NW	422600 425738	Refuse Tip	1966 mapping	Polygon

ID	Distance (m)	Direction	NGR	Site Address	Source	Data Type
Not shown	1066	NW	422854 426115	Refuse Tip	1967 mapping	Polygon
Not shown	1333	SW	422594 424246	Refuse Tip	1970 mapping	Polygon

3.2 Other Waste Sites

3.2.1 Records of waste treatment, transfer or disposal sites within 500m of the study site:

4

The following waste treatment, transfer or disposal sites records are represented as points on the Landfill and Other Waste Sites map:

ID	Distance (m)	Direction	NGR	Details		
3A	0	On Site	423662 425144	Type of Site: Ground Workings and Refuse Heap Site Address: N/A	Planning Application Reference: N/A Date: 1968	Further Details: N/A Data Source: Historic Mapping Data Type: Polygon
4A	0	On Site	423662 425144	Type of Site: Ground Workings and Refuse Heap Site Address: N/A	Planning Application Reference: N/A Date: 1955	Further Details: N/A Data Source: Historic Mapping Data Type: Polygon
5	442	S	423883 424555	Type of Site: Ground Workings and Refuse Heap Site Address: N/A	Planning Application Reference: N/A Date: 1955	Further Details: N/A Data Source: Historic Mapping Data Type: Polygon
6B	449	SE	424061 424631	Type of Site: Breakers Yard (Conversion) Site Address: 485 Bradford Road, BatleyWest YorkshireWF17 8LB	Planning Application Reference: 2014/62/90992/E Date: -	Further Details: Scheme comprises change of use from general industry to breakers yard. Data Source: Historic Planning Application Data Type: Point

3.2.2 Records of Environment Agency/Natural Resources Wales licensed waste sites within 1500m of the study site:

6

The following waste treatment, transfer or disposal sites records are represented as points on the Landfill and Other Waste Sites map:

ID	Distance (m)	Direction	NGR	Details	
13B	470	SE	424058 424633	Site Address: 485, Bradford Road, Batley, West Yorkshire, WF17 8LB Type: 75kte Vehicle Depollution Facility	Issue Date: 01/07/2010 Effective Date: - Modified: -

ID	Distance (m)	Direction	NGR	Details
				<p>Size: < 25000 tonnes Environmental Permitting Regulations (Waste) Licence Number: JMH002 EPR reference: EA/EPR/GP3693LB/A001 Operator: Helale Mansoor Waste Management licence No: 101566 Annual Tonnage: 74999.0</p> <p>Surrendered Date: - Expiry Date: - Cancelled Date: - Status: Issued Site Name: Manroz Breakers Correspondence Address: -</p>
14B	470	SE	424058 424633	<p>Site Address: 485, Bradford Road, Batley, West Yorkshire, WF17 8LB Type: Vehicle Depollution Facility <5000 tps Size: < 25000 tonnes Environmental Permitting Regulations (Waste) Licence Number: JMH002 EPR reference: EA/EPR/GP3693LB/V002 Operator: Helale Mansoor Waste Management licence No: 101566 Annual Tonnage: 4999.0</p> <p>Issue Date: 01/07/2010 Effective Date: - Modified: 12/09/2012 Surrendered Date: - Expiry Date: - Cancelled Date: - Status: Modified Site Name: M D Auto Salvage Correspondence Address: -</p>
Not shown	907	S	423700 424100	<p>Site Address: Corporation Yard, Mayman Lane, Batley, West Yorkshire, WF17 7TA Type: Household, Commercial & Industrial Waste T Stn Size: < 25000 tonnes Environmental Permitting Regulations (Waste) Licence Number: KMC003 EPR reference: EA/EPR/BP3396ZH/A001 Operator: Kirklees Council Waste Management licence No: 65524 Annual Tonnage: 24999.0</p> <p>Issue Date: 12/01/2007 Effective Date: - Modified: - Surrendered Date: - Expiry Date: - Cancelled Date: - Status: Issued Site Name: Corporation Yard Correspondence Address: -</p>
Not shown	1167	NE	424843 425618	<p>Site Address: Land To Rear Of West View, Scotchman Road, Morley, Leeds, West Yorkshire, LS27 0NZ Type: Landfill taking Non-Biodegradable Wastes Size: Unknown Environmental Permitting Regulations (Waste) Licence Number: CAL001 EPR reference: - Operator: Calder J F Mr Waste Management licence No: 61200 Annual Tonnage: 0.0</p> <p>Issue Date: 24/05/1984 Effective Date: - Modified: - Surrendered Date: - Expiry Date: - Cancelled Date: - Status: Issued Site Name: - Correspondence Address: West View, Scotchman Lane, Morley, Leeds, West Yorkshire, LS27 0NZ</p>
Not shown	1167	NE	424843 425618	<p>Site Address: Land To Rear Of West View, Scotchman Road, Morley, Leeds, West Yorkshire, LS27 0NZ Type: Landfill taking Non-Biodegradable Wastes Size: < 25000 tonnes Environmental Permitting Regulations (Waste) Licence Number: CAL001 EPR reference: EA/EPR/CP3795ZW/A001 Operator: Calder J F Mr Waste Management licence No: 61200 Annual Tonnage: 24850.0</p> <p>Issue Date: 24/05/1984 Effective Date: - Modified: - Surrendered Date: - Expiry Date: 02/12/2009 Cancelled Date: - Status: Issued Site Name: Mr J F Calder Correspondence Address: -</p>
Not shown	1393	NW	422727 426381	<p>Site Address: Gelderd Road, Birstall, Batley, West Yorkshire, WF17 9PX Type: Metal Recycling Site (mixed MRS's) Size: < 25000 tonnes Environmental Permitting Regulations (Waste) Licence Number: MAW001 EPR reference: EA/EPR/GP3895ZQ/A001 Operator: M A Warren Waste Management licence No: 61011 Annual Tonnage: 23000.0</p> <p>Issue Date: 01/04/1974 Effective Date: - Modified: - Surrendered Date: - Expiry Date: - Cancelled Date: - Status: Revoked Site Name: The Scrapyard Correspondence Address: -</p>

4. Current Land Use Map

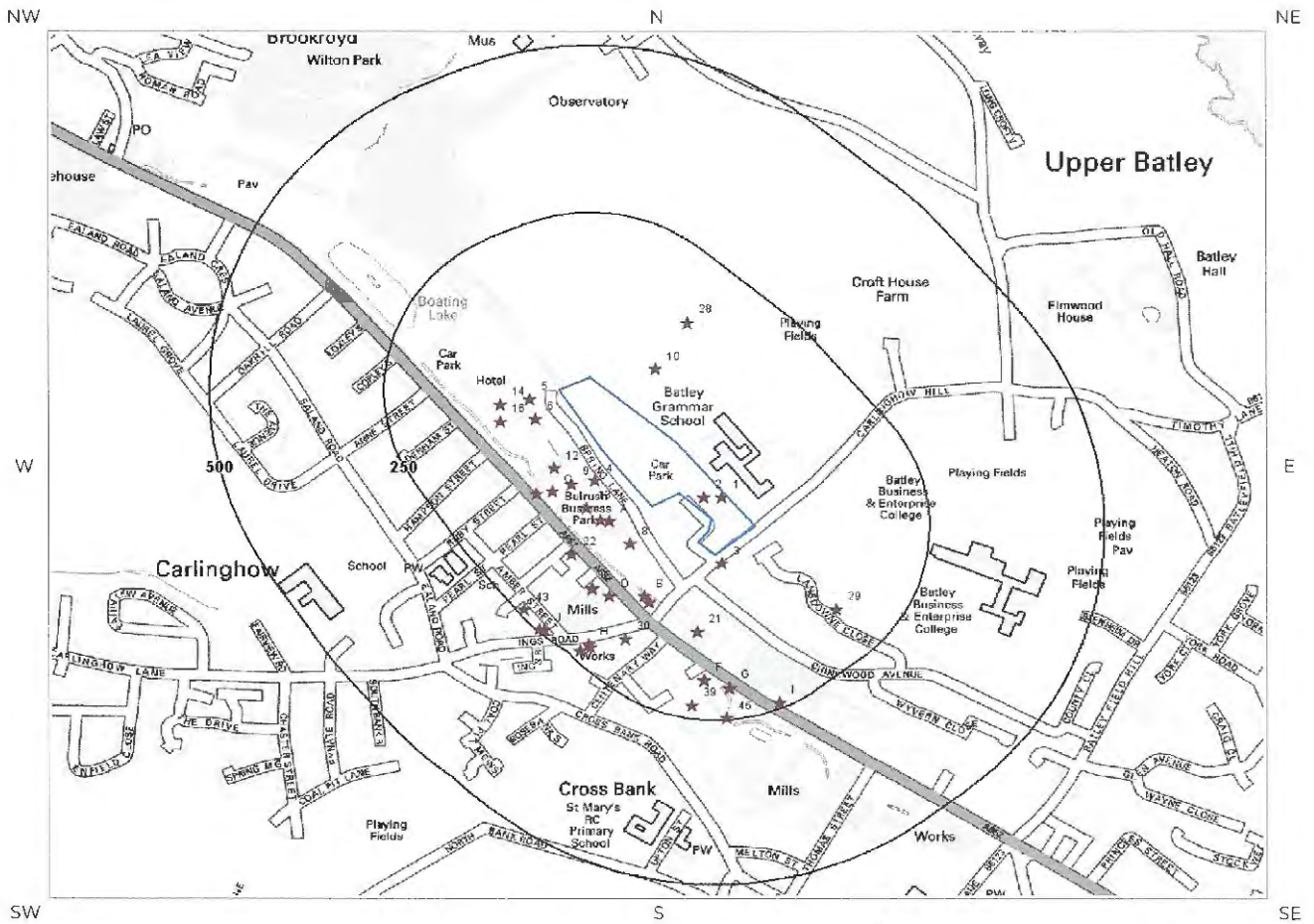

© Crown copyright and database rights 2019.
Ordnance Survey licence 100035207.

- | | | | | | |
|---|--------------------|---|--------------------------|--|---------------------------------|
|  | Site Outline |  | Current Industrial Sites |  | Electricity Transmission Cables |
|  | Search Buffers (m) |  | Petrol & Fuel Sites |  | Gas Transmission Pipelines |

4. Current Land Uses

4.1 Current Industrial Data

Records of potentially contaminative industrial sites within 250m of the study site:

46

The following records are represented as points on the Current Land Uses map.

ID	Distance (m)	Direction	Company	NGR	Address	Activity	Category
1	0	On Site	Tank	423778 425092	West Yorkshire, WF17	Tanks (Generic)	Industrial Features
2	0	On Site	Electricity Sub Station	423752 425092	West Yorkshire, WF17	Electrical Features	Infrastructure and Facilities
3	16	SE	Electricity Sub Station	423778 424991	West Yorkshire, WF17	Electrical Features	Infrastructure and Facilities
4	38	SW	Prestige Tyres & Auto Centre	423596 425117	Unit 6 Bullrush Mills, 624 Bradford Road, Batley, West Yorkshire, WF17 8HF	Vehicle Parts and Accessories	Motoring
5	44	W	Chimney	423503 425241	West Yorkshire, WF17	Chimneys	Industrial Features
6	52	SW	Works	423511 425211	West Yorkshire, WF17	Unspecified Works Or Factories	Industrial Features
7A	62	SW	Works	423616 425055	West Yorkshire, WF17	Unspecified Works Or Factories	Industrial Features
8	65	SW	Northern Shelving Ltd	423646 425021	620, Bradford Road, Batley, West Yorkshire, WF17 8HF	Building and Component Suppliers	Construction Services
9	66	SW	Bulrush Business Park	423563 425112	West Yorkshire, WF17	Business Parks and Industrial Estates	Industrial Features
10	68	NE	Rifle Range	423683 425286	West Yorkshire, WF17	Shooting Facilities	Sports Complex
11A	70	SW	Haani Furniture Ltd	423604 425057	620, Bradford Road, Batley, West Yorkshire, WF17 8HF	Beds and Bedding	Consumer Products
12	73	SW	Computer Repairs Centre	423538 425136	Bullrush Mills 624, Bradford Road, Batley, West Yorkshire, WF17 8HF	Electrical Equipment Repair and Servicing	Repair and Servicing
13	73	SW	Bulrush Works	423584 425076	West Yorkshire, WF17	Unspecified Works Or Factories	Industrial Features
14	87	W	Depot	423461 425233	West Yorkshire, WF17	Container and Storage	Transport, Storage and Delivery
15C	94	SW	Johnson Auto Repairs	423536 425101	Johnson Auto Repairs Unit 12 Bullrush Mills 624, Bradford Road, Batley, West Yorkshire, WF17 8HF	Vehicle Repair, Testing and Servicing	Repair and Servicing
16	96	SW	Park Works	423461 425207	West Yorkshire, WF17	Unspecified Works Or Factories	Industrial Features
17B	112	SW	B M V	423667 424942	604, Bradford Road, Batley, West Yorkshire, WF17 8HA	Vehicle Repair, Testing and Servicing	Repair and Servicing

ID	Distance (m)	Direction	Company	NGR	Address	Activity	Category
18B	114	SW	Fast Fix Autocentre	423674 424933	604, Bradford Road, Batley, West Yorkshire, WF17 8HA	Vehicle Repair, Testing and Servicing	Repair and Servicing
19B	114	SW	Crystal Hand Car Wash	423674 424933	604, Bradford Road, Batley, West Yorkshire, WF17 8HA	Vehicle Cleaning Services	Personal, Consumer and Other Services
20C	116	SW	Electricity Sub Station	423513 425097	West Yorkshire, WF17	Electrical Features	Infrastructure and Facilities
21	118	S	German Tyres Ltd	423743 424889	The Old Tram Sheds 588, Bradford Road, Batley, West Yorkshire, WF17 8LP	Vehicle Parts and Accessories	Motoring
22	136	SW	Metal Powder Coatings Ltd	423562 425005	Unit 1 Dock ING Mills 581, Bradford Road, Batley, West Yorkshire, WF17 8HB	Industrial Coatings and Finishings	Industrial Products
23D	149	SW	Chimney	423616 424942	West Yorkshire, WF17	Chimneys	Industrial Features
24D	151	SW	Sampson Products Ltd	423592 424954	Dock Ings Mill, Ings Road, Batley, West Yorkshire, WF17 8LT	Packaging	Industrial Products
25E	151	SW	Millbeck Motors	423592 424954	Unit 2 Docking Mills, Bradford Road, Batley, West Yorkshire, WF17 8HB	Secondhand Vehicles	Motoring
26E	151	SW	Living Style	423592 424954	Unit 6 Dock ING Mills 581, Bradford Road, Batley, West Yorkshire, WF17 8HB	Carpets, Flooring, Rugs and Soft Furnishings	Consumer Products
27E	151	SW	Eclipse Headboard	423592 424954	Unit 5 Dock ING Mills 581, Bradford Road, Batley, West Yorkshire, WF17 8HB	Carpets, Flooring, Rugs and Soft Furnishings	Consumer Products
28	152	NE	Shaft (Disused)	423729 425357	West Yorkshire, WF17	Unspecified Quarries Or Mines	Extractive Industries
29	169	SE	Mast	423942 424923	West Yorkshire, WF17	Telecommunications Features	Infrastructure and Facilities
30	178	SW	Works	423640 424878	West Yorkshire, WF17	Unspecified Works Or Factories	Industrial Features
31F	189	S	Sleep Pose	423752 424816	Unit 16 Batley Enterprise Centre 513, Bradford Road, Batley, West Yorkshire, WF17 8LL	Beds and Bedding	Consumer Products
32F	189	S	Trade Direct Outlet	423752 424816	Unit 16 Batley Enterprise Centre 513, Bradford Road, Batley, West Yorkshire, WF17 8LL	General Construction Supplies	Industrial Products
33G	200	S	C U Global Traders Ltd	423788 424805	Room No 25 Batley Enterprise Centre, 513 Bradford Road, Batley, West Yorkshire, WF17 8LL	Beds and Bedding	Consumer Products
34G	202	S	Pub Tales	423789 424803	Batley Enterprise Centre 513, Bradford Road, Batley, West Yorkshire, WF17 8LL	Published Goods	Industrial Products
35G	202	S	Autohaus	423789 424803	Unit 44 Batley Enterprise Centre 513, Bradford Road, Batley, West Yorkshire, WF17 8LL	Vehicle Parts and Accessories	Motoring

ID	Distance (m)	Direction	Company	NGR	Address	Activity	Category
36G	202	S	Nor-rak Systems Ltd	423789 424803	Unit 10 Batley Enterprise Centre 513, Bradford Road, Batley, West Yorkshire, WF17 8LL	Shelving, Storage, Safes and Vaults	Industrial Products
37H	219	SW	Works	423587 424870	West Yorkshire, WF17	Unspecified Works Or Factories	Industrial Features
38H	221	SW	Robson & Moss Ltd	423590 424865	Ings Road, Batley, West Yorkshire, WF17 8LT	Industrial Engineers	Engineering Services
39	229	S	Batley Enterprise Centre	423734 424778	West Yorkshire, WF17	Business Parks and Industrial Estates	Industrial Features
40H	235	SW	Electricity Sub Station	423575 424860	West Yorkshire, WF17	Electrical Features	Infrastructure and Facilities
41I	241	SE	Platinum Motor Company Ltd	423861 424782	578, Bradford Road, Batley, West Yorkshire, WF17 8LP	Secondhand Vehicles	Motoring
42I	241	SE	IMO - arc Clean Car Centres	423861 424782	Bradford Road, Batley, West Yorkshire, WF17 8LP	Vehicle Cleaning Services	Personal, Consumer and Other Services
43	241	SW	Vehicle Electronics Services	423495 424922	1, Amber Street, Batley, West Yorkshire, WF17 8HH	Vehicle Repair, Testing and Servicing	Repair and Servicing
44J	243	SW	Carlinghow Motor Care	423523 424891	1a, Ings Road, Batley, West Yorkshire, WF17 8LT	Vehicle Repair, Testing and Servicing	Repair and Servicing
45	247	S	Impress Blinds	423784 424758	499, Bradford Road, Batley, West Yorkshire, WF17 8LL	Curtains and Blinds	Consumer Products
46J	247	SW	At Sawani	423516 424892	Unit 1c, Ings Road, Batley, West Yorkshire, WF17 8LT	Metals Manufacturers, Fabricators and Stockholders	Industrial Products

4.2 Petrol and Fuel Sites

Records of petrol or fuel sites within 500m of the study site: 0

Database searched and no data found.

4.3 National Grid High Voltage Underground Electricity Transmission Cables

This dataset identifies the high voltage electricity transmission lines running between generating power plants and electricity substations. The dataset does not include the electricity distribution network (smaller, lower voltage cables distributing power from substations to the local user network). This information has been extracted from databases held by National Grid and is provided for information only with no guarantee as to its completeness or accuracy. National Grid do not offer any warranty as to the accuracy of the available data and are excluded from any liability for any such inaccuracies or errors.

Records of National Grid high voltage underground electricity transmission cables within 500m of the study site: 0

Database searched and no data found.

4.4 National Grid High Pressure Gas Transmission Pipelines

This dataset identifies high-pressure, large diameter pipelines which carry gas between gas terminals, power stations, compressors and storage facilities. The dataset does not include the Local Transmission System (LTS) which supplies gas directly into homes and businesses. This information has been extracted from databases held by National Grid and is provided for information only with no guarantee as to its completeness or accuracy. National Grid do not offer any warranty as to the accuracy of the available data and are excluded from any liability for any such inaccuracies or errors.

Records of National Grid high pressure gas transmission pipelines within 500m of the study site: 0

Database searched and no data found.

5. Geology

5.1 Artificial Ground and Made Ground

The database has been searched on site, including a 50m buffer.

Lex Code	Description	Rock Type
MGR-ARTDP	MADE GROUND (UNDIVIDED)	ARTIFICIAL DEPOSIT

5.2 Superficial Ground and Drift Geology

Database searched and no data found.

The database has been searched on site, including a 50m buffer.

5.3 Bedrock and Solid Geology

The database has been searched on site, including a 50m buffer.

Lex Code	Description	Rock Type
PLCM-MDSS	PENNINE LOWER COAL MEASURES FORMATION	MUDSTONE, SILTSTONE AND SANDSTONE
ER-SDST	EMLEY ROCK	SANDSTONE
PLCM-MDSS	PENNINE LOWER COAL MEASURES FORMATION	MUDSTONE, SILTSTONE AND SANDSTONE
PLCM-MDSS	PENNINE LOWER COAL MEASURES FORMATION	MUDSTONE, SILTSTONE AND SANDSTONE
PLCM-MDSS	PENNINE LOWER COAL MEASURES FORMATION	MUDSTONE, SILTSTONE AND SANDSTONE
PLCM-MDSS	PENNINE LOWER COAL MEASURES FORMATION	MUDSTONE, SILTSTONE AND SANDSTONE
PMCM-MDSS	PENNINE MIDDLE COAL MEASURES FORMATION	MUDSTONE, SILTSTONE AND SANDSTONE
BRSR-SDST	BIRSTALL ROCK	SANDSTONE

(Derived from the BGS 1:50,000 Digital Geological Map of Great Britain)

6 Hydrogeology and Hydrology

6a. Aquifer Within Superficial Geology

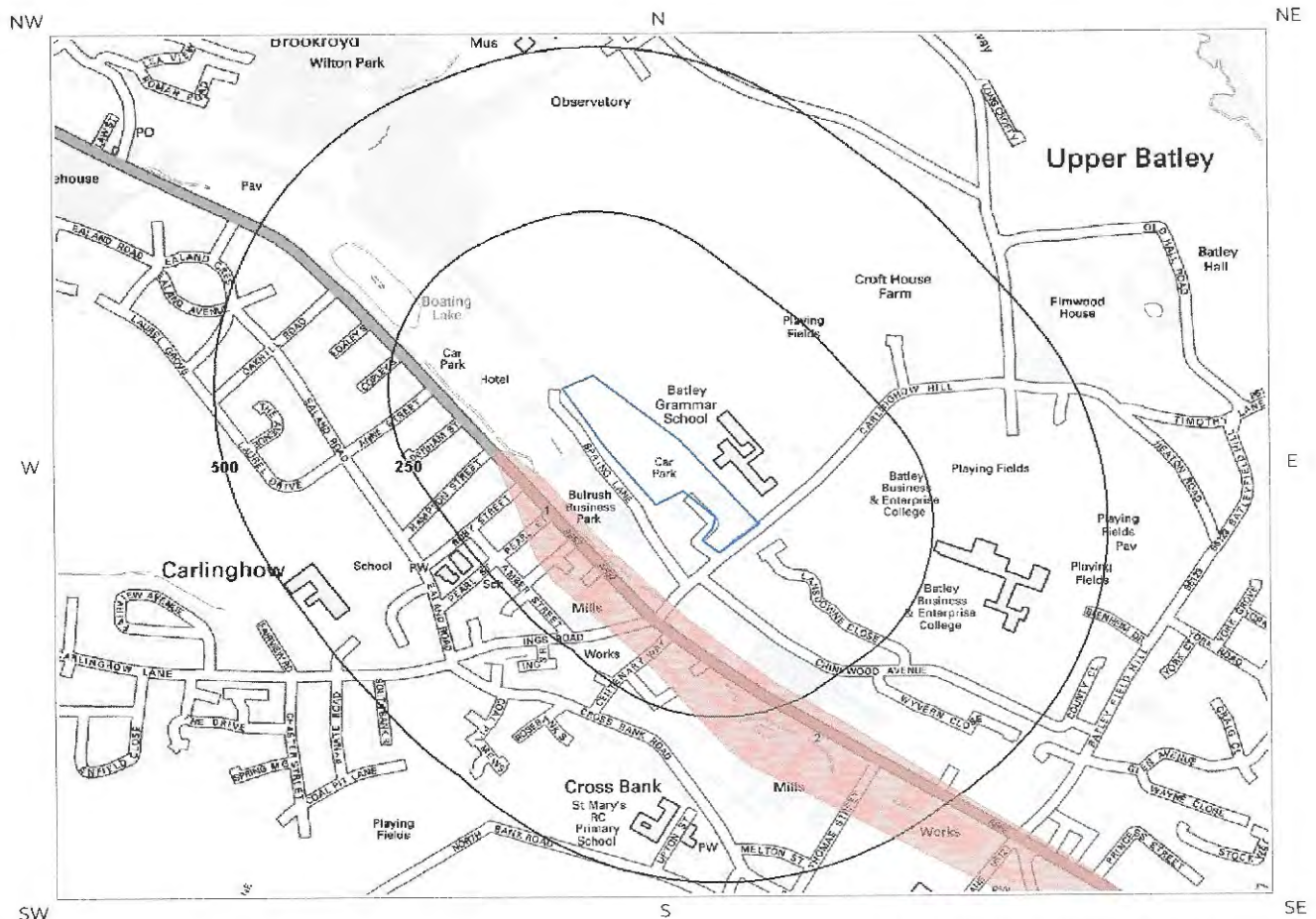

© Crown copyright and database rights 2019
Ordnance Survey licence 100035207.

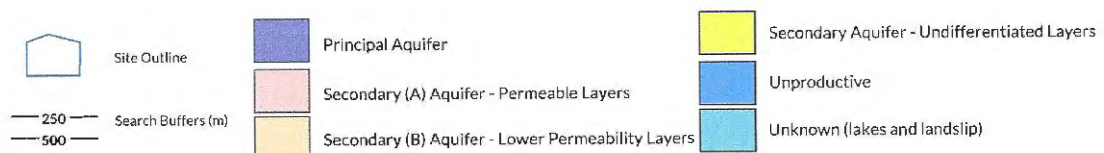

6b. Aquifer Within Bedrock Geology and Abstraction Licences

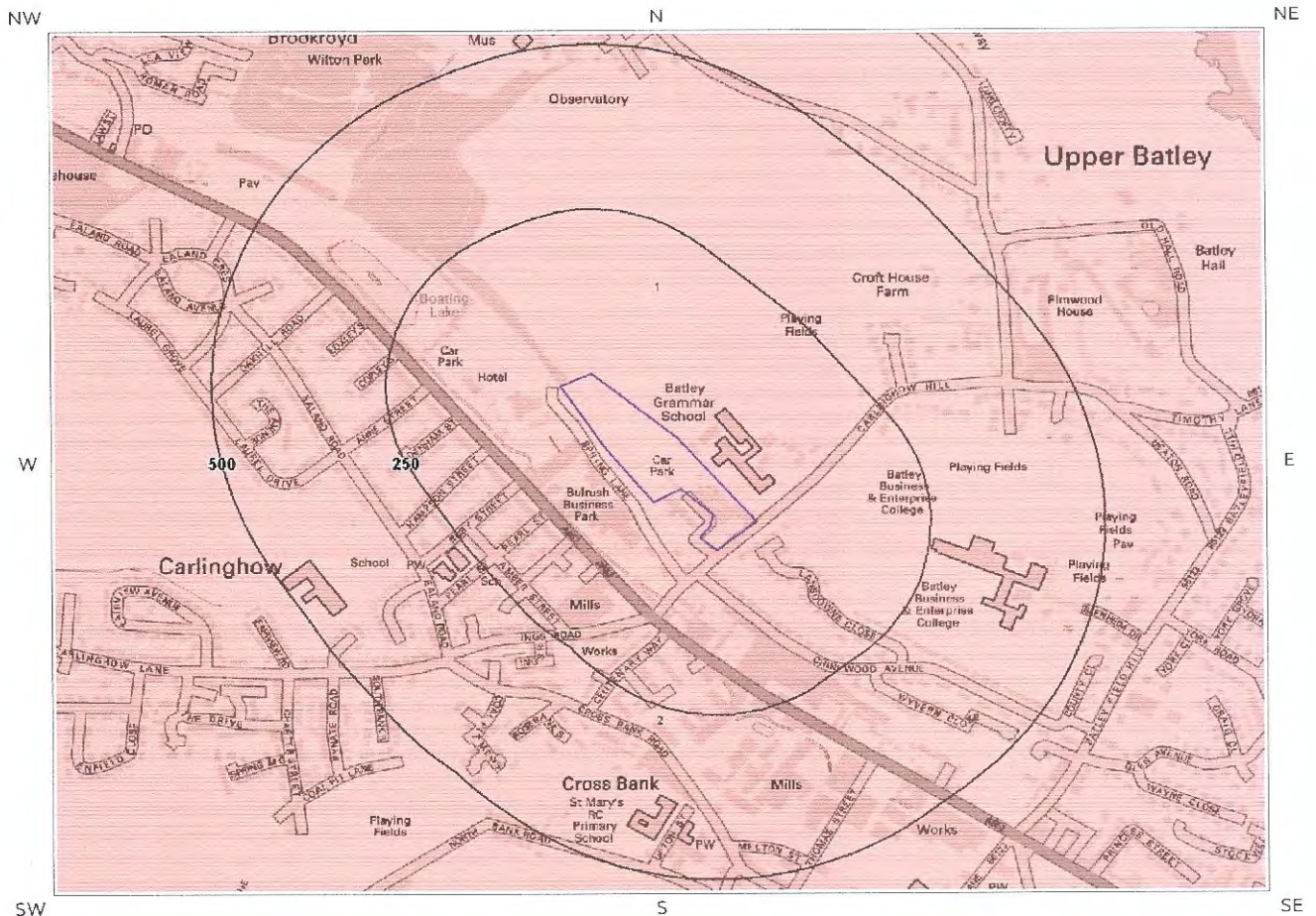

© Crown copyright and database rights 2019
Ordnance Survey licence 100035207.

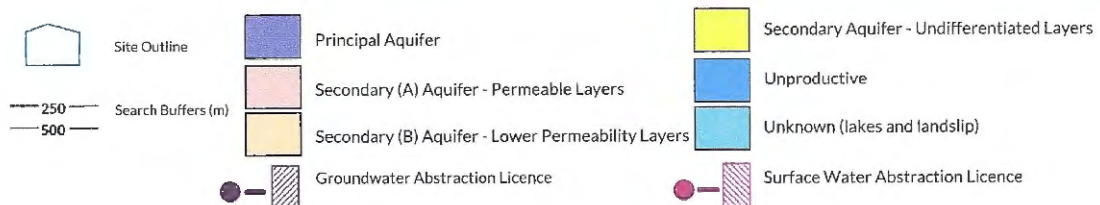

6c. Hydrogeology – Source Protection Zones and Potable Water Abstraction Licences

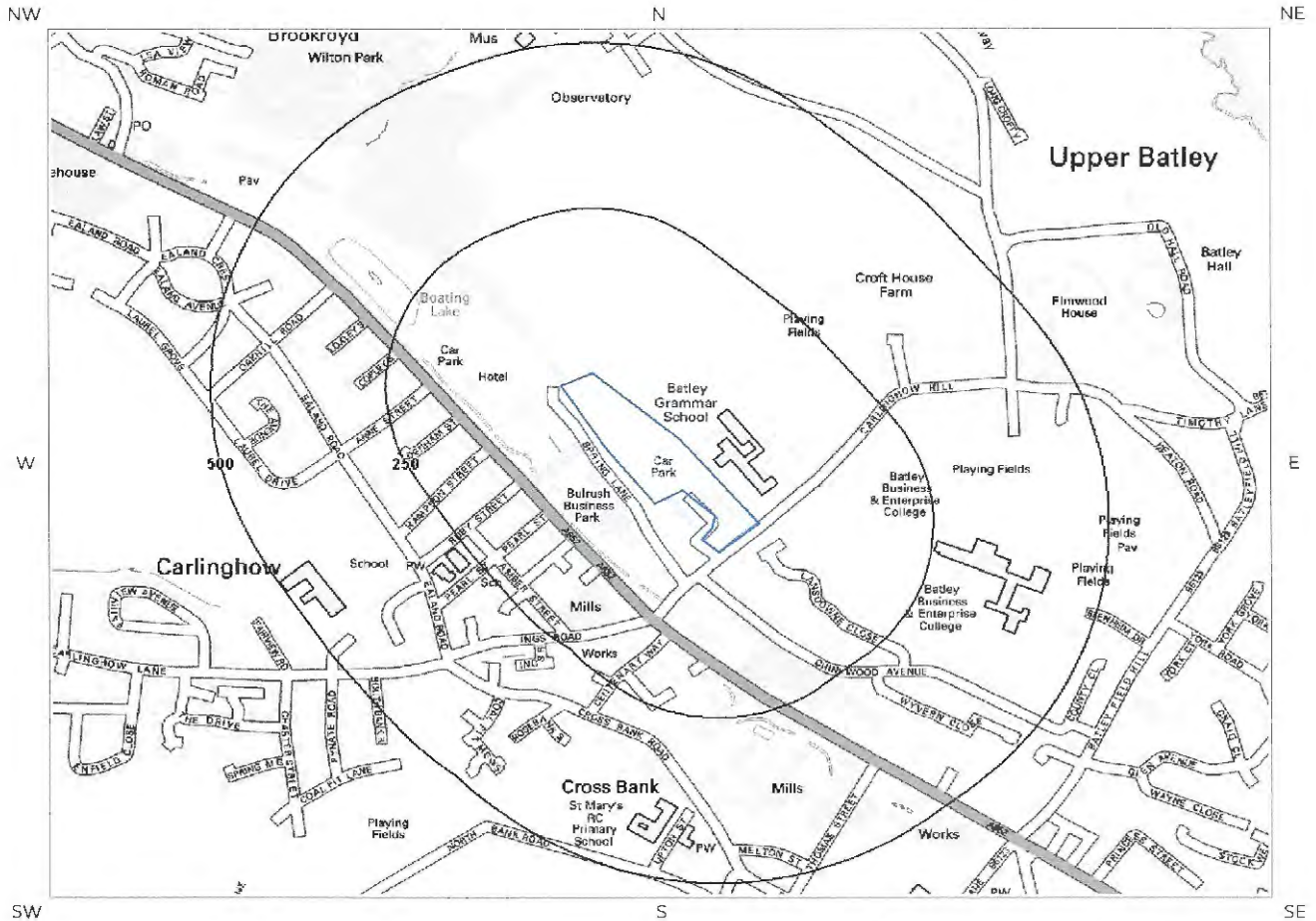

© Crown copyright and database rights 2019
Ordnance Survey licence 100035207.

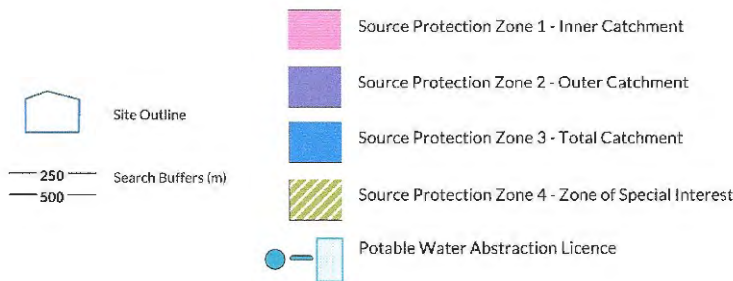

6d. Hydrogeology – Source Protection Zones within confined aquifer

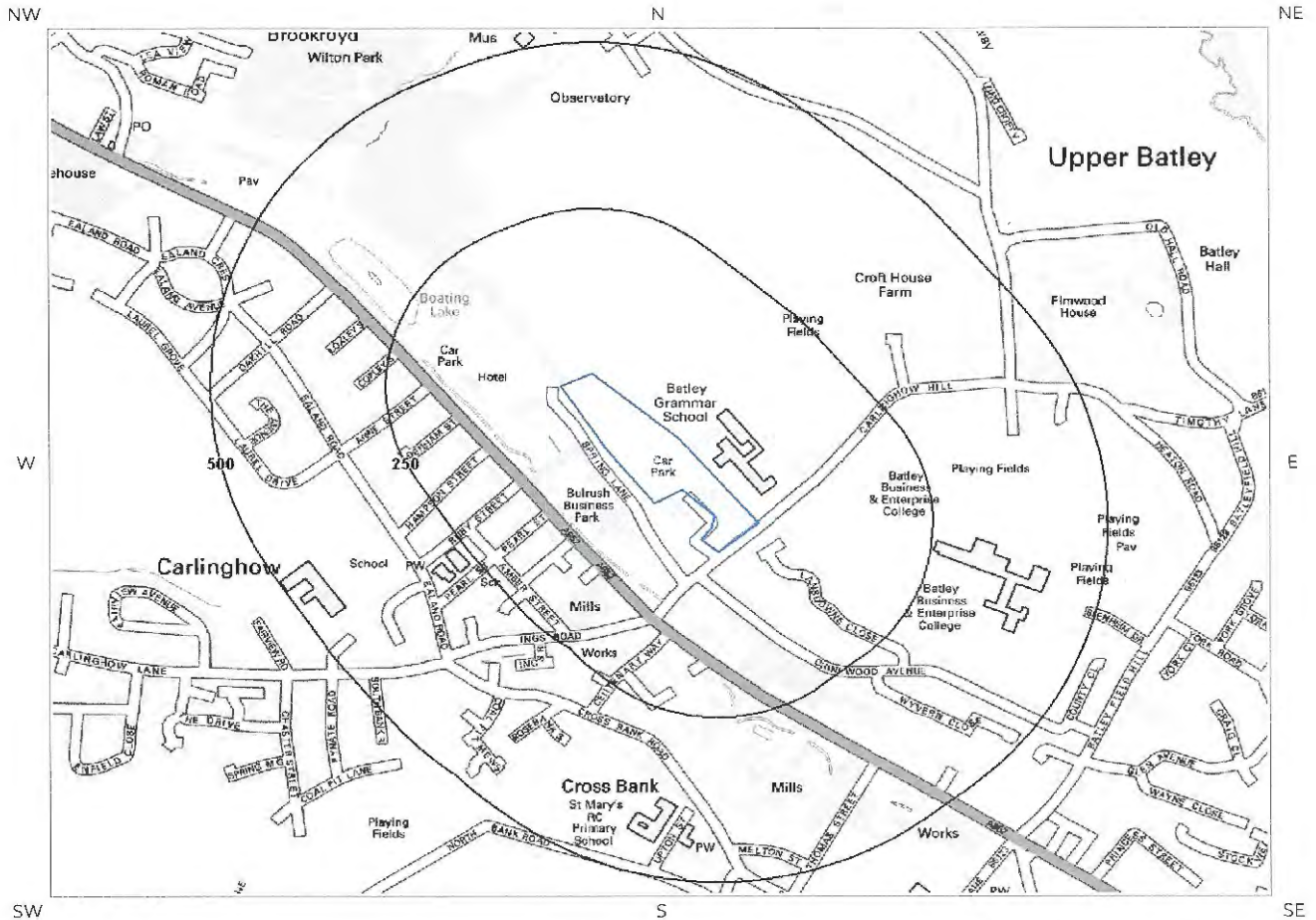

© Crown copyright and database rights 2019
 Ordnance Survey licence 100035207.

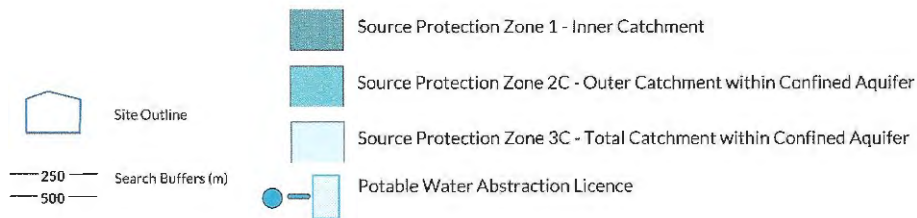

6e. Hydrology – Watercourse Network and River Quality

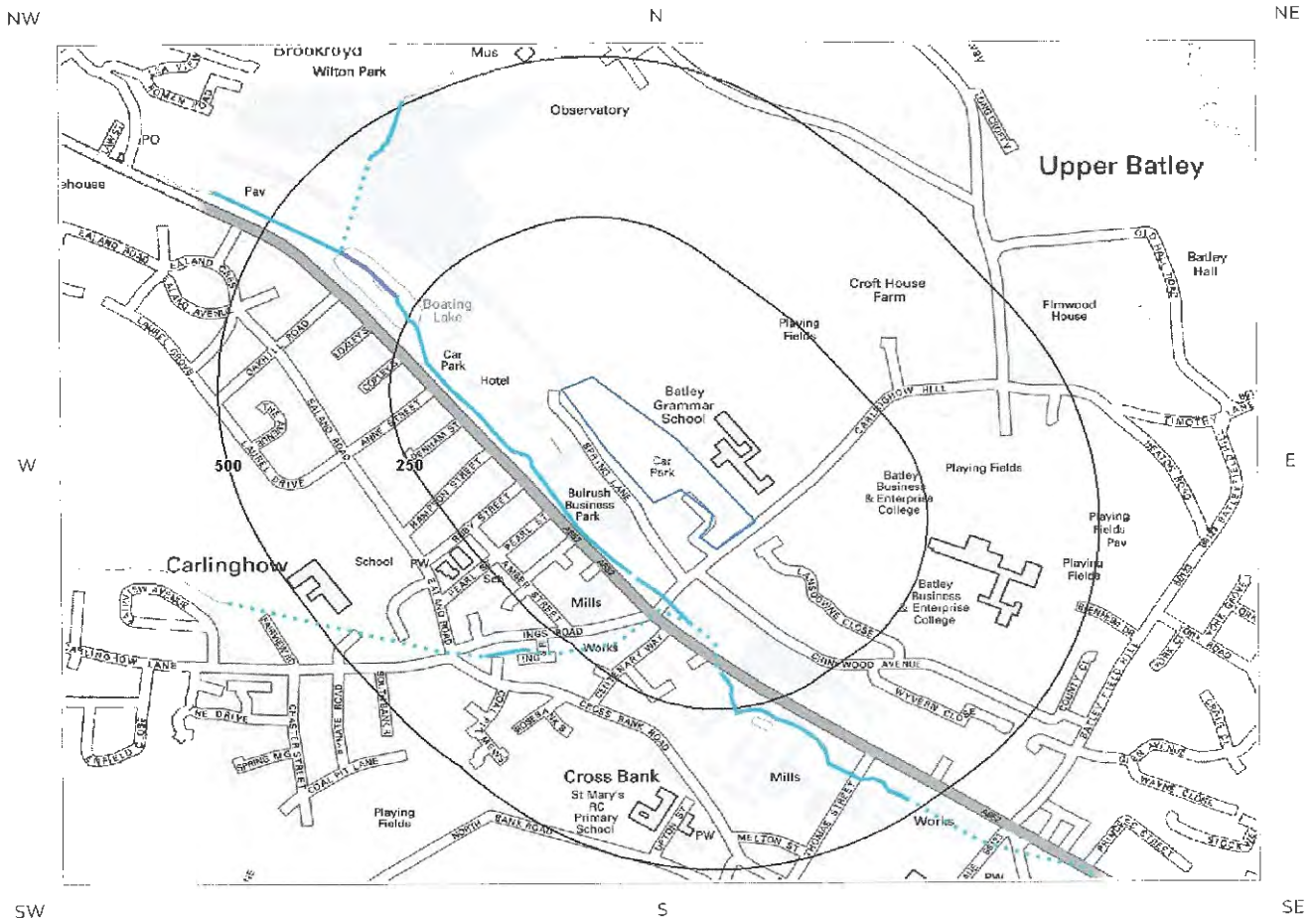

© Crown copyright and database rights 2019.
Ordnance Survey licence 100035207.

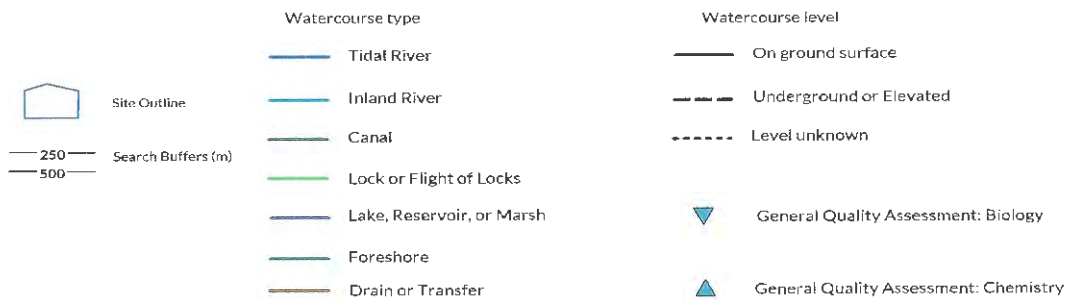

6. Hydrogeology and Hydrology

6.1 Aquifer within Superficial Deposits

Records of strata classification within the superficial geology at or in proximity to the property Yes

From 1 April 2010, the Environment Agency/Natural Resources Wales's Groundwater Protection Policy has been using aquifer designations consistent with the Water Framework Directive. For further details on the designation and interpretation of this information, please refer to the Groundsure Enviro Insight User Guide.

The following aquifer records are shown on the Aquifer within Superficial Geology Map (6a):

ID	Distance (m)	Direction	Designation	Description
1	95	SW	Secondary A	Permeable layers capable of supporting water supplies at a local rather than strategic scale, and in some cases forming an important source of base flow to rivers. These are generally aquifers formerly classified as minor aquifers
2	96	SW	Secondary A	Permeable layers capable of supporting water supplies at a local rather than strategic scale, and in some cases forming an important source of base flow to rivers. These are generally aquifers formerly classified as minor aquifers

6.2 Aquifer within Bedrock Deposits

Records of strata classification within the bedrock geology at or in proximity to the property Yes

From 1 April 2010, the Environment Agency/Natural Resources Wales's Groundwater Protection Policy has been using aquifer designations consistent with the Water Framework Directive. For further details on the designation and interpretation of this information, please refer to the Groundsure Enviro Insight User Guide.

The following aquifer records are shown on the Aquifer within Bedrock Geology Map (6b):

ID	Distance (m)	Direction	Designation	Description
1	0	On Site	Secondary A	Permeable layers capable of supporting water supplies at a local rather than strategic scale, and in some cases forming an important source of base flow to rivers. These are generally aquifers formerly classified as minor aquifers
2	4	S	Secondary A	Permeable layers capable of supporting water supplies at a local rather than strategic scale, and in some cases forming an important source of base flow to rivers. These are generally aquifers formerly classified as minor aquifers

6.3 Groundwater Abstraction Licences

Groundwater Abstraction Licences within 2000m of the study site

Identified

The following Abstraction Licences records are represented as points, lines and regions on the Aquifer within Bedrock Geology Map (6b):

ID	Distance (m)	Direction	NGR	Details
Not shown	1046	NW	422600 425700	Status: Historical Licence No: 2/27/13/027 Details: General use relating to Secondary Category (Medium Loss) Direct Source: GROUNDWATERS Point: WELL Data Type: Point Name: ROUNDHAY METAL FINISHERS (LEEDS) LTD Annual Volume (m ³): - Max Daily Volume (m ³): - Original Application No: - Original Start Date: 14/12/1965 Expiry Date: - Issue No: 100 Version Start Date: 14/12/1965 Version End Date:
Not shown	1046	NW	422600 425700	Status: Historical Licence No: 2/27/13/027 Details: General use relating to Secondary Category (Medium Loss) Direct Source: GROUNDWATERS Point: WELL - COAL MEASURES - BIRSTALL Data Type: Point Name: MOSS METAL FINISHING LIMITED Annual Volume (m ³): - Max Daily Volume (m ³): - Original Application No: - Original Start Date: 14/12/1965 Expiry Date: - Issue No: 101 Version Start Date: 18/04/2002 Version End Date:
Not shown	1389	W	422230 425700	Status: Historical Licence No: 2/27/13/220 Details: General Use Relating To Secondary Category (Medium Loss) Direct Source: GROUNDWATERS Point: BOREHOLE - COAL MEASURES - BATLEY Data Type: Point Name: SIGMAKALON UK LTD Annual Volume (m ³): 50000 Max Daily Volume (m ³): 240 Original Application No: - Original Start Date: 01/01/2007 Expiry Date: 31/03/2015 Issue No: 1 Version Start Date: 01/01/2007 Version End Date:
Not shown	1389	W	422230 425700	Status: Historical Licence No: 2/27/13/190 Details: General use relating to Secondary Category (High Loss) Direct Source: GROUNDWATERS Point: BOREHOLE Data Type: Point Name: KALON GROUP LIMITED Annual Volume (m ³): - Max Daily Volume (m ³): - Original Application No: - Original Start Date: 30/04/1997 Expiry Date: 31/12/2006 Issue No: 100 Version Start Date: 30/04/1997 Version End Date:
Not shown	1389	W	422230 425700	Status: Historical Licence No: 2/27/13/190 Details: General use relating to Secondary Category (High Loss) Direct Source: GROUNDWATERS Point: BOREHOLE - COAL MEASURES - BATLEY Data Type: Point Name: SIGMAKALON UK LTD Annual Volume (m ³): 50000 Max Daily Volume (m ³): 240 Original Application No: - Original Start Date: 30/04/1997 Expiry Date: 31/12/2006 Issue No: 103 Version Start Date: 13/03/2006 Version End Date:
Not shown	1735	E	425500 425500	Status: Active Licence No: 2/27/13/004 Details: Spray Irrigation - Direct Direct Source: GROUNDWATERS Point: BOREHOLE - COAL MEASURES - MORLEY Data Type: Point Name: HOWLEY HALL GOLF CLUB LTD Annual Volume (m ³): 6364 Max Daily Volume (m ³): 63.644 Original Application No: - Original Start Date: 01/12/1965 Expiry Date: - Issue No: 100 Version Start Date: 01/12/1965 Version End Date:

ID	Distance (m)	Direction	NGR	Details
Not shown	1735	E	425500 425500	Status: Historical Licence No: 2/27/13/004 Details: Spray Irrigation - Direct Direct Source: GROUNDWATERS Point: BOREHOLE Data Type: Point Name: HOWLEY HALL GOLF CLUB LTD Annual Volume (m ³): - Max Daily Volume (m ³): - Original Application No: - Original Start Date: 01/12/1965 Expiry Date: - Issue No: - Version Start Date: 01/12/1965 Version End Date: -
Not shown	1956	SW	422650 423400	Status: Historical Licence No: 2/27/13/193 Details: General use relating to Secondary Category (Medium Loss) Direct Source: GROUNDWATERS Point: BOREHOLE - COAL MEASURES - STAINCLIFFE DEWSBURY Data Type: Point Name: THOMAS CARR LTD Annual Volume (m ³): - Max Daily Volume (m ³): - Original Application No: - Original Start Date: 04/03/1998 Expiry Date: 31/12/2008 Issue No: 100 Version Start Date: 04/03/1998 Version End Date: -
Not shown	1956	SW	422650 423400	Status: Historical Licence No: 2/27/13/193 Details: General use relating to Secondary Category (Medium Loss) Direct Source: GROUNDWATERS Point: BOREHOLE Data Type: Point Name: THOMAS CARR LIMITED C/O BERNARD KAYE Annual Volume (m ³): - Max Daily Volume (m ³): - Original Application No: - Original Start Date: 04/03/1998 Expiry Date: 31/12/2008 Issue No: 100 Version Start Date: 04/03/1998 Version End Date: -

6.4 Surface Water Abstraction Licences

Surface Water Abstraction Licences within 2000m of the study site

Identified

The following Surface Water Abstraction Licences records are represented as points, lines and regions on the Aquifer within Bedrock Geology Map (6b):

ID	Distance (m)	Direction	NGR	Details
Not shown	1838	SE	424810 423490	Status: Historical Licence No: 2/27/13/206 Details: General Use Relating To Secondary Category (Medium Loss) Direct Source: SURFACE WATER Point: BATLEY BECK Data Type: Point Name: CULLINGWORTH SUMMERS & CO LTD Annual Volume (m ³): 11500 Max Daily Volume (m ³): 60 Application No: - Original Start Date: 21/08/2001 Expiry Date: 31/03/2015 Issue No: 2 Version Start Date: 23/05/2005 Version End Date: -

6.5 Potable Water Abstraction Licences

Potable Water Abstraction Licences within 2000m of the study site

None identified

Database searched and no data found.

6.6 Source Protection Zones

Source Protection Zones within 500m of the study site

None identified

Database searched and no data found.

6.7 Source Protection Zones within Confined Aquifer

Source Protection Zones within the Confined Aquifer within 500m of the study site

None identified

Historically, Source Protection Zone maps have been focused on regulation of activities which occur at or near the ground surface, such as prevention of point source pollution and bacterial contamination of water supplies. Sources in confined aquifers were often considered to be protected from these surface pressures due to the presence of a low permeability confining layer (e.g. glacial till, clay). The increased interest in subsurface activities such as onshore oil and gas exploration, ground source heating and cooling requires protection zones for confined sources to be marked on SPZ maps where this has not already been done.

Database searched and no data found.

6.8 Groundwater Vulnerability and Soil Leaching Potential

Environment Agency/Natural Resources Wales information on groundwater vulnerability and soil leaching potential within 500m of the study site

Identified

Distance (m)	Direction	Classification	Soil Vulnerability Category	Description
0	On Site	Minor Aquifer/High Leaching Potential	HU	Soil information for urban areas and restored mineral workings. These soils are therefore assumed to be highly permeable in the absence of site-specific information.

6.9 River Quality

Environment Agency/Natural Resources Wales information on river quality within 1500m of the study site

None identified

6.9.1 Biological Quality:

Database searched and no data found.

6.9.2 Chemical Quality:

Database searched and no data found.

6.10 Ordnance Survey MasterMap Water Network

Ordnance Survey MasterMap Water Network entries within 500m of the study site

This watercourse information is provided by Ordnance Survey MasterMap Water Network. The data provides a detailed centre line following the curve of the waterway precisely, so all distances provided in the report should be understood as measurements to the centreline rather than a measurement to the nearest point of the watercourse. Underground watercourses are inferred from entry and exit points so caution is advised in using these to indicate precise locations of underground watercourses when planning site investigation and development.

The following Ordnance Survey MasterMap Water Network records are represented on the Hydrology Map (6e):

ID	Distance/ Direction	Name	Type of Watercourse	Additional Details
1	99 SW	Smithies Beck	Inland river not influenced by normal tidal action.	Catchment Area: Aire and Calder Relationship to Ground Level: On ground surface Permanence: Watercourse contains water year round (in normal conditions) Average Width in Watercourse Section (m): 3.3
15	99 SW	Smithies Beck	Inland river not influenced by normal tidal action.	Catchment Area: Aire and Calder Relationship to Ground Level: On ground surface Permanence: Watercourse contains water year round (in normal conditions) Average Width in Watercourse Section (m): 3.3
2	104 SW	Smithies Beck	Inland river not influenced by normal tidal action.	Catchment Area: Aire and Calder Relationship to Ground Level: On ground surface Permanence: Watercourse contains water year round (in normal conditions) Average Width in Watercourse Section (m): Not Provided
16	104 SW	Smithies Beck	Inland river not influenced by normal tidal action.	Catchment Area: Aire and Calder Relationship to Ground Level: On ground surface Permanence: Watercourse contains water year round (in normal conditions) Average Width in Watercourse Section (m): Not Provided
3	106 SW	Carlinghow Brook	Inland river not influenced by normal tidal action.	Catchment Area: Aire and Calder Relationship to Ground Level: On ground surface Permanence: Watercourse contains water year round (in normal conditions) Average Width in Watercourse Section (m): 3.3
17	106 SW	Carlinghow Brook	Inland river not influenced by normal tidal action.	Catchment Area: Aire and Calder Relationship to Ground Level: On ground surface Permanence: Watercourse contains water year round (in normal conditions) Average Width in Watercourse Section (m): 3.3
4	107 SW	Carlinghow Brook	Inland river not influenced by normal tidal action.	Catchment Area: Aire and Calder Relationship to Ground Level: On ground surface Permanence: Watercourse contains water year round (in normal conditions) Average Width in Watercourse Section (m): 3.0
18	107 SW	Carlinghow Brook	Inland river not influenced by normal tidal action.	Catchment Area: Aire and Calder Relationship to Ground Level: On ground surface Permanence: Watercourse contains water year round (in normal conditions)

ID	Distance/ Direction	Name	Type of Watercourse	Additional Details
				conditions) Average Width in Watercourse Section (m): 3.0
5	109 SW	Carlinghow Brook	Inland river not influenced by normal tidal action.	Catchment Area: Aire and Calder Relationship to Ground Level: Not provided Permanence: Watercourse contains water year round (in normal conditions) Average Width in Watercourse Section (m): Not Provided
19	109 SW	Carlinghow Brook	Inland river not influenced by normal tidal action.	Catchment Area: Aire and Calder Relationship to Ground Level: Not provided Permanence: Watercourse contains water year round (in normal conditions) Average Width in Watercourse Section (m): Not Provided
6	119 SW	Smithies Beck	Inland river not influenced by normal tidal action.	Catchment Area: Aire and Calder Relationship to Ground Level: On ground surface Permanence: Watercourse contains water year round (in normal conditions) Average Width in Watercourse Section (m): 3.0
20	119 SW	Smithies Beck	Inland river not influenced by normal tidal action.	Catchment Area: Aire and Calder Relationship to Ground Level: On ground surface Permanence: Watercourse contains water year round (in normal conditions) Average Width in Watercourse Section (m): 3.0
7	121 SW	-	Inland river not influenced by normal tidal action.	Catchment Area: Aire and Calder Relationship to Ground Level: Not provided Permanence: Watercourse contains water year round (in normal conditions) Average Width in Watercourse Section (m): Not Provided
8	121 S	Carlinghow Brook	Inland river not influenced by normal tidal action.	Catchment Area: Aire and Calder Relationship to Ground Level: Not provided Permanence: Watercourse contains water year round (in normal conditions) Average Width in Watercourse Section (m): Not Provided
21	121 SW	-	Inland river not influenced by normal tidal action.	Catchment Area: Aire and Calder Relationship to Ground Level: Not provided Permanence: Watercourse contains water year round (in normal conditions) Average Width in Watercourse Section (m): Not Provided
22	121 S	Carlinghow Brook	Inland river not influenced by normal tidal action.	Catchment Area: Aire and Calder Relationship to Ground Level: Not provided Permanence: Watercourse contains water year round (in normal conditions) Average Width in Watercourse Section (m): Not Provided
9	158 W	Smithies Beck	Inland river not influenced by normal tidal action.	Catchment Area: Aire and Calder Relationship to Ground Level: On ground surface Permanence: Watercourse contains water year round (in normal conditions) Average Width in Watercourse Section (m): Not Provided
23	158 W	Smithies Beck	Inland river not influenced by normal tidal action.	Catchment Area: Aire and Calder Relationship to Ground Level: On ground surface Permanence: Watercourse contains water year round (in normal conditions) Average Width in Watercourse Section (m): Not Provided
10	162 W	Smithies Beck	Inland river not influenced by normal tidal action.	Catchment Area: Aire and Calder Relationship to Ground Level: On ground surface Permanence: Watercourse contains water year round (in normal conditions) Average Width in Watercourse Section (m): 3.1
24	162 W	Smithies Beck	Inland river not influenced by normal tidal action.	Catchment Area: Aire and Calder Relationship to Ground Level: On ground surface Permanence: Watercourse contains water year round (in normal conditions) Average Width in Watercourse Section (m): 3.1

ID	Distance/ Direction	Name	Type of Watercourse	Additional Details
11	199 S	Carlinghow Brook	Inland river not influenced by normal tidal action.	Catchment Area: Aire and Calder Relationship to Ground Level: On ground surface Permanence: Watercourse contains water year round (in normal conditions) Average Width in Watercourse Section (m): 3.1
25	199 S	Carlinghow Brook	Inland river not influenced by normal tidal action.	Catchment Area: Aire and Calder Relationship to Ground Level: On ground surface Permanence: Watercourse contains water year round (in normal conditions) Average Width in Watercourse Section (m): 3.1
12	201 W	Smithies Beck	Inland river not influenced by normal tidal action.	Catchment Area: Aire and Calder Relationship to Ground Level: On ground surface Permanence: Watercourse contains water year round (in normal conditions) Average Width in Watercourse Section (m): Not Provided
26	201 W	Smithies Beck	Inland river not influenced by normal tidal action.	Catchment Area: Aire and Calder Relationship to Ground Level: On ground surface Permanence: Watercourse contains water year round (in normal conditions) Average Width in Watercourse Section (m): Not Provided
13	231 S	Carlinghow Brook	Inland river not influenced by normal tidal action.	Catchment Area: Aire and Calder Relationship to Ground Level: On ground surface Permanence: Watercourse contains water year round (in normal conditions) Average Width in Watercourse Section (m): Not Provided
14	231 NW	Smithies Beck	Inland river not influenced by normal tidal action.	Catchment Area: Aire and Calder Relationship to Ground Level: On ground surface Permanence: Watercourse contains water year round (in normal conditions) Average Width in Watercourse Section (m): 30.6
27	231 S	Carlinghow Brook	Inland river not influenced by normal tidal action.	Catchment Area: Aire and Calder Relationship to Ground Level: On ground surface Permanence: Watercourse contains water year round (in normal conditions) Average Width in Watercourse Section (m): Not Provided
28	231 NW	Smithies Beck	Inland river not influenced by normal tidal action.	Catchment Area: Aire and Calder Relationship to Ground Level: On ground surface Permanence: Watercourse contains water year round (in normal conditions) Average Width in Watercourse Section (m): 30.6
15	255 S	Carlinghow Brook	Inland river not influenced by normal tidal action.	Catchment Area: Aire and Calder Relationship to Ground Level: On ground surface Permanence: Watercourse contains water year round (in normal conditions) Average Width in Watercourse Section (m): 3.2
29	255 S	Carlinghow Brook	Inland river not influenced by normal tidal action.	Catchment Area: Aire and Calder Relationship to Ground Level: On ground surface Permanence: Watercourse contains water year round (in normal conditions) Average Width in Watercourse Section (m): 3.2
16	270 S	Carlinghow Brook	Inland river not influenced by normal tidal action.	Catchment Area: Aire and Calder Relationship to Ground Level: On ground surface Permanence: Watercourse contains water year round (in normal conditions) Average Width in Watercourse Section (m): Not Provided
30	270 S	Carlinghow Brook	Inland river not influenced by normal tidal action.	Catchment Area: Aire and Calder Relationship to Ground Level: On ground surface Permanence: Watercourse contains water year round (in normal conditions) Average Width in Watercourse Section (m): Not Provided
17	279	Carlinghow Brook	Inland river not influenced by normal tidal action.	Catchment Area: Aire and Calder Relationship to Ground Level: On ground surface

ID	Distance/ Direction	Name	Type of Watercourse	Additional Details
	S			Permanence: Watercourse contains water year round (in normal conditions) Average Width in Watercourse Section (m): 2.7
18	279 NW	Smithies Beck	Lake, loch or reservoir.	Catchment Area: Aire and Calder Relationship to Ground Level: On ground surface Permanence: Watercourse contains water year round (in normal conditions) Average Width in Watercourse Section (m): 41.3
Not shown	279 S	Carlinghow Brook	Inland river not influenced by normal tidal action.	Catchment Area: Aire and Calder Relationship to Ground Level: On ground surface Permanence: Watercourse contains water year round (in normal conditions) Average Width in Watercourse Section (m): 2.7
32	279 NW	Smithies Beck	Lake, loch or reservoir.	Catchment Area: Aire and Calder Relationship to Ground Level: On ground surface Permanence: Watercourse contains water year round (in normal conditions) Average Width in Watercourse Section (m): 41.3
19	293 S	Carlinghow Brook	Inland river not influenced by normal tidal action.	Catchment Area: Aire and Calder Relationship to Ground Level: On ground surface Permanence: Watercourse contains water year round (in normal conditions) Average Width in Watercourse Section (m): Not Provided
Not shown	293 S	Carlinghow Brook	Inland river not influenced by normal tidal action.	Catchment Area: Aire and Calder Relationship to Ground Level: On ground surface Permanence: Watercourse contains water year round (in normal conditions) Average Width in Watercourse Section (m): Not Provided
20	295 SW	-	Inland river not influenced by normal tidal action.	Catchment Area: Aire and Calder Relationship to Ground Level: On ground surface Permanence: Watercourse contains water year round (in normal conditions) Average Width in Watercourse Section (m): Not Provided
34	295 SW	-	Inland river not influenced by normal tidal action.	Catchment Area: Aire and Calder Relationship to Ground Level: On ground surface Permanence: Watercourse contains water year round (in normal conditions) Average Width in Watercourse Section (m): Not Provided
21	311 SE	Carlinghow Brook	Inland river not influenced by normal tidal action.	Catchment Area: Aire and Calder Relationship to Ground Level: On ground surface Permanence: Watercourse contains water year round (in normal conditions) Average Width in Watercourse Section (m): 4.0
Not shown	311 SE	Carlinghow Brook	Inland river not influenced by normal tidal action.	Catchment Area: Aire and Calder Relationship to Ground Level: On ground surface Permanence: Watercourse contains water year round (in normal conditions) Average Width in Watercourse Section (m): 4.0
22	336 SE	Carlinghow Brook	Inland river not influenced by normal tidal action.	Catchment Area: Aire and Calder Relationship to Ground Level: On ground surface Permanence: Watercourse contains water year round (in normal conditions) Average Width in Watercourse Section (m): Not Provided
Not shown	336 SE	Carlinghow Brook	Inland river not influenced by normal tidal action.	Catchment Area: Aire and Calder Relationship to Ground Level: On ground surface Permanence: Watercourse contains water year round (in normal conditions) Average Width in Watercourse Section (m): Not Provided
23	337 SE	Carlinghow Brook	Inland river not influenced by normal tidal action.	Catchment Area: Aire and Calder Relationship to Ground Level: On ground surface Permanence: Watercourse contains water year round (in normal conditions)

ID	Distance/ Direction	Name	Type of Watercourse	Additional Details
				Average Width in Watercourse Section (m): 3.0
Not shown	337 SE	Carlinghow Brook	Inland river not influenced by normal tidal action.	Catchment Area: Aire and Calder Relationship to Ground Level: On ground surface Permanence: Watercourse contains water year round (in normal conditions) Average Width in Watercourse Section (m): 3.0
24	344 SW	-	Inland river not influenced by normal tidal action.	Catchment Area: Aire and Calder Relationship to Ground Level: Not provided Permanence: Watercourse contains water year round (in normal conditions) Average Width in Watercourse Section (m): Not Provided
25	344 SE	Carlinghow Brook	Inland river not influenced by normal tidal action.	Catchment Area: Aire and Calder Relationship to Ground Level: On ground surface Permanence: Watercourse contains water year round (in normal conditions) Average Width in Watercourse Section (m): Not Provided
38	344 SW	-	Inland river not influenced by normal tidal action.	Catchment Area: Aire and Calder Relationship to Ground Level: Not provided Permanence: Watercourse contains water year round (in normal conditions) Average Width in Watercourse Section (m): Not Provided
Not shown	344 SE	Carlinghow Brook	Inland river not influenced by normal tidal action.	Catchment Area: Aire and Calder Relationship to Ground Level: On ground surface Permanence: Watercourse contains water year round (in normal conditions) Average Width in Watercourse Section (m): Not Provided
26	350 SE	Carlinghow Brook	Inland river not influenced by normal tidal action.	Catchment Area: Aire and Calder Relationship to Ground Level: On ground surface Permanence: Watercourse contains water year round (in normal conditions) Average Width in Watercourse Section (m): 2.5
Not shown	350 SE	Carlinghow Brook	Inland river not influenced by normal tidal action.	Catchment Area: Aire and Calder Relationship to Ground Level: On ground surface Permanence: Watercourse contains water year round (in normal conditions) Average Width in Watercourse Section (m): 2.5
27	354 SE	Carlinghow Brook	Inland river not influenced by normal tidal action.	Catchment Area: Aire and Calder Relationship to Ground Level: On ground surface Permanence: Watercourse contains water year round (in normal conditions) Average Width in Watercourse Section (m): Not Provided
Not shown	354 SE	Carlinghow Brook	Inland river not influenced by normal tidal action.	Catchment Area: Aire and Calder Relationship to Ground Level: On ground surface Permanence: Watercourse contains water year round (in normal conditions) Average Width in Watercourse Section (m): Not Provided
28	358 SE	Carlinghow Brook	Inland river not influenced by normal tidal action.	Catchment Area: Aire and Calder Relationship to Ground Level: On ground surface Permanence: Watercourse contains water year round (in normal conditions) Average Width in Watercourse Section (m): 3.4
Not shown	358 SE	Carlinghow Brook	Inland river not influenced by normal tidal action.	Catchment Area: Aire and Calder Relationship to Ground Level: On ground surface Permanence: Watercourse contains water year round (in normal conditions) Average Width in Watercourse Section (m): 3.4
29	371 SE	Carlinghow Brook	Inland river not influenced by normal tidal action.	Catchment Area: Aire and Calder Relationship to Ground Level: On ground surface Permanence: Watercourse contains water year round (in normal conditions) Average Width in Watercourse Section (m): Not Provided

ID	Distance/ Direction	Name	Type of Watercourse	Additional Details
Not shown	371 SE	Carlinghow Brook	Inland river not influenced by normal tidal action.	Catchment Area: Aire and Calder Relationship to Ground Level: On ground surface Permanence: Watercourse contains water year round (in normal conditions) Average Width in Watercourse Section (m): Not Provided
30	387 NW	Smithies Beck	Inland river not influenced by normal tidal action.	Catchment Area: Aire and Calder Relationship to Ground Level: On ground surface Permanence: Watercourse contains water year round (in normal conditions) Average Width in Watercourse Section (m): Not Provided
31	387 NW	-	Inland river not influenced by normal tidal action.	Catchment Area: Aire and Calder Relationship to Ground Level: Not provided Permanence: Watercourse contains water year round (in normal conditions) Average Width in Watercourse Section (m): Not Provided
44	387 NW	Smithies Beck	Inland river not influenced by normal tidal action.	Catchment Area: Aire and Calder Relationship to Ground Level: On ground surface Permanence: Watercourse contains water year round (in normal conditions) Average Width in Watercourse Section (m): Not Provided
45	387 NW	-	Inland river not influenced by normal tidal action.	Catchment Area: Aire and Calder Relationship to Ground Level: Not provided Permanence: Watercourse contains water year round (in normal conditions) Average Width in Watercourse Section (m): Not Provided
32	414 SE	Carlinghow Brook	Inland river not influenced by normal tidal action.	Catchment Area: Aire and Calder Relationship to Ground Level: On ground surface Permanence: Watercourse contains water year round (in normal conditions) Average Width in Watercourse Section (m): Not Provided
Not shown	414 SE	Carlinghow Brook	Inland river not influenced by normal tidal action.	Catchment Area: Aire and Calder Relationship to Ground Level: On ground surface Permanence: Watercourse contains water year round (in normal conditions) Average Width in Watercourse Section (m): Not Provided
33	451 SE	Carlinghow Brook	Inland river not influenced by normal tidal action.	Catchment Area: Aire and Calder Relationship to Ground Level: On ground surface Permanence: Watercourse contains water year round (in normal conditions) Average Width in Watercourse Section (m): 3.3
Not shown	451 SE	Carlinghow Brook	Inland river not influenced by normal tidal action.	Catchment Area: Aire and Calder Relationship to Ground Level: On ground surface Permanence: Watercourse contains water year round (in normal conditions) Average Width in Watercourse Section (m): 3.3
34	456 NW	-	Inland river not influenced by normal tidal action.	Catchment Area: Aire and Calder Relationship to Ground Level: On ground surface Permanence: Watercourse contains water year round (in normal conditions) Average Width in Watercourse Section (m): Not Provided
Not shown	456 NW	-	Inland river not influenced by normal tidal action.	Catchment Area: Aire and Calder Relationship to Ground Level: On ground surface Permanence: Watercourse contains water year round (in normal conditions) Average Width in Watercourse Section (m): Not Provided
35	478 SE	Carlinghow Brook	Inland river not influenced by normal tidal action.	Catchment Area: Aire and Calder Relationship to Ground Level: Not provided Permanence: Watercourse contains water year round (in normal conditions) Average Width in Watercourse Section (m): Not Provided
Not shown	478	Carlinghow Brook	Inland river not influenced by normal tidal action.	Catchment Area: Aire and Calder Relationship to Ground Level: Not provided

ID	Distance/ Direction	Name	Type of Watercourse	Additional Details
	SE			Permanence: Watercourse contains water year round (in normal conditions) Average Width in Watercourse Section (m): Not Provided

6.11 Surface Water Features

Surface water features within 250m of the study site

Identified

The following surface water records are not represented on mapping:

Distance (m)	Direction
97	SW
104	SW
105	SW
107	SW
117	SW
161	W
198	S
230	NW

7a. Environment Agency/Natural Resources Wales Flood Map for Planning (from rivers and the sea)

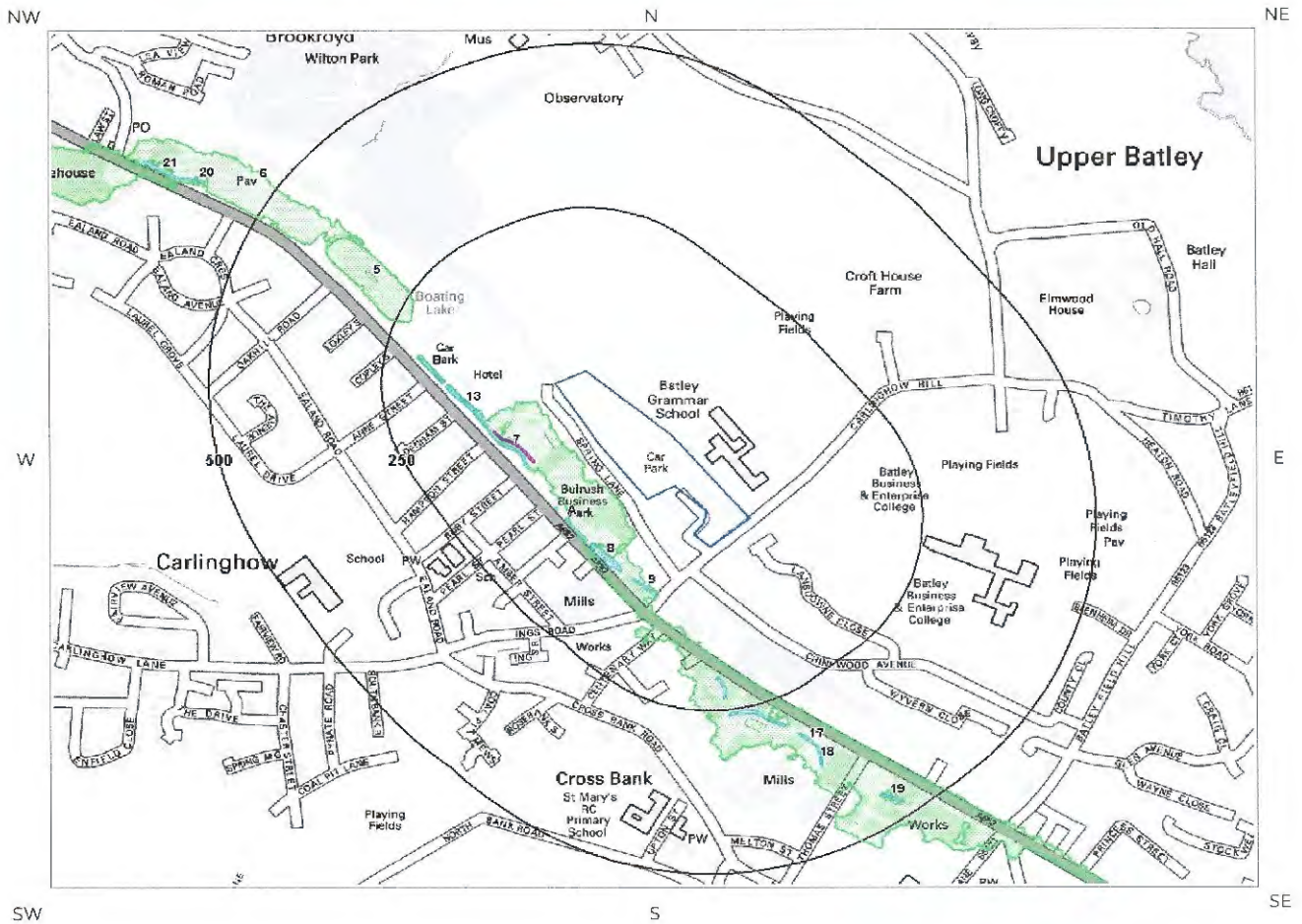

© Crown copyright and database rights 2019.
Ordnance Survey licence 100035207.

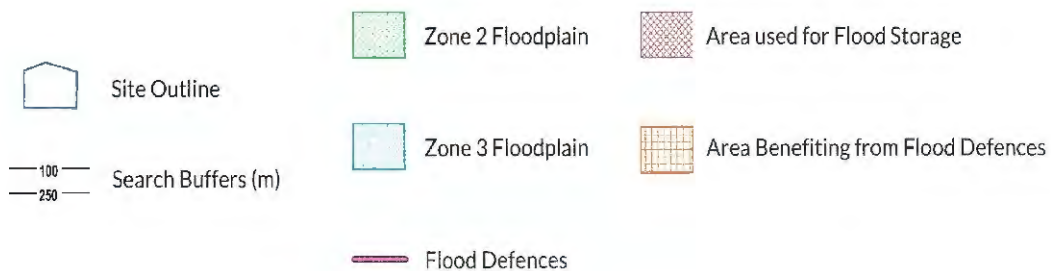

7b. Environment Agency/Natural Resources Wales Risk of Flooding from Rivers and the Sea (RoFRaS) Map

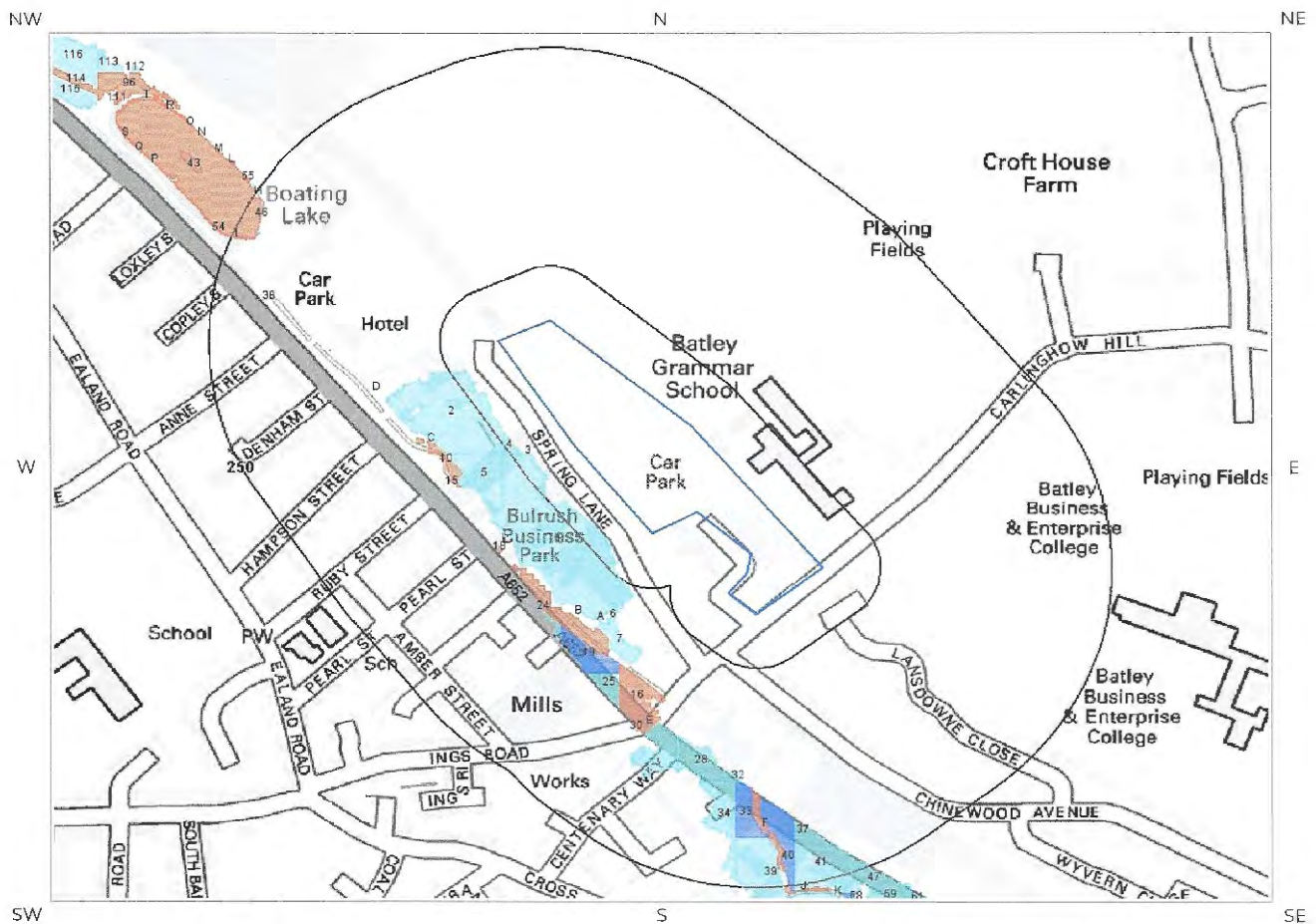

© Crown copyright and database rights 2019.
Ordnance Survey licence 100035207.

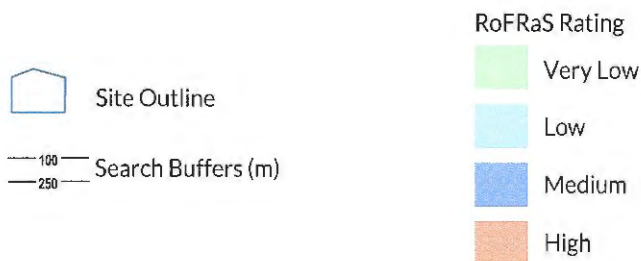

7 Flooding

7.1 River and Coastal Zone 2 Flooding

Environment Agency/Natural Resources Wales Zone 2 floodplain within 250m Identified

Environment Agency/Natural Resources Wales Zone 2 floodplains estimate the annual probability of flooding as between 1 in 1000 (0.1%) and 1 in 100 (1%) from rivers and between 1 in 1000 (0.1%) and 1 in 200 (0.5%) from the sea. Any relevant data is represented on Map 7a – Flood Map for Planning:

ID	Distance (m)	Direction	Update	Type
1	33	SW	21-Feb-2019	Zone 2 - (Fluvial /Tidal Models)
2A	109	SW	21-Feb-2019	Zone 2 - (Fluvial /Tidal Models)
3A	109	SW	21-Feb-2019	Zone 2 - (Fluvial /Tidal Models)
4B	160	W	21-Feb-2019	Zone 2 - (Fluvial /Tidal Models)
5	229	NW	21-Feb-2019	Zone 2 - (Fluvial /Tidal Models)

7.2 River and Coastal Zone 3 Flooding

Environment Agency/Natural Resources Wales Zone 3 floodplain within 250m Identified

Zone 3 shows the extent of a river flood with a 1 in 100 (1%) or greater chance of occurring in any year or a sea flood with a 1 in 200 (0.5%) or greater chance of occurring in any year. Any relevant data is represented on Map 7a – Flood Map for Planning.

ID	Distance (m)	Direction	Update	Type
1	97	SW	21-Feb-2019	Zone 3 - (Fluvial /Tidal Models)
2A	102	SW	21-Feb-2019	Zone 3 - (Fluvial /Tidal Models)
3A	104	SW	21-Feb-2019	Zone 3 - (Fluvial /Tidal Models)
4B	107	SW	21-Feb-2019	Zone 3 - (Fluvial /Tidal Models)
5	109	SW	21-Feb-2019	Zone 3 - (Fluvial /Tidal Models)
	109	SW	21-Feb-2019	Zone 3 - (Fluvial /Tidal Models)
	113	SW	21-Feb-2019	Zone 3 - (Fluvial /Tidal Models)
	161	W	21-Feb-2019	Zone 3 - (Fluvial /Tidal Models)

7.3 Risk of Flooding from Rivers and the Sea (RoFRaS) Flood Rating

Highest risk of flooding onsite

Very Low

The Environment Agency/Natural Resources Wales RoFRaS database provides an indication of river and coastal flood risk at a national level on a 50m grid with the flood rating at the centre of the grid calculated and given above. The data considers the probability that the flood defences will overtop or breach by considering their location, type, condition and standard of protection.

RoFRaS data for the study site indicates the property is in an area with a Very Low (less than 1 in 1000) chance of flooding in any given year.

Any relevant data within 250m is represented on the RoFRaS Flood map. Data to 50m is reported in the table below.

ID	Distance (m)	Direction	RoFRaS flood Risk
1	33.0	SW	Low
2	36.0	SW	Low
3	36.0	SW	Low
4	41.0	SW	Low

7.4 Flood Defences

Flood Defences within 250m of the study site

Identified

The following flood defence records are represented as lines on the Flood Map:

ID	Distance (m)	Direction	Update
22	93	SW	21-Feb-2019

7.5 Areas benefiting from Flood Defences

Areas benefiting from Flood Defences within 250m of the study site

None identified

7.6 Areas benefiting from Flood Storage

Areas used for Flood Storage within 250m of the study site

None identified

7.7 Groundwater Flooding Susceptibility Areas

7.7.1 British Geological Survey groundwater flooding susceptibility areas within 50m of the boundary of the study site Identified

Clearwater Flooding or Superficial Deposits Flooding Clearwater Flooding

Notes: Groundwater flooding may either be associated with shallow unconsolidated sedimentary aquifers which overlie unproductive aquifers (Superficial Deposits Flooding), or with unconfined aquifers (Clearwater Flooding).

7.7.2 Highest susceptibility to groundwater flooding in the search area based on the underlying geological conditions

Potential at Surface

Where potential for groundwater flooding to occur at surface is indicated, this means that given the geological conditions in the area groundwater flooding hazard should be considered in all land-use planning decisions. It is recommended that other relevant information e.g. records of previous incidence of groundwater flooding, rainfall, property type, and land drainage information be investigated in order to establish relative, but not absolute, risk of groundwater flooding.

7.8 Groundwater Flooding Confidence Areas

British Geological Survey confidence rating in this result Low

Notes: Groundwater flooding is defined as the emergence of groundwater at the ground surface or the rising of groundwater into man-made ground under conditions where the normal range of groundwater levels is exceeded.

The confidence rating is on a threefold scale - Low, Moderate and High. This provides a relative indication of the BGS confidence in the accuracy of the susceptibility result for groundwater flooding. This is based on the amount and precision of the information used in the assessment. In areas with a relatively lower level of confidence the susceptibility result should be treated with more caution. In other areas with higher levels of confidence the susceptibility result can be used with more confidence.

8. Designated Environmentally Sensitive Sites Map

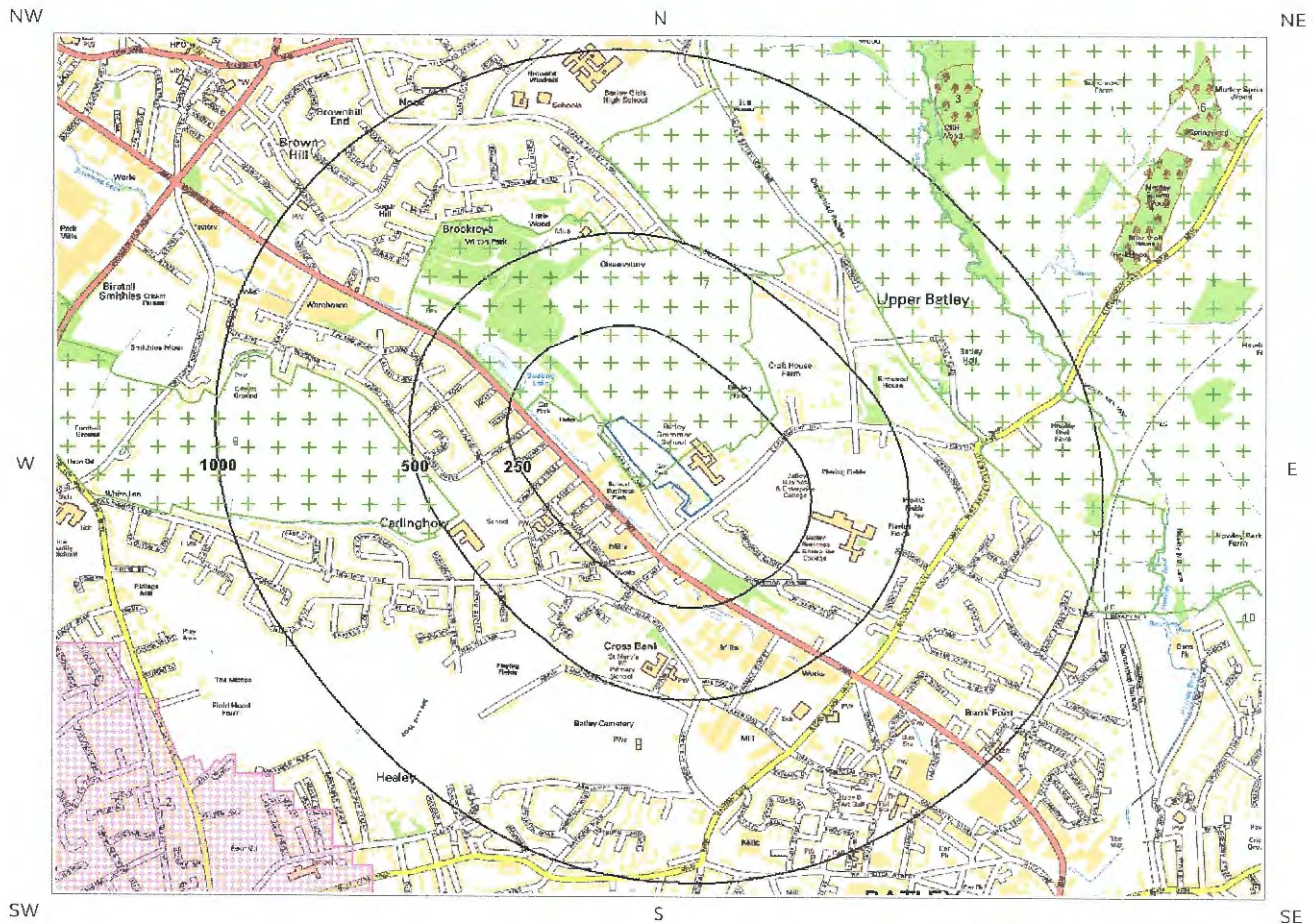

© Crown copyright and database rights 2019.
Ordnance Survey licence 100035207.



8. Designated Environmentally Sensitive Sites

Designated Environmentally Sensitive Sites within 2000m of the study site

Identified

8.1 Records of Sites of Special Scientific Interest (SSSI) within 2000m of the study site:

0

Database searched and no data found.

8.2 Records of National Nature Reserves (NNR) within 2000m of the study site:

0

Database searched and no data found.

8.3 Records of Special Areas of Conservation (SAC) within 2000m of the study site:

0

Database searched and no data found.

8.4 Records of Special Protection Areas (SPA) within 2000m of the study site:

0

Database searched and no data found.

8.5 Records of Ramsar sites within 2000m of the study site:

0

Database searched and no data found.

8.6 Records of Ancient Woodland within 2000m of the study site:

4

The following records of Designated Ancient Woodland provided by Natural England/Natural Resources Wales are represented as polygons on the Designated Environmentally Sensitive Sites Map:

ID	Distance (m)	Direction	Ancient Woodland Name	Data Source
3	1108	NE	UNKNOWN	Ancient and Semi-Natural Woodland
4	1221	NE	MORLEY SPRING WOOD	Ancient Replanted Woodland
5	1302	NE	BIRKBY BROW WOOD	Ancient Replanted Woodland
6	1551	NE	MORLEY SPRING WOOD	Ancient Replanted Woodland

8.7 Records of Local Nature Reserves (LNR) within 2000m of the study site:

1

The following Local Nature Reserve (LNR) records provided by Natural England/Natural Resources Wales are represented as polygons on the Designated Environmentally Sensitive Sites Map:

ID	Distance (m)	Direction	LNR Name	Data Source
Not shown	1987	NW	Oakwell Park	Natural England

8.8 Records of World Heritage Sites within 2000m of the study site:

0

Database searched and no data found.

8.9 Records of Environmentally Sensitive Areas within 2000m of the study site:

0

Database searched and no data found.

8.10 Records of Areas of Outstanding Natural Beauty (AONB) within 2000m of the study site:

0

Database searched and no data found.

8.11 Records of National Parks (NP) within 2000m of the study site:

0

Database searched and no data found.

8.12 Records of Nitrate Sensitive Areas within 2000m of the study site:

0

Database searched and no data found.

8.13 Records of Nitrate Vulnerable Zones within 2000m of the study site:

1

The following Nitrate Vulnerable Zone records produced by DEFRA are represented as polygons on the Designated Environmentally Sensitive Sites Map:

ID	Distance (m)	Direction	NVZ Name	Data Source
2	1207	SW	Existing	DEFRA

8.14 Records of Green Belt land within 2000m of the study site:

4

Green Belt data contains Ordnance Survey data © Crown copyright and database right [2015].

ID	Distance	Direction	Green Belt Name	Local Authority Name
7	0	On Site	Liverpool, Manchester and West Yorks Greenbelt	Kirklees District (B)
8	446	SW	Liverpool, Manchester and West Yorks Greenbelt	Kirklees District (B)
9	905	NE	Liverpool, Manchester and West Yorks Greenbelt	Leeds
10	1320	E	Liverpool, Manchester and West Yorks Greenbelt	Kirklees District (B)

9. Natural Hazards Findings

9.1 Detailed BGS GeoSure Data

BGS GeoSure Data has been searched to 50m. The data is included in tabular format. If you require further information on geology and ground stability, please obtain a Groundsure Geo Insight, available from our website. The following information has been found:

9.1.1 Shrink Swell

Maximum Shrink-Swell** hazard rating identified on the study site Very Low

The following natural subsidence information provided by the British Geological Survey is not represented on mapping:

Hazard
Ground conditions predominantly low plasticity. No special actions required to avoid problems due to shrink-swell clays. No special ground investigation required, and increased construction costs or increased financial risks are unlikely due to potential problems with shrink-swell clays.

9.1.2 Landslides

Maximum Landslide* hazard rating identified on the study site Low

The following natural subsidence information provided by the British Geological Survey is not represented on mapping:

Hazard
Possibility of slope instability problems after major changes in ground conditions. Consideration should be given to stability if changes to drainage or excavations take place. Possible increase in construction cost to reduce potential slope stability problems. Existing property no significant increase in insurance risk due to natural slope instability problems.

9.1.3 Soluble Rocks

Maximum Soluble Rocks* hazard rating identified on the study site Negligible

The following natural subsidence information provided by the British Geological Survey is not represented on mapping:

Hazard
Soluble rocks are present, but unlikely to cause problems except under exceptional conditions. No special actions required to avoid problems due to soluble rocks. No special ground investigation required, and increased construction costs or increased financial risks are unlikely due to potential problems with soluble rocks.

* This indicates an automatically generated 50m buffer and site.

9.1.4 Compressible Ground

Maximum Compressible Ground* hazard rating identified on the study site

Very Low

The following natural subsidence information provided by the British Geological Survey is not represented on mapping:

Hazard

Very low potential for compressible deposits to be present. No special actions required to avoid problems due to compressible deposits. No special ground investigation required, and increased construction costs or increased financial risks are unlikely due to potential problems with compressible deposits.

9.1.5 Collapsible Rocks

Maximum Collapsible Rocks* hazard rating identified on the study site

Very Low

The following natural subsidence information provided by the British Geological Survey is not represented on mapping:

Hazard

Deposits with potential to collapse when loaded and saturated are unlikely to be present. No special ground investigation required or increased construction costs or increased financial risk due to potential problems with collapsible deposits.

9.1.6 Running Sand

Maximum Running Sand** hazard rating identified on the study site

Very Low

The following natural subsidence information provided by the British Geological Survey is not represented on mapping:

Hazard

Very low potential for running sand problems if water table rises or if sandy strata are exposed to water. No special actions required, to avoid problems due to running sand. No special ground investigation required, and increased construction costs or increased financial risks are unlikely due to potential problems with running sand.

* This indicates an automatically generated 50m buffer and site.

9.2 Radon

9.2.1 Radon Affected Areas

Is the property in a Radon Affected Area as defined by the Health Protection Agency (HPA) and if so what percentage of homes are above the Action Level? The site is not in a Radon Affected Area, as less than 1% of properties are above the Action Level.

The radon data in this report is supplied by the BGS/Public Health England and is the definitive map of Radon Affected Areas in Great Britain and Northern Ireland. The dataset was created using long-term radon measurements in over 479,000 homes across Great Britain and 23,000 homes across Northern Ireland, combined with geological data. The dataset is considered accurate to 50m to allow for the margin of error in geological lines, and the findings of this report supercede any answer given in the less accurate Indicative Atlas of Radon in Great Britain, which simplifies the data to give the highest risk within any given 1km grid square. As such, the radon atlas is considered indicative, whereas the data given in this report is considered definitive.

9.2.2 Radon Protection

Is the property in an area where Radon Protection are required for new properties or extensions to existing ones as described in publication BR211 by the Building Research Establishment? No radon protective measures are necessary.

10. Mining

10.1 Coal Mining

Coal mining areas within 75m of the study site

Identified

The following coal mining information provided by the Coal Authority is not represented on Mapping:

Distance (m)	Direction	Details
0	On Site	The study site is located within the specified search distance of an identified mining area. Further details concerning this can be obtained from the Coal Authority Helpline on 0845 762 6848.

10.2 Non-Coal Mining

Non-Coal Mining areas within 50m of the study site boundary

None identified

Database searched and no data found.

10.3 Brine Affected Areas

Brine affected areas within 75m of the study site
Guidance: No Guidance Required.

None identified

Site Details:

STREET RECORD, ACCESS
 REAR OF 1-3 AND NURSING
 HOME ON TRANSVAAL
 TERRACE, BATLEY, WF17 0AA

Client Ref: C316
 Report Ref: GS-5915063
 Grid Ref: 423686, 425138

Map Name: County Series

Map date: 1854

Scale: 1:10,560

Printed at: 1:10,560



Surveyed 1847
 Revised N/A
 Edition 1854
 Copyright N/A
 Levelled N/A



Produced by
 Groundsure Insights
 T: 06444 159000
 E: info@groundsure.com
 W: www.groundsure.com

© Crown copyright and database rights 2018 Ordnance Survey 100035207

Production date: 01 April 2019

Map legend available at:
www.groundsure.com/sites/default/files/groundsure_legend.pdf

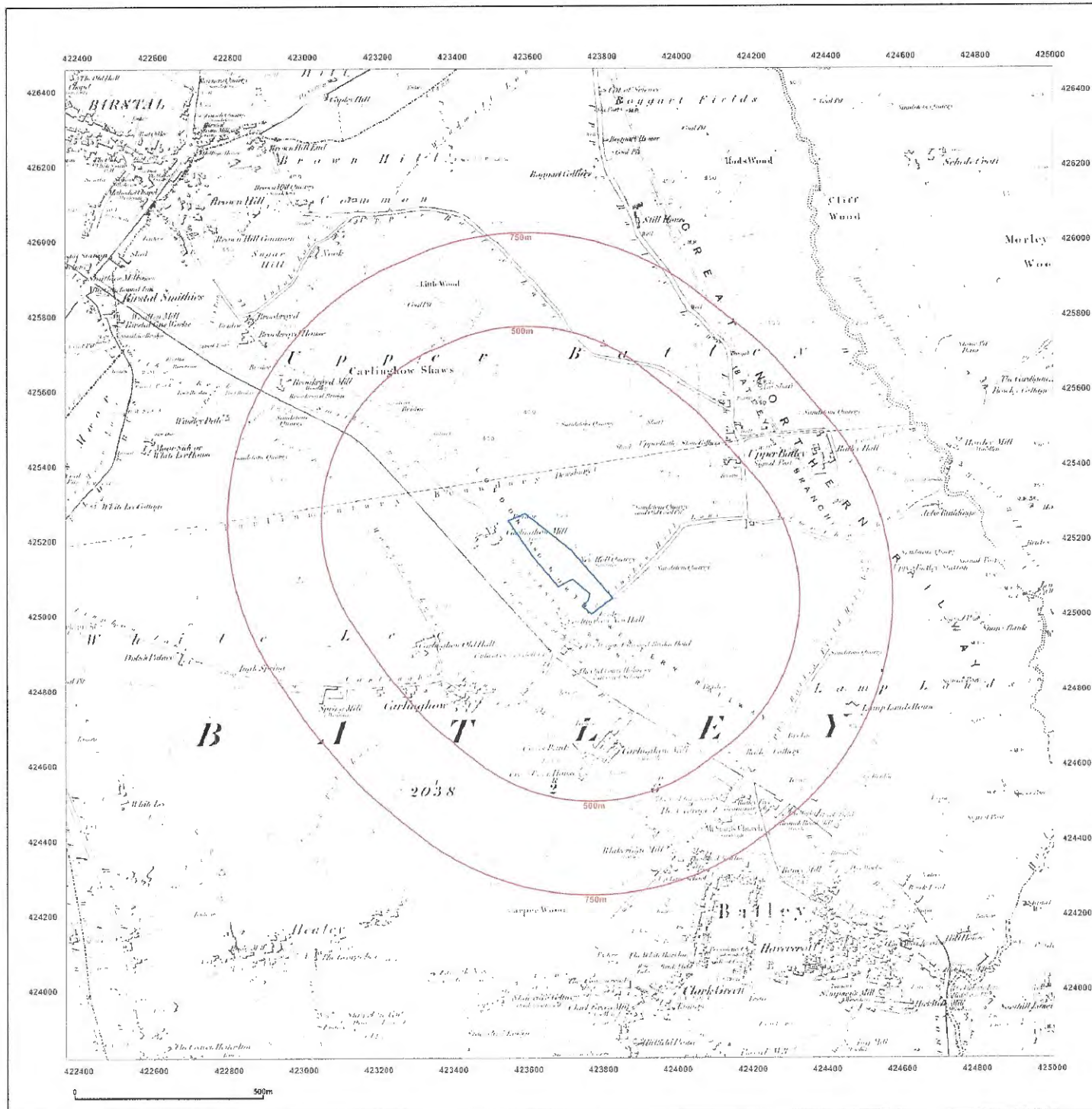

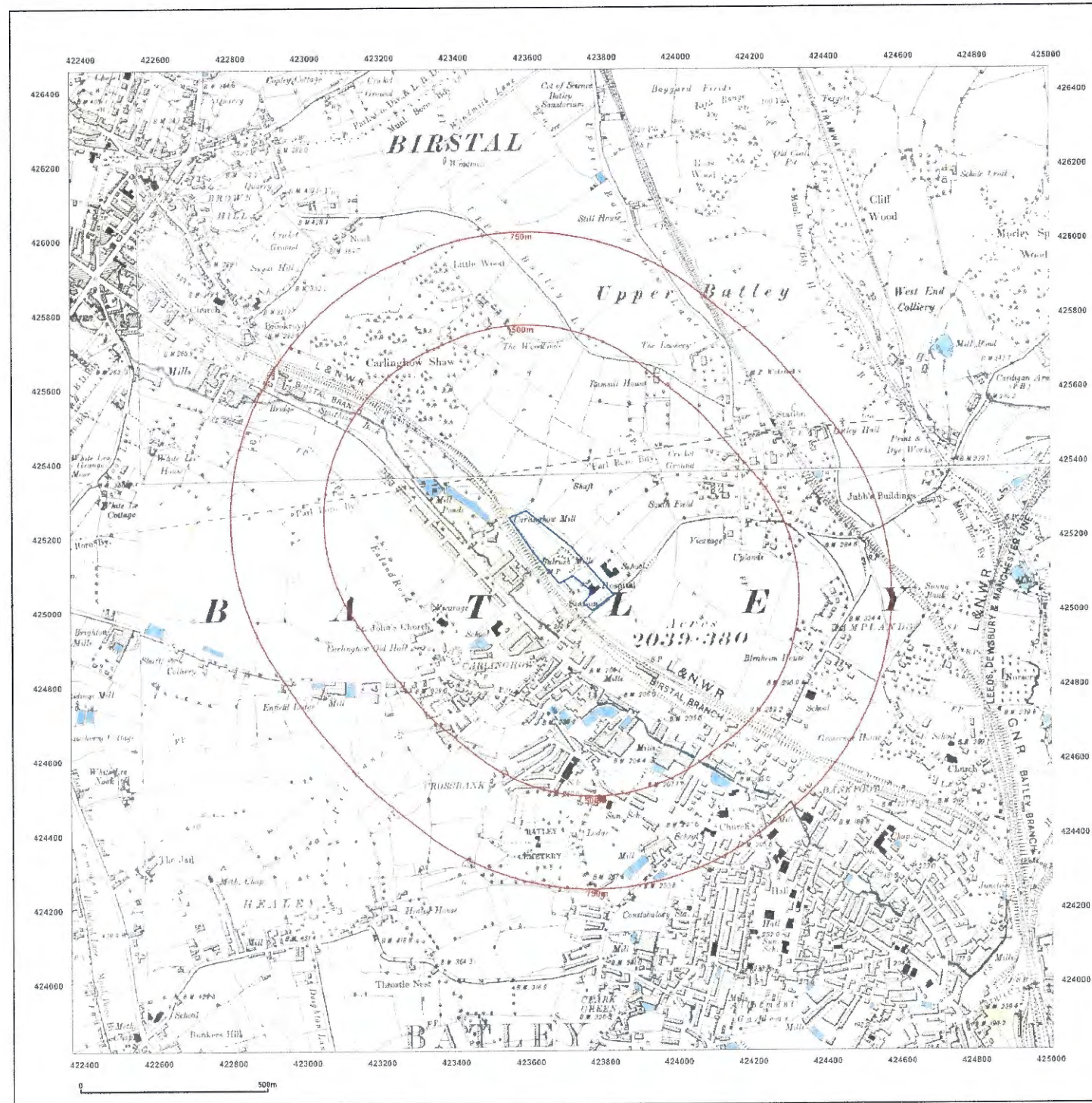

Site Details:
 STREET RECORD, ACCESS
 REAR OF 1-3 AND NURSING
 HOME ON TRANSVAAL
 TERRACE, BATLEY, WF17 0AA

Client Ref: C316
Report Ref: GS-5915063
Grid Ref: 423686, 425138

Map Name: County Series
Map date: 1892
Scale: 1:10,560
Printed at: 1:10,560



Surveyed 1892 Revised 1892 Edition N/A Copyright N/A Levelled N/A	Surveyed 1892 Revised 1892 Edition N/A Copyright N/A Levelled N/A
---	---



Produced by
 Groundsure Insights
 T: 08444 159000
 E: info@groundsure.com
 W: www.groundsure.com

© Crown copyright and database rights 2018 Ordnance Survey 100035207

Production date: 01 April 2019

Map legend available at:
www.groundsure.com/sites/default/files/groundsure_legend.pdf

Site Details:

STREET RECORD, ACCESS
 REAR OF 1-3 AND NURSING
 HOME ON TRANVAAL
 TERRACE, BATLEY, WF17 0AA

Client Ref: C316
 Report Ref: GS-5915063
 Grid Ref: 423686, 425138

Map Name: County Series

Map date: 1894

Scale: 1:2,500

Printed at: 1:2,500



Surveyed 1894
 Revised 1894
 Edition N/A
 Copyright N/A
 Levelled N/A

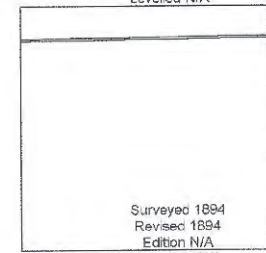

Surveyed 1894
 Revised 1894
 Edition N/A
 Copyright N/A
 Levelled N/A



Produced by
 Groundsure Insights
 T: 08444 159000
 E: info@groundsure.com
 W: www.groundsure.com

© Crown copyright and database rights 2018 Ordnance Survey 100035207

Production date: 01 April 2019

Map legend available at:
www.groundsure.com/sites/default/files/groundsure_legend.pdf

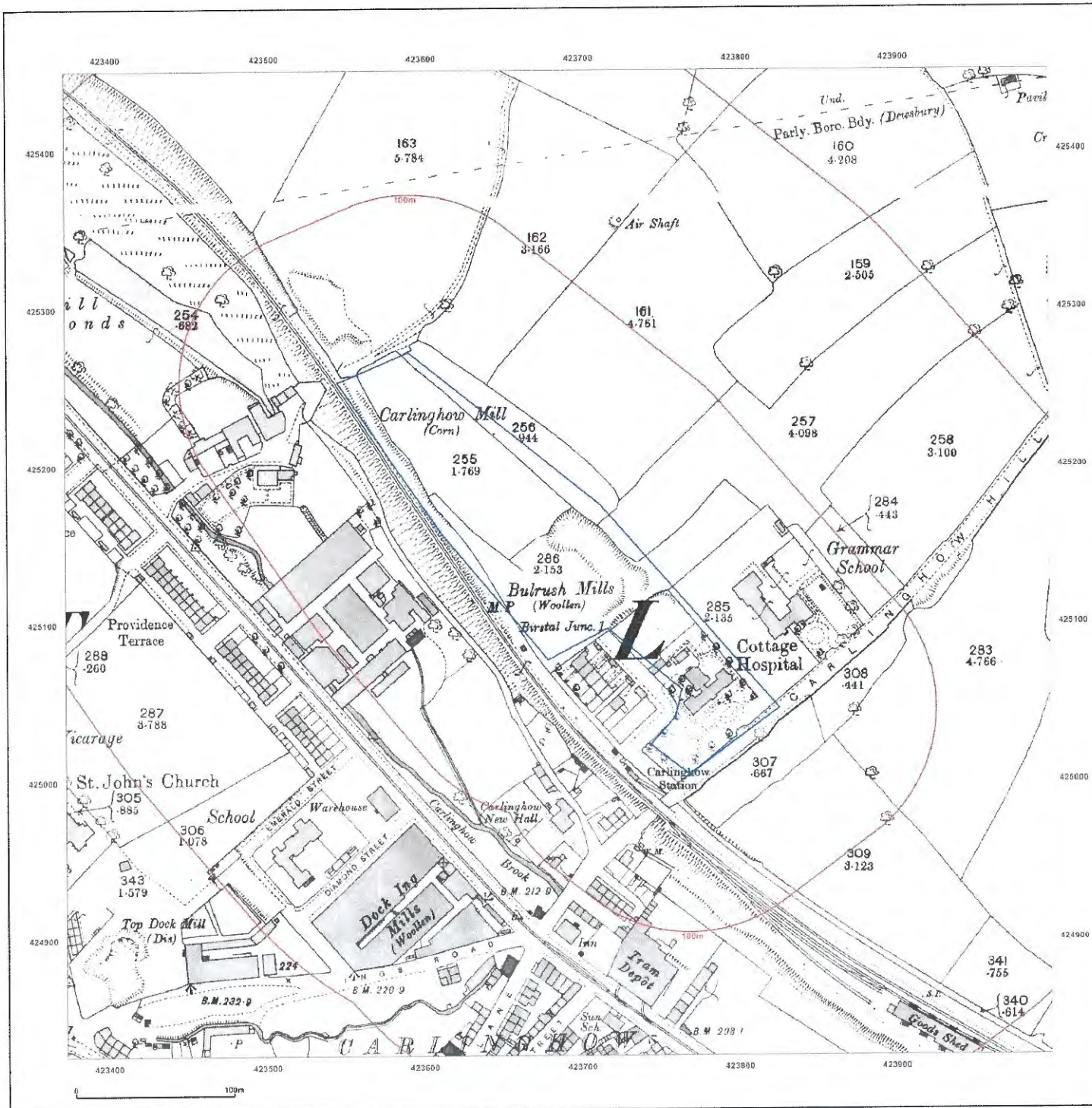

Site Details:

STREET RECORD, ACCESS
 REAR OF 1-3 AND NURSING
 HOME ON TRANSVAAL
 TERRACE, BATLEY, WF17 0AA

Client Ref: C316
Report Ref: GS-5915063
Grid Ref: 423686, 425138

Map Name: County Series

Map date: 1905-1906

Scale: 1:10,560

Printed at: 1:10,560

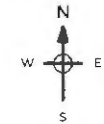

Surveyed 1889
 Revised 1905
 Edition N/A
 Copyright N/A
 Levelled N/A

Surveyed 1889
 Revised 1906
 Edition 1906
 Copyright N/A
 Levelled N/A

Surveyed 1889
 Revised 1905
 Edition N/A
 Copyright N/A
 Levelled N/A

Surveyed 1889
 Revised 1905
 Edition N/A
 Copyright N/A
 Levelled N/A



Produced by
 Groundsure Insights
 T: 08444 159000
 E: info@groundsure.com
 W: www.groundsure.com

© Crown copyright and database rights 2018 Ordnance Survey 100035207

Production date: 01 April 2019

Map legend available at:
www.groundsure.com/sites/default/files/groundsure_legend.pdf

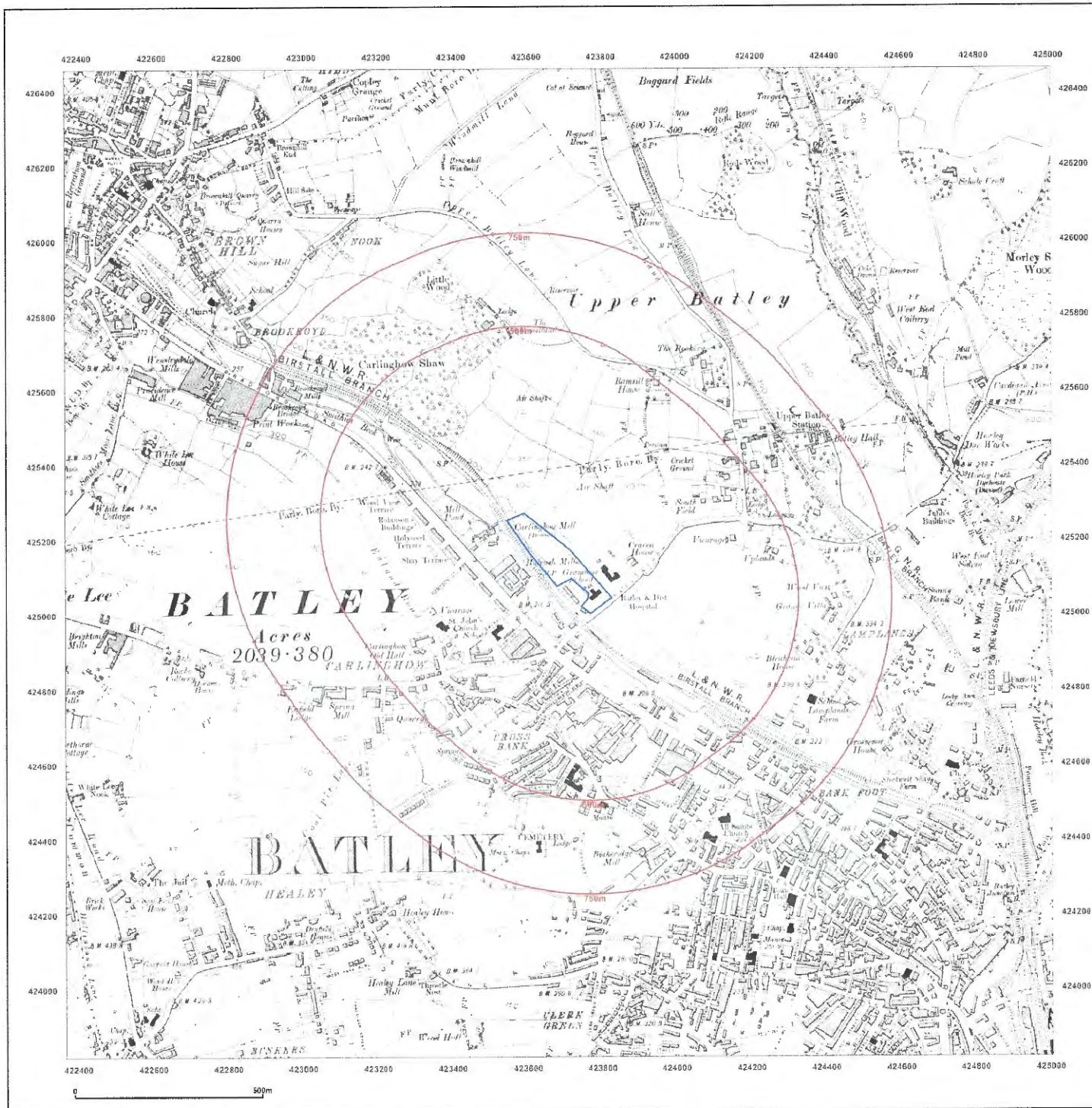

Site Details:

STREET RECORD, ACCESS
 REAR OF 1-3 AND NURSING
 HOME ON TRANSVAAL
 TERRACE, BATLEY, WF17 0AA

Client Ref: C316
 Report Ref: GS-5915063
 Grid Ref: 423686, 425138

Map Name: County Series

Map date: 1907-1908

Scale: 1:2,500

Printed at: 1:2,500



Surveyed 1908
 Revised 1908
 Edition N/A
 Copyright N/A
 Levelled N/A

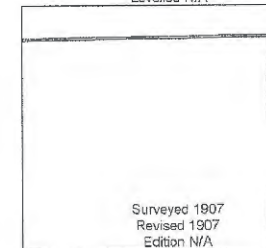

Surveyed 1907
 Revised 1907
 Edition N/A
 Copyright N/A
 Levelled N/A



Produced by
 Groundsure Insights
 T: 08444 159000
 E: info@groundsure.com
 W: www.groundsure.com

© Crown copyright and database rights 2018 Ordnance Survey 100035207

Production date: 01 April 2019

Map legend available at:
www.groundsure.com/sites/default/files/groundsure_legend.pdf



Site Details:

STREET RECORD, ACCESS
 REAR OF 1-3 AND NURSING
 HOME ON TRANSVAAL
 TERRACE, BATLEY, WF17 0AA

Client Ref: C316
 Report Ref: GS-5915063
 Grid Ref: 423686, 425138

Map Name: County Series

Map date: 1922

Scale: 1:2,500

Printed at: 1:2,500



Surveyed 1922
 Revised 1922
 Edition N/A
 Copyright N/A
 Levelled N/A

Surveyed 1922
 Revised 1922
 Edition N/A
 Copyright N/A
 Levelled N/A



Produced by
 Groundsure Insights
 T: 08444 159000
 E: info@groundsure.com
 W: www.groundsure.com

© Crown copyright and database rights 2018 Ordnance Survey 100035207

Production date: 01 April 2019

Map legend available at:
www.groundsure.com/sites/default/files/groundsure_legend.pdf

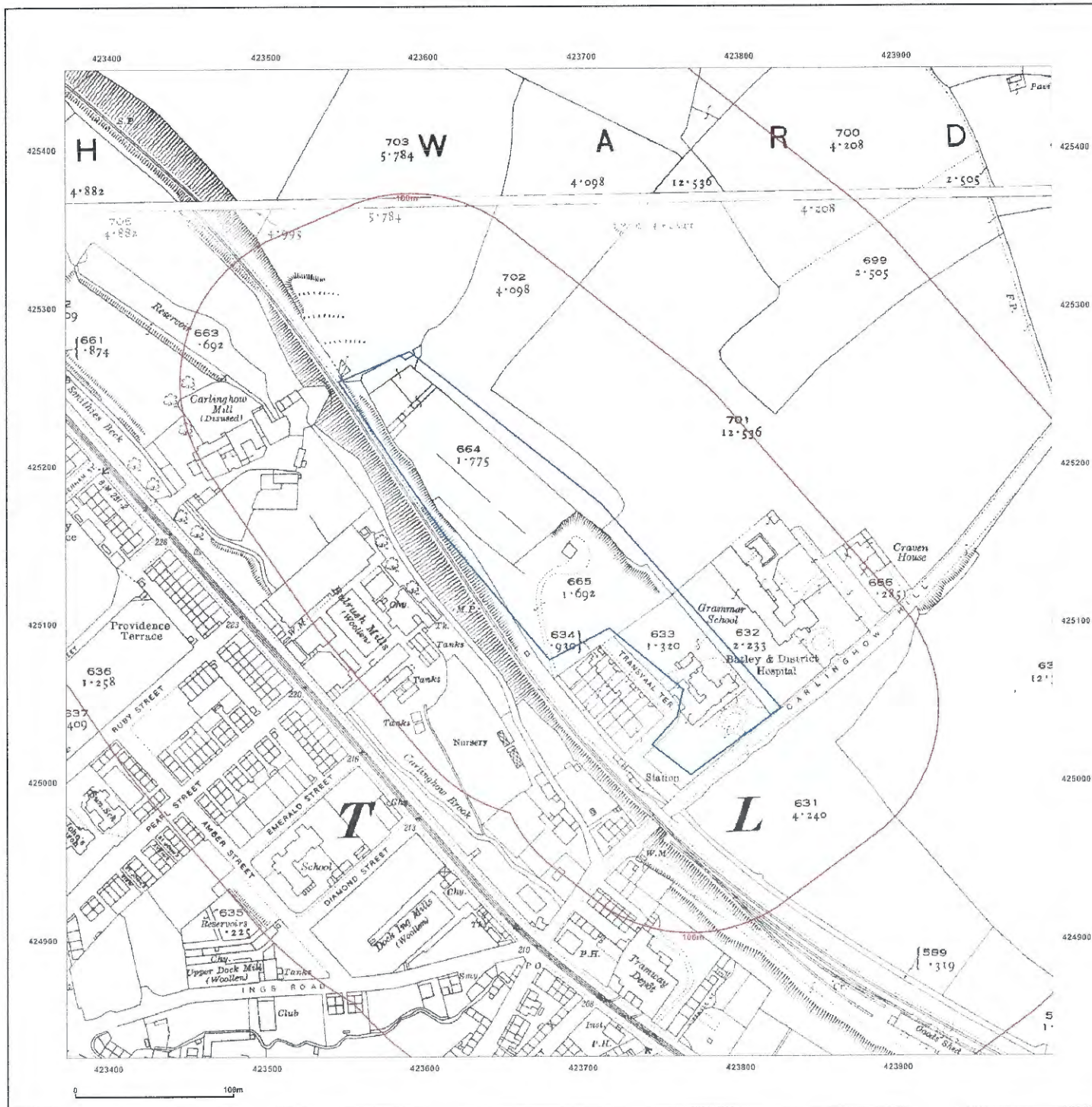

Site Details:

STREET RECORD, ACCESS
REAR OF 1-3 AND NURSING
HOME ON TRANSVAAL
TERRACE, BATLEY, WF17 0AA

Client Ref: C316
Report Ref: GS-5915063
Grid Ref: 423686, 425138

Map Name: County Series

Map date: 1931-1932

Scale: 1:10,560

Printed at: 1:10,560



Surveyed 1850	Surveyed 1850
Revised 1932	Revised 1932
Edition N/A	Edition 1932
Copyright N/A	Copyright N/A
Levelled N/A	Levelled 1929

Surveyed 1851	Surveyed 1851
Revised 1931	Revised 1931
Edition N/A	Edition N/A
Copyright N/A	Copyright N/A
Levelled N/A	Levelled N/A



Produced by
Groundsure Insights
T: 08444 159000
E: info@groundsure.com
W: www.groundsure.com

© Crown copyright and database rights 2018 Ordnance Survey 100035207

Production date: 01 April 2019

Map legend available at:
www.groundsure.com/sites/default/files/groundsure_legend.pdf

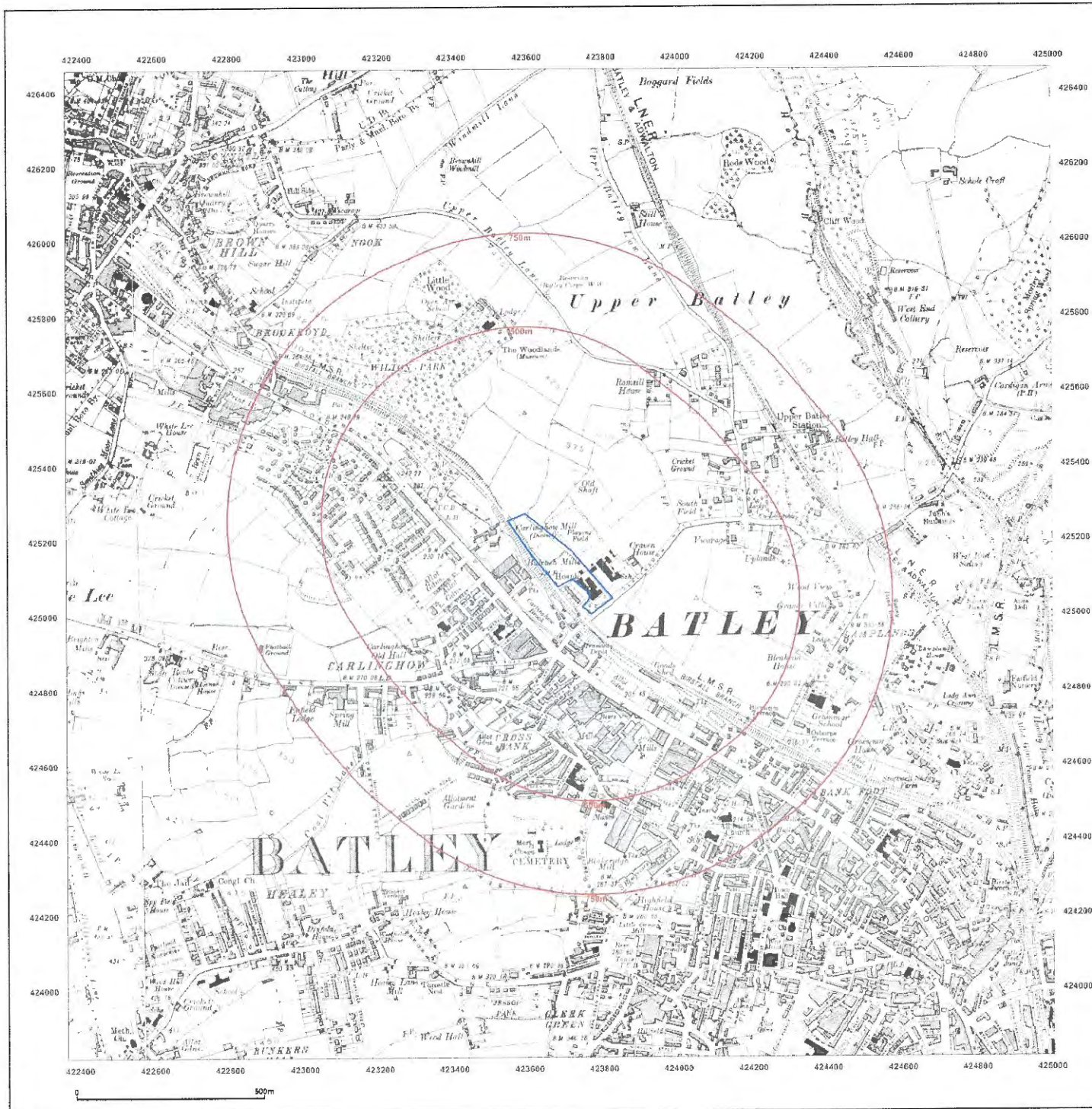

Site Details:

STREET RECORD, ACCESS
 REAR OF 1-3 AND NURSING
 HOME ON TRANSVAAL
 TERRACE, BATLEY, WF17 0AA

Client Ref: C316
Report Ref: GS-5915063
Grid Ref: 423686, 425138

Map Name: County Series

Map date: 1933

Scale: 1:2,500

Printed at: 1:2,500



Surveyed 1933
 Revised 1933
 Edition N/A
 Copyright N/A
 Levelled N/A

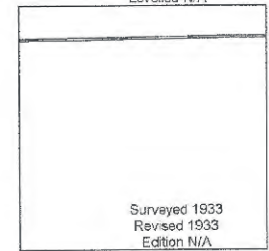

Surveyed 1933
 Revised 1933
 Edition N/A
 Copyright N/A
 Levelled N/A



Produced by
 Groundsure Insights
 T: 08444 159000
 E: info@groundsure.com
 W: www.groundsure.com

© Crown copyright and database rights 2018 Ordnance Survey 100035207

Production date: 01 April 2019

Map legend available at:
www.groundsure.com/sites/default/files/groundsure_legend.pdf

