

PROJECT INFORMATION

CLIENT
Kirklees Neighbourhood Housing (KNH)

ADDRESS
Former Garage Site at Corfe Close/Windmill Lane, Birstall

PROJECT TITLE
Proposed Residential Development

DRAWING DETAILS

PROJECT NUMBER
T-0220.0.C - P

DRAWING NUMBER **REV**
GA103 A

DRAWING TITLE
Proposed Offset Parking Strategy

SCALE (@ A1 [x2 for A3])
As indicated

DRAWN BY **CHECKED BY**
AJ AJ

DATE
08/28/19

Purpose of Issue

NOTES

This drawing is for information only.

Rev	Description	Date
A	Drawings Rescaled	6 Feb 2020

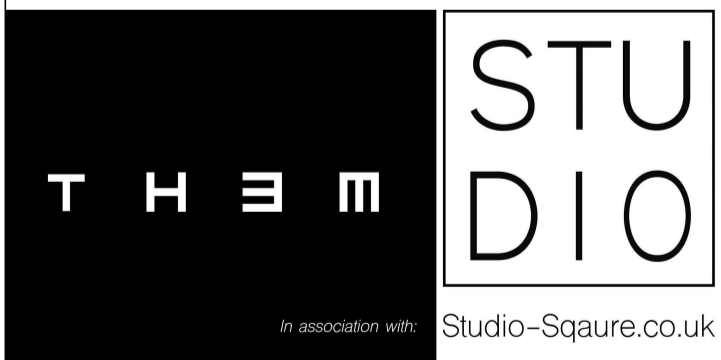

The Studio. No 96 Blacker Road,
Huddersfield
HD1 5HN

Tel. +44 (0)1484 309 394
Email. Hello@TH3M.co

Web. www.TH3M.co

This drawing and design is the copyright of TH3M Limited and may not be reproduced, retained or disclosed to any unauthorised person in any form whatsoever without prior express or written consent. Figured dimensions to be taken in preference to those scaled. All dimensions to be checked onsite and taken in preference to those shown.

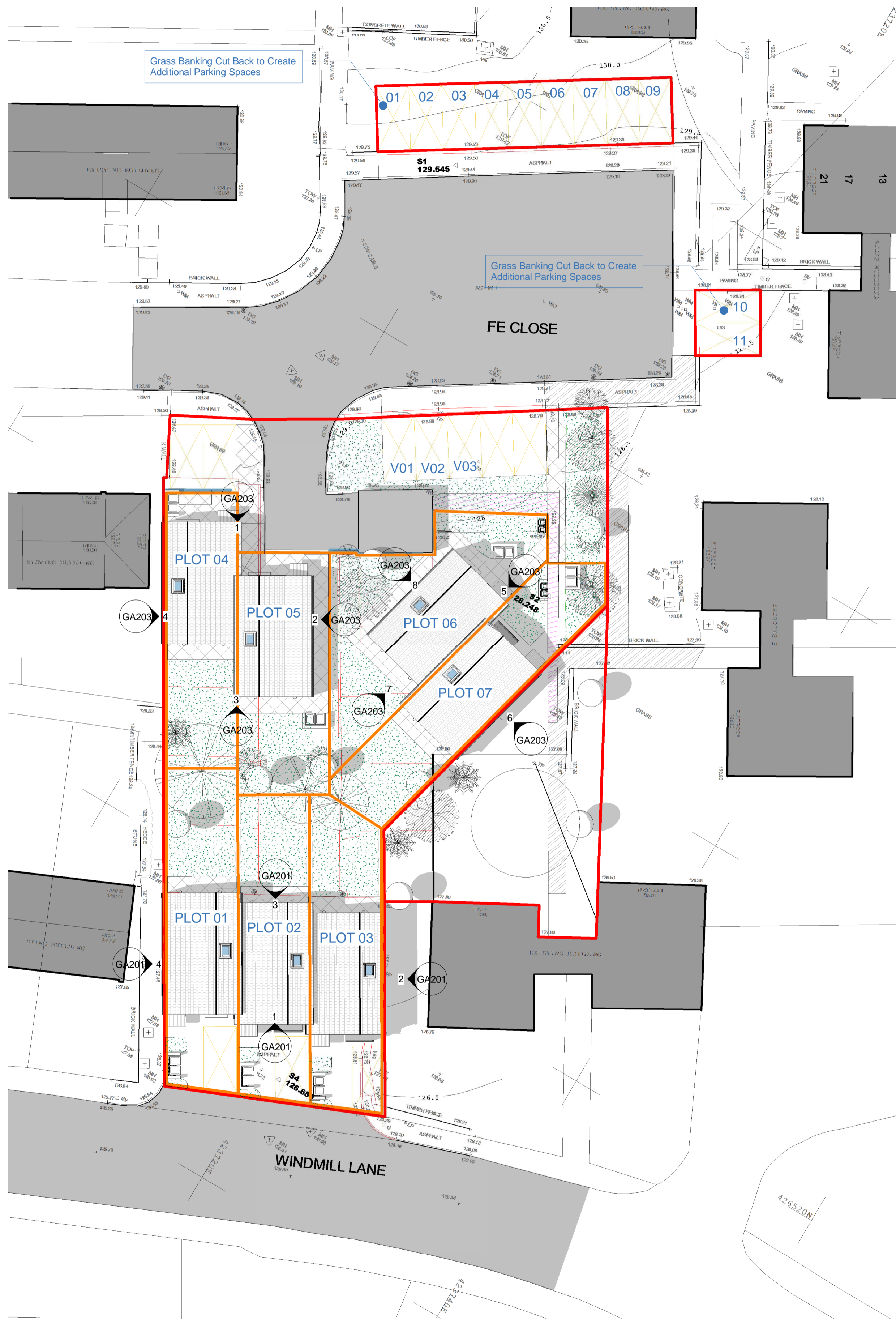

1 Proposed Site Layout Plan with Parking
1 : 200

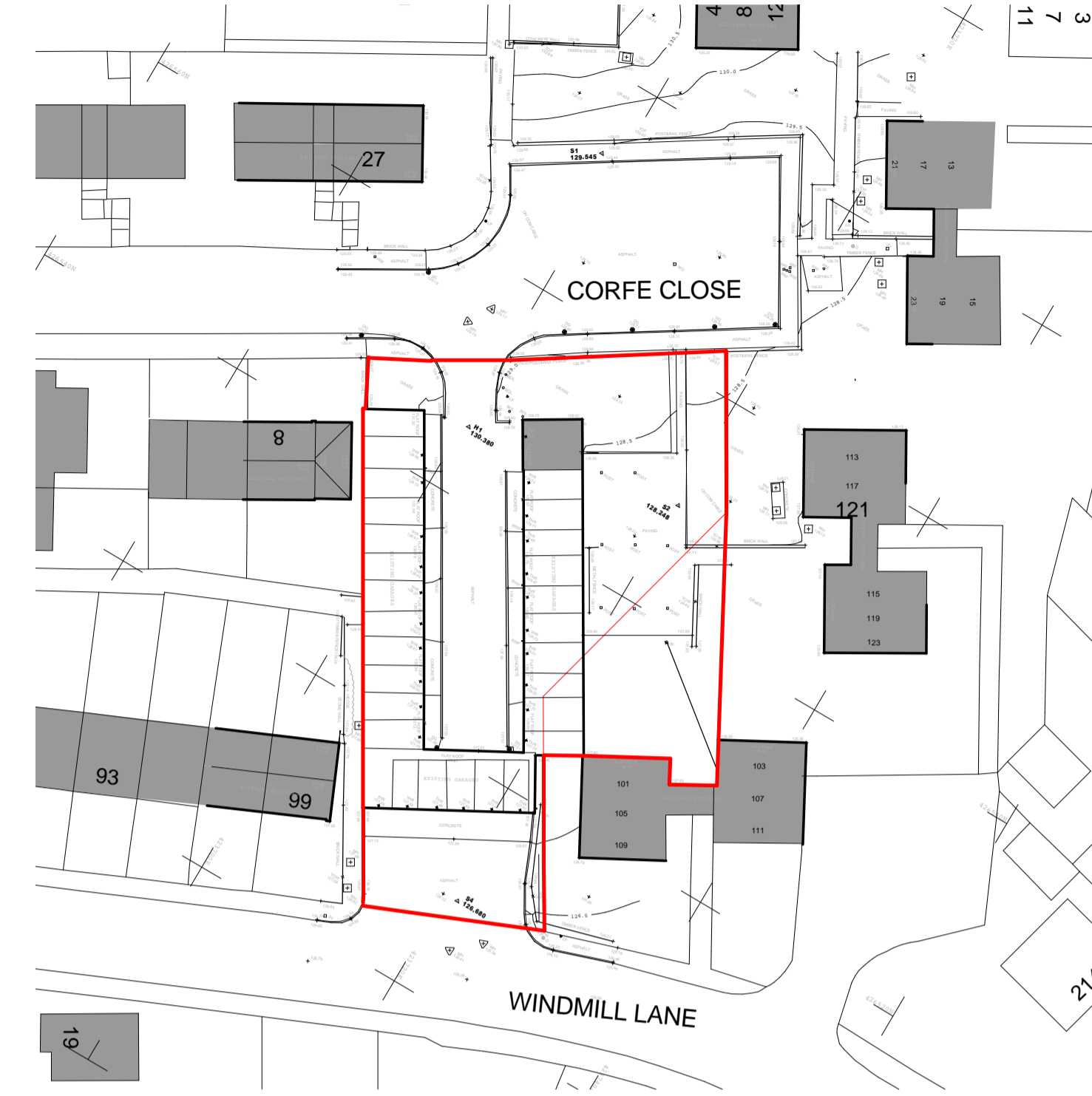

2 Existing Site Plan
1 : 500

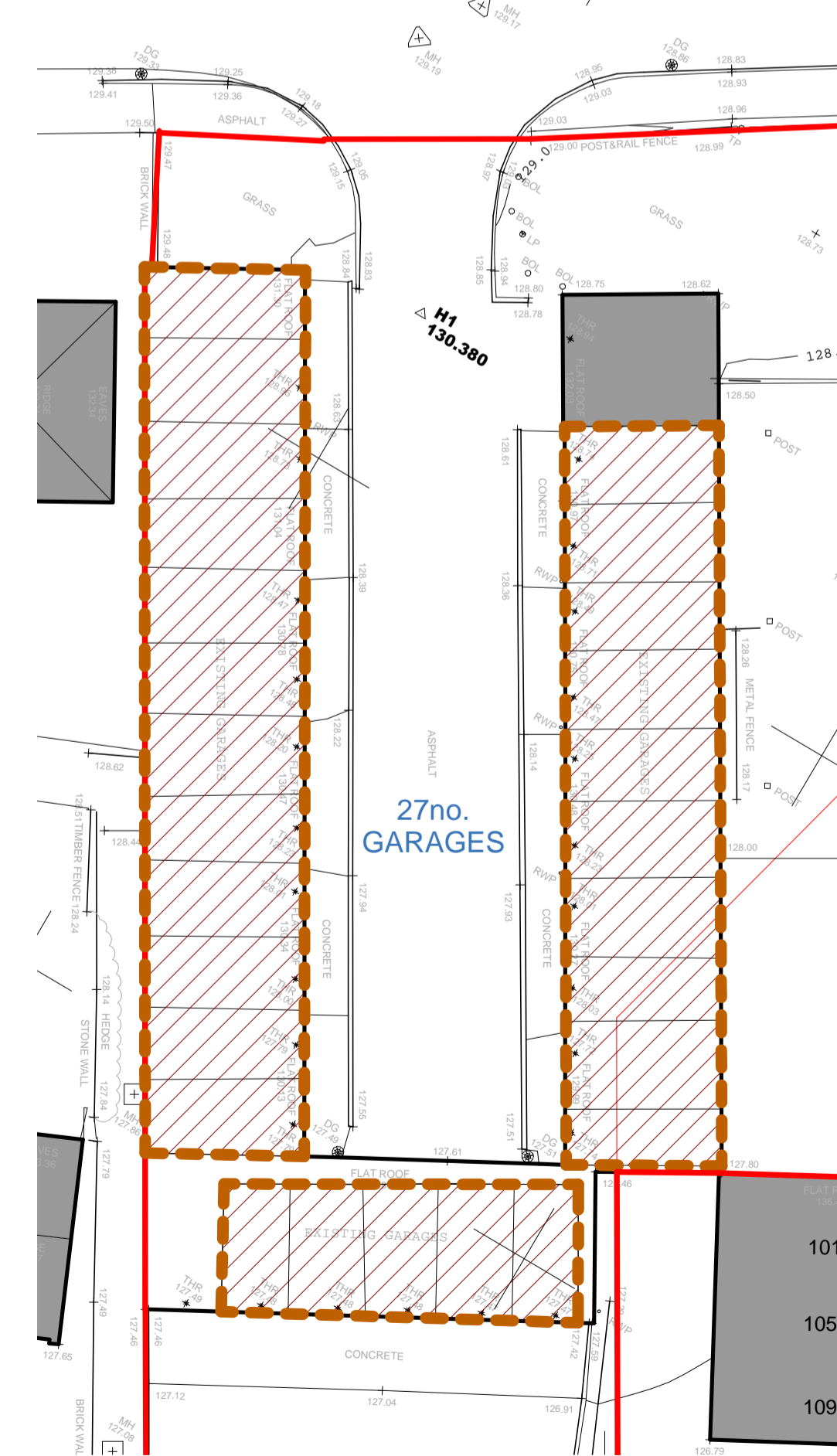

3 Existing Garage Plan
1 : 200