

Copyright exist on the designs and information shown on this drawing. No part of this drawing can be reproduced without written confirmation of Heppenstalls. This drawing should only be used for the purpose was issued for and should not be used for construction unless it is marked for construction. Heppenstalls must be notified should any discrepancies be found.

75

LATHAM LANE

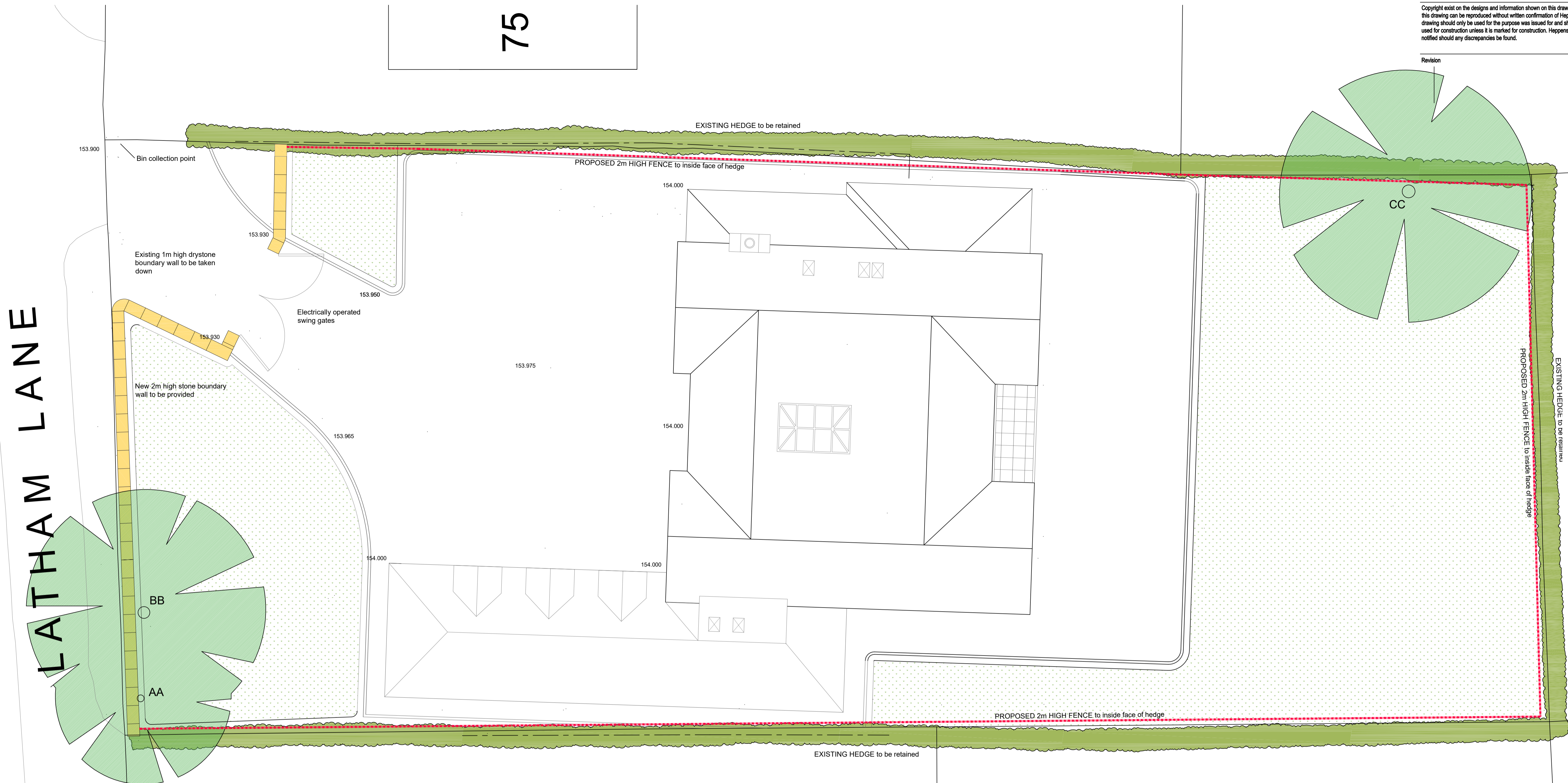

79

# Landscaping and Boundaries Plan

**GENERAL SPECIFICATION FOR INITIAL ESTABLISHMENT AND MAINTENANCE OF PLANTED AREAS.**

**Preparation:**

Prior to planting, shrub beds shall be forked, dug, hoed and stone picked to create a smooth, even surface free from weeds, stones greater than 50mm in any dimension or other deleterious material. Any perennial weed shall be removed including the roots. If necessary an approved herbicide shall be applied to manufacturer's instructions.

**1st Season Maintenance:**

Following planting all areas of new shrub planting shall be mulched with coarse grade bark to a minimum settled depth of 75mm during moist ground conditions. Shrub beds shall be kept clear of all weeds by either mechanical or chemical control during the first growing season after planting. Edges of shrub beds that abut grassed areas shall be kept tidy by regular edging at the time of grass cutting.

**Long term Maintenance:**

Bark mulch shall be topped up as necessary at the start of each growing season to maintain a minimum settled depth of 75mm. Such mulching shall only be done once the beds are weed-free. Weeding shall be carried out as necessary during the growing season to keep beds in a tidy condition. Edges of shrub beds shall be kept clipped as above. Pruning of shrubs shall be carried out as appropriate to maintain shape, flower and vigour.

**Turfing:**

Soil to be prepared with all stones removed. Surface to be lightly scarified and graded to slope evenly where gradients necessary. Supply, lay and bed imported turf to be sourced from an Approved landscape turf supplier (Turf should be in accordance with the specifications given in BS 3969, and laid in accordance with BS 4428:1989, Section 6).

**Existing Trees:**

The existing mature trees marked AA, BB and CC are to be retained

- AA. Hazel
- BB. Fern
- CC. Beech

**EXISTING BORDERS AND NEW GROUND COVER:**

**Existing Borders:**

To provide maturity to the garden where possible existing mature shrubs will be retained and any areas requiring infill will be supplemented with the addition of Pachysandra, Hebe, Vinca, Euonymus, Genista etc.

**New Ground Cover Plants:**

To soften the base of the new house at the edge of the drive and pathway use Pachysandra, Hebe, Vinca, Euonymus, Genista etc.

**EXISTING HEDGES AND THEIR PROTECTION DURING THE CONSTRUCTION PHASE:**

**Existing Hedging:**

In the interests of providing effective screening and to attract wildlife the existing boundary hedges of beech, hawthorn, holly, privet and hazel will be retained. For new more formal hedging if required use Carpinus or Fagus species or a mixture of the two.

**Construction Phase Protection:**

During the construction phase the existing hedges and existing trees are to be protected by means of barriers that offer full protection to the trees and hedges and their root systems (contractors responsibility)

**LEGEND**

- Existing Trees
- 2m high random stone wall
- Turf
- 2m high screen fence
- Existing Hedge

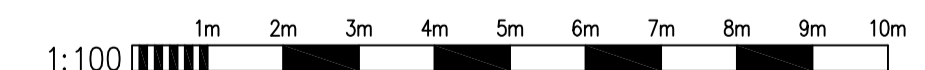

Client A. Saeed.

Project Proposed House, 77 Latham Lane, Gomersal.

Drawing Planning Landscaping and Boundaries Plan

Number 4340-04-01  
 Checked Scale @ A1 1:100  
 Date 02/2019

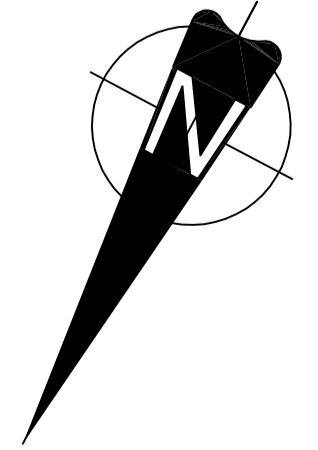

Revision

Planning Condition Variation

**HEPPENSTALLS**

Chartered Architects & Surveyors

Architecture Surveying Planning Project Management  
 RIBA RICS  
 Allisons buildings, 135 Armitage Road Millsbridge, Huddersfield, HD3 4JY tel 01484 658411 projects@heppenstalls.net www.heppenstalls.net