



WILLIAM STREET

PROPOSED SITE PLAN  
SCALE 1:200



LOCATION PLAN  
SCALE 1:1250



WILLIAM STREET

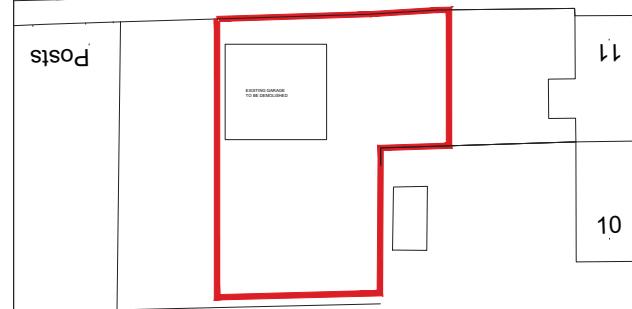

GEORGE STREET

EXISTING SITE PLAN  
SCALE 1:500

Rev	Revision	Date
C	Length and Width reduced by 1m. Gable end changed to hipped roof	22/01/19
B	Building Height reduces from 5.92m to 5m	09/01/19
A	Existing Elevation added to plans	03/01/19

**JOB**  
PROPOSED ERECTION OF NEW INDUSTRIAL UNIT FOR SOTRAGE

**ADDRESS**  
LAND AT WILLIAM STREET  
DEWSBURY  
WF13

MR ABID HUSSAIN

DATE	SCALE	SHEET
03/09/18	1:200/1:1250	1@A3

**NOTES**

This drawing is subject to a detailed building and site survey, therefore no guarantee of its accuracy can be given.  
This drawing has been draughted in accordance with the clients design requirements.  
All areas are approximate and are subject to a detailed building and site survey and further design development.  
All dimensions should be checked prior to commencement of construction on site. Measurements should not be taken off the drawing.