

Demeter Environmental Ltd
Liverpool Office:
 Hanover House
 Hanover Street
 Liverpool
 L1 3DZ

Tel: 0151 521 2539
 Fax: 0151 909 3661

Brighton Office:
 Gemini House
 136-140 Old Shoreham
 Road
 Brighton, East Sussex
 BN3 7BD
 Tel: 01273 741 727

Email: enquiries@demeter-environmental.co.uk

Drawing 4

LA New Hey Road

Scale: 1:1,000 at
 A3

Proposed Site
 Investigation
 Layout



APPENDIX H: SITE PHOTOGRAPHS AND PHOTOGRAPH KEY PLAN



Demeter Environmental Ltd
Liverpool Office:
Hanover House
Hanover Street
Liverpool
L1 3DZ

Tel: 0151 521 2539
Fax: 0151 909 3661

Brighton Office:
Gemini House
136-140 Old Shoreham
Road
Brighton, East Sussex
BN3 7BD
Tel: 01273 741 727

Email: enquiries@demeter-environmental.co.uk

Drawing 5

LA New Hey Road
(Site A)

Scale: 1:1,000 at
A3

Photograph Key
Plan

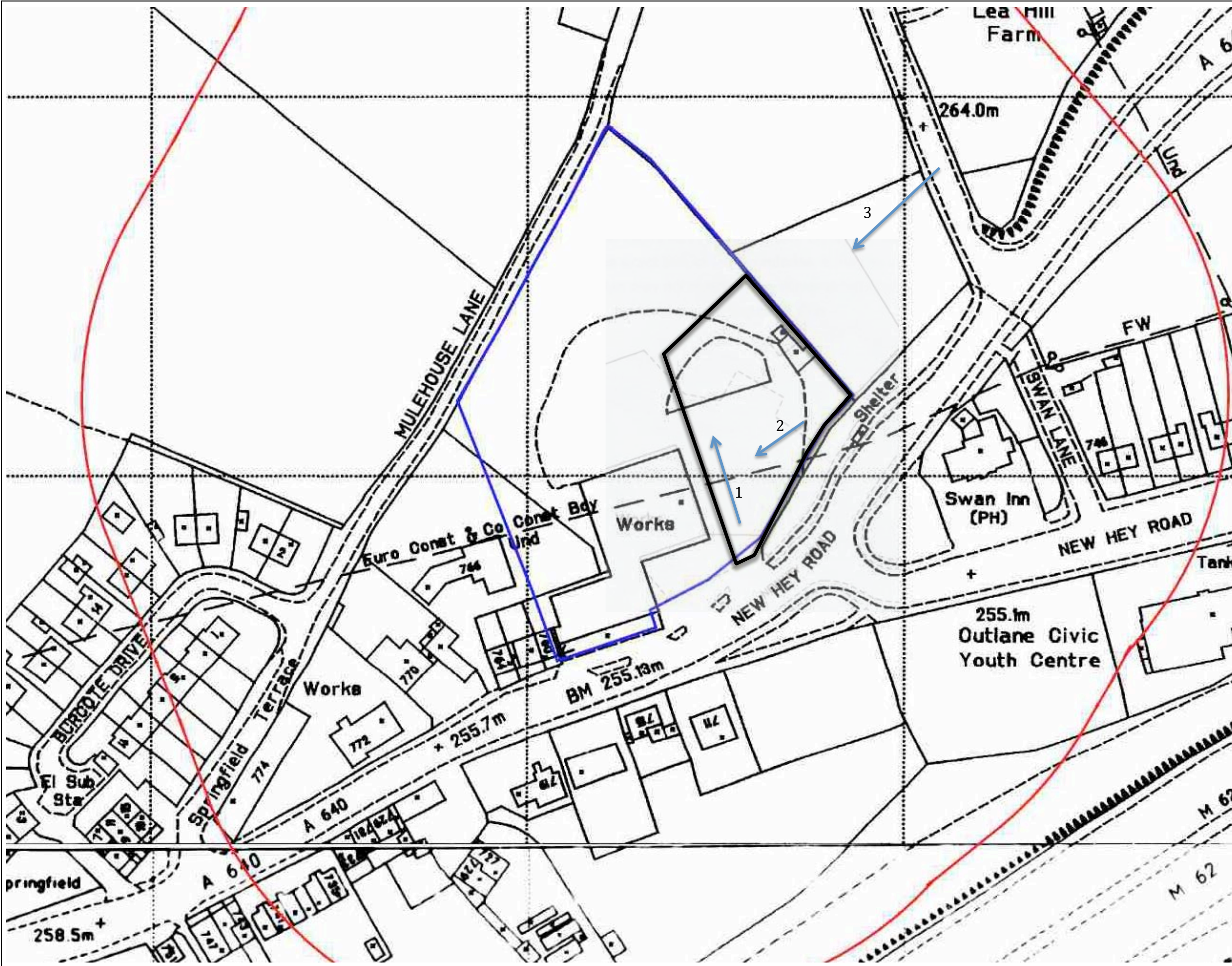



Demeter Environmental Ltd
Liverpool Office:
Hanover House
Hanover Street
Liverpool
L1 3DZ

Tel: 0151 521 2539
Fax: 0151 909 3661

Brighton Office:
Gemini House
136-140 Old Shoreham
Road
Brighton, East Sussex
BN3 7BD
Tel: 01273 741 727

Email: enquiries@demeter-environmental.co.uk

Drawing 5

LA New Hey Road

Scale: 1:1,000 at
A3

Photograph Key
Plan

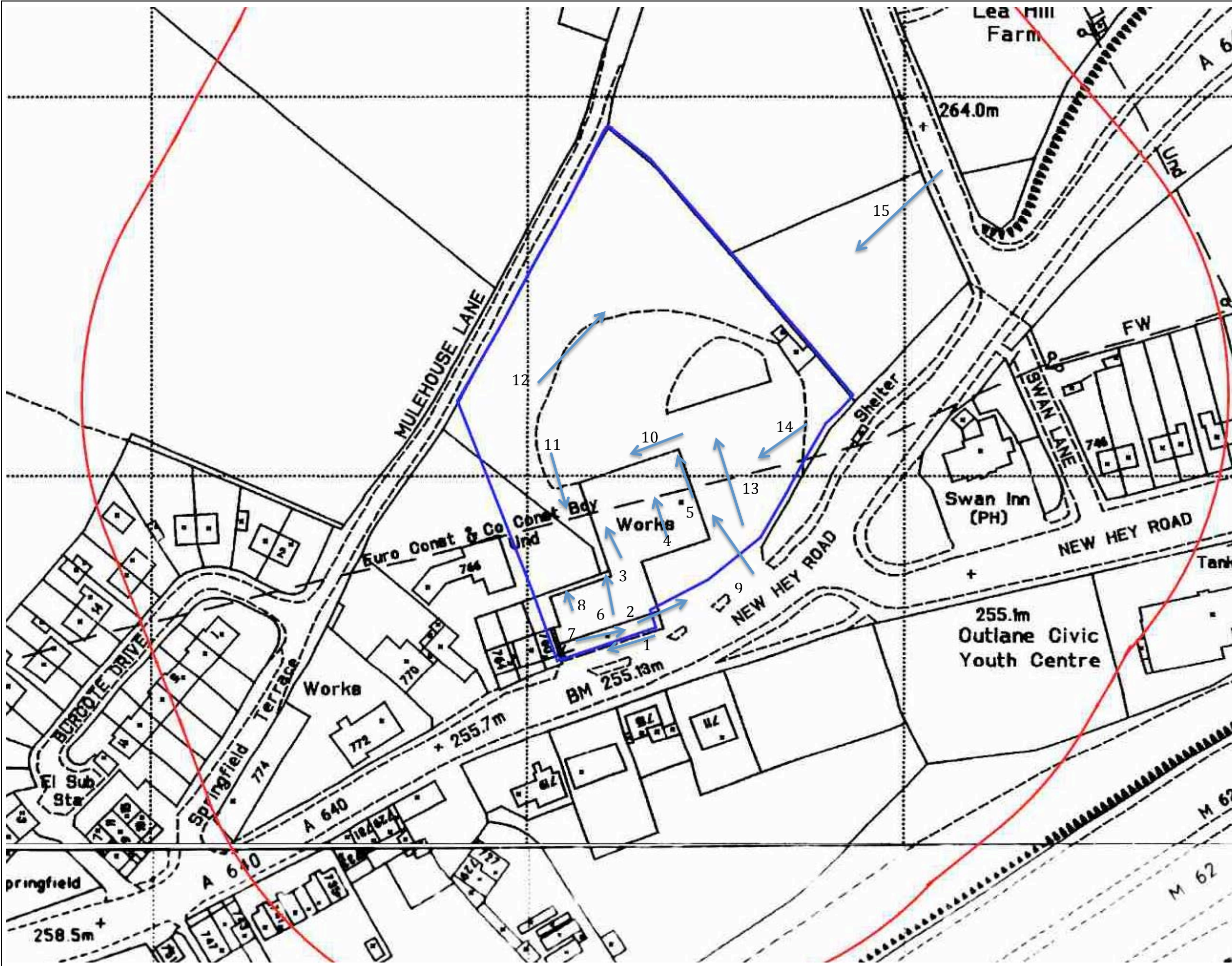



☀ 266°W (T) LAT: 53.658924 LON: -1.867726 ±8m ▲ 256m



Demeter Environmental

24 Jul 2018, 10:27



Demeter Environmental Ltd
Liverpool Office:
 Hanover House
 Hanover Street
 Liverpool
 L1 3DZ
 Tel: 0151 521 2539
 Fax: 0151 909 3661
Brighton Office:
 Gemini House
 136-140 Old Shoreham Road
 Brighton, East Sussex
 BN3 7BD
 Email: enquiries@demeter-environmental.co.uk

Plate 1

LA New Hey Road

Description: View of southern boundary of the site (area of former filling station)



☀ 42°NE (T) LAT: 53.658985 LON: -1.867719 ±4m ▲ 256m



Demeter Environmental

24 Jul 2018, 10:31



Demeter Environmental Ltd

Liverpool Office:
 Hanover House
 Hanover Street
 Liverpool
 L1 3DZ

Tel: 0151 521 2539
 Fax: 0151 909 3661

Brighton Office:
 Gemini House
 136-140 Old Shoreham
 Road
 Brighton, East Sussex
 BN3 7BD

Email: enquiries@demeter-environmental.co.uk

Plate 2

LA New Hey Road

Description: View of southern boundary of the site

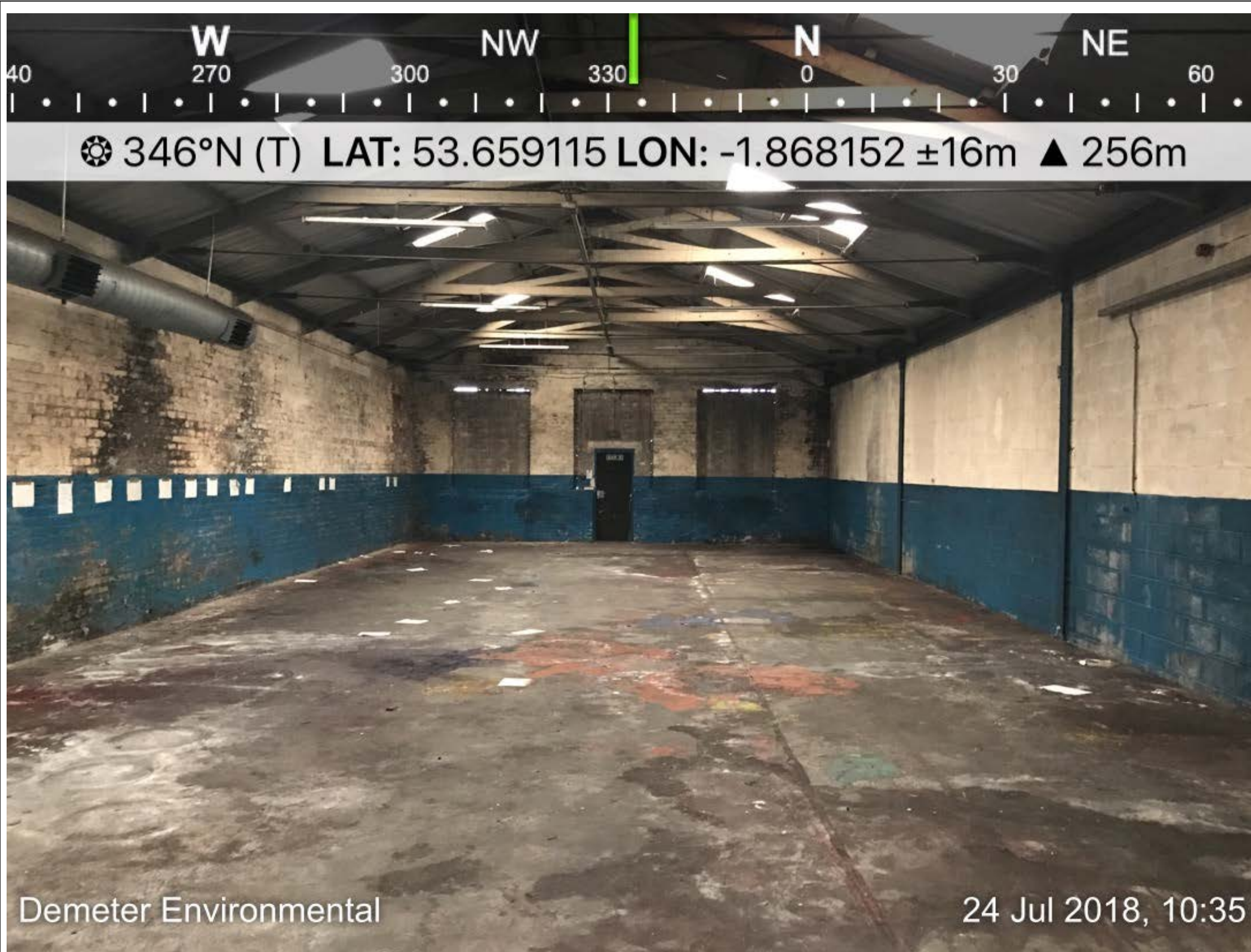

Demeter Environmental Ltd

Liverpool Office:
Hanover House
Hanover Street
Liverpool
L1 3DZ

Tel: 0151 521 2539
Fax: 0151 909 3661

Brighton Office:
Gemini House
136-140 Old Shoreham
Road
Brighton, East Sussex
BN3 7BD

Email: enquiries@demeter-environmental.co.uk

Plate 3

LA New Hey Road

Description: View of central area of the building

Demeter Environmental

24 Jul 2018, 10:35



☀ 345°N (T) LAT: 53.659035 LON: -1.867919 ±16m ▲ 256m



Demeter Environmental

24 Jul 2018, 10:35



Demeter Environmental Ltd

Liverpool Office:

Hanover House
Hanover Street
Liverpool
L1 3DZ

Tel: 0151 521 2539
Fax: 0151 909 3661

Brighton Office:

Gemini House
136-140 Old Shoreham
Road
Brighton, East Sussex
BN3 7BD

Email: enquiries@demeter-environmental.co.uk

Plate 4

LA New Hey Road

Description: View of raised area in the eastern area of the building



☀ 336°NW (T) LAT: 53.659069 LON: -1.867870 ±16m ▲ 256m



Demeter Environmental

24 Jul 2018, 10:35



Demeter Environmental Ltd

Liverpool Office:

Hanover House
Hanover Street
Liverpool
L1 3DZ

Tel: 0151 521 2539
Fax: 0151 909 3661

Brighton Office:

Gemini House
136-140 Old Shoreham
Road
Brighton, East Sussex
BN3 7BD

Email: enquiries@demeter-environmental.co.uk

Plate 5

LA New Hey Road

Description: View of raised area in the eastern area of the building

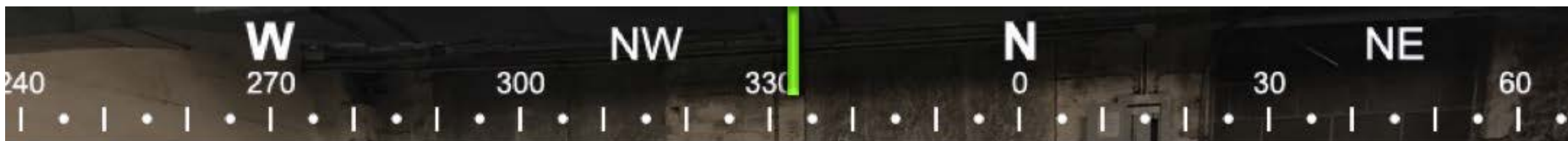

☉ 345°N (T) LAT: 53.659088 LON: -1.867871 ±16m ▲ 256m



Demeter Environmental Ltd

Liverpool Office:
Hanover House
Hanover Street
Liverpool
L1 3DZ

Tel: 0151 521 2539
Fax: 0151 909 3661

Brighton Office:
Gemini House
136-140 Old Shoreham
Road
Brighton, East Sussex
BN3 7BD

Email: enquiries@demeter-environmental.co.uk

Plate 5

LA New Hey Road

Description: View of the inspection pit

Demeter Environmental

24 Jul 2018, 10:37



☀ 72°E (T) LAT: 53.659054 LON: -1.867908 ±24m ▲ 256m



Demeter Environmental

24 Jul 2018, 10:39



Demeter Environmental Ltd

Liverpool Office:
Hanover House
Hanover Street
Liverpool
L1 3DZ

Tel: 0151 521 2539
Fax: 0151 909 3661

Brighton Office:
Gemini House
136-140 Old Shoreham
Road
Brighton, East Sussex
BN3 7BD

Email: enquiries@demeter-environmental.co.uk

Plate 7

LA New Hey Road

Description: View of the offices on the southern area of the building



☀ 343°N (T) LAT: 53.658958 LON: -1.867985 ±16m ▲ 256m



Demeter Environmental Ltd

Liverpool Office:

Hanover House
Hanover Street
Liverpool
L1 3DZ

Tel: 0151 521 2539
Fax: 0151 909 3661

Brighton Office:

Gemini House
136-140 Old Shoreham
Road
Brighton, East Sussex
BN3 7BD

Email: enquiries@demeter-environmental.co.uk

Plate 8

LA New Hey Road

Description: View of the western area of the building

Demeter Environmental

24 Jul 2018, 10:39



☉ 242°SW (T) LAT: 53.659515 LON: -1.867547 ±6m ▲ 256m



Demeter Environmental

24 Jul 2018, 11:05



Demeter Environmental Ltd

Liverpool Office:

Hanover House
Hanover Street
Liverpool
L1 3DZ

Tel: 0151 521 2539
Fax: 0151 909 3661

Brighton Office:

Gemini House
136-140 Old Shoreham
Road
Brighton, East Sussex
BN3 7BD

Email: enquiries@demeter-environmental.co.uk

Plate 9

LA New Hey Road

Description: View of the eastern face of the building



☀ 247°SW (T) LAT: 53.659412 LON: -1.867758 ±6m ▲ 255m



Demeter Environmental

24 Jul 2018, 11:06



Demeter Environmental Ltd

Liverpool Office:
 Hanover House
 Hanover Street
 Liverpool
 L1 3DZ

Tel: 0151 521 2539
 Fax: 0151 909 3661

Brighton Office:
 Gemini House
 136-140 Old Shoreham
 Road
 Brighton, East Sussex
 BN3 7BD

Email: enquiries@demeter-environmental.co.uk

Plate 10

LA New Hey Road

Description: View of the northern face of the building



☀ 168°S (T) LAT: 53.659374 LON: -1.868095 ±6m ▲ 255m



Demeter Environmental Ltd

Liverpool Office:
Hanover House
Hanover Street
Liverpool
L1 3DZ

Tel: 0151 521 2539
Fax: 0151 909 3661

Brighton Office:
Gemini House
136-140 Old Shoreham
Road
Brighton, East Sussex
BN3 7BD

Email: enquiries@demeter-environmental.co.uk

Plate 11

LA New Hey Road

Description: View of the overgrown area on the north western area of the site

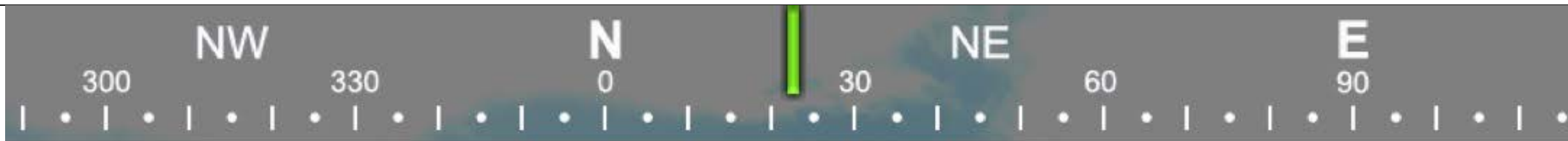

☀ 35°NE (T) LAT: 53.659512 LON: -1.868281 ±6m ▲ 255m



Demeter Environmental

24 Jul 2018, 11:09



Demeter Environmental Ltd

Liverpool Office:

Hanover House
Hanover Street
Liverpool
L1 3DZ

Tel: 0151 521 2539
Fax: 0151 909 3661

Brighton Office:

Gemini House
136-140 Old Shoreham
Road
Brighton, East Sussex
BN3 7BD

Email: enquiries@demeter-environmental.co.uk

Plate 12

LA New Hey Road

Description: View of the overgrown area on the north eastern area of the site



☉ 344°N (T) LAT: 53.659386 LON: -1.867389 ±6m ▲ 257m



Demeter Environmental

24 Jul 2018, 11:04



Demeter Environmental Ltd
Liverpool Office:
 Hanover House
 Hanover Street
 Liverpool
 L1 3DZ
 Tel: 0151 521 2539
 Fax: 0151 909 3661
Brighton Office:
 Gemini House
 136-140 Old Shoreham
 Road
 Brighton, East Sussex
 BN3 7BD
 Email: enquiries@demeter-environmental.co.uk

Plate 13

LA New Hey Road

Description: View of the western boundary of the site looking north



☀ 259°W (T) LAT: 53.659298 LON: -1.867014 ±12m ▲ 227m



Demeter Environmental Ltd

Liverpool Office:
 Hanover House
 Hanover Street
 Liverpool
 L1 3DZ

Tel: 0151 521 2539
 Fax: 0151 909 3661

Brighton Office:
 Gemini House
 136-140 Old Shoreham
 Road
 Brighton, East Sussex
 BN3 7BD

Email: enquiries@demeter-environmental.co.uk

Plate 14

LA New Hey Road

Description: View of the site looking west across the site

Demeter Environmental

24 Jul 2018, 11:16



Demeter Environmental Ltd
Liverpool Office:
 Hanover House
 Hanover Street
 Liverpool
 L1 3DZ
 Tel: 0151 521 2539
 Fax: 0151 909 3661

Brighton Office:
 Gemini House
 136-140 Old Shoreham Road
 Brighton, East Sussex
 BN3 7BD
 Email: enquiries@demeter-environmental.co.uk

☉ 209°SW (T) LAT: 53.660072 LON: -1.866660 ±6m ▲ 266m



Plate 15

LA New Hey Road

Description: View of site looking west across the site

Demeter Environmental

24 Jul 2018, 11:17



APPENDIX I: HISTORICAL O.S. MAPS