

front elevation

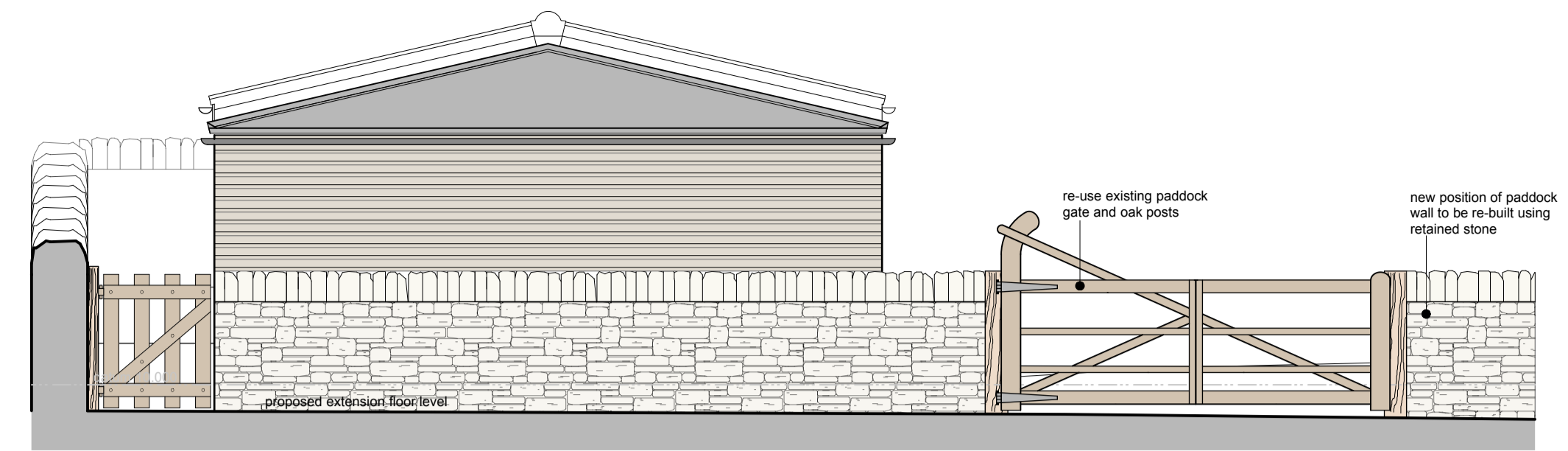

side elevation



rear elevation / part section

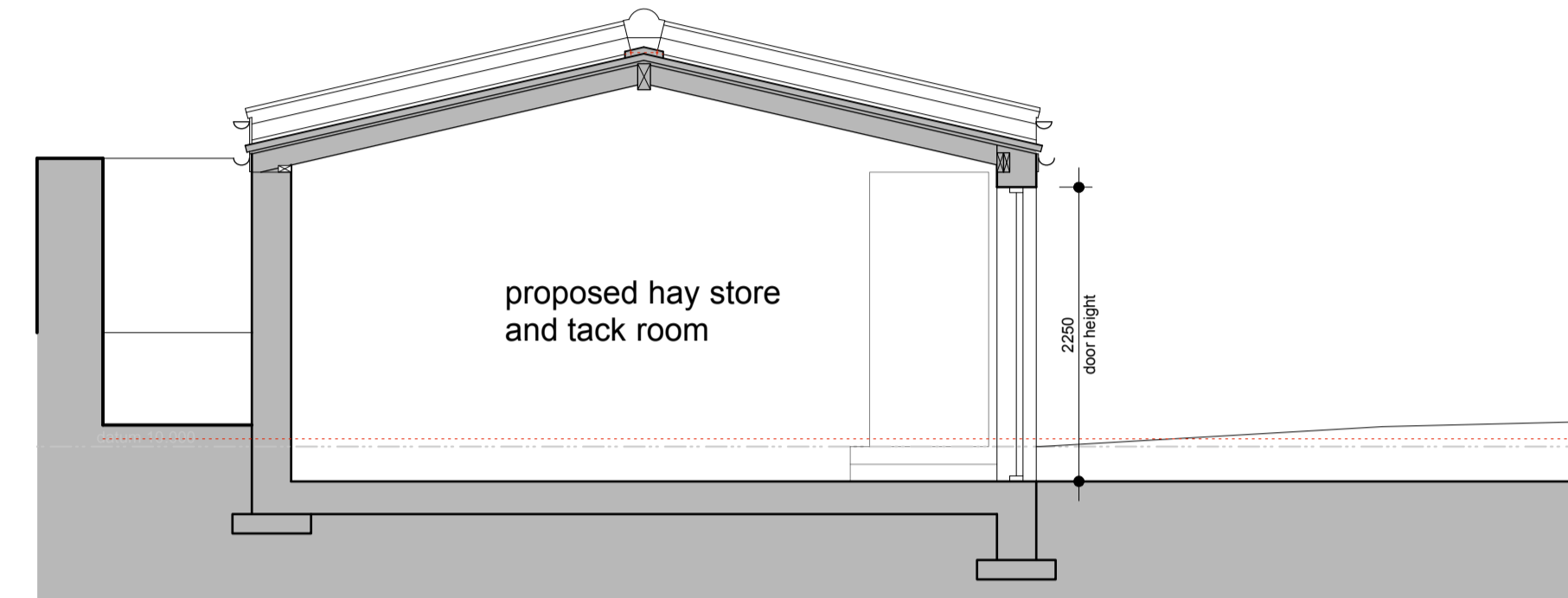

section a-a

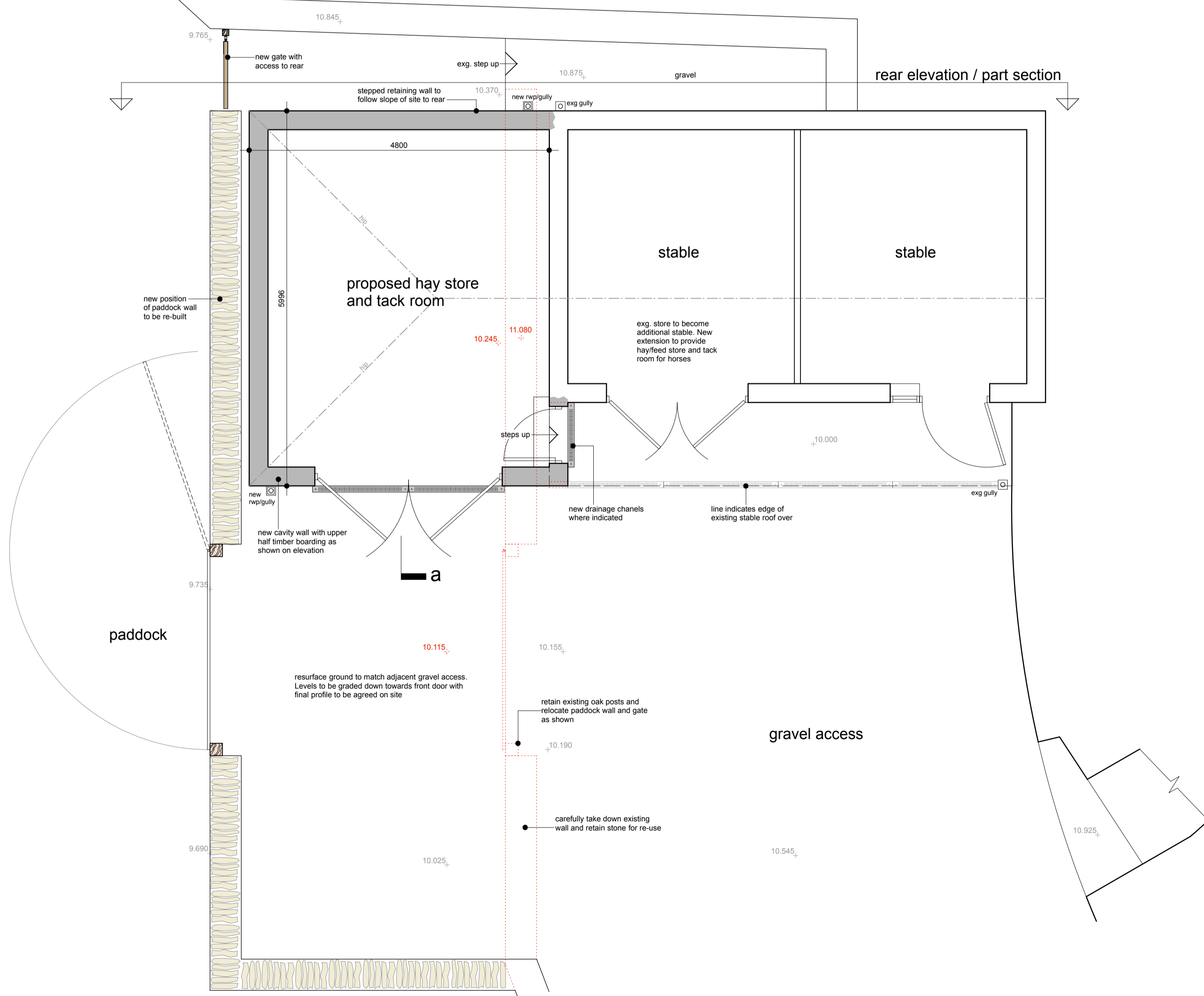

ground floor plan

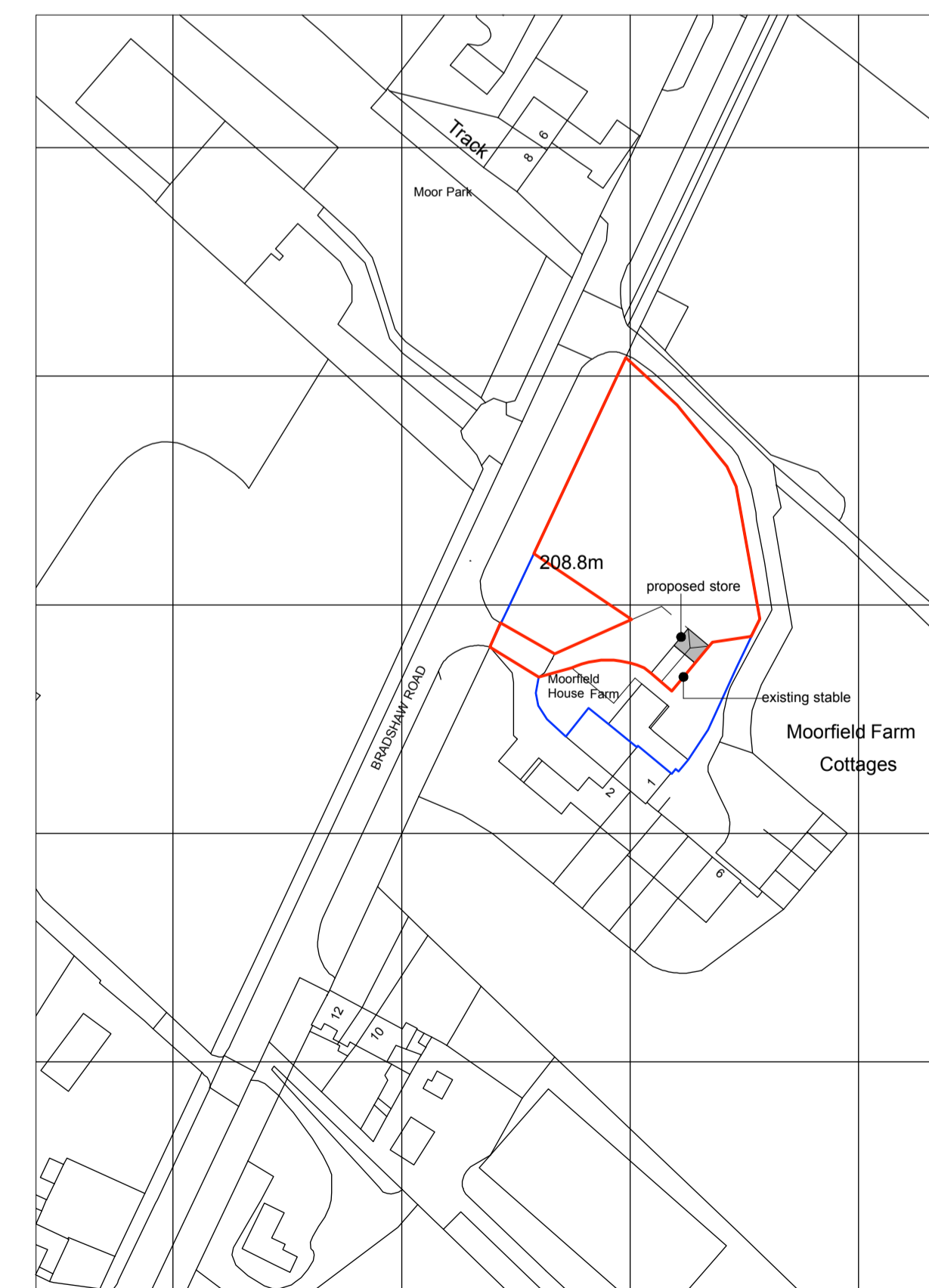

Ordnance Survey (c) Crown Copyright 2018. All rights reserved. Licence number 100022432

location plan 1/1250

This drawing has been prepared specifically for the purpose of obtaining Planning Permission and/or Building Regulation Approval. Its suitability for other purposes, without supplementary details and specifications cannot be guaranteed. The Permissions and/or Approvals are beyond the Architects control, and no guarantee that such will be granted is given or to be inferred by reason of the preparation of this drawing. Only figured dimensions are to be used. All dimensions to be checked on site. This drawing together with the design is the property and copyright of the Architect and must not be reproduced without prior written permission.

rev.	description	date	drawn	approved
P03	Location plan amended	11.09.18	JS	RE
P02	Drawing updated following client comments	06.08.18	JS	RE
P01	Drawing originated	27.07.18	JS	RE



project Side extension to existing stables at Moorfield House Farm, Bradshaw Road, Honley, HD9 6RJ for Mrs Angela Vine

title GA as proposed
number 18090D-02-P03
scale 1:50
size A1