

garage floor plan

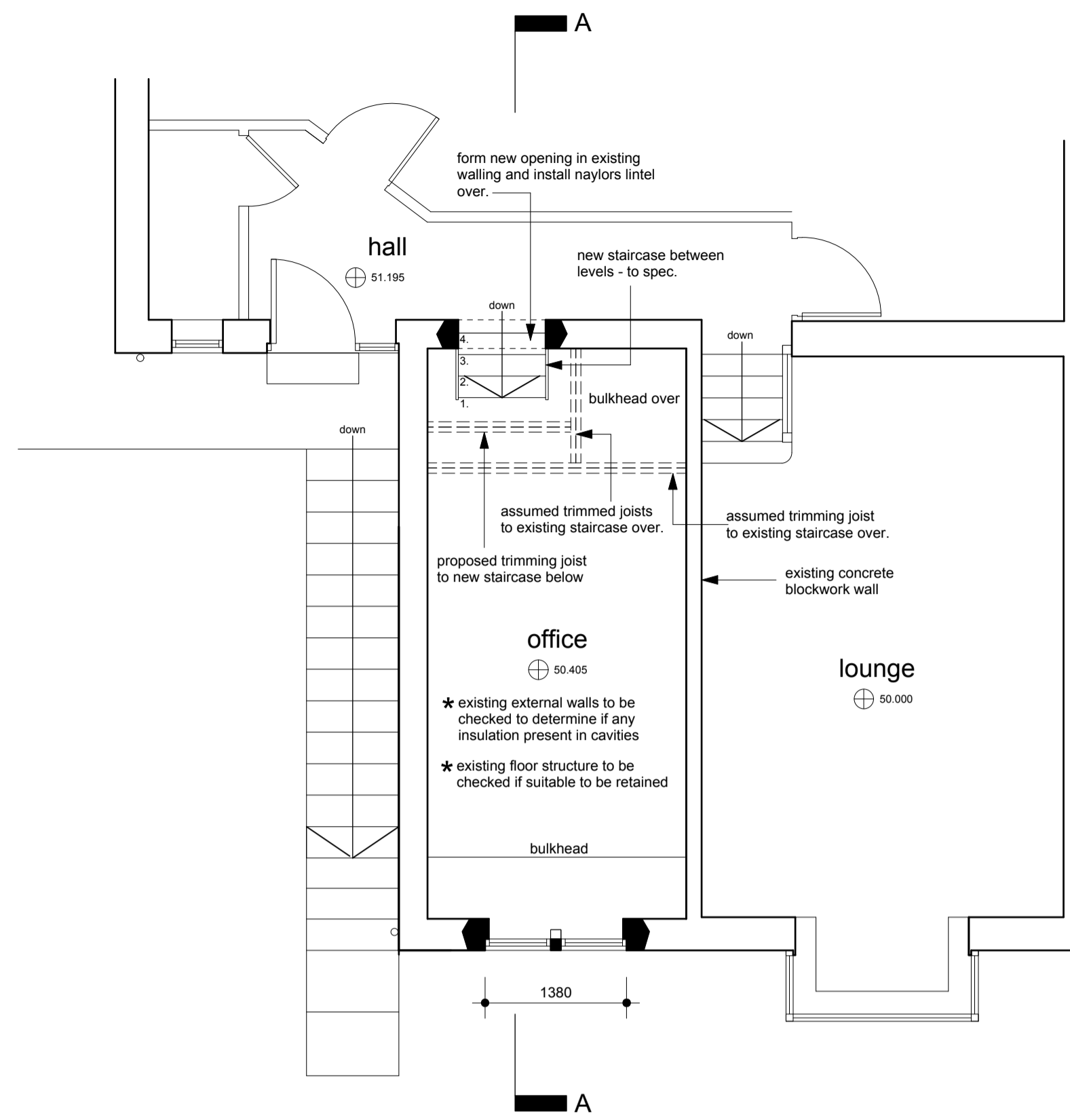

ground floor plan

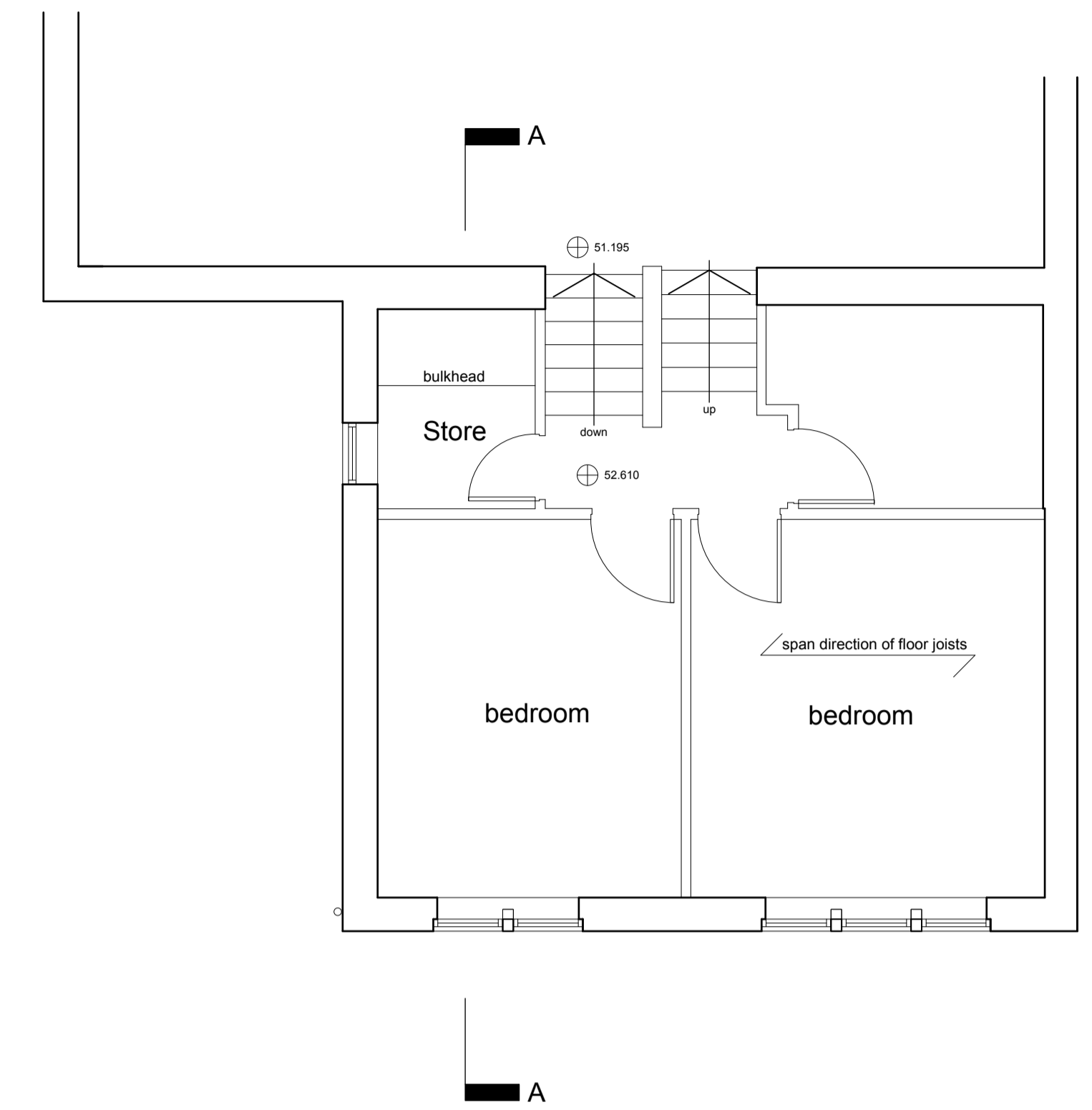

first floor plan



Location Plan-1/1250



north east elevation

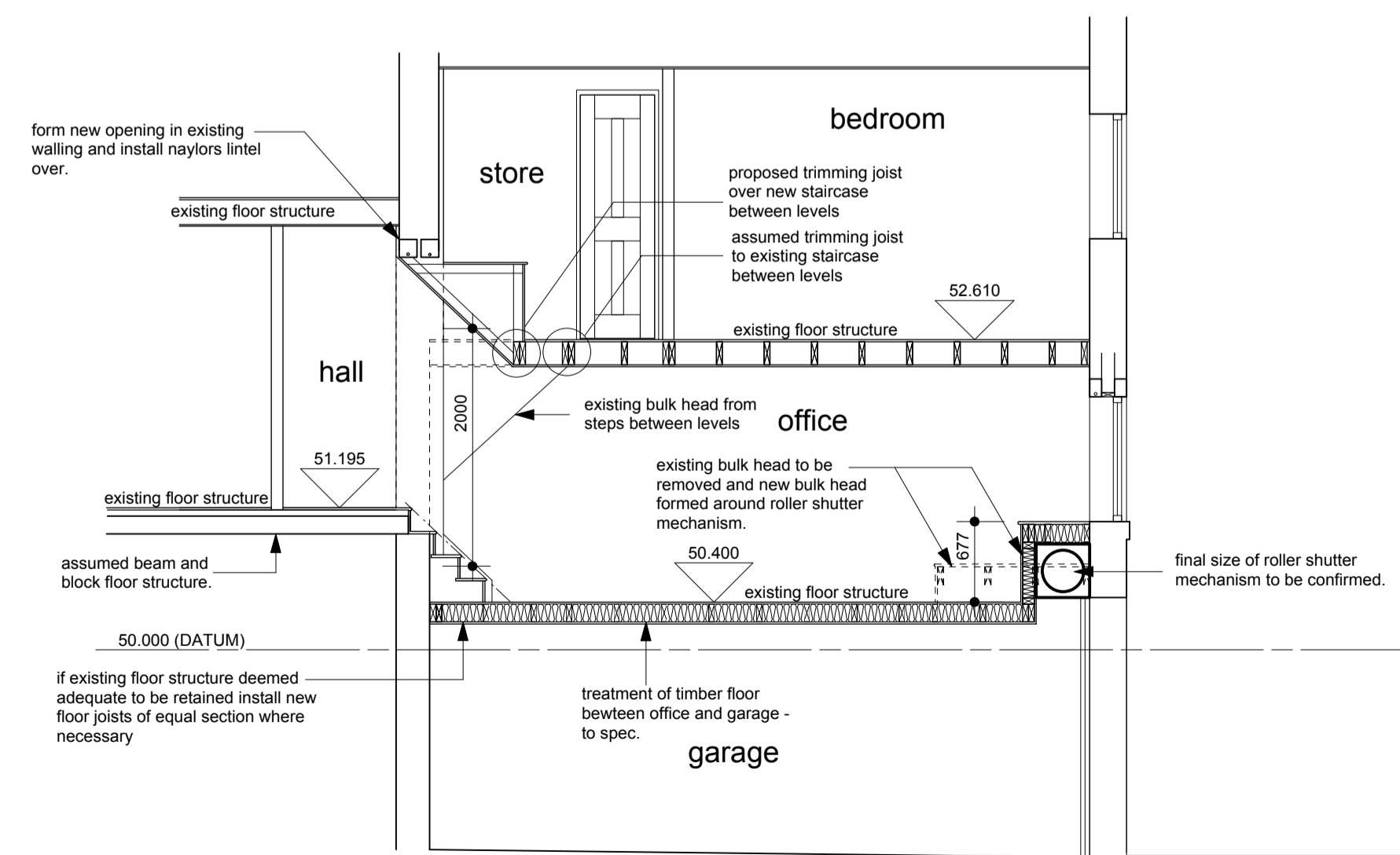

section A-A

Notes:
This drawing has been prepared specifically for the purpose of Planning Permission (where appropriate) & Building Regulation Approval. Valley Properties accept no liability for errors or omissions. The drawing may be used for estimating purposes, but the Principal Contractor must carry out a site investigation. The Contractor is responsible for checking site dimensions, materials etc., and all building work, such work being checked by Building Control on site, as may be appropriate. Valley Properties disclaim any liability for works carried out.

Revisions:
Rev.A
Rev.B
Rev.C
Rev.D
Rev.E

VALLEY PROPERTIES
ARCHITECTURAL DESIGN SERVICES
5 Holmfirth Road
Meltham
Holmfirth HD9 4AA
Tel: 01484 854100 Mob: 07769736142
E-mail: vproperties@vpa.net

Client Details
Mr & Mrs Snow

Project Title
**Proposed internal/external alterations at
52 Heather Road
Meltham
Holmfirth**

Drawing Title
Planning Drawing

Scale: 1:50 & 1:100	Drawing Number 2018/025/03	Rev. May 2018	Date Drawn May 2018	Drawn By Andrew Smith
------------------------	-------------------------------	------------------	------------------------	--------------------------