



Ordnance Survey Plan Published 1956 Source map scale - 1:2,500

The historical maps shown were reproduced from maps predominantly held at the scale adopted for England, Wales and Scotland in the 1840's. In 1854 the 1:2,500 scale was adopted for mapping urban areas and by 1896 it covered the whole of what were considered to be the cultivated parts of Great Britain. The published date given below is often some years later than the surveyed date. Before 1938, all OS maps were based on the Cassini Projection, with independent surveys of a single county or group of counties, giving rise to significant inaccuracies in outlying areas.

Map Name(s) and Date(s)

SE2123 1956 1:2,500	SE2223 1956 1:2,500
SE2122 1956 1:2,500	SE2222 1956 1:2,500

Historical Map - Segment A13

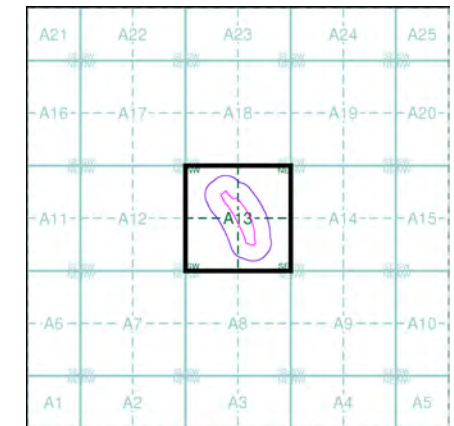

Order Details

Order Number: 125293094_1_1
 Customer Ref: YKS/01
 National Grid Reference: 421940, 423120
 Slice: A
 Site Area (Ha): 2.79
 Search Buffer (m): 100

Site Details

7, Sunnyside, HECKMONDWIKE, WF16 0LN

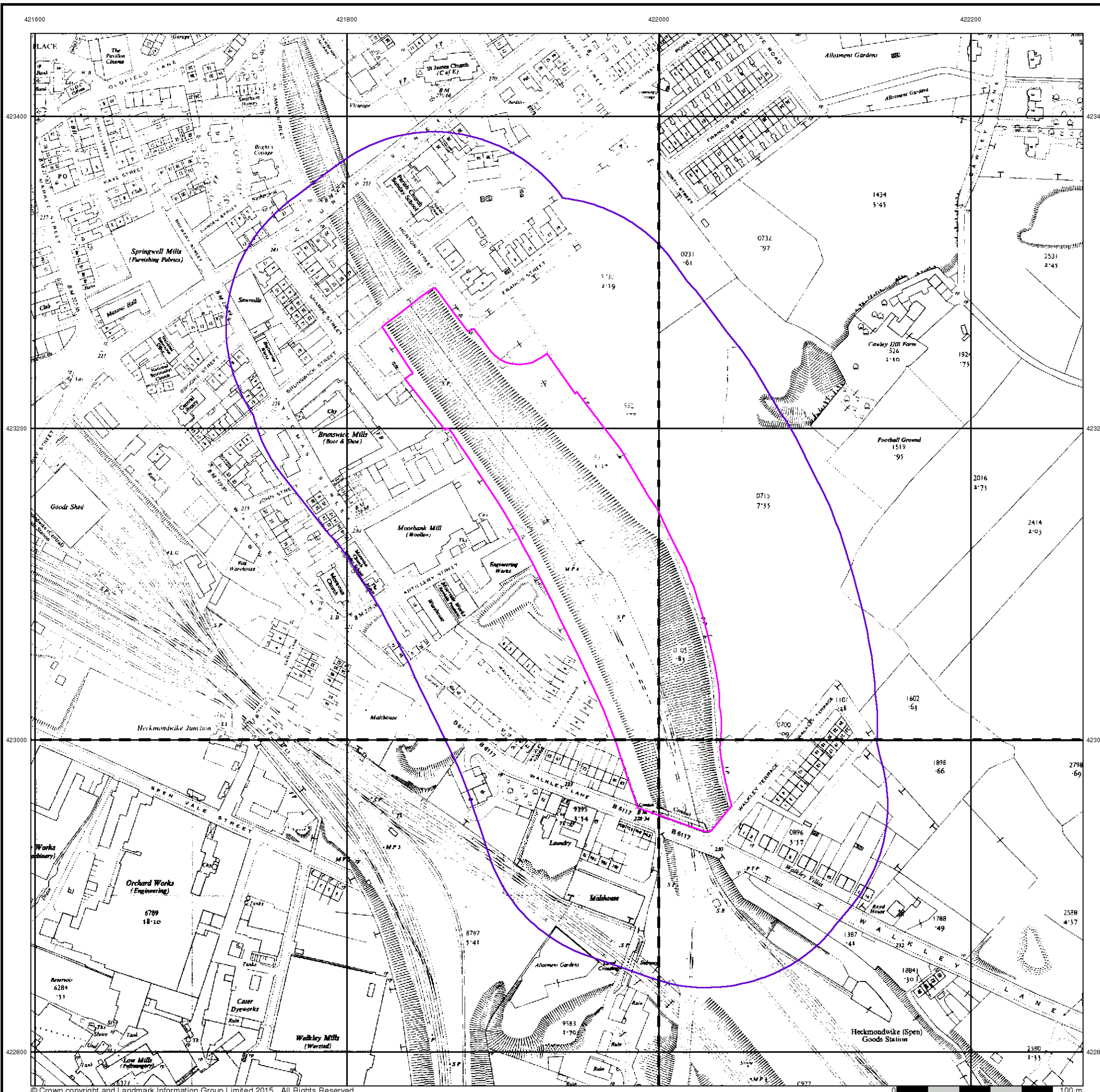

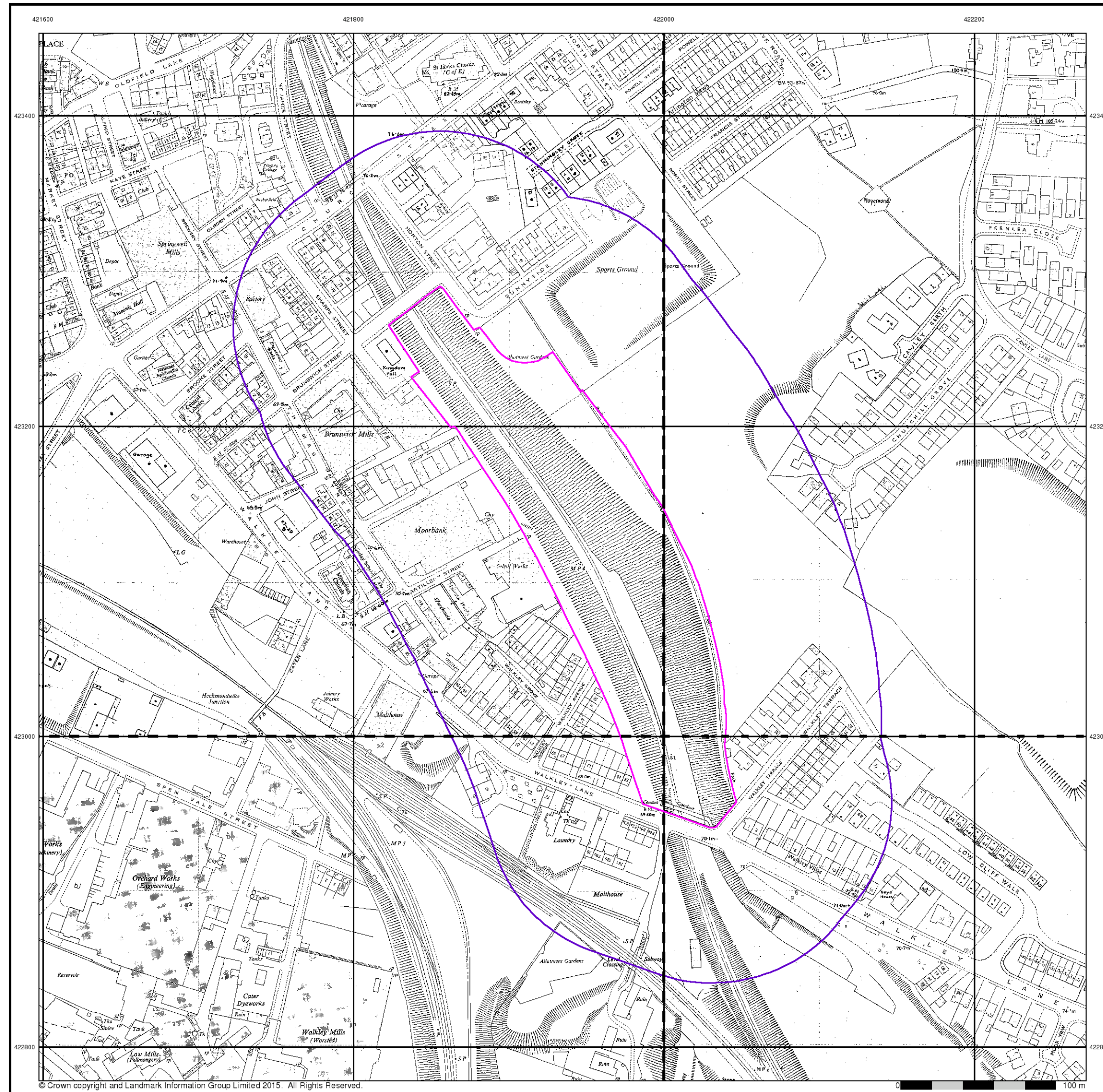

ARP GEOTECHNICAL LIMITED
CHARTERED CONSULTING ENGINEERS

Additional SIMs

Published 1956 - 1988

Source map scale - 1:1,250

The SIM cards (Ordnance Survey's 'Survey of Information on Microfilm') are further, minor editions of mapping which were produced and published in between the main editions as an area was updated. They date from 1947 to 1994, and contain detailed information on buildings, roads and land-use. These maps were produced at both 1:2,500 and 1:1,250 scales.

Map Name(s) and Date(s)

SE2123SE 1982 1:1,250	SE2223SW 1988 1:1,250
SE2122NE 1956 1:1,250	SE2222NW 1979 1:1,250

Historical Map - Segment A13

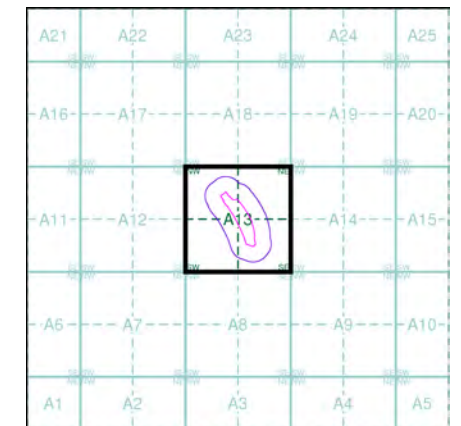

Order Details

Order Number: 125293094_1_1
 Customer Ref: YKS/01
 National Grid Reference: 421940, 423120
 Slice: A
 Site Area (Ha): 2.79
 Search Buffer (m): 100

Site Details

7, Sunnyside, HECKMONDWIKE, WF16 0LN



Tel: 0844 844 9952
 Fax: 0844 844 9951
 Web: www.envirocheck.co.uk

421600

421800

422000

422200

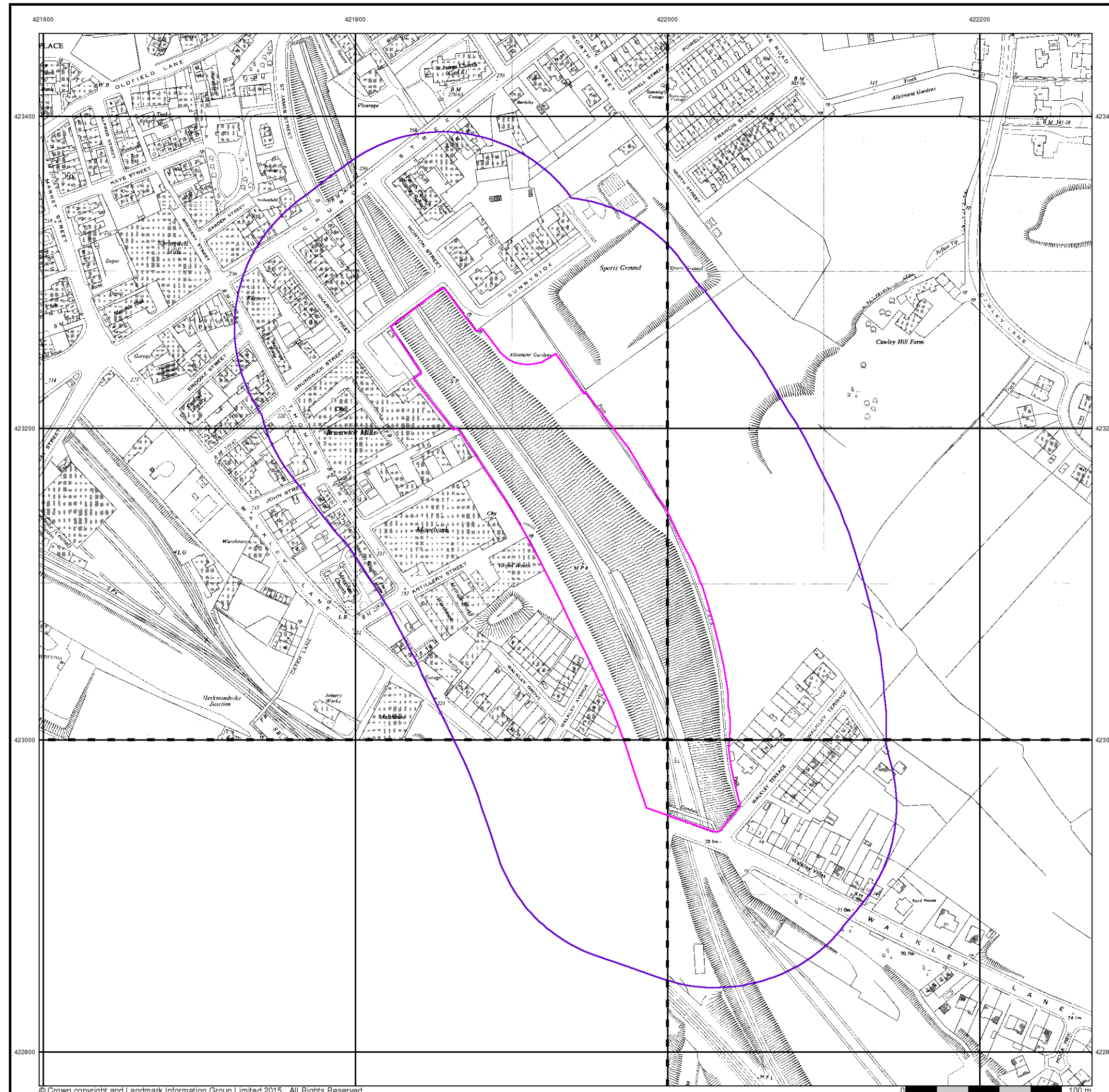

ARP GEOTECHNICAL LIMITED
CHARTERED CONSULTING ENGINEERS

Ordnance Survey Plan
Published 1967 - 1973
Source map scale - 1:1,250

The historical maps shown were reproduced from maps predominantly held at the scale adopted for England, Wales and Scotland in the 1840's. In 1854 the 1:2,500 scale was adopted for mapping urban areas and by 1896 it covered the whole of what were considered to be the cultivated parts of Great Britain. The published date given below is often some years later than the surveyed date. Before 1938, all OS maps were based on the Cassini Projection, with independent surveys of a single county or group of counties, giving rise to significant inaccuracies in outlying areas.

Map Name(s) and Date(s)

SE2123SE 1967 1:1,250	SE2223SW 1968 1:1,250
	SE2222NW 1973 1:1,250

Historical Map - Segment A13

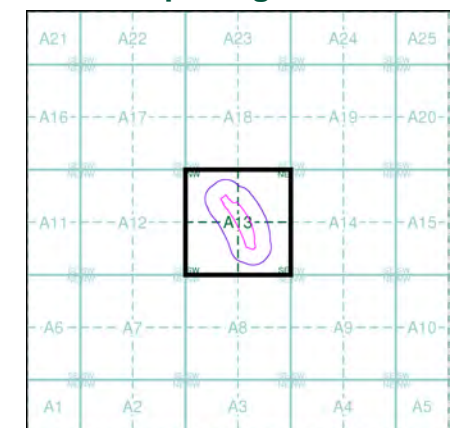

Order Details

Order Number: 125293094_1_1
 Customer Ref: YKS/01
 National Grid Reference: 421940, 423120
 Slice: A
 Site Area (Ha): 2.79
 Search Buffer (m): 100

Site Details

7, Sunnyside, HECKMONDWIKE, WF16 0LN



Tel: 0844 844 9952
 Fax: 0844 844 9951
 Web: www.envirocheck.co.uk

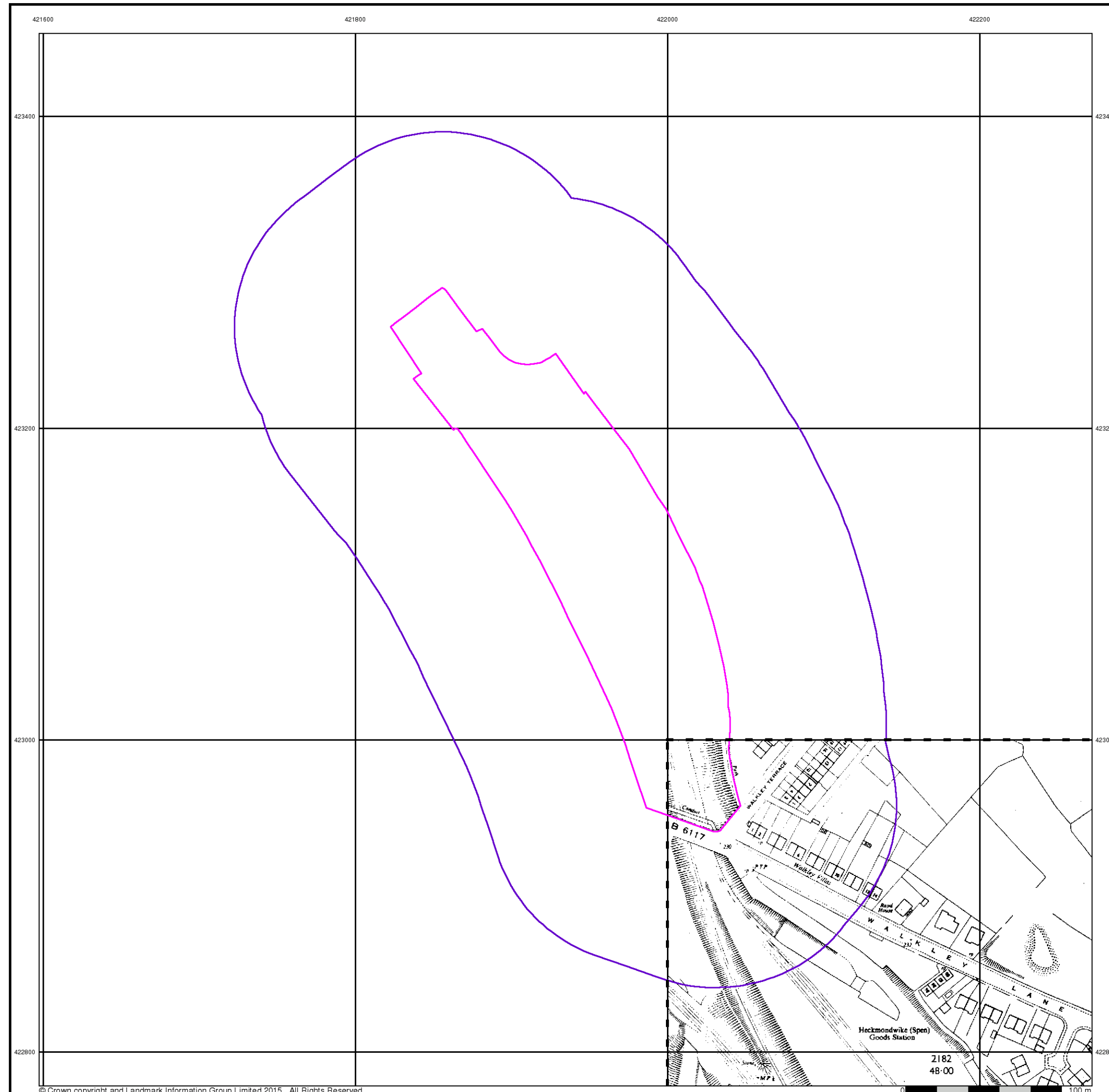

ARP GEOTECHNICAL LIMITED
CHARTERED CONSULTING ENGINEERS

Ordnance Survey Plan

Published 1971

Source map scale - 1:2,500

The historical maps shown were reproduced from maps predominantly held at the scale adopted for England, Wales and Scotland in the 1840's. In 1854 the 1:2,500 scale was adopted for mapping urban areas and by 1896 it covered the whole of what were considered to be the cultivated parts of Great Britain. The published date given below is often some years later than the surveyed date. Before 1938, all OS maps were based on the Cassini Projection, with independent surveys of a single county or group of counties, giving rise to significant inaccuracies in outlying areas.

Map Name(s) and Date(s)

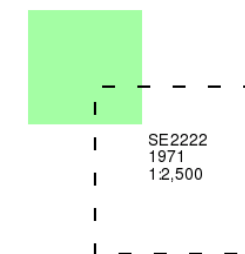

Historical Map - Segment A13

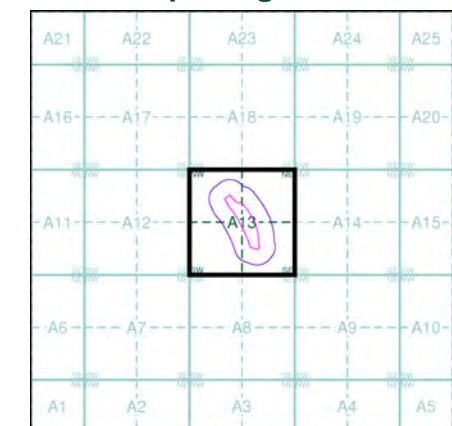

Order Details

Order Number: 125293094_1_1
 Customer Ref: YKS/01
 National Grid Reference: 421940, 423120
 Slice: A
 Site Area (Ha): 2.79
 Search Buffer (m): 100

Site Details

7, Sunnyside, HECKMONDWIKE, WF16 0LN



Tel: 0844 844 9952
 Fax: 0844 844 9951
 Web: www.envirocheck.co.uk



ARP GEOTECHNICAL LIMITED
CHARTERED CONSULTING ENGINEERS

Ordnance Survey Plan

Published 1974

Source map scale - 1:1,250

The historical maps shown were reproduced from maps predominantly held at the scale adopted for England, Wales and Scotland in the 1840's. In 1854 the 1:2,500 scale was adopted for mapping urban areas and by 1896 it covered the whole of what were considered to be the cultivated parts of Great Britain. The published date given below is often some years later than the surveyed date. Before 1938, all OS maps were based on the Cassini Projection, with independent surveys of a single county or group of counties, giving rise to significant inaccuracies in outlying areas.

Map Name(s) and Date(s)

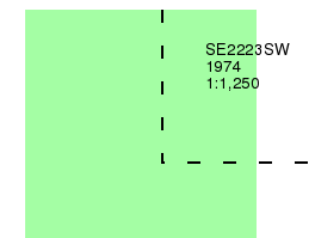

Historical Map - Segment A13

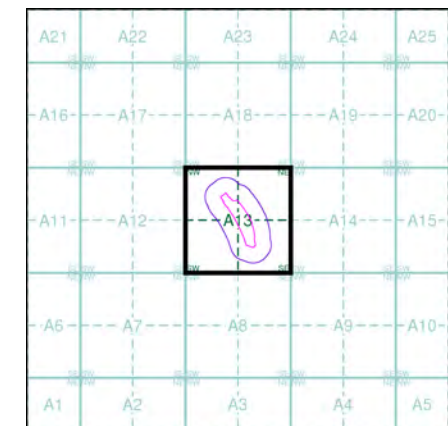

Order Details

Order Number: 125293094_1_1
 Customer Ref: YKS/01
 National Grid Reference: 421940, 423120
 Slice: A
 Site Area (Ha): 2.79
 Search Buffer (m): 100

Site Details

7, Sunnyside, HECKMONDWIKE, WF16 0LN



Tel: 0844 844 9952
 Fax: 0844 844 9951
 Web: www.envirocheck.co.uk





ARP GEOTECHNICAL LIMITED
CHARTERED CONSULTING ENGINEERS

Additional SIMs
Published 1987 - 1990
Source map scale - 1:1,250

The SIM cards (Ordnance Survey's 'Survey of Information on Microfilm') are further, minor editions of mapping which were produced and published in between the main editions as an area was updated. They date from 1947 to 1994, and contain detailed information on buildings, roads and land-use. These maps were produced at both 1:2,500 and 1:1,250 scales.

Map Name(s) and Date(s)

SE2123SE	1990	1:1,250
SE2122NE	1987	1:1,250
SE2222NW	1988	1:1,250

Historical Map - Segment A13

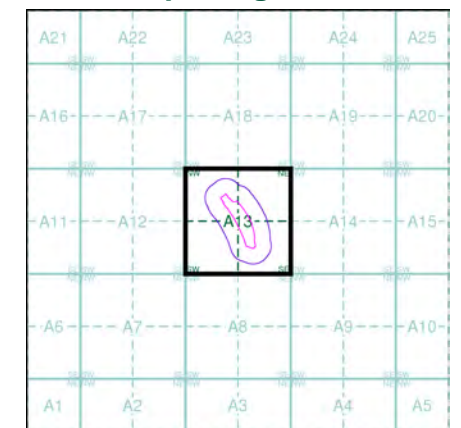

Order Details
 Order Number: 125293094_1_1
 Customer Ref: YKS/01
 National Grid Reference: 421940, 423120
 Slice: A
 Site Area (Ha): 2.79
 Search Buffer (m): 100

Site Details
 7, Sunnyside, HECKMONDWIKE, WF16 0LN



Tel: 0844 844 9952
 Fax: 0844 844 9951
 Web: www.envirocheck.co.uk



ARP GEOTECHNICAL LIMITED
CHARTERED CONSULTING ENGINEERS

Large-Scale National Grid Data

Published 1992

Source map scale - 1:1,250

'Large Scale National Grid Data' superseded SIM cards (Ordnance Survey's 'Survey of Information on Microfilm') in 1992, and continued to be produced until 1999. These maps were the fore-runners of digital mapping and so provide detailed information on houses and roads, but tend to show less topographic features such as vegetation. These maps were produced at both 1:2,500 and 1:1,250 scales.

Map Name(s) and Date(s)

SE2123SE 1992 1:1,250	SE2223SW 1992 1:1,250
SE2122NE 1992 1:1,250	SE2222NW 1992 1:1,250

Historical Map - Segment A13

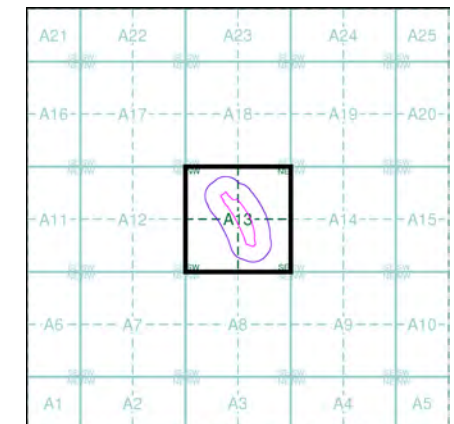

Order Details

Order Number: 125293094_1_1
 Customer Ref: YKS/01
 National Grid Reference: 421940, 423120
 Slice: A
 Site Area (Ha): 2.79
 Search Buffer (m): 100

Site Details

7, Sunnyside, HECKMONDWIKE, WF16 0LN

Landmark
 INFORMATION GROUP

Tel: 0844 844 9952
 Fax: 0844 844 9951
 Web: www.envirocheck.co.uk

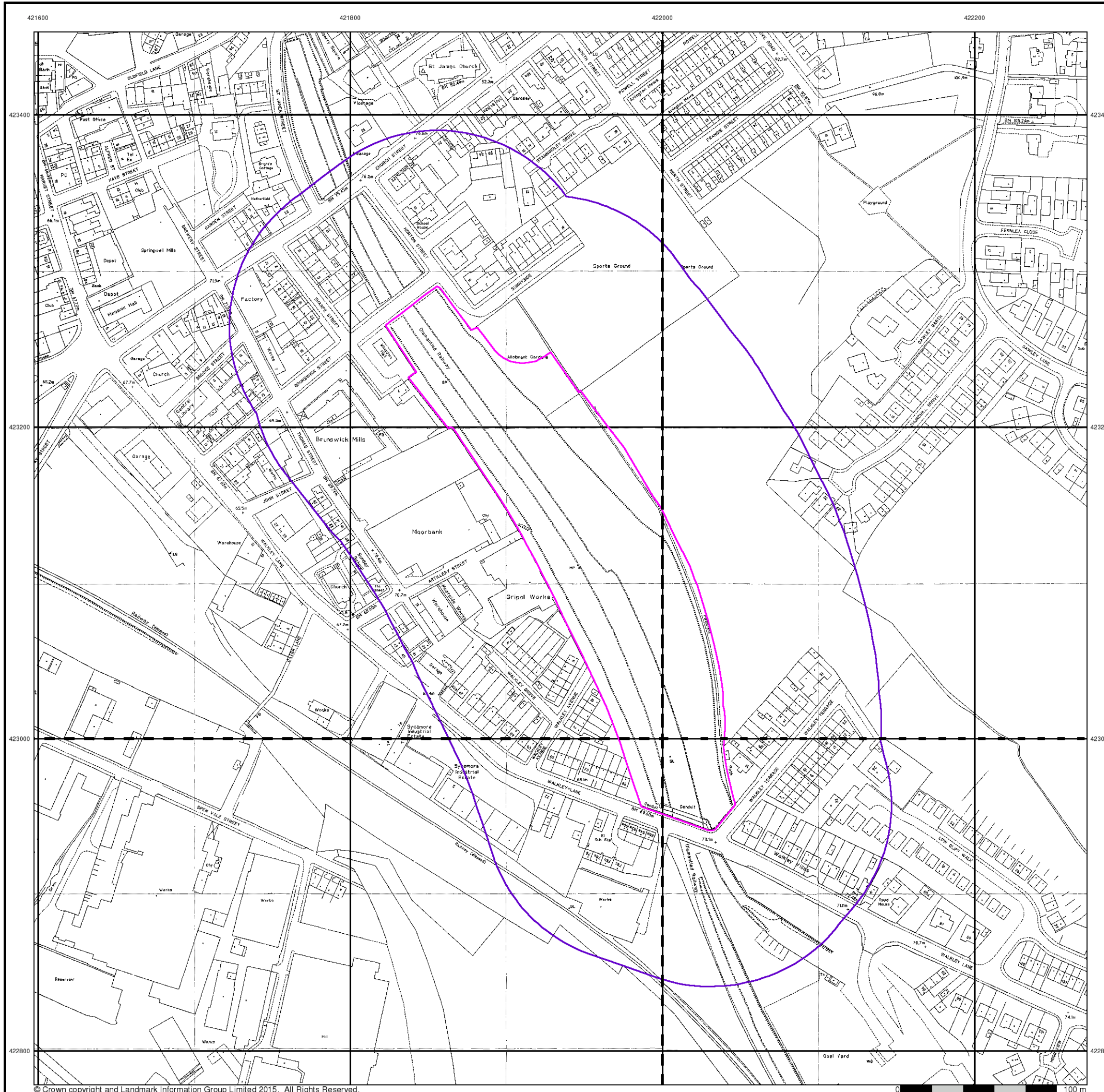

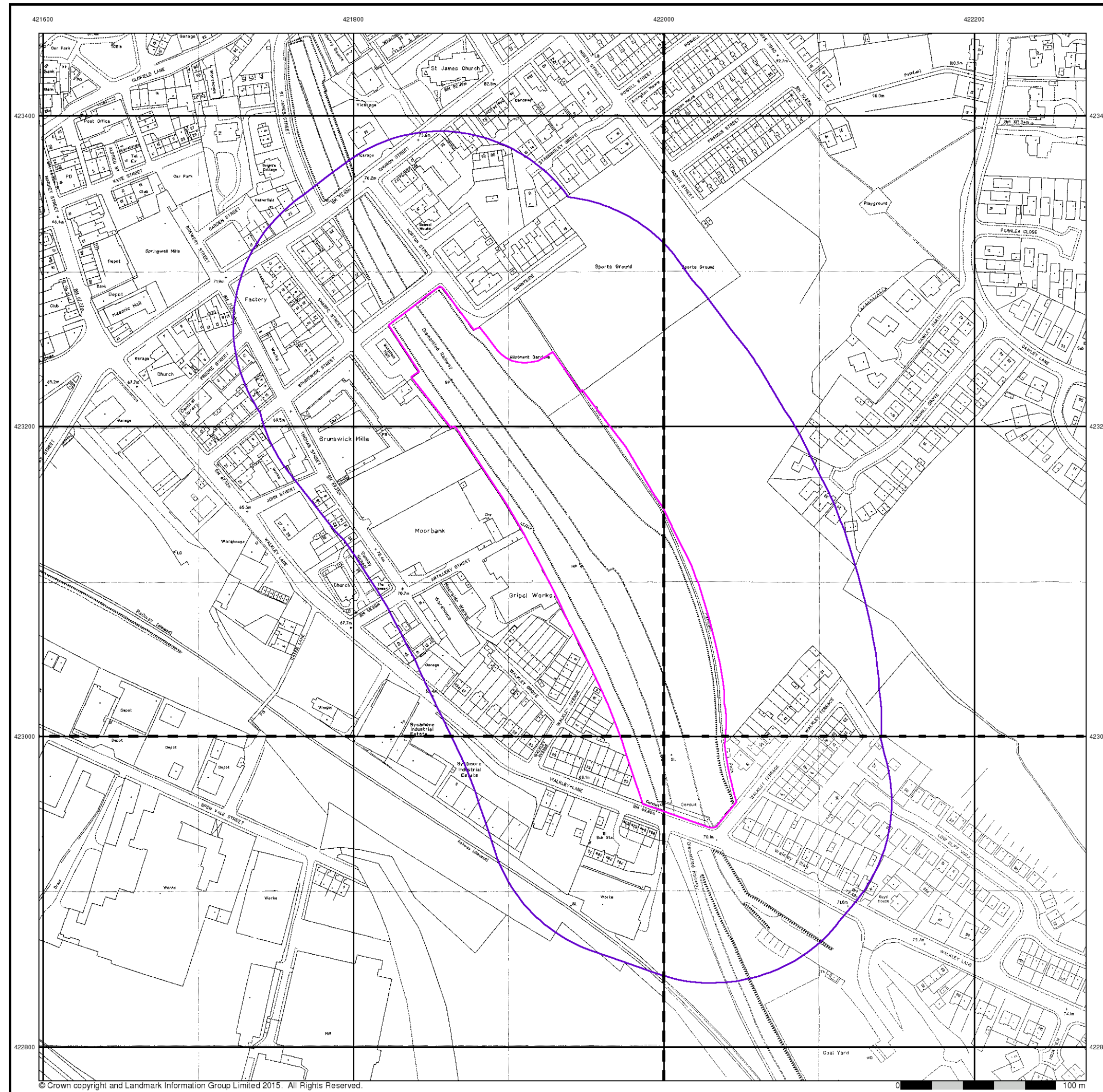

ARP GEOTECHNICAL LIMITED
CHARTERED CONSULTING ENGINEERS

Large-Scale National Grid Data
Published 1993 - 1995
Source map scale - 1:1,250

'Large Scale National Grid Data' superseded SIM cards (Ordnance Survey's 'Survey of Information on Microfilm') in 1992, and continued to be produced until 1999. These maps were the fore-runners of digital mapping and so provide detailed information on houses and roads, but tend to show less topographic features such as vegetation. These maps were produced at both 1:2,500 and 1:1,250 scales.

Map Name(s) and Date(s)

SE2123SE 1993 1:1,250	SE2223SW 1993 1:1,250
SE2122NE 1993 1:1,250	SE2222NW 1995 1:1,250

Historical Map - Segment A13

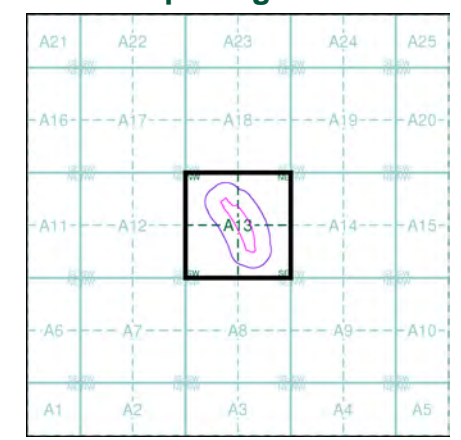

Order Details

Order Number: 125293094_1_1
 Customer Ref: YKS/01
 National Grid Reference: 421940, 423120
 Slice: A
 Site Area (Ha): 2.79
 Search Buffer (m): 100

Site Details

7, Sunnyside, HECKMONDWIKE, WF16 0LN



Tel: 0844 844 9952
 Fax: 0844 844 9951
 Web: www.envirocheck.co.uk



ARP GEOTECHNICAL LIMITED
CHARTERED CONSULTING ENGINEERS

Large-Scale National Grid Data

Published 1994

Source map scale - 1:1,250

'Large Scale National Grid Data' superseded SIM cards (Ordnance Survey's 'Survey of Information on Microfilm') in 1992, and continued to be produced until 1999. These maps were the fore-runners of digital mapping and so provide detailed information on houses and roads, but tend to show less topographic features such as vegetation. These maps were produced at both 1:2,500 and 1:1,250 scales.

Map Name(s) and Date(s)

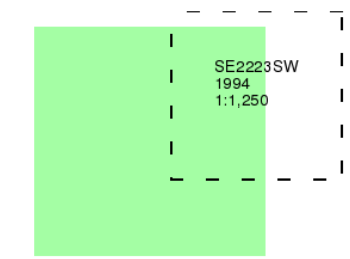

Historical Map - Segment A13

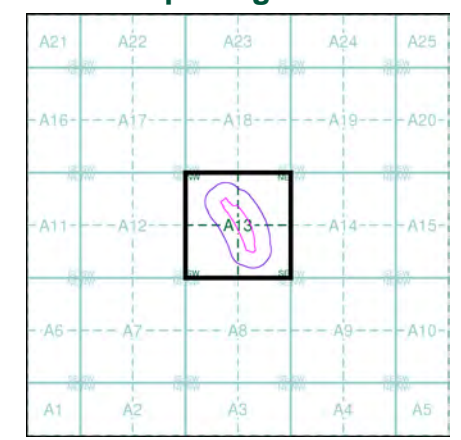

Order Details

Order Number: 125293094_1_1
 Customer Ref: YKS/01
 National Grid Reference: 421940, 423120
 Slice: A
 Site Area (Ha): 2.79
 Search Buffer (m): 100

Site Details

7, Sunnyside, HECKMONDWIKE, WF16 0LN



Tel: 0844 844 9952
 Fax: 0844 844 9951
 Web: www.envirocheck.co.uk

Historical Mapping Legends

Ordnance Survey County Series 1:10,560

	Gravel Pit		Sand Pit		Other Pits
	Quarry		Shingle		Orchard
	Osiers		Reeds		Marsh
	Mixed Wood		Deciduous		Brushwood
	Fir		Furze		Rough Pasture
	Arrow denotes flow of water		Trigonometrical Station		
	Site of Antiquities		Bench Mark		
	Pump, Guide Post, Signal Post		Well, Spring, Boundary Post		
	-285 Surface Level				
	Sketched Contour		Instrumental Contour		
	Main Roads		Minor Roads		
	Sunken Road		Raised Road		
	Road over Railway		Railway over River		
	Railway over Road		Level Crossing		
	Road over River or Canal		Road over Stream		
	Road over Stream				
	County Boundary (Geographical)				
	County & Civil Parish Boundary				
	Administrative County & Civil Parish Boundary				
	County Borough Boundary (England)				
	County Burgh Boundary (Scotland)				
	Rural District Boundary				
	Civil Parish Boundary				

Ordnance Survey Plan 1:10,000

	Chalk Pit, Clay Pit or Quarry		Gravel Pit
	Sand Pit		Disused Pit or Quarry
	Refuse or Slag Heap		Lake, Loch or Pond
	Dunes		Boulders
	Coniferous Trees		Non-Coniferous Trees
	Orchard		Scrub
	Coppice		Bracken
	Heath		Rough Grassland
	Marsh		Reeds
	Saltings		
	Building		Glasshouse
	Sloping Masonry		Pylon
	Electricity Transmission Line		Pole
	Cutting		Embankment
	Standard Gauge Multiple Track		Standard Gauge Single Track
	Siding, Tramway or Mineral Line		Narrow Gauge
	Geographical County		
	Administrative County, County Borough or County of City		
	Municipal Borough, Urban or Rural District, Burgh or District Council		
	Borough, Burgh or County Constituency Shown only when not coincident with other boundaries		
	Civil Parish Shown alternately when coincidence of boundaries occurs		
	BP, BS Boundary Post or Stone		Pol Sta Police Station
	Ch Church		PO Post Office
	CH Club House		PC Public Convenience
	F E Sta Fire Engine Station		PH Public House
	FB Foot Bridge		SB Signal Box
	Fn Fountain		Spr Spring
	GP Guide Post		TCB Telephone Call Box
	MP Mile Post		TCP Telephone Call Post
	MS Mile Stone		W Well

1:10,000 Raster Mapping

	Gravel Pit		Refuse tip or slag heap
	Rock		Rock (scattered)
	Boulders		Boulders (scattered)
	Shingle		Mud
	Sand		Sand Pit
	Slopes		Top of cliff
	General detail		Underground detail
	Overhead detail		Narrow gauge railway
	Multi-track railway		Single track railway
	County boundary (England only)		Civil, parish or community boundary
	District, Unitary, Metropolitan, London Borough boundary		Constituency boundary
	Area of wooded vegetation		Non-coniferous trees
	Non-coniferous trees (scattered)		Coniferous trees
	Coniferous trees (scattered)		Positioned tree
	Orchard		Coppice or Osiers
	Rough Grassland		Heath
	Scrub		Marsh, Salt Marsh or Reeds
	Water feature		Flow arrows
	MHW(S) Mean high water (springs)		MLW(S) Mean low water (springs)
	Telephone line (where shown)		Electricity transmission line (with poles)
	Bench mark (where shown)		Triangulation station
	Point feature (e.g. Guide Post or Mile Stone)		Pylon, flare stack or lighting tower
	Site of (antiquity)		Glasshouse
	General Building		Important Building



ARP GEOTECHNICAL LIMITED
CHARTERED CONSULTING ENGINEERS

Historical Mapping & Photography included:

Mapping Type	Scale	Date	Pg
Yorkshire	1:10,560	1854 - 1855	2
Yorkshire	1:10,560	1894 - 1895	3
Yorkshire	1:10,560	1908	4
Yorkshire	1:10,560	1931	5
Yorkshire	1:10,560	1938	6
Yorkshire	1:10,560	1938 - 1948	7
Yorkshire	1:10,560	1948	8
Ordnance Survey Plan	1:10,000	1955	9
Ordnance Survey Plan	1:10,000	1967	10
Ordnance Survey Plan	1:10,000	1974	11
Ordnance Survey Plan	1:10,000	1983	12
Ordnance Survey Plan	1:10,000	1989	13
10K Raster Mapping	1:10,000	2000	14
Street View	Variable		15

Historical Map - Slice A

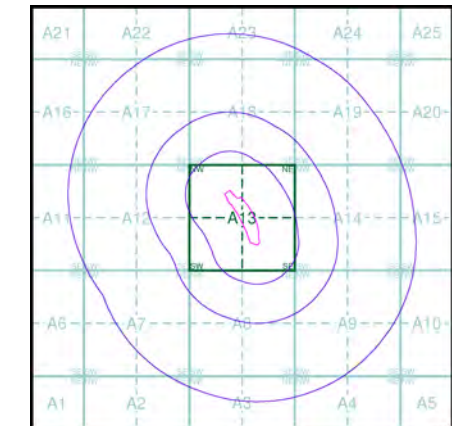

Order Details

Order Number: 125293094_1_1
Customer Ref: YKS/01
National Grid Reference: 421940, 423120
Slice: A
Site Area (Ha): 2.79
Search Buffer (m): 1000

Site Details

7, Sunnyside, HECKMONDWIKE, WF16 0LN

Landmark
INFORMATION GROUP

Tel: 0844 844 9952
Fax: 0844 844 9951
Web: www.envirocheck.co.uk



Yorkshire

Published 1854 - 1855

Source map scale - 1:10,560

The historical maps shown were reproduced from maps predominantly held at the scale adopted for England, Wales and Scotland in the 1840's. In 1854 the 1:2,500 scale was adopted for mapping urban areas; these maps were used to update the 1:10,560 maps. The published date given therefore is often some years later than the surveyed date. Before 1938, all OS maps were based on the Cassini Projection, with independent surveys of a single county or group of counties, giving rise to significant inaccuracies in outlying areas. In the late 1940's, a Provisional Edition was produced, which updated the 1:10,560 mapping from a number of sources. The maps appear unfinished - with all military camps and other strategic sites removed. These maps were initially overprinted with the National Grid. In 1970, the first 1:10,000 maps were produced using the Transverse Mercator Projection. The revision process continued until recently, with new editions appearing every 10 years or so for urban areas.

Map Name(s) and Date(s)

23200	1854	1:10,560
24700	1855	1:10,560

Historical Map - Slice A

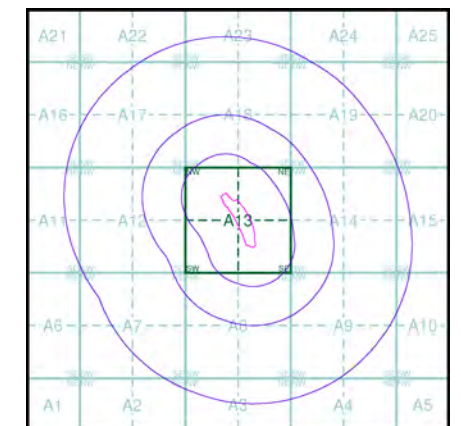

Order Details

Order Number: 125293094_1_1
 Customer Ref: YKS/01
 National Grid Reference: 421940, 423120
 Slice: A
 Site Area (Ha): 2.79
 Search Buffer (m): 1000

Site Details

7, Sunnyside, HECKMONDWIKE, WF16 0LN

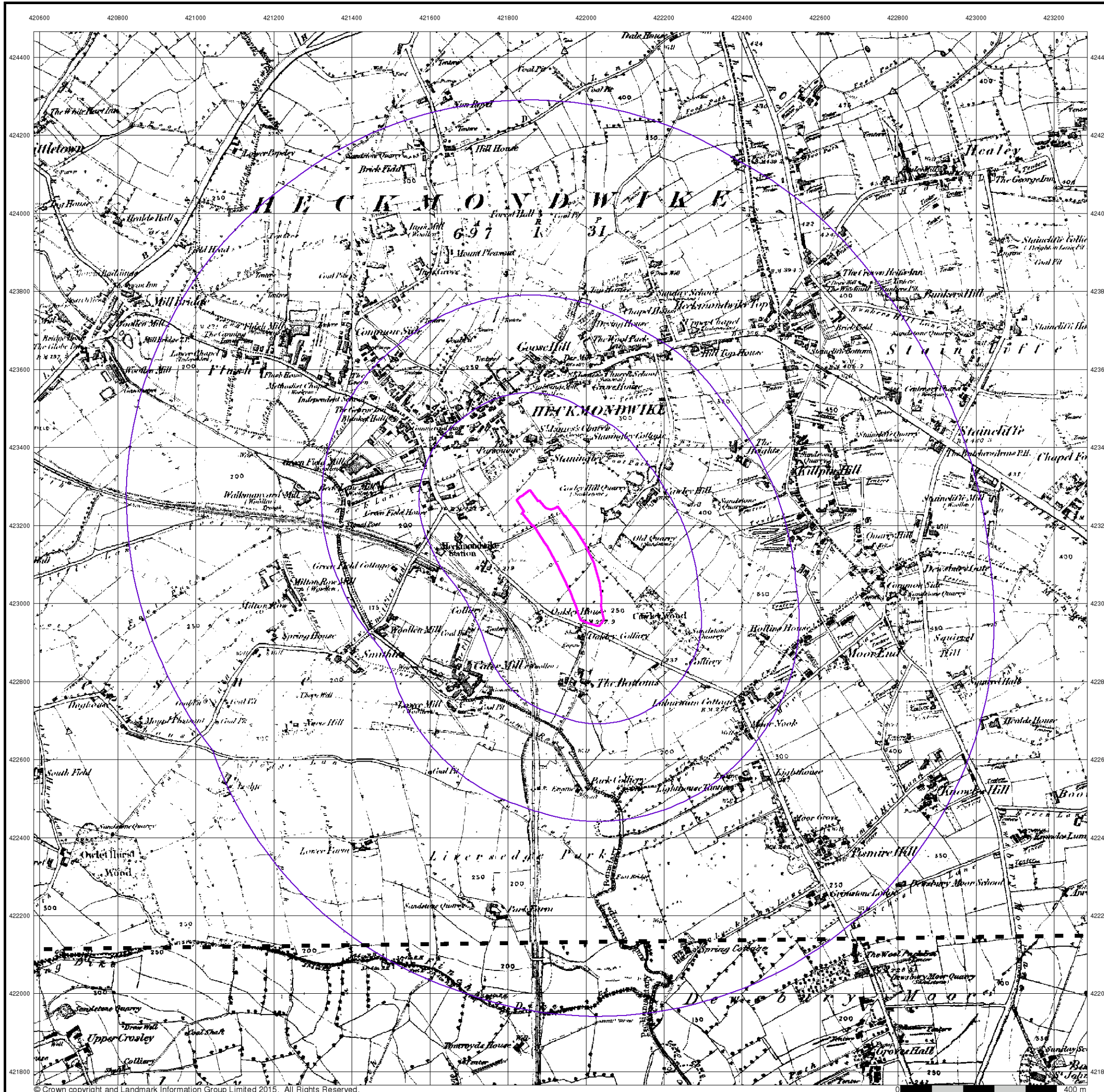



Yorkshire

Published 1894 - 1895

Source map scale - 1:10,560

The historical maps shown were reproduced from maps predominantly held at the scale adopted for England, Wales and Scotland in the 1840's. In 1854 the 1:2,500 scale was adopted for mapping urban areas; these maps were used to update the 1:10,560 maps. The published date given therefore is often some years later than the surveyed date. Before 1938, all OS maps were based on the Cassini Projection, with independent surveys of a single county or group of counties, giving rise to significant inaccuracies in outlying areas. In the late 1940's, a Provisional Edition was produced, which updated the 1:10,560 mapping from a number of sources. The maps appear unfinished - with all military camps and other strategic sites removed. These maps were initially overprinted with the National Grid. In 1970, the first 1:10,000 maps were produced using the Transverse Mercator Projection. The revision process continued until recently, with new editions appearing every 10 years or so for urban areas.

Map Name(s) and Date(s)

232SW 1894 1:10,560	232SE 1895 1:10,560
247NW 1894 1:10,560	247NE 1894 1:10,560

Historical Map - Slice A

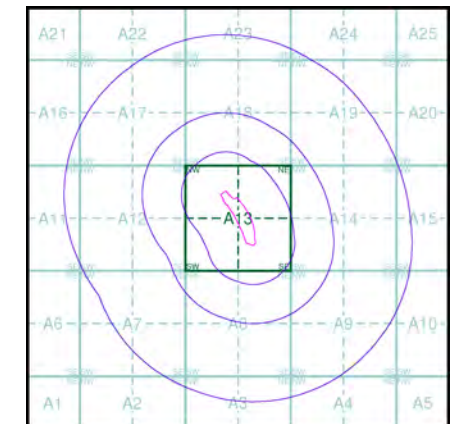

Order Details

Order Number: 125293094_1_1
Customer Ref: YKS/01
National Grid Reference: 421940, 423120
Slice: A
Site Area (Ha): 2.79
Search Buffer (m): 1000

Site Details

7, Sunnyside, HECKMONDWIKE, WF16 0LN

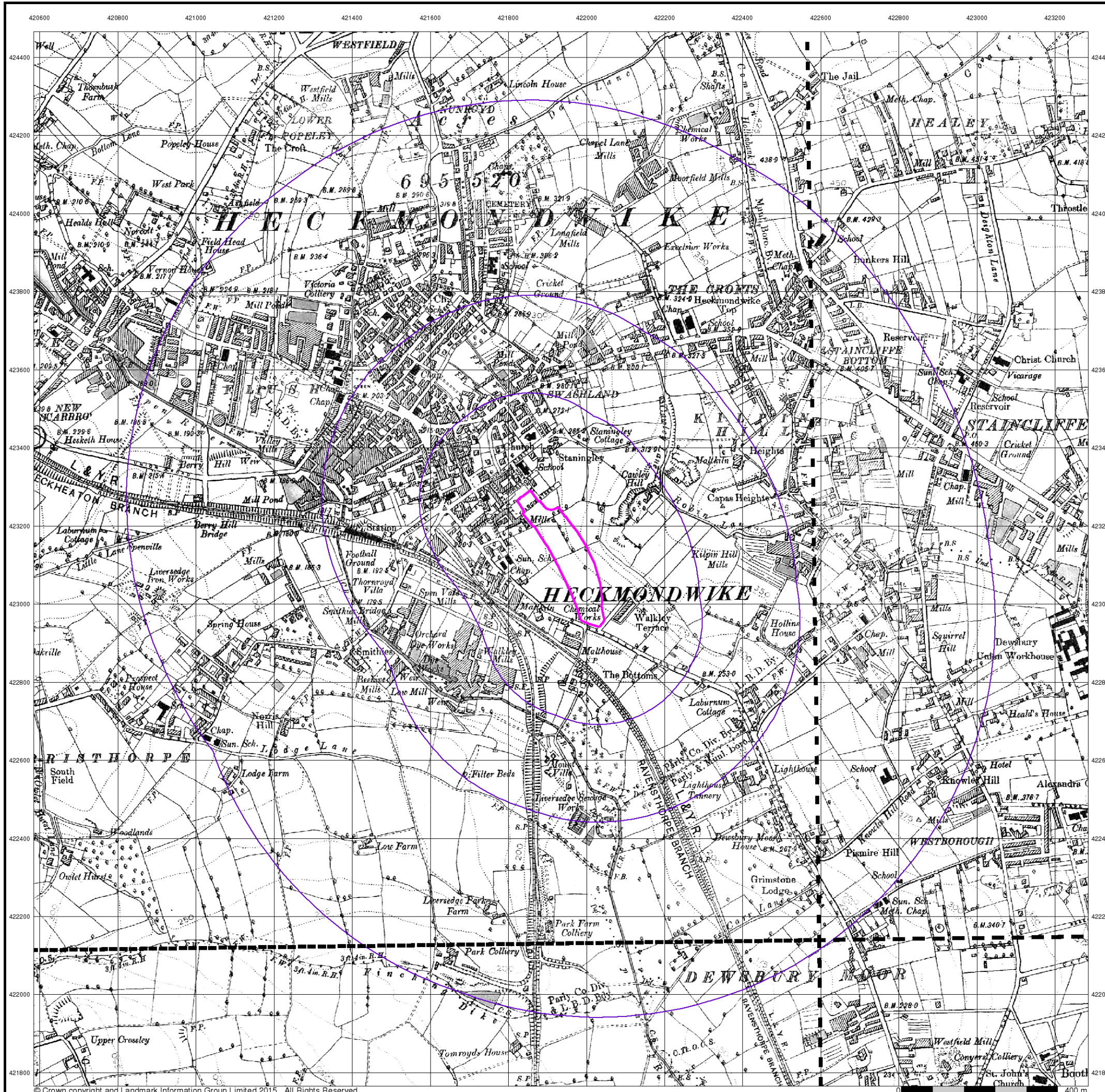



Yorkshire

Published 1908

Source map scale - 1:10,560

The historical maps shown were reproduced from maps predominantly held at the scale adopted for England, Wales and Scotland in the 1840's. In 1854 the 1:2,500 scale was adopted for mapping urban areas; these maps were used to update the 1:10,560 maps. The published date given therefore is often some years later than the surveyed date. Before 1938, all OS maps were based on the Cassini Projection, with independent surveys of a single county or group of counties, giving rise to significant inaccuracies in outlying areas. In the late 1940's, a Provisional Edition was produced, which updated the 1:10,560 mapping from a number of sources. The maps appear unfinished - with all military camps and other strategic sites removed. These maps were initially overprinted with the National Grid. In 1970, the first 1:10,000 maps were produced using the Transverse Mercator Projection. The revision process continued until recently, with new editions appearing every 10 years or so for urban areas.

Map Name(s) and Date(s)

232SW 1908 1:10,560	232SE 1908 1:10,560
247NW 1908 1:10,560	247NE 1908 1:10,560

Historical Map - Slice A

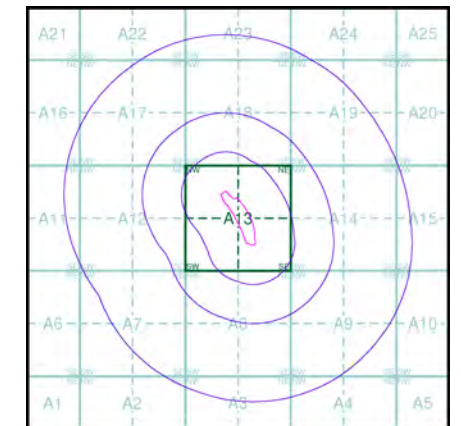

Order Details

Order Number: 125293094_1_1
 Customer Ref: YKS/01
 National Grid Reference: 421940, 423120
 Slice: A
 Site Area (Ha): 2.79
 Search Buffer (m): 1000

Site Details

7, Sunnyside, HECKMONDWIKE, WF16 0LN

