



Yorkshire

Published 1931

Source map scale - 1:10,560

The historical maps shown were reproduced from maps predominantly held at the scale adopted for England, Wales and Scotland in the 1840's. In 1854 the 1:2,500 scale was adopted for mapping urban areas; these maps were used to update the 1:10,560 maps. The published date given therefore is often some years later than the surveyed date. Before 1938, all OS maps were based on the Cassini Projection, with independent surveys of a single county or group of counties, giving rise to significant inaccuracies in outlying areas. In the late 1940's, a Provisional Edition was produced, which updated the 1:10,560 mapping from a number of sources. The maps appear unfinished - with all military camps and other strategic sites removed. These maps were initially overprinted with the National Grid. In 1970, the first 1:10,000 maps were produced using the Transverse Mercator Projection. The revision process continued until recently, with new editions appearing every 10 years or so for urban areas.

Map Name(s) and Date(s)

| | |
|---------------------------|---------------------------|
| 232SW 1931 1:10,560 | 232SE 1931 1:10,560 |
| 247NW 1931 1:10,560 | 247NE 1931 1:10,560 |

Historical Map - Slice A

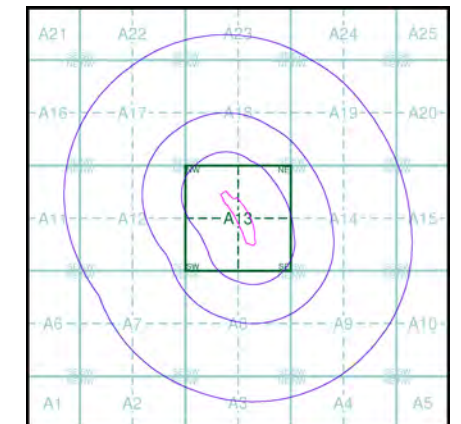

Order Details

Order Number: 125293094_1_1
Customer Ref: YKS/01
National Grid Reference: 421940, 423120
Slice: A
Site Area (Ha): 2.79
Search Buffer (m): 1000

Site Details

7, Sunnyside, HECKMONDWIKE, WF16 0LN

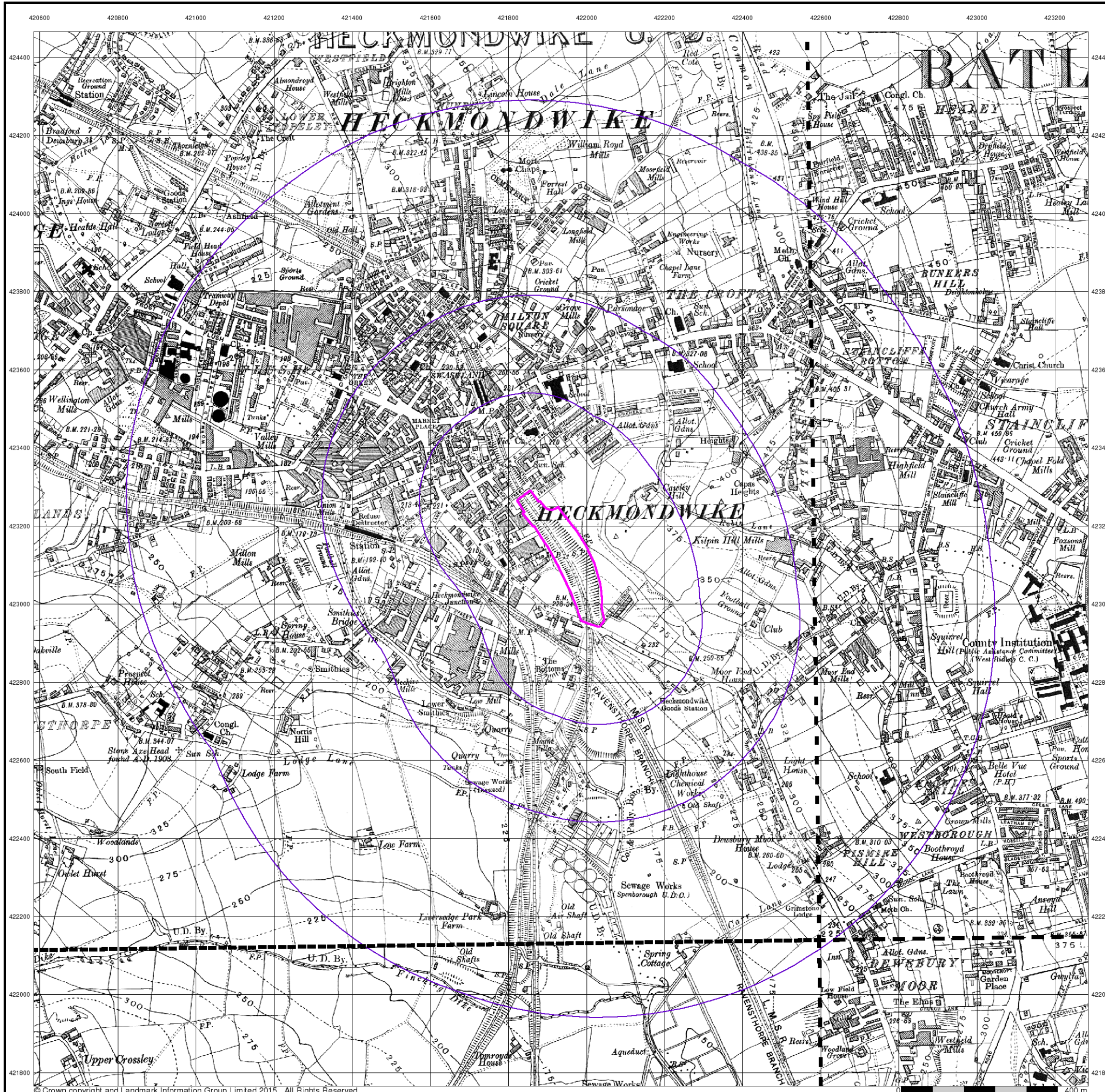



Yorkshire

Published 1938

Source map scale - 1:10,560

The historical maps shown were reproduced from maps predominantly held at the scale adopted for England, Wales and Scotland in the 1840's. In 1854 the 1:2,500 scale was adopted for mapping urban areas; these maps were used to update the 1:10,560 maps. The published date given therefore is often some years later than the surveyed date. Before 1938, all OS maps were based on the Cassini Projection, with independent surveys of a single county or group of counties, giving rise to significant inaccuracies in outlying areas. In the late 1940's, a Provisional Edition was produced, which updated the 1:10,560 mapping from a number of sources. The maps appear unfinished - with all military camps and other strategic sites removed. These maps were initially overprinted with the National Grid. In 1970, the first 1:10,000 maps were produced using the Transverse Mercator Projection. The revision process continued until recently, with new editions appearing every 10 years or so for urban areas.

Map Name(s) and Date(s)

| | |
|---------------------------|---------------------------|
| 232SW 1938 1:10,560 | 232SE 1938 1:10,560 |
| 247NW 1938 1:10,560 | 247NE 1938 1:10,560 |

Historical Map - Slice A

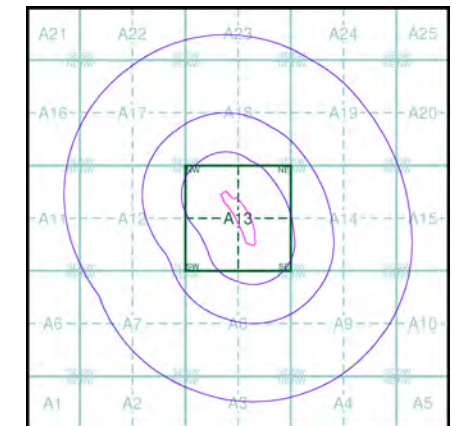

Order Details

Order Number: 125293094_1_1
Customer Ref: YKS/01
National Grid Reference: 421940, 423120
Slice: A
Site Area (Ha): 2.79
Search Buffer (m): 1000

Site Details

7, Sunnyside, HECKMONDWIKE, WF16 0LN

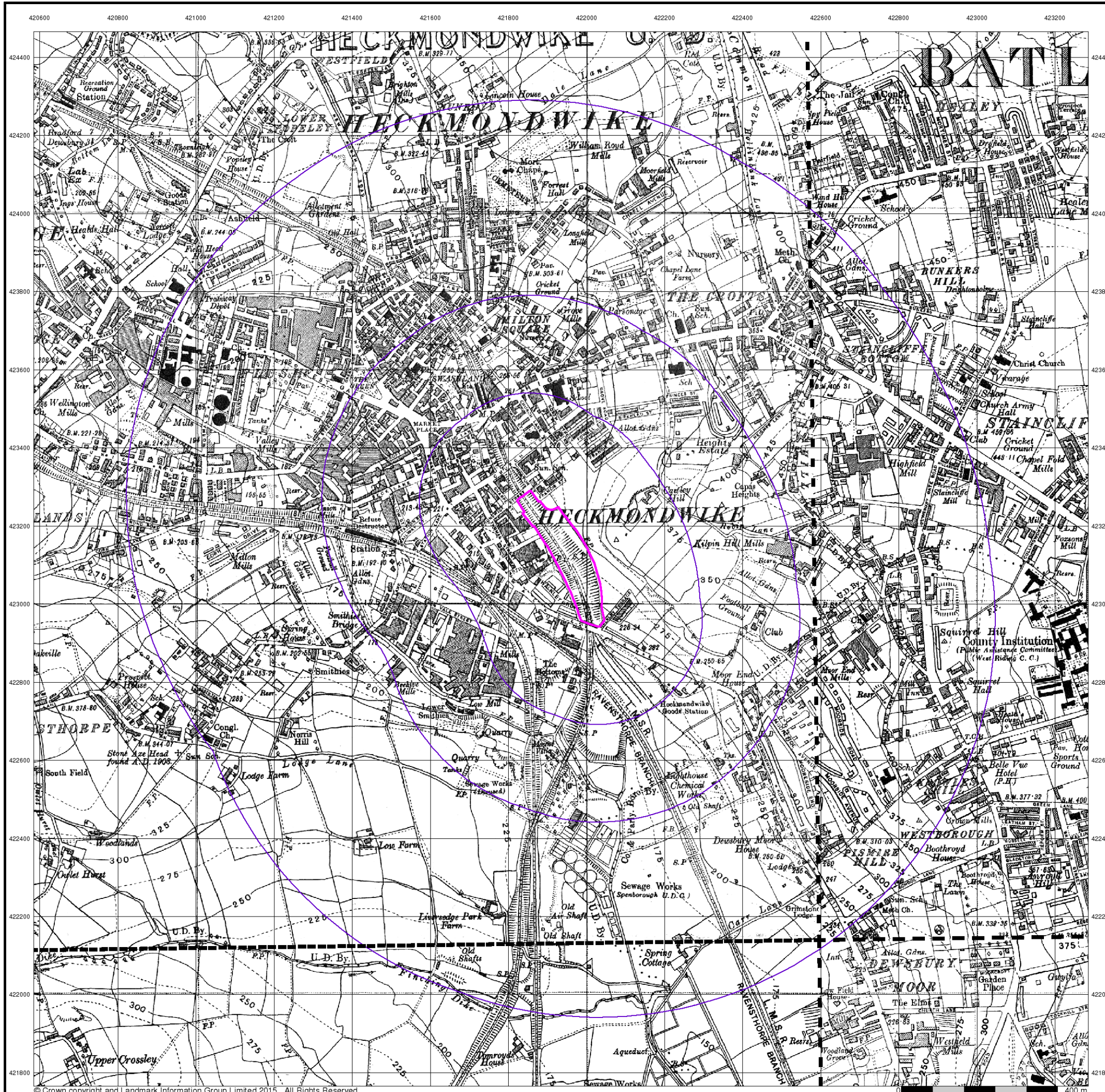



Yorkshire

Published 1938 - 1948

Source map scale - 1:10,560

The historical maps shown were reproduced from maps predominantly held at the scale adopted for England, Wales and Scotland in the 1840's. In 1854 the 1:2,500 scale was adopted for mapping urban areas; these maps were used to update the 1:10,560 maps. The published date given therefore is often some years later than the surveyed date. Before 1938, all OS maps were based on the Cassini Projection, with independent surveys of a single county or group of counties, giving rise to significant inaccuracies in outlying areas. In the late 1940's, a Provisional Edition was produced, which updated the 1:10,560 mapping from a number of sources. The maps appear unfinished - with all military camps and other strategic sites removed. These maps were initially overprinted with the National Grid. In 1970, the first 1:10,000 maps were produced using the Transverse Mercator Projection. The revision process continued until recently, with new editions appearing every 10 years or so for urban areas.

Map Name(s) and Date(s)

| | |
|---------------------------|---------------------------|
| 232SW 1938 1:10,560 | 232SE 1948 1:10,560 |
| 247NW 1948 1:10,560 | 247NE 1948 1:10,560 |

Historical Map - Slice A

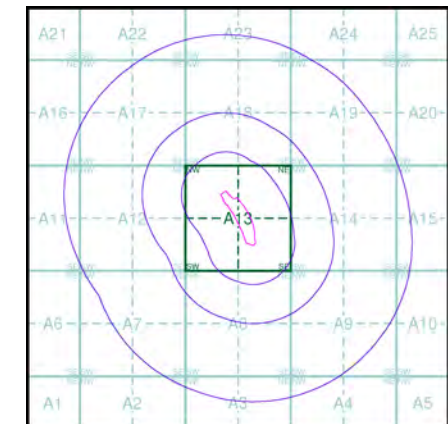

Order Details

Order Number: 125293094_1_1
Customer Ref: YKS/01
National Grid Reference: 421940, 423120
Slice: A
Site Area (Ha): 2.79
Search Buffer (m): 1000

Site Details

7, Sunnyside, HECKMONDWIKE, WF16 0LN

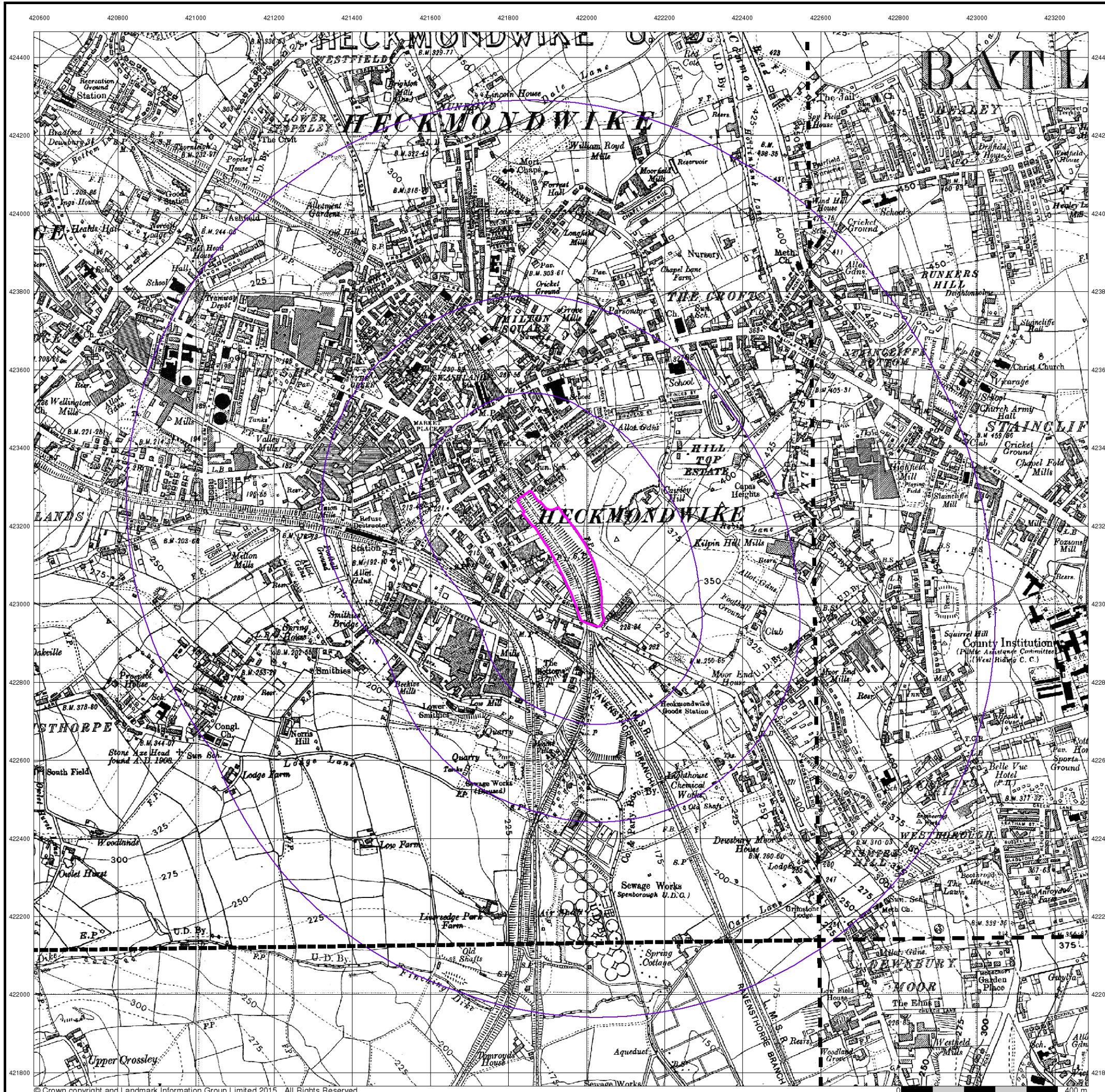



Yorkshire

Published 1948

Source map scale - 1:10,560

The historical maps shown were reproduced from maps predominantly held at the scale adopted for England, Wales and Scotland in the 1840's. In 1854 the 1:2,500 scale was adopted for mapping urban areas; these maps were used to update the 1:10,560 maps. The published date given therefore is often some years later than the surveyed date. Before 1938, all OS maps were based on the Cassini Projection, with independent surveys of a single county or group of counties, giving rise to significant inaccuracies in outlying areas. In the late 1940's, a Provisional Edition was produced, which updated the 1:10,560 mapping from a number of sources. The maps appear unfinished - with all military camps and other strategic sites removed. These maps were initially overprinted with the National Grid. In 1970, the first 1:10,000 maps were produced using the Transverse Mercator Projection. The revision process continued until recently, with new editions appearing every 10 years or so for urban areas.

Map Name(s) and Date(s)

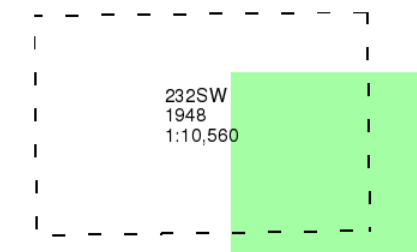

Historical Map - Slice A

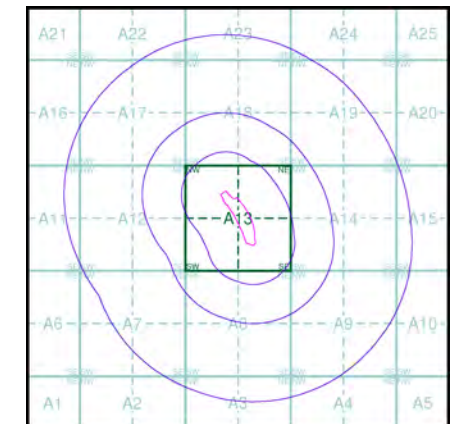

Order Details

Order Number: 125293094_1_1
 Customer Ref: YKS/01
 National Grid Reference: 421940, 423120
 Slice: A
 Site Area (Ha): 2.79
 Search Buffer (m): 1000

Site Details

7, Sunnyside, HECKMONDWIKE, WF16 0LN

