

FOOTPATH REINSTATEMENT DETAIL Scale 1:20

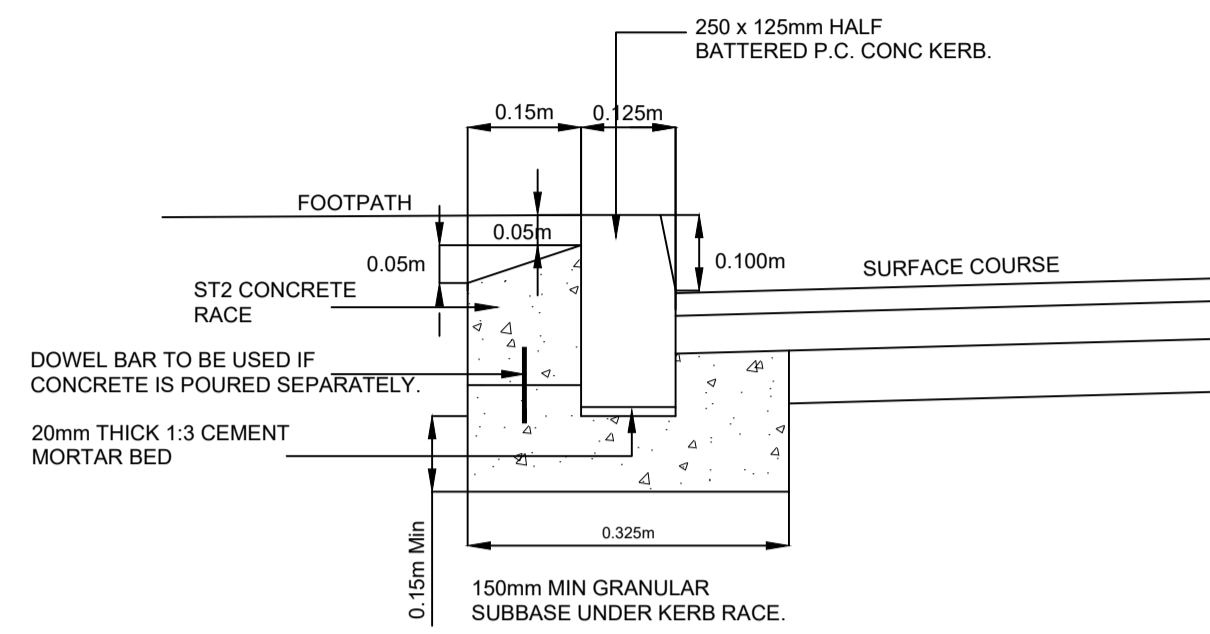

VEHICULAR CORSSING DETAIL Scale 1:20

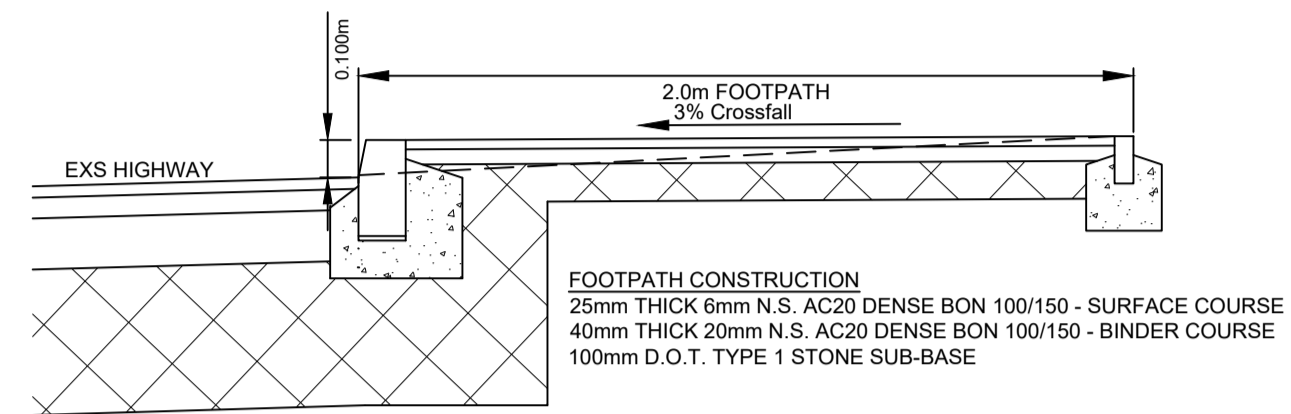
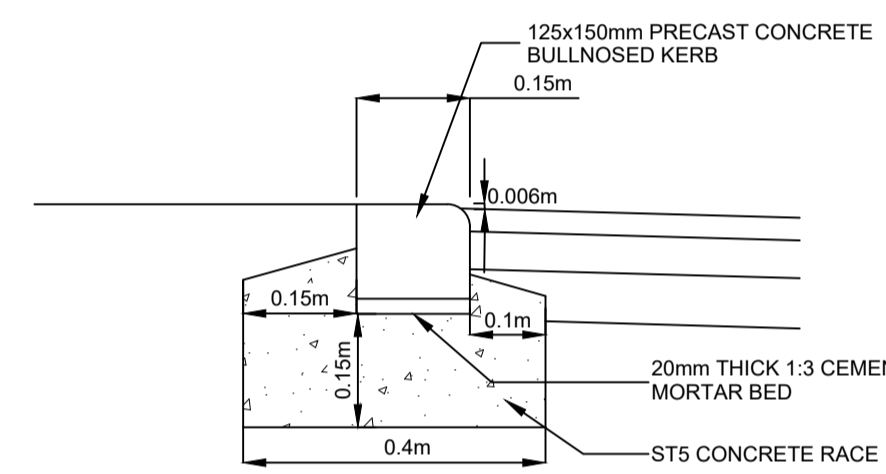
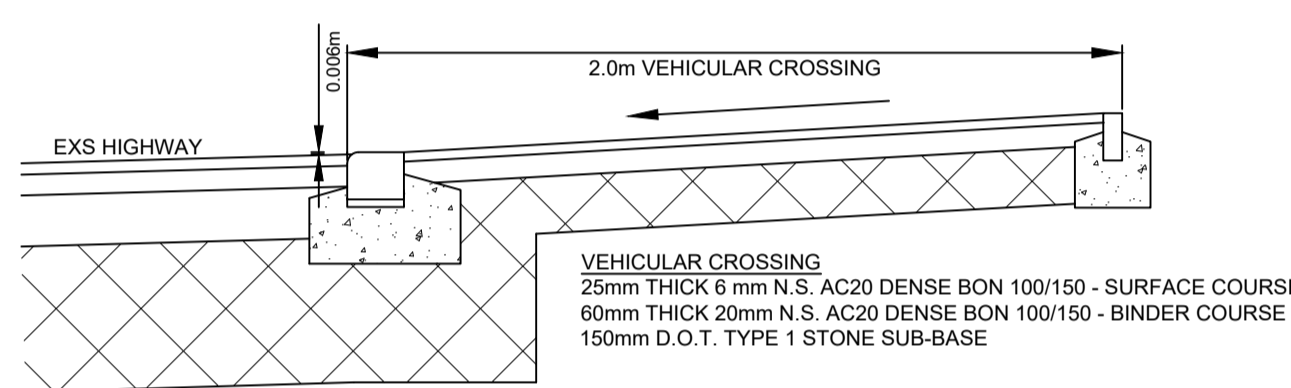

NOTE
 THE SURFACE AND BINDER COURSE AT ALL JUNCTIONS WITH EXISTING ROADS MUST BE CUT BACK TO SOUND VERTICAL FACES SO THAT THE NEW LAYERS FORM STAGGERED JOINTS WITH A 300mm OVERLAP ON THE EXISTING. ALL HORIZONTAL AND VERTICAL FACES TO RECEIVE TACK COAT PRIOR TO LAYING OF RESPECTIVE LAYERS.

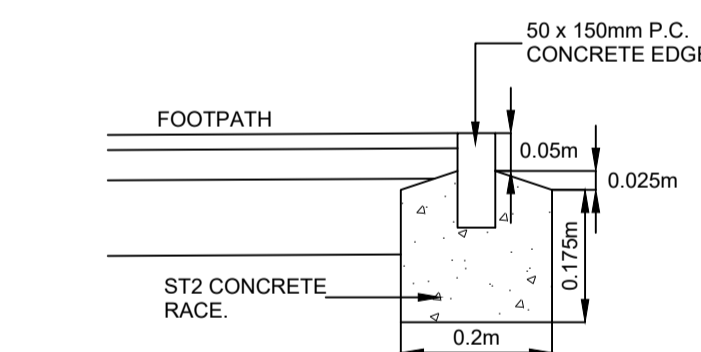
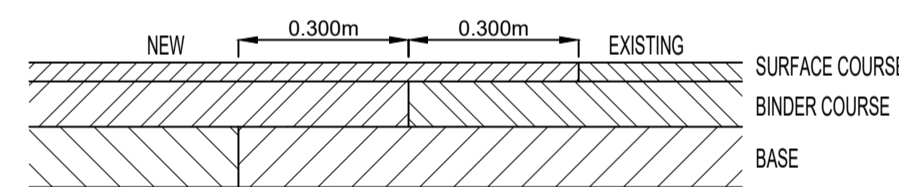

TYPICAL DROPPED CROSSING Scale 1:100

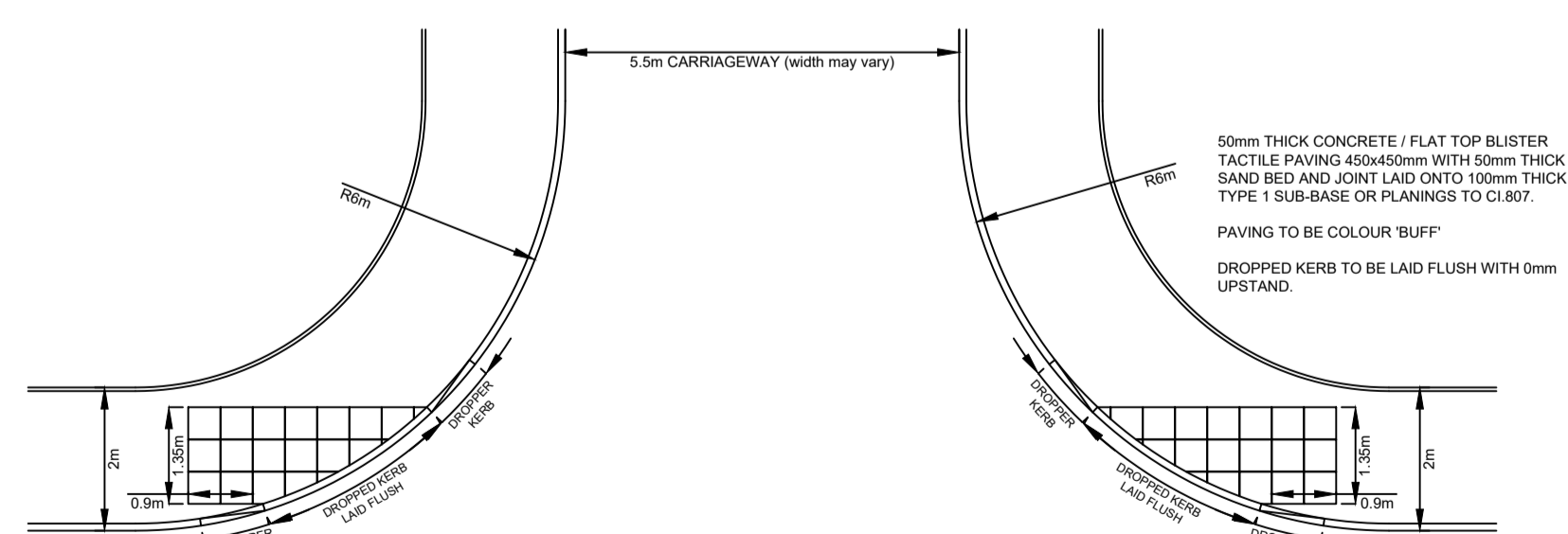

1. ALL ADOPTABLE SEWER WORKS AND MATERIAL TO BE IN ACCORDANCE WITH 'SEWERS FOR ADOPTION' 6th EDITION, THE RELEVANT BRITISH/EUROPEAN AND YORKSHIRE WATER'S STANDARDS/REQUIREMENTS/ADDENDUM TO THE MECHANICAL AND ELECTRICAL SPECIFICATION AND KITEMARKED.
2. MANHOLE COVERS SHALL MUST HAVE A CLEAR OPENING OF 600mm AND SHALL BE CLASS D400 TO BS EN 124 WITH 150mm DEEP FRAMES IN HIGHWAYS.
3. FILLED GROUND MUST BE FILLED AND CONSOLIDATED UNDER THE SUPERVISION AND TO THE SATISFACTION OF YORKSHIRE WATER BEFORE ANY SEWER WORKS ARE CARRIED OUT.
4. YORKSHIRE WATER IS NOT OBLIGED TO ACCEPT FILTER DRAINLAND DRAINAGE RUNOFF INTO THE PUBLIC SEWER NETWORK OR ADOPTABLE DRAINAGE SYSTEM (DIRECTLY OR INDIRECTLY). AN ALTERNATIVE METHOD OF DISPOSAL OF THE LAND DRAINAGE RUNOFF WILL THEREFORE BE REQUIRED AND YOU WILL HAVE TO LAISE WITH THE LOCAL AUTHORITY. LAND DRAINAGE SECTION WITH REGARD TO THE DISPOSAL OF THE FILTER DRAINLAND DRAINAGE RUNOFF.
5. COVER SLABS MUST CARRY THE BSI KITEMARK OR WILL BE REJECTED BY YORKSHIRE WATER INSPECTOR. WHERE THE CLEAR OPENING OF THE KITEMARKED PRODUCT IS DIFFERENT TO THAT OF THE COVER AND FRAME. A LOADING BEARING SLAB SHOULD BE FITTED ABOVE THE COVER SLAB TO BRING THE SIZE DOWN TO 600x600mm FOR THE YORKSHIRE WATER SPECIFIED COVER SIZE. PLEASE REFER TO CONCRETE PIPE SYSTEMS ASSOCIATION (CPSA), 'TECHNICAL BULLETIN' ISSUED AUTUMN 2004 FOR KITEMARKED COVER SLAB OPENING SIZES.
6. SULPHATE RESISTANT CEMENT (C20-DC2) AND PRECAST CONCRETE PRODUCTS MUST BE USED OR A LABORATORY REPORT PROVIDED PROVING THAT SUCH PRECAUTIONS ARE NOT NECESSARY.
7. THE ADOPTABLE SEWERS SHOULD BE A MINIMUM OF 1m AND MANHOLES 0.5m FROM KERB FACES.
8. SEWERS MUST HAVE 5m CLEARANCE FROM TREES AND HEDGES (PLEASE ALSO REFER TO FIGURE 2.3 ON PAGE 33 IN 'SEWERS FOR ADOPTION' 6th EDITION FOR RESTRICTION ON TREE PLANTING ADJACENT TO SEWERS).
9. SEWERS TO BE LAID IN CLASS 'S1' BEDDING (150mm GRANULAR BED AND SURROUND), WHERE DEPTH OF COVER TO TOP OF THE SEWER IS LESS THAN 1.2m IN HIGHWAYS AND VERGES (OR LESS THAN 900mm IN NONE VEHICULAR ACCESS AREAS) THEN A 175mm CONCRETE SLAB OVER SEWER SHALL BE PROVIDED.
10. ALL PIPEWORK 300mm DIAM. OR LESS TO BE VITRIFIED CLAY CONFORMING WITH BS 65. MINIMUM CRUSHING STRENGTHS TO BE AS FOLLOWS: 100mm DIA. 40kN/m, 150mm DIA 40kN/m, 225mm DIA 45kN/m, 300mm DIA 72kN/m.
11. ALL PIPEWORK 375mm DIAM. OR GREATER TO BE CONCRETE CLASS 120, 54kN/m MINIMUM CRUSHING STRENGTH.
12. THE CHAMBER SIZE OF MANHOLES WITH MORE THAN ONE CONNECTION IN THEM MAY NEED TO BE INCREASED AN INCREMENT TO ACCOMMODATE THE CONNECTIONS AND BENDS.
13. YORKSHIRE WATER POLICY IS NOT TO ACCEPT TYPE 'C' BRICK MANHOLES AND 1050mm DIAM. MANHOLE RINGS. INSTEAD IT IS PREFERRED THAT YOU USE A TYPE 'B' MANHOLE WITH 1200mm DIAM. OR 1500mm DIAM. RINGS, WITH THE OPENING SIGHTED OVER THE CHANNEL WHERE DEPTH OF COVER TO PIPE SOFFIT IS 1-1.5m.
14. ALL HIGHWAY WORKS AND MATERIAL TO CONFORM WITH KIRKLEES COUNCIL SPECIFICATION.
15. GULLY COVER AND FRAMES SHALL BE D400 DUCTILE IRON AND COMPLY WITH EUROPEAN STANDARD BS EN 124. THOSE SIGHTED IN ACCESSWAYS AND MEWS COURTS MUST BE SUITABLE FOR USE IN PEDESTRIAN AREAS.
16. BEDDING AND BACKFILL MATERIAL TO CONFORM TO THE REQUIREMENT OF WATER INDUSTRY SPECIFICATION 4-08-2 (TABLE A2).
17. PLASTIC CHANNEL SECTIONS IN MANHOLES ARE NOT ACCEPTABLE AND YORKSHIRE WATER WOULD PREFER PLASTICWARE CHANNELS IN MANHOLES. YORKSHIRE WATER HAVE FOUND THAT PLASTIC CHANNELS ARE DIFFICULT TO SET IN CONCRETE AS THEY FLOAT AND A SATISFACTORY FINISH CANNOT BE OBTAINED ON BENCHING.

