

Legend - CDM Residual Risks	
Key Hazard	Residual Risk
CDM4	Temporary edge protection required prior to installation of lift door.

**General Notes**

- Any areas indicated on the plans are approximate. They relate to the likely areas of the building at the current stage of the design. Any decision to be made on the basis of these indications, contractual agreements or the like, should include due allowance for design development and building tolerances. Plans are subject to Building Control and other statutory approvals.
- Any structural services or fit out details shown is for coordination only. Refer to relevant consultant / client information for full details.
- Refer to Bim Design NBS for full outline performance specification of architectural elements.
- All external envelope construction, insulation specs, number and size of opening lights and size of louvers are subject to verification by internal / external mode and detail coordination with the relevant consultants.
- All FF&E (greyed out) shown is indicative only. Refer to dedicated FF&E drawings for full information.

**Department Legend**

- Basic Teaching
- Circulation
- Large Space
- Learning Resource Area
- Non-Net
- SEN
- Staff & Admin
- Storage

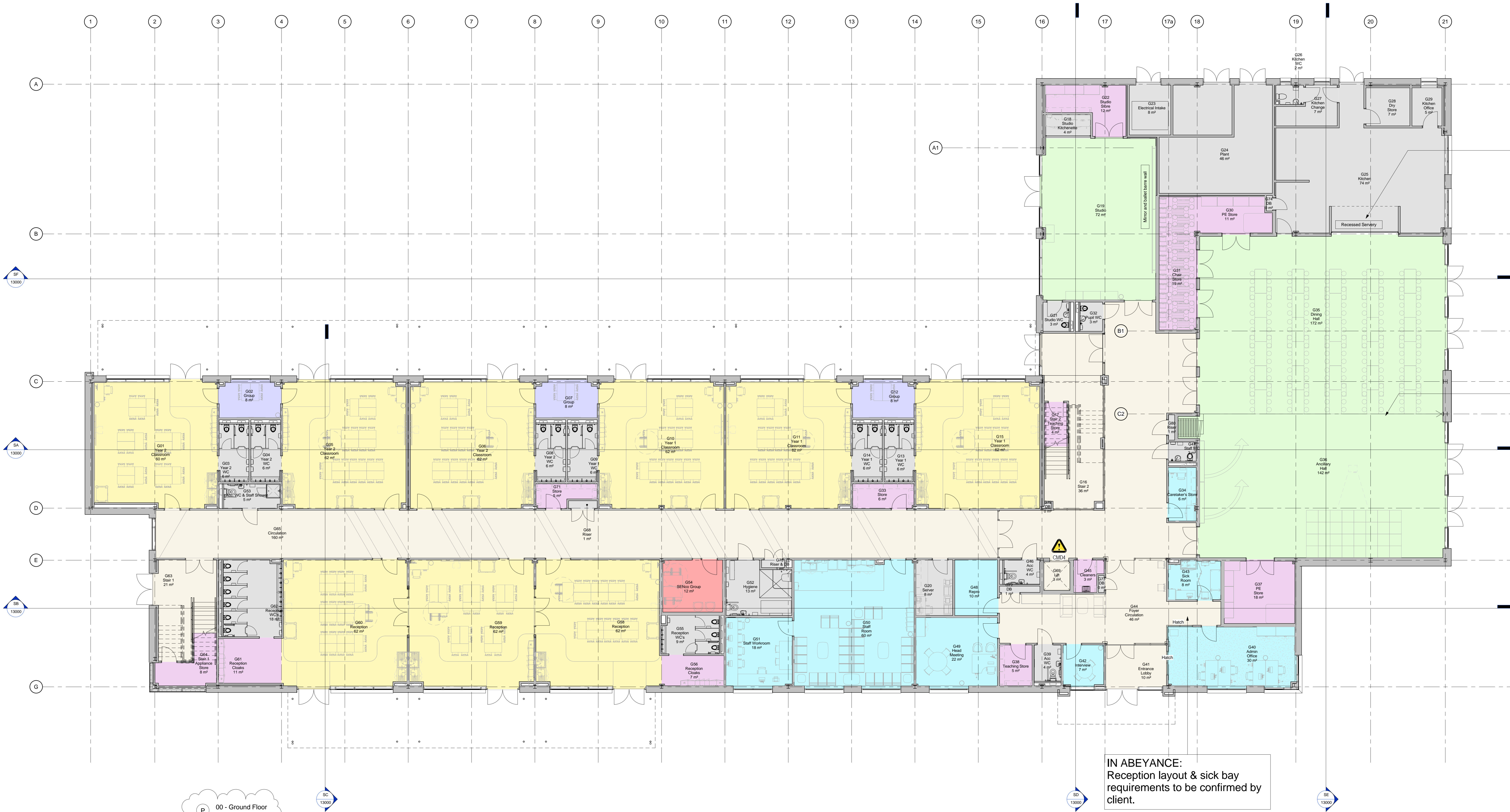

**IN ABEYANCE:**  
 Kitchen servery requirements to be confirmed by client.

**IN ABEYANCE:**  
 Client to confirm position of movable wall as email dated 03/10/16.

**IN ABEYANCE:**  
 Reception layout & sick bay requirements to be confirmed by client.

Rev	By	Date	CHKD	Description
P01	JM	15/01/17	GK	Scale bar added.
P02	JM	23/11/16	GK	Stage 4s issue. Plant room sub-divided and additional door added as M&E Eng request. Key hazards added.
P03	JM	23/11/16	GK	Issue related to wall of movable wall access as requested by M&E.
P04	JM	04/10/16	GK	DR submitted G22 relocated & Reception and storage room sub-divided to allow access from foyer. Additional light wall added. Submission G22 moved to G23. G24 room enlarged at client request. Staff 1 G24 Store enlarged. Cross corridor door added. In response to client request.
P05	JM	15/06/16	GK	Layout amended to incorporate comments from client. Staff 1 Storage enlarged. Reception enlarged. G23 accessible WC relocated. Staff 1 room added. Reception's store enlarged. Storage moved from G22 kitchen change. G24 room enlarged. Additional cross corridor added for security. Client table added to reception canopy for additional seating. K21 tables removed and FF&E beyond. Cross corridor door removed due to completion being pending.
P06	JM	28/01/16	GK	Layout amended to incorporate stage 2 comments from client.
P07	JM	16/09/16	GK	Issue for stage 2 report. Reception added. Entrance planing enlarged.
P08	JM	26/04/16	GK	Plans fully updated in line with client comments. Studio reception reconfigured round to entrance foyer reconfigured & hall enlarged.
P09	JM	12/04/16	GK	Plans fully updated in line with client comments.

**Submittal Code (as defined in BS1192)**  
 Work in Progress (WIP)  
 S0 - Work in Progress  
**Shared (Non-Contractual)**  
 S1 - Suitable for Co-ordination  
 S2 - Suitable for Review & Comment  
 S3 - Suitable for Review & Comment  
 S4 - Suitable for Stage Approval  
 S5 - Not Used  
 S6 - Suitable for PM Authorization  
**WIP to Published (Non-Contractual)**  
 D1 - Suitable for Costing  
 D2 - Suitable for Contractor Design

**Published Documentation (Contractual)**  
 A1, A2, A3, Etc - Approved and accepted as stage complete  
 B1, B2, B3, Etc - Partially signed off with minor comments from the Client  
**Published for AIM Acceptance**  
 CR - As Construction Record Documentation

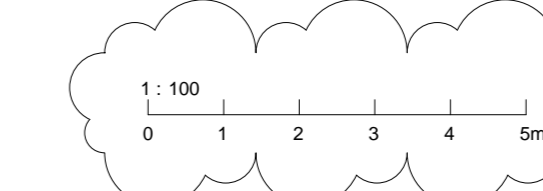

**AIM Design**  
 300 Woodhouse  
 Leeds LS11 3JL  
 0113 2822000  
 www.aim-design.co.uk