

Copyright exist on the designs and information shown on this drawing. No part of this drawing can be reproduced without written confirmation of Heppenstalls. This drawing should only be used for the purpose was issued for and should not be used for construction unless it is marked for construction. Heppenstalls must be notified should any discrepancies be found.

Revision

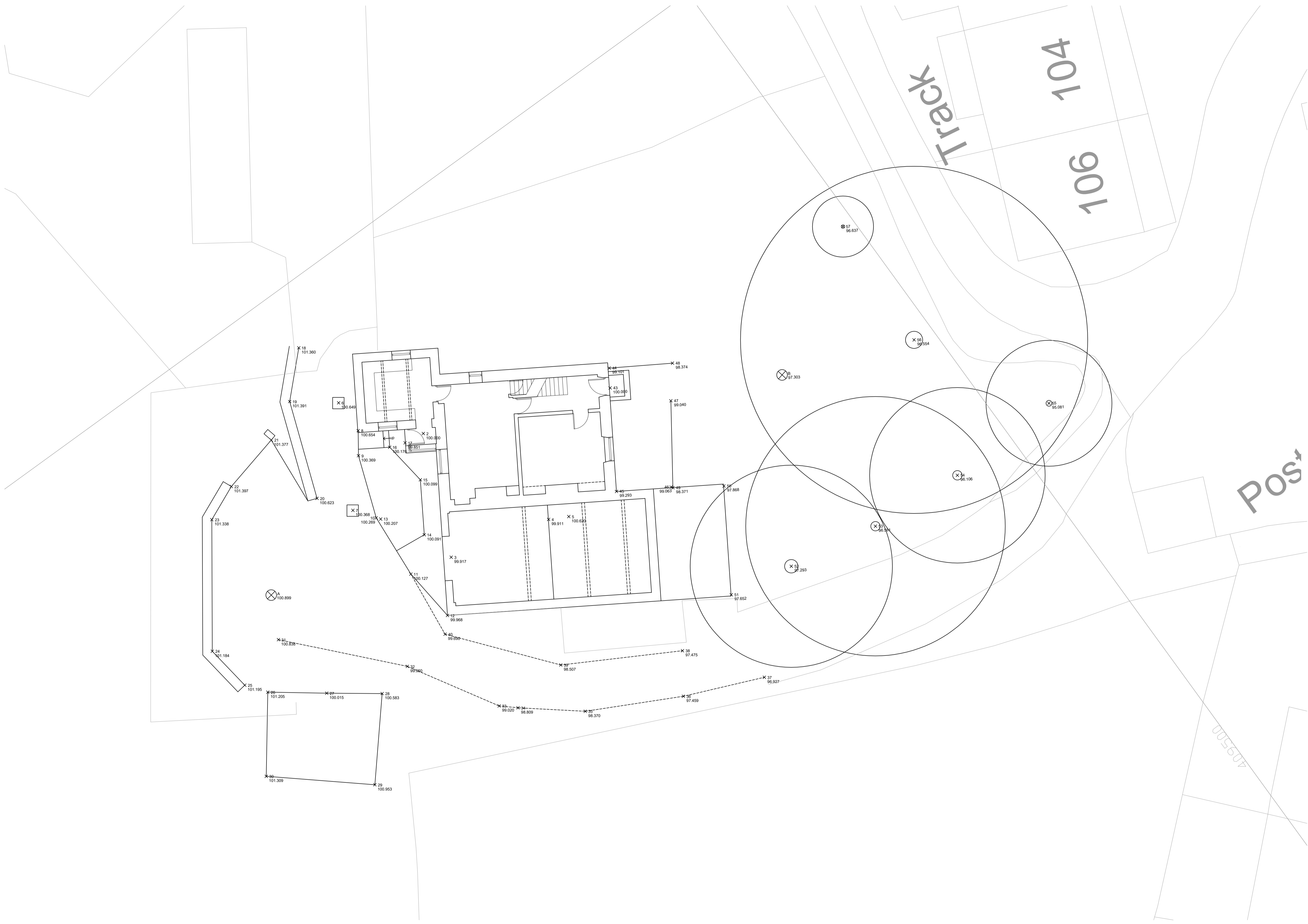

Site Plan 1:100

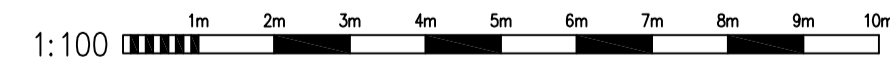

Client E. FINN		
Project 108 Lower Wellhouse, Golcar		
Drawing Survey Site		
Number	Checked	Date
4266-01-05	Scale @ A1 1:100	10/2016

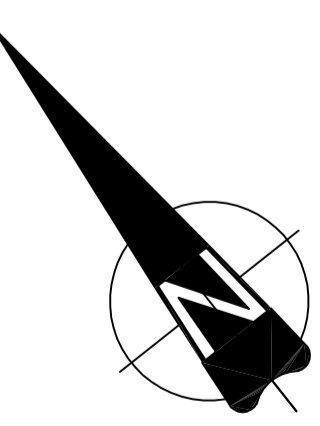

Survey

HEPPENSTALLS
Chartered Architects & Surveyors

Architecture
Surveying
Planning
Project Management

RIBA RICS

Allisons buildings, 135 Armitage Road Milsbridge,
Huddersfield, HD3 4JY tel 01484 655411
projects@heppenstalls.net www.heppenstalls.net

Z:\Finn E\4266-DWSS4266-01 SURVEY.dwg 10/20/2016 11:11:22 AM AYC: ddf\Factor\land.nct A1 1:1