

first floor plan

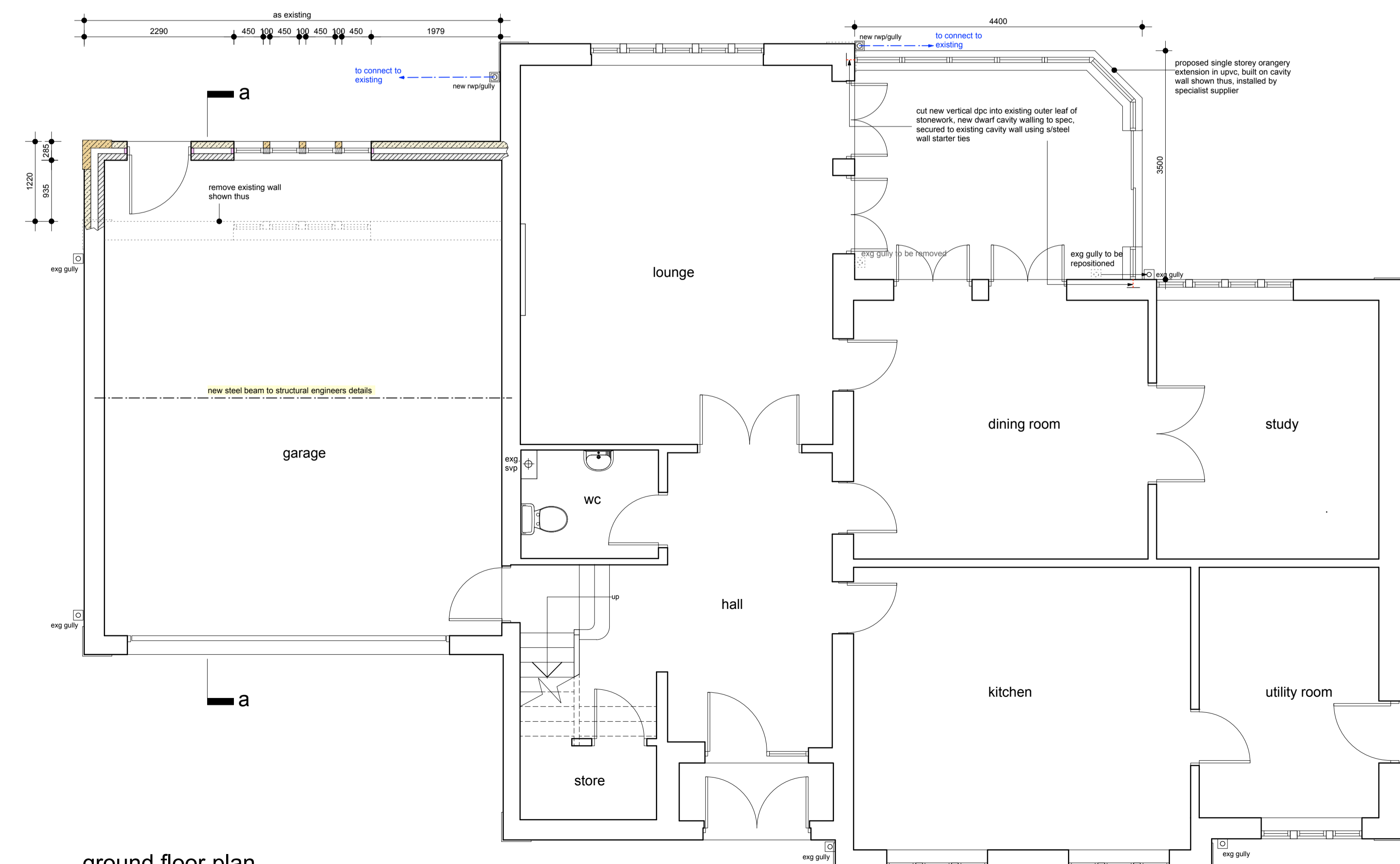

ground floor plan

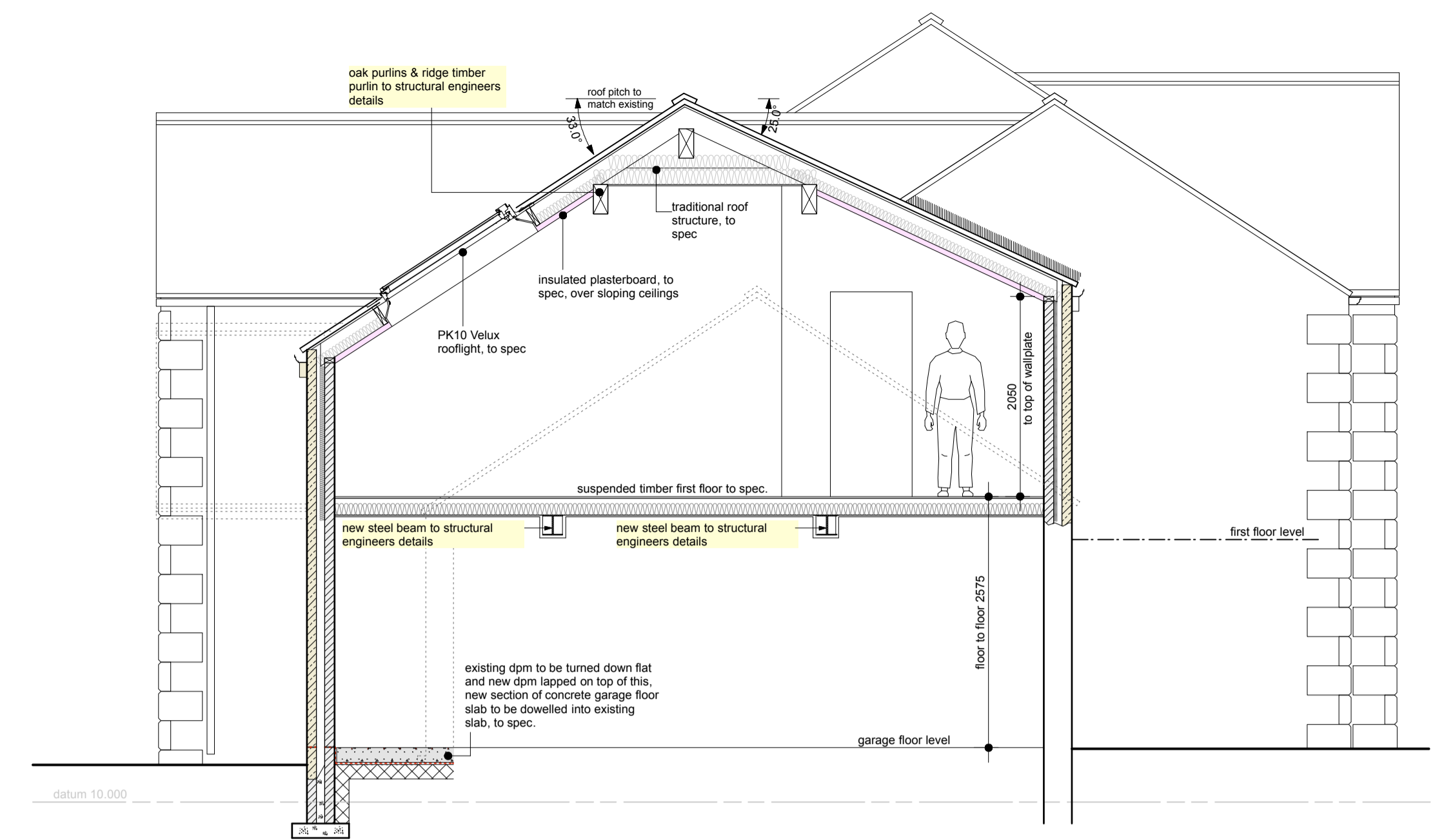

section a - a

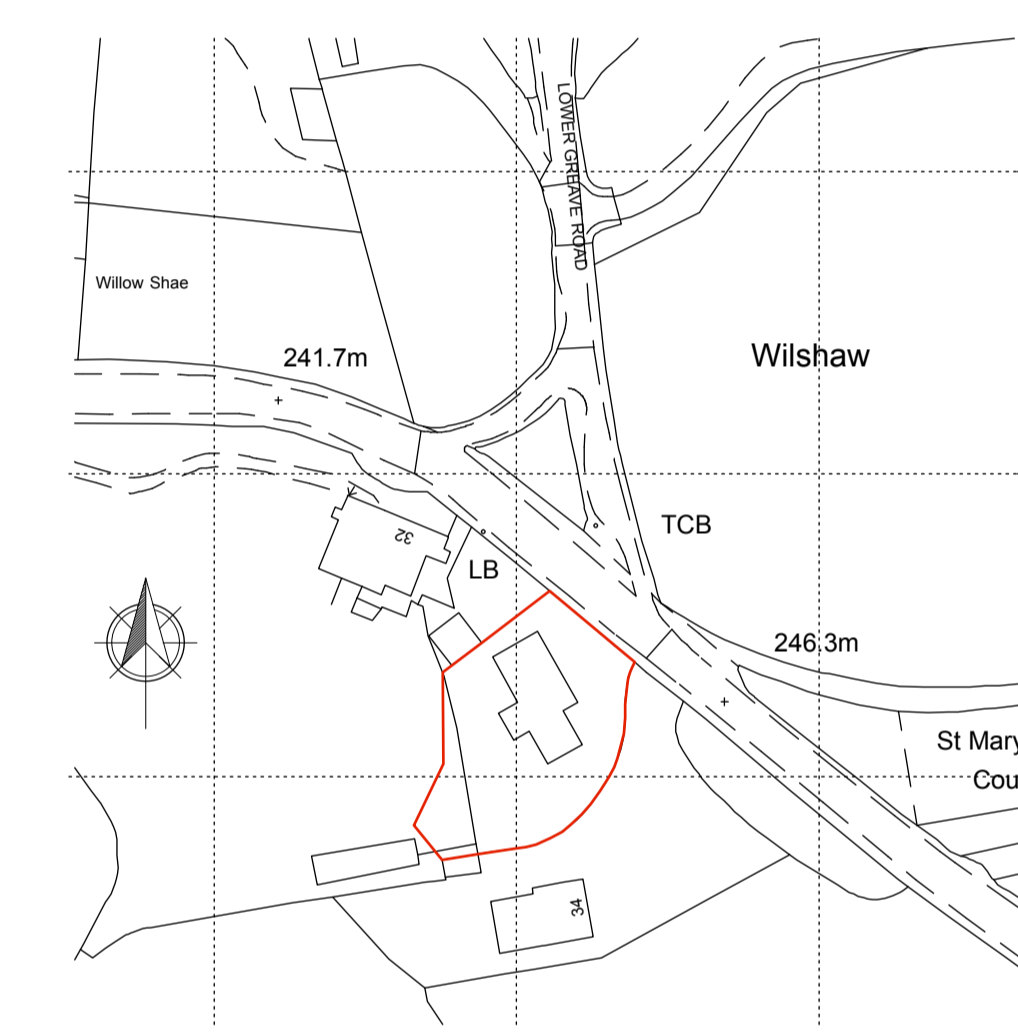

site location plan - 1:1250

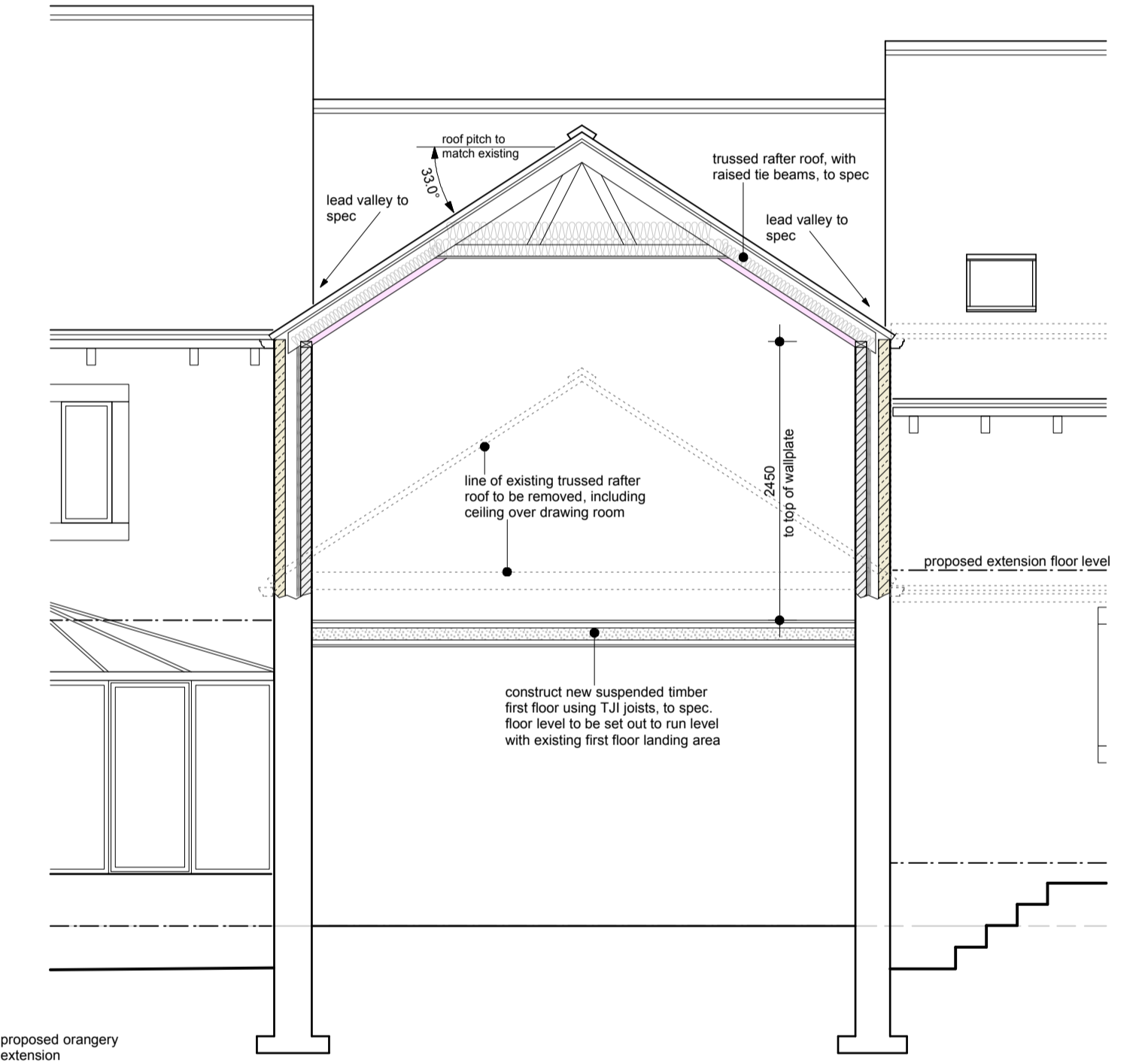

section b - b

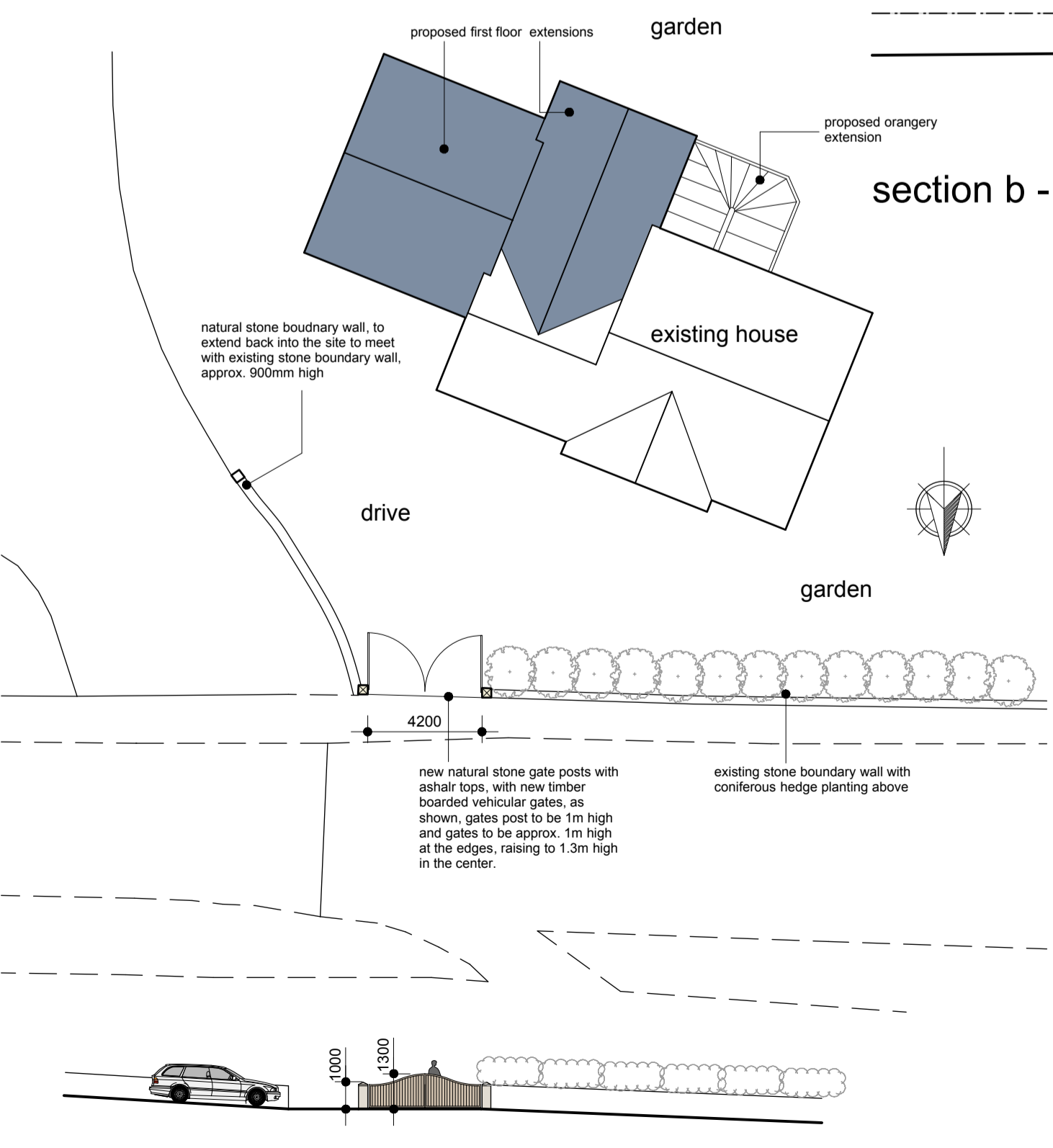

site plan & elevation of proposed gates - 1:200

This drawing has been prepared specifically for the purpose of obtaining Planning Permission and/or Building Regulation Approval. Its suitability for other purposes, without supplementary details and specifications, cannot be guaranteed. The Permissions and/or Approvals are beyond the Architects control, and no guarantee that such will be granted is given or to be inferred by reason of the preparation of this drawing. Only figured dimensions are to be used. All dimensions to be checked on site. This drawing together with the design is the property and copyright of the Architect and must not be reproduced without prior written permission.

P01 Drawing prepared for building regulation purposes 11.10.16 NG NG
 rev. description date drawn apprd



project Proposed extension and alterations
 at
 Braystone House, 32A Wilshaw Road,
 Wilshaw, Holmfirth,
 HD9 4DZ
 for
 Mr Jim Alexander

title plans & sections as proposed
 number 16026D-05-P01
 scale 1:50 or as shown
 size A1